

7/3/19

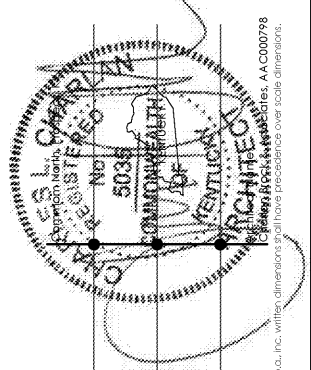

WWW.LDILINE.COM

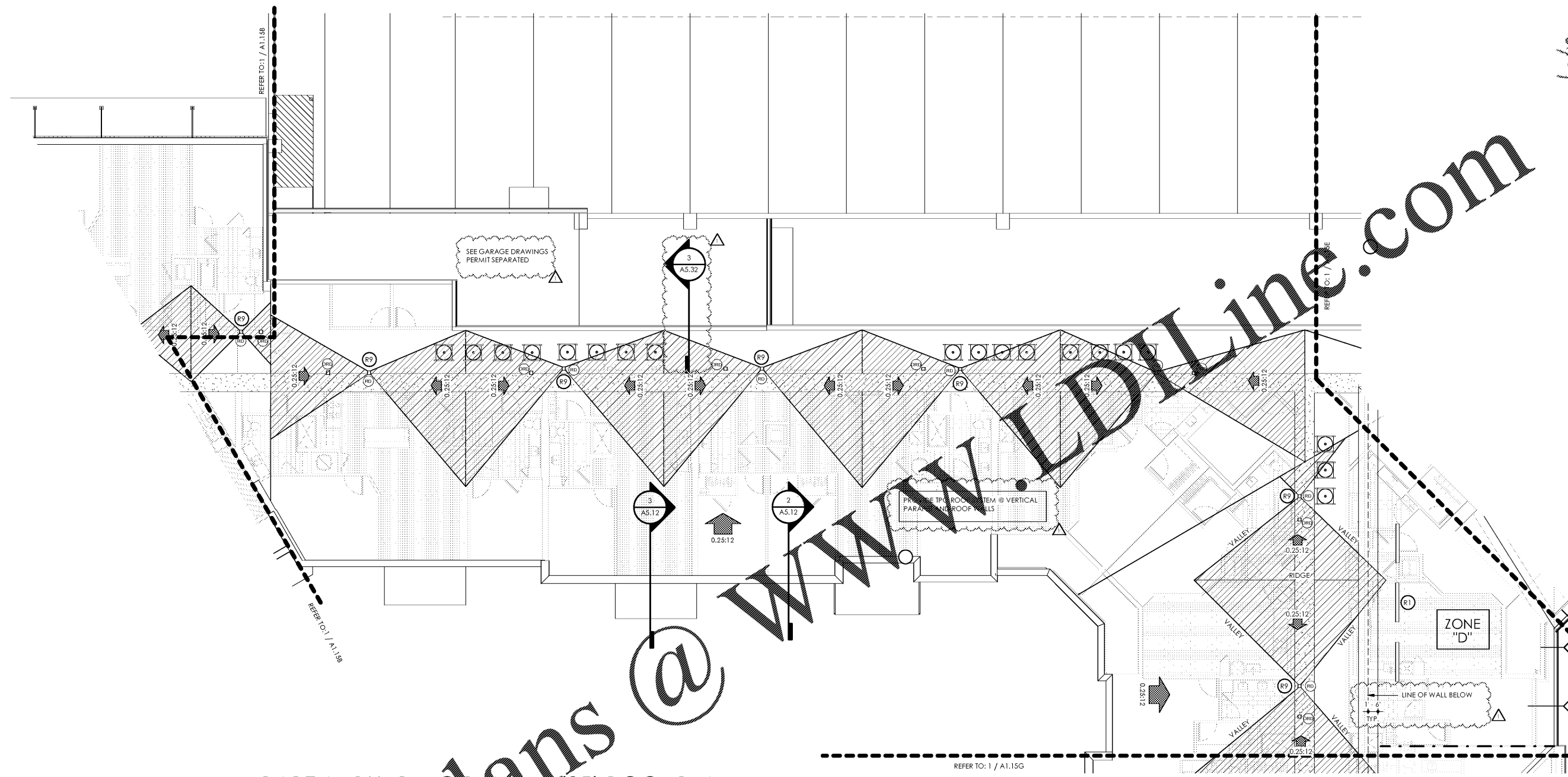

1 PARTIAL BUILDING PLAN F - (05) ROOF PLAN

SCALE: 1/8" = 1'-0"

Lyric at Norton Commons
 Prospect, Kentucky
 Bristol Development Group
 381 Mallory Station Rd, Suite 204
 Franklin, TN 37067

charlan • brock
 associates
 architects • planners
 1770 fennell street
 malland florida 32751-7208
 407.660.8900 f:407.875.9948
 www.cbarchitects.com

PARTIAL BUILDING PLAN F - ROOF PLAN

ROOF TRUSS LEGEND			
TRUSS TYPE	HEEL HEIGHT	BRG. HEIGHT	OVERHANG
A	1'-8 1/4"	32'-6 3/4"	1'
B	1'-2 3/4"	32'-6 3/4"	0'
C	1'-9"	32'-6 3/4"	2'-6"
D	2'-7 1/4"	42'-6 3/4"	1'-6"
E	2'-11 1/4"	42'-6 3/4"	2'-3"
F	2'-7 1/2"	42'-6 3/4"	1'-4"
G	2'-7 7/8"	42'-6 3/4"	1'-9"
H	2'-7 7/8"	42'-6 3/4"	1'-10"
I	2'-2 3/8"	42'-6 3/4"	0'-10"
J	2'-9 1/2"	42'-6 3/4"	1'-11"
K	2'-7"	42'-6 3/4"	1'-8"
L	3'-1 3/8"	42'-6 3/4"	2'-10"
M	2'-10 3/4"	42'-6 3/4"	2'-4"
N	2'-4 1/2"	42'-6 3/4"	1'-2"

ATTIC VENTILATION CALCULATIONS							
ZONES	AREA SQ.FT.	PERIMETER LIN.FT.	REQ. VENT. SQ.FT. HIGH	REQ. VENT. SQ.FT. LOW	PROVIDED VENT. SQ.FT. HIGH	PROVIDED VENT. SQ.FT. LOW	
D	12,668	882	21.11	21.11	15	21.90	70.56

ROOF LEGEND	
	INDICATES ASPHALT SHEATHING ROOF
	INDICATES TPO ROOF SYSTEM W/ 1/2" PER 1'-0" SLOPPING
	INDICATES 4'-0" MIN. WIDE FIRE RETARDANT SHEATHING AT PERIMETER FOR 2 HR BUILDING SEPARATION WALL - NO ROOF PENETRATIONS PERMITTED AT THIS LOCATION
	INDICATES ANTICIPATED EQUIPMENT ROOF LOCATIONS
	INDICATES ACCESS UNDER ROOF - TRUSS ENGINEER TO PROVIDE REINFORCED BOTTOM AND CLEAR PATH THRU TRUSSES

ROOF PLAN GENERAL NOTES

1. ALL ROOF PITCHES ARE 5:12 UNLESS NOTED OTHERWISE.
2. ROOFING CONTRACTOR TO PROVIDE OFF-RIDGE & SOFFIT VENTILATION IN ACCORDANCE WITH THE FBC. OFF-RIDGE VENTS SHALL BE GALV. STEEL OR ALUMINUM VENT WITH SCREEN - PAINT VENTS TO MATCH ROOF. REFER TO ROOF VENT CALCULATIONS ON THIS SHEET.
3. WHERE REQUIRED, ATTIC VENTILATION SHALL BE PROVIDED AND REFER TO MECHANICAL AND PLUMBING PLANS FOR ROOF PENETRATION LOCATIONS.
4. CALCULATED AS FOLLOWS:
 - 5.1 ROOFING CONTRACTOR TO PROVIDE OFF-RIDGE ROOF VENTILATION IN ACCORDANCE WITH FBC OFF-RIDGE ROOF VENTS SHALL BE GALV. STEEL OR ALUMINUM VENT WITH SCREEN - PAINT VENTS TO MATCH ROOF.
 - 5.2 ATTIC VENTILATION TO BE CALCULATED AT 1/300 RATIO.
5. ATTIC VENTILATION SHALL BE A COMBINATION OF VENTINGS AT EAVES AND AT UPPER ROOF. REFER TO ATTIC VENTILATION CALCULATIONS FOR MORE DETAILED INFORMATION.

ROOF KEYNOTES	
	DENOTES OFF RIDGE VENT
	HVAC CONDENSER RACK - ROUTE HVAC COMPRESSOR DRAIN PIPES PER MEP DRAWINGS
	DENOTES 4'-0" MIN. WIDE FIRE RETARDANT PLYWOOD ON BOTH SIDES OF 2-HOUR BUILDING SEPARATION WALL - NO ROOF PENETRATIONS AT THIS LOCATION
	PROVIDE 1/4" PER FOOT MIN. SLOPE AWAY FROM ALL WALLS, TYPICAL.
	DENOTES 6" GUTTER LOCATION
	DENOTES DOWNSPOUT LOCATION
	SCUPPER
	DENOTES 30'X48" ATTIC ACCESS
	DENOTES PRIMARY ROOF DRAIN
	DENOTES OVERFLOW ROOF DRAIN MOUNTED 2' ABOVE PRIMARY ROOF DRAIN
	ROOFTOP EQUIPMENT STAND CAPABLE TO SUPPORT 2,000 POUNDS REFER TO MEP. SEE DETAIL 3(A7.5)

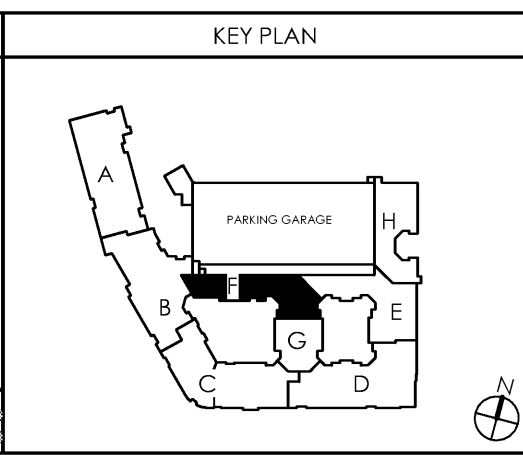

date: 06/04/2019
 job no: 3789.15
 drawn by: EGR JAC, TQT
 reviewed by: CBA
 issue history:
 Δ Date 1 07/03/19

A1.15F

7/3/2019 5:04:05 PM C:\Users\charlan\Documents\Projects\3789.15\PROJECT\DRAWINGS\A1.15F.dwg

charlan, brock & associates, inc. hereby represents its common law copyright and other proprietary rights in these plans, ideas, designs, and drawings. these ideas, designs, and plans are not to be reproduced, changed or copied in any form or manner whatsoever, nor are they to be assigned to any third party, without first obtaining the express written permission from c.b.a., inc. written dimensions shall have precedence over scale dimensions. AA-C000798