

6/3/19

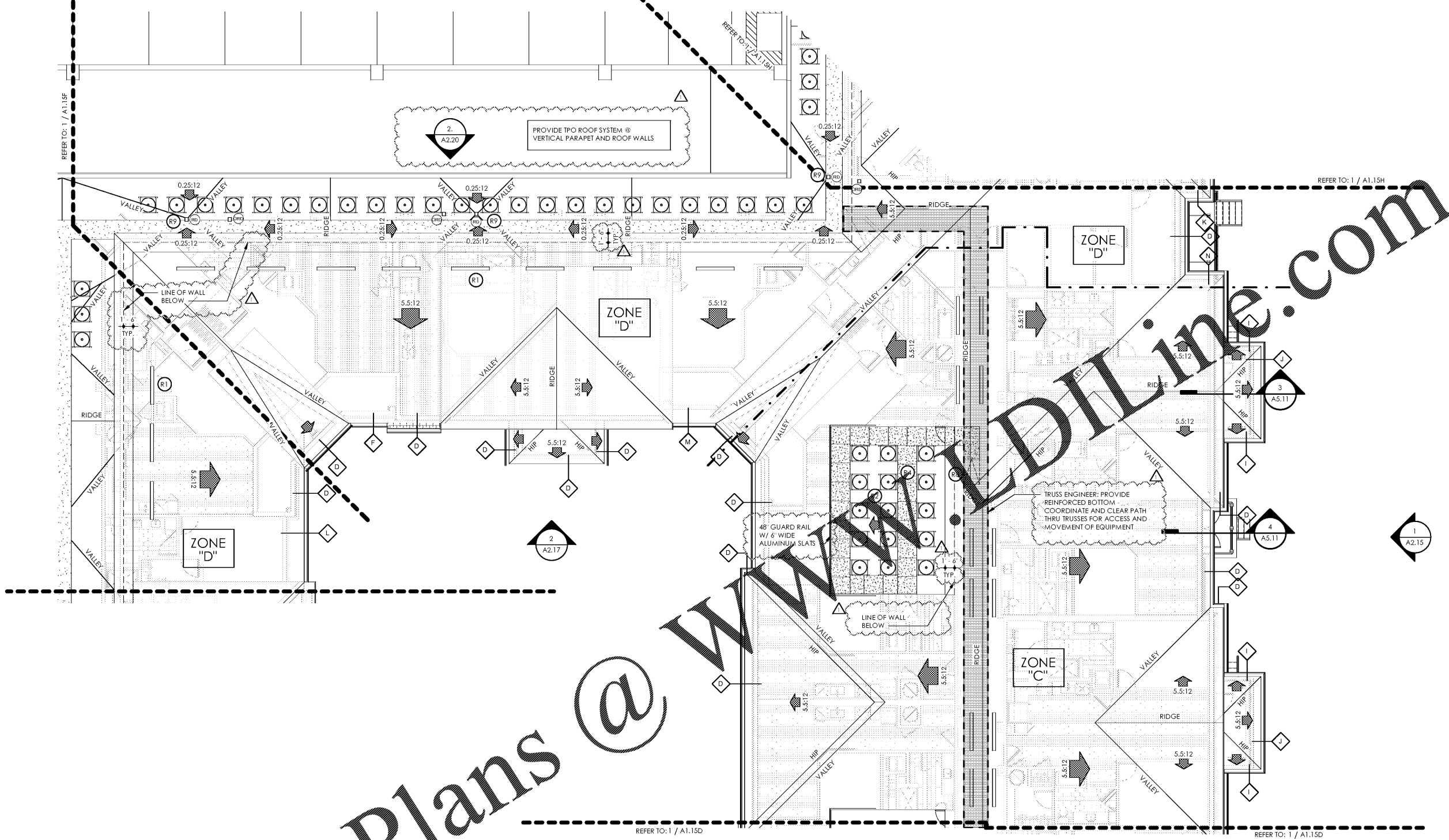
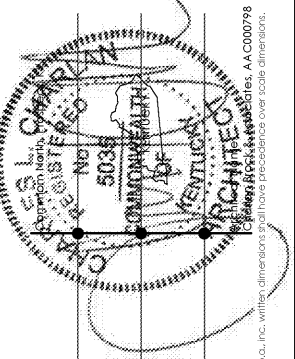

1 PARTIAL BUILDING PLAN E (05) ROOF PLAN

SCALE: 1/8" = 1'-0"

| ROOF TRUSS LEGEND |             |             |          |
|-------------------|-------------|-------------|----------|
| TRUSS TYPE        | HEEL HEIGHT | BRG. HEIGHT | OVERHANG |
| A                 | 1'-8 1/4"   | 32'-6 3/4"  | 1'-6"    |
| B                 | 1'-2 3/4"   | 32'-6 3/4"  | 0'-6"    |
| C                 | 1'-9"       | 32'-6 3/4"  | 2'-6"    |
| D                 | 2'-7 1/4"   | 42'-6 3/4"  | 1'-6"    |
| E                 | 2'-11 1/4"  | 42'-6 3/4"  | 2'-3"    |
| F                 | 2'-7 1/2"   | 42'-6 3/4"  | 1'-4"    |
| G                 | 2'-7 7/8"   | 42'-6 3/4"  | 1'-9"    |
| H                 | 2'-7 7/8"   | 42'-6 3/4"  | 1'-10"   |
| I                 | 2'-2 3/8"   | 42'-6 3/4"  | 0'-10"   |
| J                 | 2'-9 1/2"   | 42'-6 3/4"  | 1'-11"   |
| K                 | 2'-7"       | 42'-6 3/4"  | 1'-8"    |
| L                 | 3'-1 3/8"   | 42'-6 3/4"  | 2'-10"   |
| M                 | 2'-10 3/4"  | 42'-6 3/4"  | 2'-4"    |
| N                 | 2'-4 1/2"   | 42'-6 3/4"  | 1'-2"    |

| ATTIC VENTILATION CALCULATIONS |             |                   |                   |       |                       |       |
|--------------------------------|-------------|-------------------|-------------------|-------|-----------------------|-------|
| ZONES                          | AREA SQ.FT. | PERIMETER LIN.FT. | REQ. VENT. SQ.FT. |       | PROVIDED VENT. SQ.FT. |       |
|                                |             |                   | HIGH              | LOW   | HIGH                  | LOW   |
| C                              | 9,995       | 280               | 16.66             | 16.66 | 12                    | 17.52 |
| D                              | 12,668      | 882               | 21.11             | 21.11 | 15                    | 21.90 |

| ROOF LEGEND |   |
|-------------|---|
|             | INDICATES ASPHALT SHEATHING ROOF  |
|             | INDICATES TPO ROOF SYSTEM W/ 1/2" PER 1'-0" SLOPPING  |
|             | INDICATES 4'-0" MIN. WIDE FIRE RETARDANT SHEATHING AT PERIMETER FOR 2 HR BUILDING SEPARATION WALL - NO ROOF PENETRATIONS PERMITTED AT THIS LOCATION |
|             | INDICATES ANTICIPATED EQUIPMENT ROOF LOCATIONS  |
|             | INDICATES ACCESS UNDER ROOF - TRUSS ENGINEER TO PROVIDE REINFORCED BOTTOM AND CLEAR PATH THRU TRUSSES   |

**ROOF PLAN GENERAL NOTES**

1. ALL ROOF PITCHES ARE 5:12 UNLESS NOTED OTHERWISE.
2. ROOFING CONTRACTOR TO PROVIDE OFF-RIDGE & SOFFIT VENTILATION IN ACCORDANCE WITH THE FBC. OFF-RIDGE VENTS SHALL BE GALV. STEEL OR ALUMINUM VENT WITH SCREEN. PAINT VENTS TO MATCH ROOF. REFER TO ROOF VENT CALCULATIONS ON THIS SHEET.
3. WHERE REQUIRED, ATTIC VENTILATION SHALL BE PROVIDED AND REFER TO MECHANICAL AND PLUMBING PLANS FOR ROOF PENETRATION LOCATIONS.
4. CALCULATED AS FOLLOWS:
  - 5.1 ROOFING CONTRACTOR TO PROVIDE OFF-RIDGE ROOF VENTILATION IN ACCORDANCE WITH FBC OFF-RIDGE ROOF VENTS SHALL BE GALV. STEEL OR ALUMINUM VENT WITH SCREEN - PAINT VENTS TO MATCH ROOF.
  - 5.2 ATTIC VENTILATION TO BE CALCULATED AT 1/300 RATIO. VENTILATION SHALL BE A COMBINATION OF VENTING AT EAVES AND AT UPPER ROOF. REFER TO ATTIC VENTILATION CALCULATIONS FOR MORE DETAILED INFORMATION.

| ROOF KEYNOTES |  |
|---------------|--|
| (R1)          | — DENOTES OFF RIDGE VENT   |
| (R2)          | HVAC CONDENSER RACK - ROUTE HVAC COMPRESSOR DRAIN PIPES PER MEP DRAWINGS   |
| (R3)          | DENOTES 4'-0" MIN. WIDE FIRE RETARDANT PLYWOOD ON BOTH SIDES OF 2-HOUR BUILDING SEPARATION WALL. NO ROOF PENETRATIONS AT THIS LOCATION |
| (R4)          | PROVIDE 1/4" PER FOOT MIN. SLOPE AWAY FROM ALL WALLS, TYPICAL.   |
| (R5)          | — DENOTES 6" GUTTER LOCATION   |
| (R6)          | ⊕ DENOTES DOWNSPOUT LOCATION   |
| (R7)          | SCUPPER  |
| (R8)          | DENOTES 30'x48" ATTIC ACCESS   |
| (R9)          | (RD) DENOTES PRIMARY ROOF DRAIN<br>(RD) DENOTES OVERFLOW ROOF DRAIN MOUNTED 2' ABOVE PRIMARY ROOF DRAIN                                |
| (R10)         | ROOFTOP EQUIPMENT STAND CAPABLE TO SUPPORT 2,000 POUNDS REFER TO MEP. SEE DETAIL 3/A7.57   |

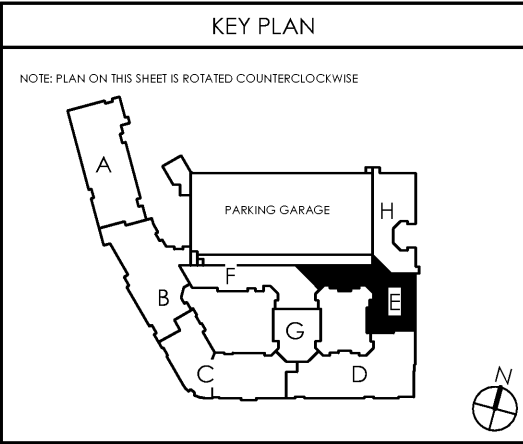

date: 06/04/2019  
 job no: 3789.15  
 drawn by: EGR JAC, TQT  
 reviewed by: CBA  
 issue history:  
 Δ Date 1 07/03/19

A1.15E

7/21/2019 10:09:53 PM C:\Users\charlan\Documents\Projects\3789.15\REVISED\DRAWINGS\05\05A1.15E.dwg

Lyric at Norton Commons  
 Prospect, Kentucky  
 Bristol Development Group  
 381 Mallory Station Rd, Suite 204  
 Franklin, TN 37067

charlan • brock  
 associates  
 architects • planners  
 1770 fennell street  
 mallard florida 32751-7208  
 407.660.8900 f:407.875.9948  
 www.cbarchitects.com

PARTIAL BUILDING  
 PLAN E - ROOF  
 PLAN

charlan, brock & associates, inc. hereby represents its common law copyright and other proprietary rights in these plans, sheets, books, and designs. these plans, sheets, books, and designs. these plans, sheets, books, and designs are not to be reproduced, changed or copied in any form or manner whatsoever, nor are they to be assigned to any third party, without first obtaining the express written permission from c.b.a., inc. written dimensions shall have precedence over scale dimensions. AA-C000798