

7/3/19

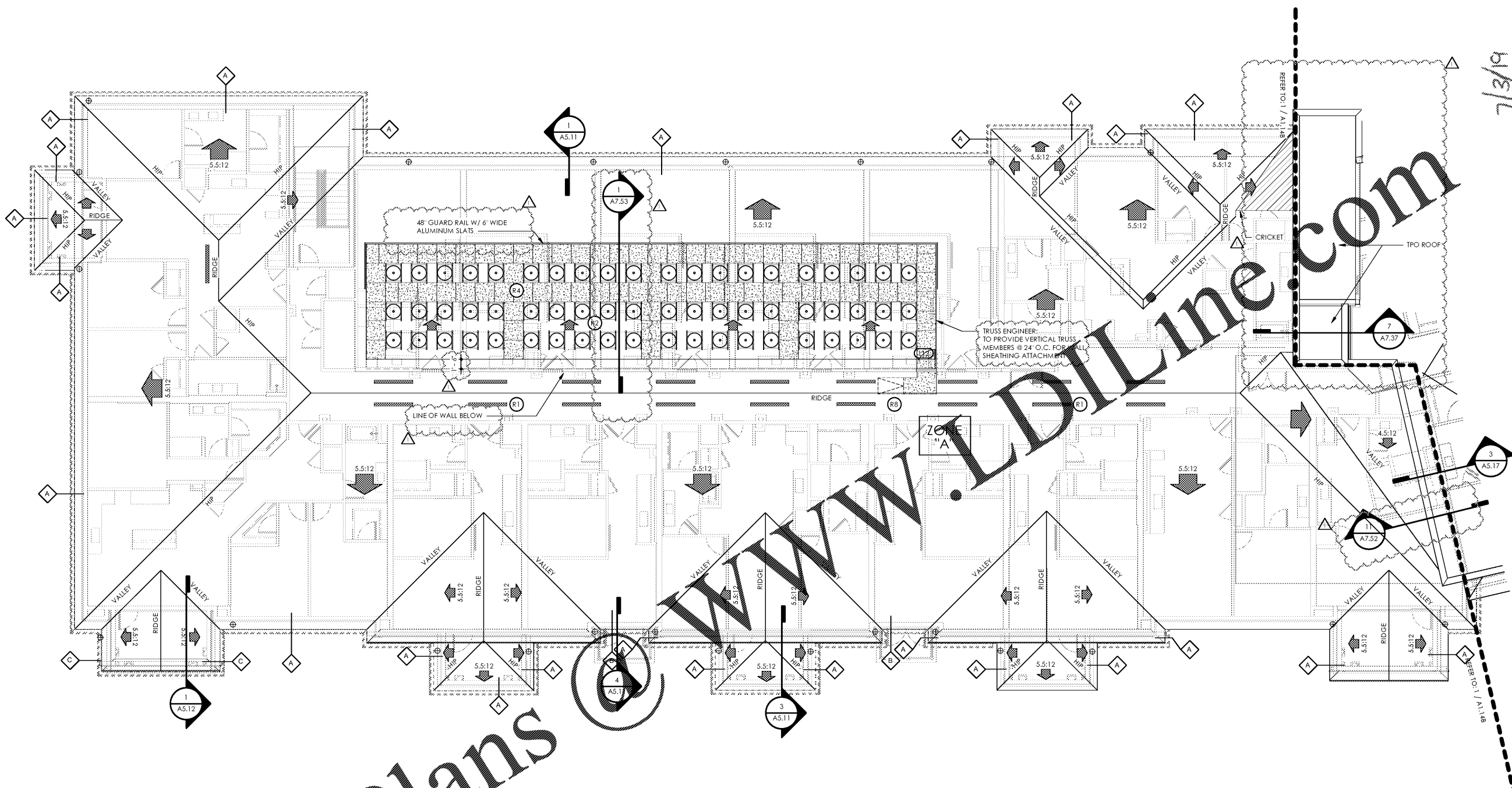

1 PARTIAL BUILDING PLAN A (04) FOURTH FLOOR PLAN

SCALE: 1/8" = 1'-0"

Lyric at Norton Commons
Prospect, Kentucky

Bristol Development Group
381 Mallory Station Rd, Suite 204
Franklin, TN 37067

charlan • brock
associates
architects • planners
1770 fennell street
maitland florida 32751-7208
407.660.8900 f:407.875.9948
www.cbarchitects.com

PARTIAL BUILDING
PLAN A - ROOF
PLAN

date: 06/04/2019
job no: 3789.15
drawn by: EGR JAC, TQT
reviewed by: CBA
issue history:
Δ Date
1 07/03/19

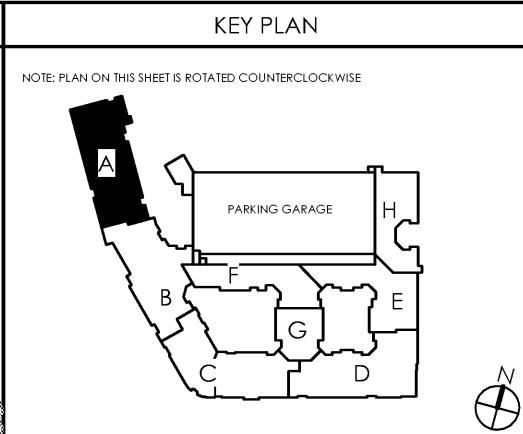

NOTE: PLAN ON THIS SHEET IS ROTATED COUNTERCLOCKWISE

ROOF TRUSS LEGEND			
TRUSS TYPE	HEEL HEIGHT	BRG. HEIGHT	OVERHANG
A	1'-8 1/4"	32'-6 3/4"	1'
B	1'-2 3/4"	32'-6 3/4"	0'
C	1'-9"	32'-6 3/4"	2'-6"
D	2'-7 1/4"	42'-6 3/4"	1'-6"
E	2'-11 1/4"	42'-6 3/4"	2'-3"
F	2'-7 1/2"	42'-6 3/4"	1'-4"
G	2'-7 7/8"	42'-6 3/4"	1'-9"
H	2'-7 7/8"	42'-6 3/4"	1'-10"
I	2'-2 3/8"	42'-6 3/4"	0'-10"
J	2'-9 1/2"	42'-6 3/4"	1'-11"
K	2'-7"	42'-6 3/4"	1'-8"
L	3'-1 3/8"	42'-6 3/4"	2'-10"
M	2'-10 3/4"	42'-6 3/4"	2'-4"
N	2'-4 1/2"	42'-6 3/4"	1'-2"

ATTIC VENTILATION CALCULATIONS							
ZONES	AREA SQ.FT.	PERIMETER LIN.FT.	REQ. VENT. SQ.FT. HIGH	REQ. VENT. SQ.FT. LOW	PROVIDED VENT. SQ.FT. HIGH	PROVIDED VENT. SQ.FT. LOW	
A	16,442	556	27.40	27.40	19	27.74	44.48

ROOF LEGEND	
	INDICATES ASPHALT SHEATHING ROOF
	INDICATES TPO ROOF SYSTEM W/ 1/2\"/>
	INDICATES 4'-0\"/>
	INDICATES ANTICIPATED EQUIPMENT ROOF LOCATIONS
	INDICATES ACCESS UNDER ROOF - TRUSS ENGINEER TO PROVIDE REINFORCED BOTTOM AND CLEAR PATH THRU TRUSSES

ROOF PLAN GENERAL NOTES

1. ALL ROOF PITCHES ARE 5:12 UNLESS NOTED OTHERWISE.
2. ROOFING CONTRACTOR TO PROVIDE OFF-RIDGE & SOFFIT VENTILATION IN ACCORDANCE WITH THE FBC. OFF-RIDGE VENTS SHABE GALV. STEEL OR ALUMINUM VENT WITH SCREEN. PAINT VENTS TO MATCH ROOF. REFER TO ROOF VENT CALCULATIONS ON THIS SHEET.
3. WHERE REQUIRED, ATTIC VENTILATION SHALL BE PROVIDED AND REFER TO MECHANICAL AND PLUMBING PLANS FOR ROOF PENETRATION LOCATIONS.
4. CALCULATED AS FOLLOWS:
5.1 ROOFING CONTRACTOR TO PROVIDE OFF-RIDGE ROOF VENTILATION IN ACCORDANCE WITH FBC OFF-RIDGE ROOF VENTS SHALL BE GALV. STEEL OR ALUMINUM VENT WITH SCREEN - PAINT VENTS TO MATCH ROOF.
5.2 ATTIC VENTILATION TO BE CALCULATED AT 1/300 RATIO. VENTILATION SHALL BE A COMBINATION OF VENTING AT EAVES AND AT UPPER ROOF. REFER TO ATTIC VENTILATION CALCULATIONS FOR MORE DETAILED INFORMATION.

ROOF KEYNOTES	
(R1)	— DENOTES OFF-RIDGE VENT
(R2)	HVAC CONDENSER RACK - ROUTE HVAC COMPRESSOR DRAIN PIPES PER MEP DRAWINGS
(R3)	DENOTES 4'-0\"/>
(R4)	PROVIDE 1/4\"/>
(R5)	--- DENOTES 6\"/>
(R6)	⊕ DENOTES DOWNSPOUT LOCATION
(R7)	SCUPPER
(R8)	DENOTES 30\"/>
(R9)	(RD) DENOTES PRIMARY ROOF DRAIN
(R10)	(RO) DENOTES OVERFLOW ROOF DRAIN MOUNTED 2\"/>
(R11)	ROOFTOP EQUIPMENT STAND CAPABLE TO SUPPORT 2,000 POUNDS REFER TO MEP. SEE DETAIL 3/A7.52

7/3/2019 10:00:00 PM C:\AEC\A Customers\Project\Prospect\3789.15\ERIC_NORTON\COMMONS_01\Roof_PlanA.rvt

charlan, brock & associates, inc. hereby reserves its common law copyright and other proprietary rights in these plans, ideas, and designs. these ideas, designs, and plans are not to be reproduced, changed or copied in any form or manner whatsoever, nor are they to be assigned to any third party, without first obtaining the express written permission from c.b.a., inc. written dimensions shall have precedence over scale dimensions. AA-C000798