

Date:	05/23/19
Drawn by:	ICS
Reviewed by:	DHP
Job Number:	218891
Revision:	Date:

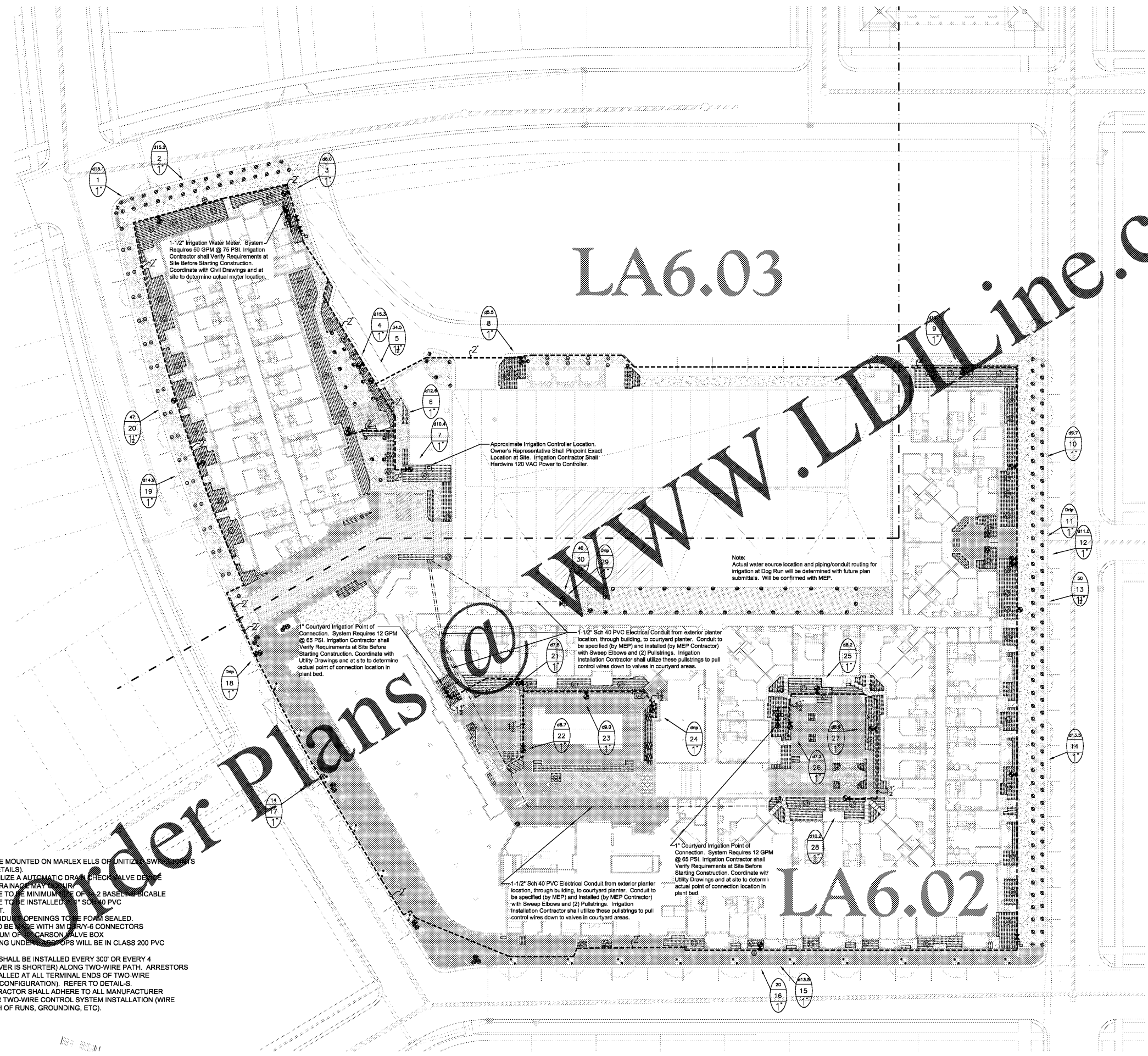
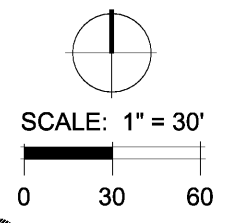

LA6.03

LA6.02

1-1/2" Irrigation Water Meter. System Requires 50 GPM @ 75 PSI. Irrigation Contractor shall Verify Requirements at Site Before Starting Construction. Coordinate with Civil Drawings and at site to determine actual meter location.

Approximate Irrigation Controller Location. Owner's Representative Shall Pinpoint Exact Location at Site. Irrigation Contractor Shall Hardwire 120 VAC Power to Controller.

Note: Actual water source location and piping/conduit routing for irrigation at Dog Run will be determined with future plan submittals. Will be confirmed with MEP.

1" Courtyard Irrigation Point of Connection. System Requires 12 GPM @ 65 PSI. Irrigation Contractor shall Verify Requirements at Site Before Starting Construction. Coordinate with Utility Drawings and at site to determine actual point of connection location in plant bed.

1-1/2" Sch 40 PVC Electrical Conduit from exterior planter location, through building, to courtyard planter. Conduit to be specified (by MEP) and installed (by MEP Contractor) with Sweep Elbows and (2) Pullstrings. Irrigation Installation Contractor shall utilize these pullstrings to pull control wires down to valves in courtyard areas.

1" Courtyard Irrigation Point of Connection. System Requires 12 GPM @ 65 PSI. Irrigation Contractor shall Verify Requirements at Site Before Starting Construction. Coordinate with Utility Drawings and at site to determine actual point of connection location in plant bed.

1-1/2" Sch 40 PVC Electrical Conduit from exterior planter location, through building, to courtyard planter. Conduit to be specified (by MEP) and installed (by MEP Contractor) with Sweep Elbows and (2) Pullstrings. Irrigation Installation Contractor shall utilize these pullstrings to pull control wires down to valves in courtyard areas.

- NOTES:
1. ALL SPRINKLER TO BE MOUNTED ON MARLEX ELLS OR UNITIZED SWIRLS (AS SPECIFIED ON DETAILS).
 2. CONTRACTOR TO UTILIZE AN AUTOMATIC DRAIN CHECK VALVE DEVICE WHERE LOW HEAD DRAINAGE MAY OCCUR.
 3. ALL TWO-WIRE CABLE TO BE MINIMUM SIZE OF #12 BASELINE BICABLE.
 4. ALL TWO-WIRE CABLE TO BE INSTALLED IN 1-1/2" SCH 40 PVC ELECTRICAL CONDUIT.
 5. ALL ELECTRICAL CONDUIT OPENINGS TO BE FOAM SEALED.
 6. ALL WIRE SPLICES TO BE MADE WITH 3M DRY-4 CONNECTORS MOUNTED IN A MINIMUM OF 1" CARSON VALVE BOX.
 7. ALL PIPING AND WIRING UNDER DECK TOPS WILL BE IN CLASS 200 PVC PIPE SLEEVE.
 8. SURGE ARRESTORS SHALL BE INSTALLED EVERY 300' OR EVERY 4 DECODERS (WHICHEVER IS SHORTER) ALONG TWO-WIRE PATH. ARRESTORS SHALL ALSO BE INSTALLED AT ALL TERMINAL ENDS OF TWO-WIRE CABLE PATHS (STAR CONFIGURATION). REFER TO DETAILS.
 9. INSTALLATION CONTRACTOR SHALL ADHERE TO ALL MANUFACTURER SPECIFICATIONS FOR TWO-WIRE CONTROL SYSTEM INSTALLATION (WIRE SIZING, WIRE LENGTH OF RUNS, GROUNDING, ETC).

LYRIC AT NORTON COMMON
Prospect, Kentucky

Bristol Development Group
380 Mallory Station Road, #504, Franklin, TN, 37064



DIX.HITE
+ PARTNERS
150 W. JESSUP AVENUE
LONGWOOD, FLORIDA 32750
TEL 407.687.1777

IRRIGATION PLANS

KEY PLAN

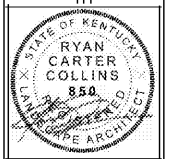

Sheet Number:
LA6.01