

Date:	06/04/19
Drawn by:	PC
Reviewed by:	RC/JW
Job Number:	21889.1
Revision:	Date:

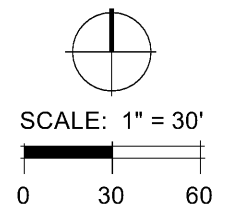

LIGHTING LEGEND:
SEE SHEET LA2.50 FOR FURTHER INFORMATION AND SPECIFICATIONS

- STREET LIGHT (MATCH NORTON COMMONS)
- WALL DOWN LIGHT
- LANDSCAPE UPLIGHT (120 VOLT)
- BOLLARD LIGHT
- WALL ACCENT LIGHTS
- FESTOON LIGHTS (ATTACHED TO WALL)
- FESTOON LIGHTS W/ ALUMINUM POSTS

UTILITY + ELECTRICAL ELEMENTS LEGEND
(SEE CIVIL ENGINEER DRAWINGS)

- LOW VOLTAGE TRANSFORMER
- 120 VOLT ELECTRIC SERVICE
- NEW WATER SERVICE
- SANITARY DRAINAGE CONNECTION
- GAS SERVICE
- OUTDOOR RATED RECEPTACLE OUTLET
- LOW VOLTAGE ELECTRICAL SERVICE
- HOSE BIBB

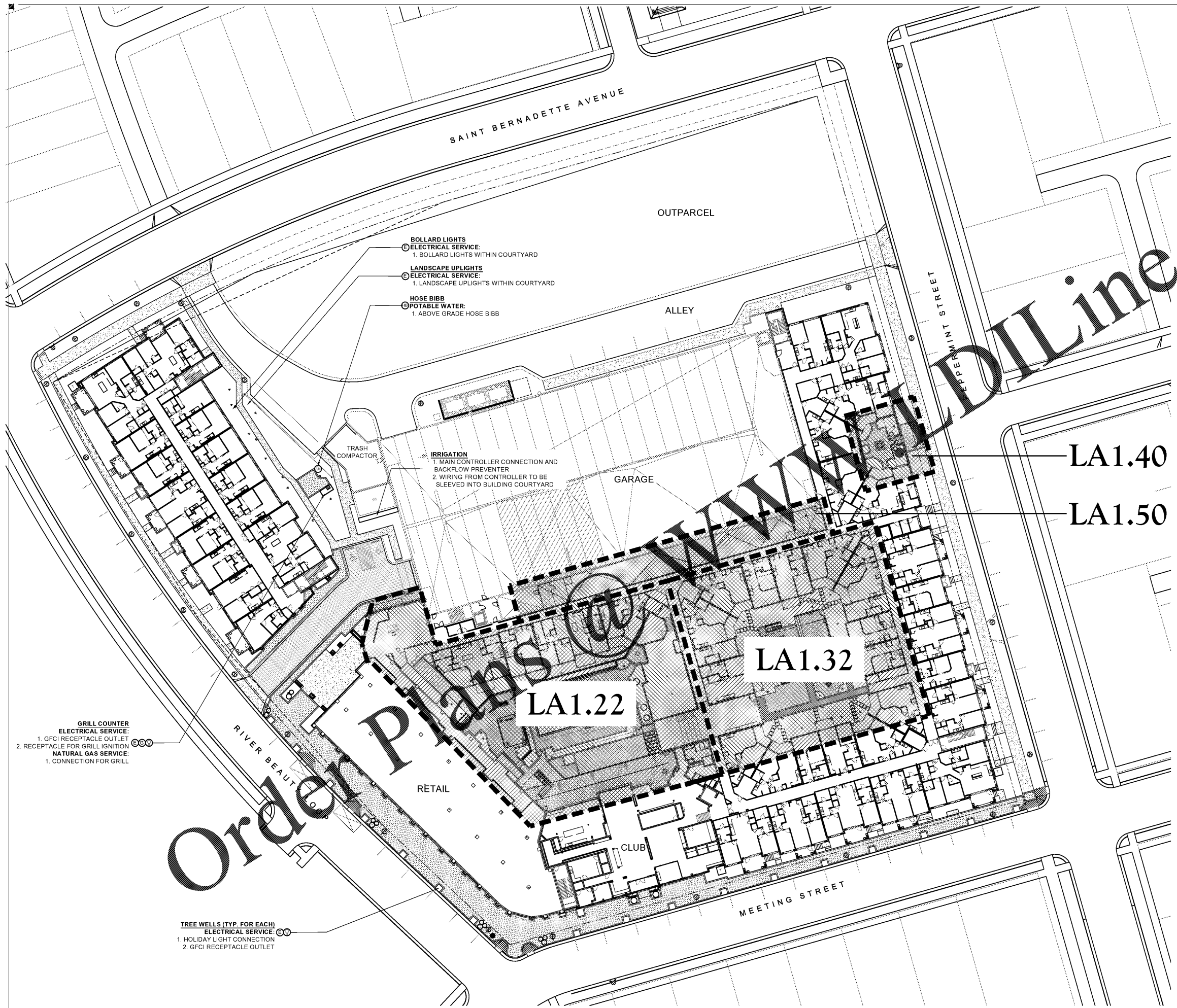

LA1.40
LA1.50

LA1.22
LA1.32

NOTES:

- ALL INFORMATION SHOWN IS FOR DESIGN INTENT/MATERIALITY PURPOSES ONLY. REFER TO CIVIL AND STRUCTURAL DRAWINGS FOR ADDITIONAL DETAILS
- CONTRACTOR SHALL OBTAIN AND UTILIZE AUTOCAD FILES PROVIDED BY THE LANDSCAPE ARCHITECT FOR THE LAYOUT OF ALL SITE ELEMENTS. ALL SITE ELEMENTS SHALL BE STAKED IN THE FIELD FOR APPROVAL BY THE OWNER/LANDSCAPE ARCHITECT PRIOR TO FINAL INSTALLATION.
- EXACT LIGHT LOCATIONS TO BE FIELD STAKED BY CONTRACTOR AND REVIEWED BY L.A. PRIOR TO FINAL INSTALLATION. REFER TO MEP PLANS FOR LIGHT/LIGHTPOLE SPECIFICATIONS, ELECTRIC ROUTING, AND PHOTOMETRICS.

LYRIC AT NORTON COMMONS
Prospect, Kentucky
Bristol Development Group
380 Mallory Station Rd., #504, Franklin, TN 37064

DIX.HITE
+ PARTNERS
150 W. JESSUP AVENUE
LONGWOOD, FLORIDA 32750
TEL 407.667.1777

90% HARDSCAPE PLANS
PERIMETER ELECTRICAL AND UTILITY
NEEDS PLAN

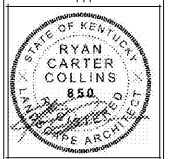

Sheet Number:
LA1.13