

Date:	06/04/19
Drawn by:	PC
Reviewed by:	RC/JW
Job Number:	21889.1
Revision:	Date:

NOTE:
FINAL DRAIN PIPE ROUTING TO BE COORDINATED BY CONTRACTOR TO AVOID CONFLICTS WITH STRUCTURAL FOOTINGS, ETC.

GRADING AND DRAINAGE LEGEND:

- SURFACE FLOW DIRECTION
- 9" BRASS DECK DRAIN
- 6" ATRIUM GRATE
- 12" YARD DRAIN
- SOLID PVC DRAIN PIPE (SEE PLAN FOR SIZES)
- PIPE SIZE
- SPOT ELEVATION
- FLOW DIRECTION OF PIPE AND GRADIENT
- DRAIN IDENTIFICATION SYMBOL
- CHANNEL DRAIN
- 6" PERFORATED DRAIN PIPE
- SPOT ELEVATION PER CIVIL PLANS

GRADING AND DRAINAGE NOTES:

- + DRAINAGE SHALL OUTFALL TO CIVIL STORM STRUCTURE 'F'.
- + ALL DRAINAGE SYSTEM COMPONENTS SHALL BE NDS OR APPROVED EQUAL.
- + CONTRACTOR TO ENSURE POSITIVE DRAINAGE IN ALL AREAS. NO STANDING WATER.
- + INSTALL DRAINAGE EQUIPMENT PER MANUFACTURER'S DETAILS AND STANDARDS.

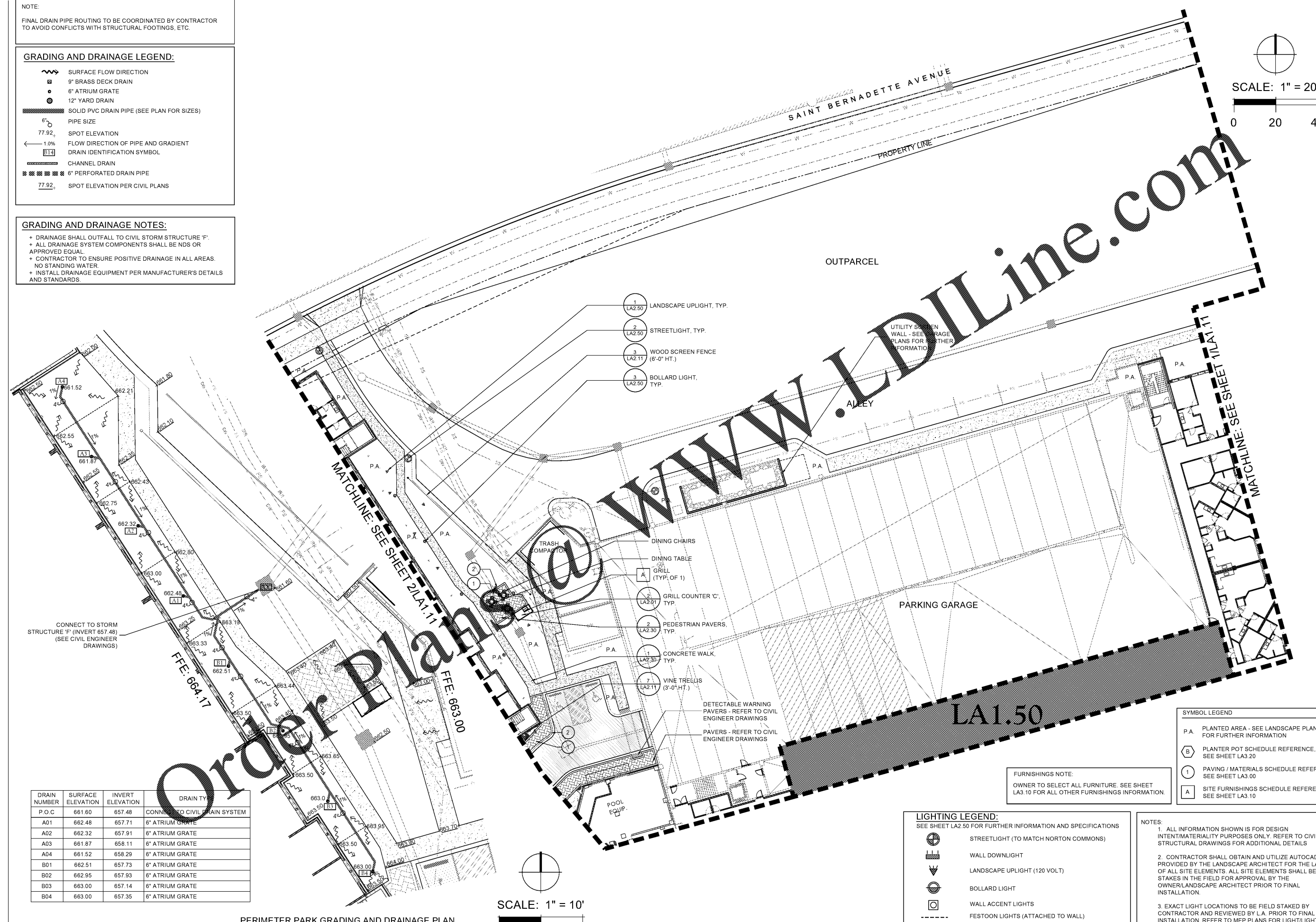
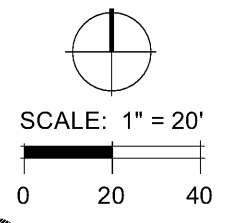

- 1 LA2.50 LANDSCAPE UPLIGHT, TYP.
- 2 LA2.50 STREETLIGHT, TYP.
- 3 LA2.11 WOOD SCREEN FENCE (6'-0" HT.)
- 3 LA2.50 BOLLARD LIGHT, TYP.

CONNECT TO STORM STRUCTURE 'F' (INVERT 657.48) (SEE CIVIL ENGINEER DRAWINGS)

DRAIN NUMBER	SURFACE ELEVATION	INVERT ELEVATION	DRAIN TYPE
P.O.C.	661.60	657.48	CONNECT TO CIVIL DRAIN SYSTEM
A01	662.48	657.71	6" ATRIUM GRATE
A02	662.32	657.91	6" ATRIUM GRATE
A03	661.87	658.11	6" ATRIUM GRATE
A04	661.52	658.29	6" ATRIUM GRATE
B01	662.51	657.73	6" ATRIUM GRATE
B02	662.95	657.93	6" ATRIUM GRATE
B03	663.00	657.14	6" ATRIUM GRATE
B04	663.00	657.35	6" ATRIUM GRATE

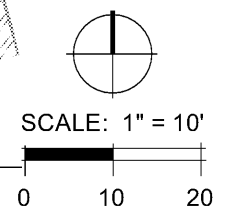

PERIMETER PARK GRADING AND DRAINAGE PLAN

SYMBOL LEGEND

P.A.	PLANTED AREA - SEE LANDSCAPE PLANS FOR FURTHER INFORMATION
B	PLANTER POT SCHEDULE REFERENCE, SEE SHEET LA3.20
1	PAVING / MATERIALS SCHEDULE REFERENCE, SEE SHEET LA3.00
A	SITE FURNISHINGS SCHEDULE REFERENCE, SEE SHEET LA3.10

FURNISHINGS NOTE:
OWNER TO SELECT ALL FURNITURE. SEE SHEET LA3.10 FOR ALL OTHER FURNISHINGS INFORMATION.

LIGHTING LEGEND:
SEE SHEET LA2.50 FOR FURTHER INFORMATION AND SPECIFICATIONS

	STREETLIGHT (TO MATCH NORTON COMMONS)
	WALL DOWNLIGHT
	LANDSCAPE UPLIGHT (120 VOLT)
	BOLLARD LIGHT
	WALL ACCENT LIGHTS
	FESTOON LIGHTS (ATTACHED TO WALL)
	FESTOON LIGHTS W/ ALUMINUM POSTS

NOTES:

- ALL INFORMATION SHOWN IS FOR DESIGN INTENT/MATERIALITY PURPOSES ONLY. REFER TO CIVIL AND STRUCTURAL DRAWINGS FOR ADDITIONAL DETAILS.
- CONTRACTOR SHALL OBTAIN AND UTILIZE AUTOCAD FILES PROVIDED BY THE LANDSCAPE ARCHITECT FOR THE LAYOUT OF ALL SITE ELEMENTS. ALL SITE ELEMENTS SHALL BE STAKED IN THE FIELD FOR APPROVAL BY THE OWNER/LANDSCAPE ARCHITECT PRIOR TO FINAL INSTALLATION.
- EXACT LIGHT LOCATIONS TO BE FIELD STAKED BY CONTRACTOR AND REVIEWED BY L.A. PRIOR TO FINAL INSTALLATION. REFER TO MEP PLANS FOR LIGHT/LIGHTPOLE SPECIFICATIONS, ELECTRIC ROUTING, AND PHOTOMETRICS.

LYRIC AT NORTON COMMONS
Prospect, Kentucky
Bristol Development Group
380 Mallory Station Rd., #504, Franklin, TN 37064

DIX.HITE
PARTNERS
150 W. JESSUP AVENUE
LONGWOOD, FLORIDA 32750
TEL 407.667.1177

90% HARDSCAPE PLANS
PERIMETER HARDSCAPE PLAN

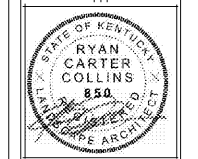

Sheet Number:
LA1.12