

GENERAL NOTES:

1. COORDINATE ALL LOCATIONS AND CONDUIT REQUIREMENTS WITH ARCHITECTURAL SECURITY SHEETS PRIOR TO BIDS. PROVIDE CONDUIT TO ADDITIONAL SECURITY DEVICES SHOWN ON ARCHITECTURAL SECURITY PLANS THAT ARE NOT SHOWN ON THE E-SHEETS.

NOTE:
ALL CONDUITS/CIRCUITRY SHALL BE CONCEALED IN THE CONCRETE SLABS. BEHIND WALLS, OR IN CHASES.

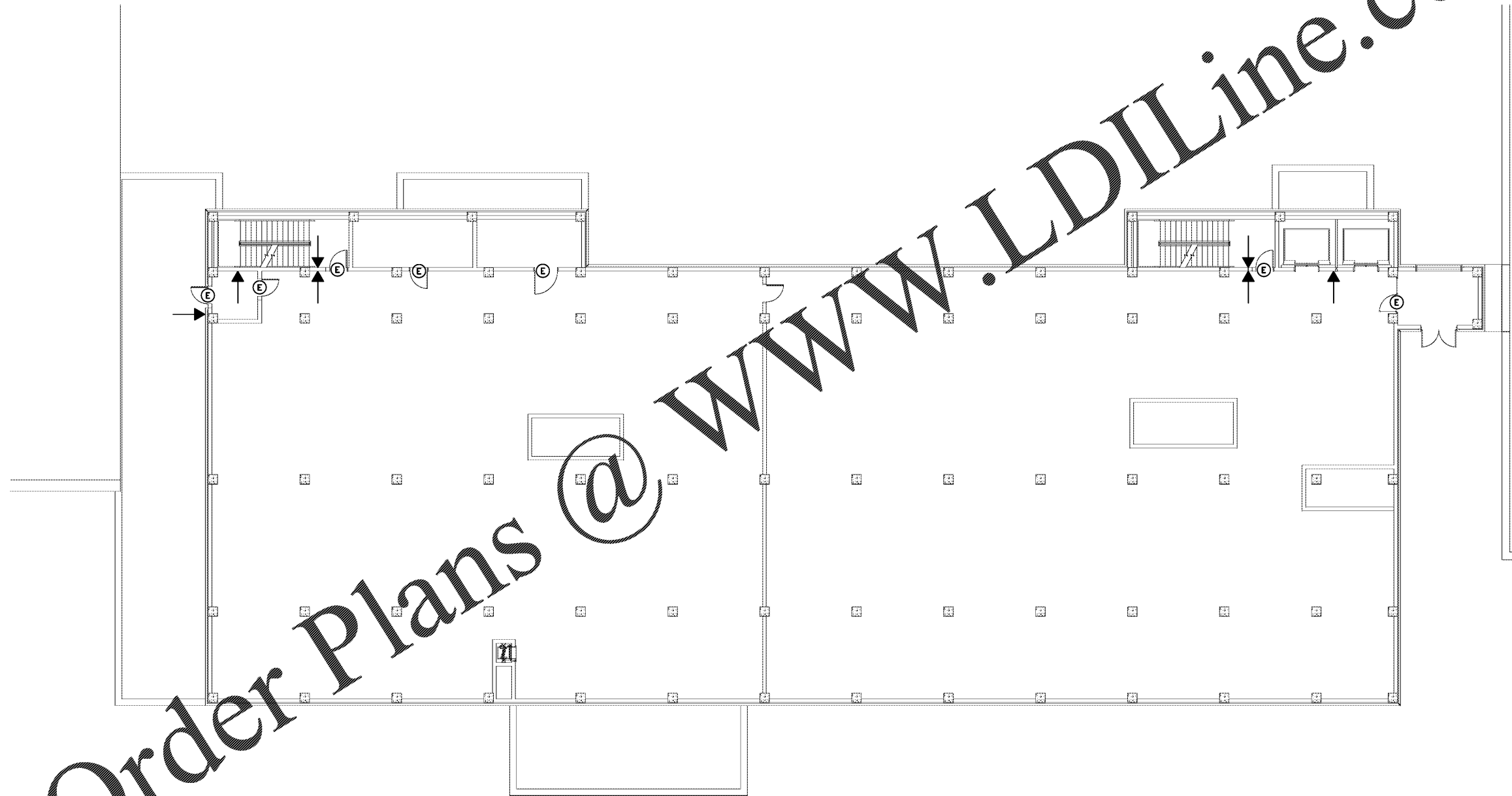

Order Plans @ www.LDILine.com

  2ND FLOOR PLAN - ALTERNATE - SECURITY
SCALE: 1/8"=1'-0"

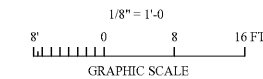

GA Gunn & Associates, P.C.
Consulting Engineers
3102 Highway 14
Millbrook, AL 36054
500 Southland Drive Suite 250
Hoover, AL 35226
Tel: 334.285.1273
GAP18-192

CIP-2017-001
UPGRADES TO THE MOBILE COUNTY METRO JAIL
For The MOBILE COUNTY COMMISSION
MOBILE, ALABAMA



DRAWN: J.C.T.	CHECK: K.A.G.
DATE: April 2, 2019 RTA	
REVISED:	
REVISED:	

SHEET TITLE
2ND FLOOR PLAN -
ALTERNATE - SECURITY

JOB NO.
PH&J 1801-GV

SEQUENCE NO. 159 OF 175

E5.2
© PH&J ARCHITECTS, INC.
ALL RIGHTS RESERVED

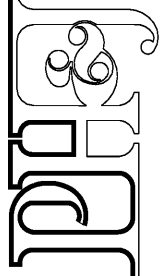

architects inc.
Montgomery, Alabama