

1 KITCHEN
SCALE: 1/4" = 1'-0"

2 CAN WASH
SCALE: 1/4" = 1'-0"

3 ACCENT WALL
SCALE: 1/4" = 1'-0"

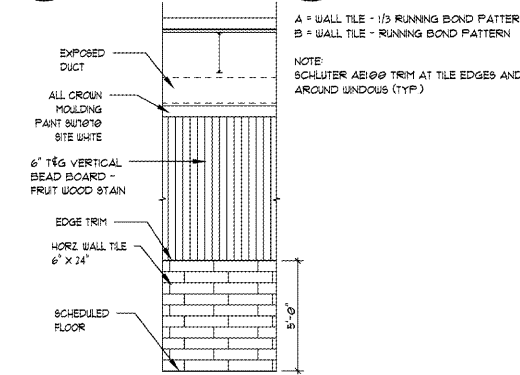

4 DINING AREA
SCALE: 1/4" = 1'-0"

5 RESTROOM
SCALE: 1/4" = 1'-0"

FINISH SCHEDULE										
ROOM NO.	ROOM NAME	FLOOR	BASE	NORTH	SOUTH	EAST	WEST	CEILING	CEILING HT.	REMARKS
101	DINING	SCONG	4/A6.1	4/A6.1	4/A6.1	4/A6.1	3/4/A6.1	PEXCLG	10'-0"	SEE REMARK 2
102	WOMEN'S	CT	2/A6.1	2/A6.1	2/A6.1	2/A6.1	2/A6.1	EPGUB	9'-0"	
103	MEN'S	CT	2/A6.1	2/A6.1	2/A6.1	2/A6.1	2/A6.1	EPGUB	9'-0"	
104	JAN	CT	2/A6.1	2/A6.1	2/A6.1	2/A6.1	2/A6.1	ACT	9'-0"	
105	DRY STORAGE	CT	1/A6.1	1/A6.1	1/A6.1	1/A6.1	1/A6.1	ACT	10'-0"	
106	COOLER	CT	1/A6.1	1/A6.1	1/A6.1	1/A6.1	1/A6.1	ACT	10'-0"	SEE REMARK 1,3
107	FREEZER	CT	1/A6.1	1/A6.1	1/A6.1	1/A6.1	1/A6.1	ACT	10'-0"	SEE REMARK 1,3
108	UNSEX	CT	1/A6.1	1/A6.1	1/A6.1	1/A6.1	1/A6.1	ACT	9'-0"	
109	VESTIBULE	CT	1/A6.1	1/A6.1	1/A6.1	1/A6.1	1/A6.1	ACT	9'-0"	
110	CAN WASH	CT	2/A6.1	2/A6.1	2/A6.1	2/A6.1	2/A6.1	ACT	10'-0"	
111	KITCHEN	CT	1/A6.1	1/A6.1	1/A6.1	1/A6.1	1/A6.1	ACT	10'-0"	
112	SERVICE AREA	SCONG	3/A6.1	3/A6.1	3/A6.1	3/A6.1	3/A6.1	PEXCLG	10'-0"	SEE REMARK 2

FINISH REMARKS
 1. DETAIL 5/A4.2 TO BE USED ON COOLER PANELS
 2. EXPOSED STRUCTURE - HEIGHT VARIES - SEE ROOF PLAN AND STRUCTURAL PLANS
 3. IF OPTION 2 IS TO BE USED, INSTALL TILE 45° DIAGONALLY

FINISH NOTES
 - ALL INTERIOR WALL AND CEILING FINISHES ARE CLASS B AND MEET THE REQUIREMENTS FOR GROUP A-1 PER TABLE 803.5 (FRP MATERIAL IS KEMITE FIRE-X GLASSBORO)
 - ALL FLOOR WALKING SURFACES, INCLUDING TILE, ARE TO BE SLIP-RESISTANT TO COMPLY WITH 1009.5 VBC SECTION 1003.4.
 - 5/8" DUROCK COVERED WITH A LAYER OF 20 GAUGE STAINLESS STEEL TO BE INSTALLED ON WALL BEHIND THE HOOD, EXTENDING 18" BEYOND THE EDGE OF THE HOOD ON EACH SIDE AND RUNNING VERTICALLY FROM THE BOTTOM EDGE OF THE HOOD DOWN TO THE TOP OF THE FLOOR TILE COVE BASE (EXTERIOR SHEATHING WITHIN 18" OF HOOD MUST BE NON-COMBUSTIBLE)
 - FINISH TYPES TO BE SELECTED BY OWNER
 - ALL AREAS WITH QUARRY TILE FLOORS SHALL RECEIVE WATERPROOF 30' FLOOR TO WALL WITH HYDROBAN AND FABRIC
 - WATERPROOFING ALL 90° FLOOR/WALL AREAS IN KITCHEN WITH HYDROBAN AND FABRIC

FINISH ABBREVIATIONS
 WALL: CT - CERAMIC TILE - SEE FINISH TYPES
 GCM - GROUT MOLDING - SEE FINISH TYPES
 BASE: QT - QUARRY TILE - SEE FINISH TYPES
 CT - CERAMIC TILE - SEE FINISH TYPES
 CP - COOLER PANEL
 ECP - EXPOSED COOLER/FREEZER PANEL
 FRP - FIBERGLASS REINFORCED PANEL
 FGWB - PAINT GYPSUM WALL BOARD (1) COAT PRIMER AND (2) COATS FINISH
 -COLOR TO BE SELECTED BY OWNER
 FLOORING: SCONG - POLYMER BOND SEALANT
 CT - CERAMIC TILE - SEE FINISH TYPES
 QT - QUARRY TILE - SEE FINISH TYPES
 FTS - FLOOR TRANSITION STRIP

CEILING
 ACT - 2'x4' ACOUSTICAL CEILING TILE - 1/2" SQUARE EDGE IN 1/2" GRID - SEE FINISH TYPES
 EPGUB - EPOXY PAINT - PAINTED WITH (1) COAT PRIMER AND (2) COATS EPOXY FINISH - COLOR TO BE SELECTED BY OWNER
 EXP - EXPOSED STRUCTURE - PAINT EXPOSED STRUCTURE (1) COAT PRIMER AND (2) COATS FINISH - COLOR TO BE SELECTED BY OWNER

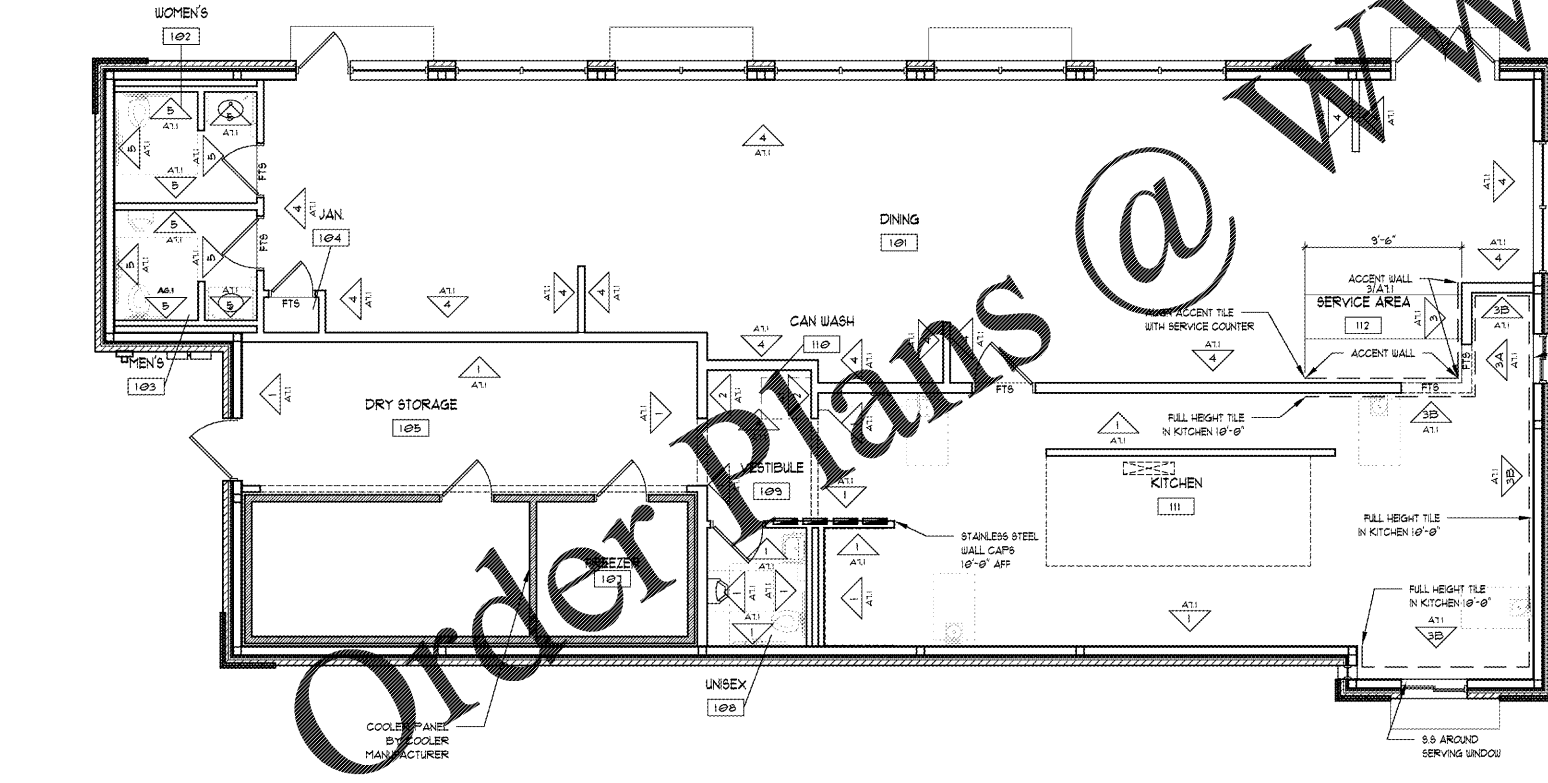

4 FINISH PLAN
SCALE: 3/16" = 1'-0"

NEW DESIGN		FINISH TYPES	
KITCHEN (1/A11)	FLOOR	CEILING	DOOR
<ul style="list-style-type: none"> RED QUARRY TILE, 6" x 6" FABRIC ABRASIVE RED QUARRY TILE BULLNOSE AROUND DRAINS WHEN NEEDED 	<ul style="list-style-type: none"> 2' x 4' SMOOTH PRO CEILING TILE ACCENT WALL (3/A11) 17'x24' SHOUSSCAPE, CURRENT SH-11 	<ul style="list-style-type: none"> OPTION 1 = EXPOSED STRUCTURE AND WALLS ABOVE CROWN MOLDING BLACK EXPOSED DUCT - GALVANIZED CROWN MOLDING - SHERWIN WILLIAMS SITE WHITE (501010) OPTION 2 = 2'x4' BLACK REGULAR ACOUSTICAL TILES IN A WHITE LAY-IN GRID 	<ul style="list-style-type: none"> PAINT COLOR: BATTLESHIP GRAY PAINT COLOR: BATTLESHIP GRAY
CAN WASH (2/A11)	FLOOR	CEILING	DOOR
<ul style="list-style-type: none"> RED QUARRY TILE, 6" x 6" FABRIC ABRASIVE RED QUARRY TILE BULLNOSE AROUND DRAINS WHEN NEEDED 	<ul style="list-style-type: none"> 2' x 4' SMOOTH PRO CEILING TILE ACCENT WALL (3/A11) 17'x24' SHOUSSCAPE, CURRENT SH-11 	<ul style="list-style-type: none"> OPTION 1 = EXPOSED STRUCTURE AND WALLS ABOVE CROWN MOLDING BLACK EXPOSED DUCT - GALVANIZED CROWN MOLDING - SHERWIN WILLIAMS SITE WHITE (501010) OPTION 2 = 2'x4' BLACK REGULAR ACOUSTICAL TILES IN A WHITE LAY-IN GRID 	<ul style="list-style-type: none"> PAINT COLOR: BATTLESHIP GRAY PAINT COLOR: BATTLESHIP GRAY
DINING AREA (4/A11)	FLOOR	CEILING	DOOR
<ul style="list-style-type: none"> OPTION 1 - STAINED CONCRETE OPTION 2 - 15' x 15' COTTO CONTEMPOR CO3 WALL STREET, INSTALLED DIAGONALLY 6' x 24" DRIFTWOOD FELD SONORA - 6300 1/2" x 24" 9' HIGH KNEE WALL 3'-0" HIGH ABOVE TILES 	<ul style="list-style-type: none"> 2' x 4' SMOOTH PRO CEILING TILE ACCENT WALL (3/A11) 17'x24' SHOUSSCAPE, CURRENT SH-11 	<ul style="list-style-type: none"> OPTION 1 = EXPOSED STRUCTURE AND WALLS ABOVE CROWN MOLDING BLACK EXPOSED DUCT - GALVANIZED CROWN MOLDING - SHERWIN WILLIAMS SITE WHITE (501010) OPTION 2 = 2'x4' BLACK REGULAR ACOUSTICAL TILES IN A WHITE LAY-IN GRID 	<ul style="list-style-type: none"> PAINT COLOR: BATTLESHIP GRAY PAINT COLOR: BATTLESHIP GRAY
RESTROOMS (5-A11)	FLOOR	CEILING	DOOR
<ul style="list-style-type: none"> FOREST PARK, BLACKWOOD, FP93, 9' x 36" SCHLUTER ABE100 IN DOOR THRESHOLD 	<ul style="list-style-type: none"> 2' x 4' SMOOTH PRO CEILING TILE ACCENT WALL (3-A11) 17'x24' SHOUSSCAPE, CURRENT SH-11 	<ul style="list-style-type: none"> OPTION 1 = EXPOSED STRUCTURE AND WALLS ABOVE CROWN MOLDING BLACK EXPOSED DUCT - GALVANIZED CROWN MOLDING - SHERWIN WILLIAMS SITE WHITE (501010) OPTION 2 = 2'x4' BLACK REGULAR ACOUSTICAL TILES IN A WHITE LAY-IN GRID 	<ul style="list-style-type: none"> PAINT COLOR: BATTLESHIP GRAY PAINT COLOR: BATTLESHIP GRAY

FINISH REMARKS
 1. DETAIL 5/A4.2 TO BE USED ON COOLER PANELS
 2. EXPOSED STRUCTURE - HEIGHT VARIES - SEE ROOF PLAN AND STRUCTURAL PLANS
 3. IF OPTION 2 IS TO BE USED, INSTALL TILE 45° DIAGONALLY

FINISH NOTES
 - ALL INTERIOR WALL AND CEILING FINISHES ARE CLASS B AND MEET THE REQUIREMENTS FOR GROUP A-1 PER TABLE 803.5 (FRP MATERIAL IS KEMITE FIRE-X GLASSBORO)
 - ALL FLOOR WALKING SURFACES, INCLUDING TILE, ARE TO BE SLIP-RESISTANT TO COMPLY WITH 1009.5 VBC SECTION 1003.4.
 - 5/8" DUROCK COVERED WITH A LAYER OF 20 GAUGE STAINLESS STEEL TO BE INSTALLED ON WALL BEHIND THE HOOD, EXTENDING 18" BEYOND THE EDGE OF THE HOOD ON EACH SIDE AND RUNNING VERTICALLY FROM THE BOTTOM EDGE OF THE HOOD DOWN TO THE TOP OF THE FLOOR TILE COVE BASE (EXTERIOR SHEATHING WITHIN 18" OF HOOD MUST BE NON-COMBUSTIBLE)
 - FINISH TYPES TO BE SELECTED BY OWNER
 - ALL AREAS WITH QUARRY TILE FLOORS SHALL RECEIVE WATERPROOF 30' FLOOR TO WALL WITH HYDROBAN AND FABRIC
 - WATERPROOFING ALL 90° FLOOR/WALL AREAS IN KITCHEN WITH HYDROBAN AND FABRIC

FINISH ABBREVIATIONS
 WALL: CT - CERAMIC TILE - SEE FINISH TYPES
 GCM - GROUT MOLDING - SEE FINISH TYPES
 BASE: QT - QUARRY TILE - SEE FINISH TYPES
 CT - CERAMIC TILE - SEE FINISH TYPES
 CP - COOLER PANEL
 ECP - EXPOSED COOLER/FREEZER PANEL
 FRP - FIBERGLASS REINFORCED PANEL
 FGWB - PAINT GYPSUM WALL BOARD (1) COAT PRIMER AND (2) COATS FINISH
 -COLOR TO BE SELECTED BY OWNER
 FLOORING: SCONG - POLYMER BOND SEALANT
 CT - CERAMIC TILE - SEE FINISH TYPES
 QT - QUARRY TILE - SEE FINISH TYPES
 FTS - FLOOR TRANSITION STRIP

CEILING
 ACT - 2'x4' ACOUSTICAL CEILING TILE - 1/2" SQUARE EDGE IN 1/2" GRID - SEE FINISH TYPES
 EPGUB - EPOXY PAINT - PAINTED WITH (1) COAT PRIMER AND (2) COATS EPOXY FINISH - COLOR TO BE SELECTED BY OWNER
 EXP - EXPOSED STRUCTURE - PAINT EXPOSED STRUCTURE (1) COAT PRIMER AND (2) COATS FINISH - COLOR TO BE SELECTED BY OWNER

NEW DESIGN
KITCHEN (1/A11)
FLOOR

- RED QUARRY TILE, 6" x 6" FABRIC ABRASIVE
- RED QUARRY TILE BULLNOSE AROUND DRAINS WHEN NEEDED

WALL

- QUARRY TILE, 6" x 6" AND FRP SEE 2/A11

WALL BASE

- QUARRY TILE, 6" x 6"

GROUT

- EPOXY GROUT, LATOCRETE SPECTRALOCK 1000 MIDNIGHT BLACK

CEILING

- 2' x 4' SMOOTH PRO CEILING TILE
- ACCENT WALL (3/A11)
- 17'x24' SHOUSSCAPE, CURRENT SH-11

CAN WASH (2/A11)
FLOOR

- RED QUARRY TILE, 6" x 6" FABRIC ABRASIVE
- RED QUARRY TILE BULLNOSE AROUND DRAINS WHEN NEEDED

WALL

- QUARRY TILE, 6" x 6" AND FRP SEE 2/A11

WALL BASE

- QUARRY TILE, 6" x 6"

GROUT

- EPOXY GROUT, LATOCRETE SPECTRALOCK 1000 MIDNIGHT BLACK

CEILING

- 2' x 4' SMOOTH PRO CEILING TILE
- ACCENT WALL (3/A11)
- 17'x24' SHOUSSCAPE, CURRENT SH-11

DINING AREA (4/A11)
FLOOR

- OPTION 1 - STAINED CONCRETE
- OPTION 2 - 15' x 15' COTTO CONTEMPOR CO3 WALL STREET, INSTALLED DIAGONALLY
- FULL HGT WALL: HILLHOUSE, TEAK, H403, 6" x 36", 5 FT BEAD BOARD
- KNEE WALL: HILLHOUSE, TEAK, H403, 6" x 36"
- DRIVE THRU WALL: HILLHOUSE, TEAK, H403, 6" x 36" FULL HEIGHT
- TRIM: SCHLUTER ABE100 - FINISH EDGE OF WALL TILE

GROUT

- CUSTOM #60 CHARCOAL

CEILING

- EXPOSED STRUCTURE PAINT COLOR: BLACK
- EXPOSED DUCT: GALVANIZED
- WALL CROWN MOLDING
- PAINT COLOR: SHERWIN WILLIAMS SITE WHITE (501010)

RESTROOMS (5-A11)
FLOOR

- FOREST PARK, BLACKWOOD, FP93, 9' x 36"
- SCHLUTER ABE100 IN DOOR THRESHOLD

WALL

- ANNAPOLIS, SAIL, BEVELED, 6" x 16", 11 ROUS HIGH FROM TOP OF BASE
- SHOUSSCAPE, CURRENT SH-11, 17' x 24", ACCENT BEHIND MIRROR FULL HEIGHT - VERIFY PATTERN WITH OWNER

WALL BASE

- 2 ROUS BASE FOREST PARK, BLACKWOOD, FP93, 9' x 36"

EDGE TRIM

- SCHLUTER ABE100 USED TO FINISH EDGE OF WALL TILE

GROUT

- CUSTOM #60 CHARCOAL

CEILING

- 5/8" GUB - EPOXY PAINT COLOR: SHERWIN WILLIAMS SITE WHITE (501010)

DOOR

- STAIN BIRCH CLEAR
- DOOR FRAME PAINT COLOR: BATTLESHIP GRAY

FLOOR TRANSITION STRIP (FTS)

- SCHLUTER RAMP AERP125B90

RUSTIC DESIGN
KITCHEN (1/A11)
FLOOR

- RED QUARRY TILE, 6" x 6" FABRIC ABRASIVE
- RED QUARRY TILE BULLNOSE AROUND DRAINS WHEN NEEDED

WALL

- RED QUARRY TILE, 6" x 6"
- RED QUARRY TILE BASE

GROUT

- EPOXY GROUT, LATOCRETE SPECTRALOCK 1000 MIDNIGHT BLACK

CEILING

- 2' x 4' SMOOTH PRO CEILING TILE
- ACCENT WALLS (3/A11)
- 17'x24' SHOUSSCAPE, CURRENT SH-11

CAN WASH (2/A11)
FLOOR

- RED QUARRY TILE, 6" x 6" FABRIC ABRASIVE
- RED QUARRY TILE BULLNOSE AROUND DRAINS WHEN NEEDED

WALL

- QUARRY TILE, 6" x 6" AND FRP SEE 2/A11

WALL BASE

- QUARRY TILE, 6" x 6"

GROUT

- EPOXY GROUT, LATOCRETE SPECTRALOCK 1000 MIDNIGHT BLACK

CEILING

- 2' x 4' SMOOTH PRO CEILING TILE
- ACCENT WALLS (3/A11)
- 17'x24' SHOUSSCAPE, CURRENT SH-11

DINING AREA (4/A11)
FLOOR

- OPTION 1 - STAINED CONCRETE
- OPTION 2 - 15' x 15' COTTO CONTEMPOR CO3 WALL STREET, INSTALLED DIAGONALLY
- FULL HGT WALL: 6" x 36" SADDLE BROOK, WALNUT CREEK SD15, 5 FT BEAD BOARD
- KNEE WALL
- DRIVE THRU WALL
- TRIM: SCHLUTER ABE100 USED TO FINISH EDGE OF WALL TILE

GROUT

- CUSTOM #60 CHARCOAL

CEILING

- EXPOSED STRUCTURE PAINT COLOR: BLACK
- EXPOSED DUCT: GALVANIZED
- WALL CROWN MOLDING
- PAINT COLOR: SHERWIN WILLIAMS SITE WHITE (501010)

RESTROOMS (5-A11)
FLOOR

- FOREST PARK, BLACKWOOD, FP93, 9' x 36"

GROUT

- CUSTOM #60 CHARCOAL

WALL

- ANNAPOLIS, APO1 SAND, GLOS, 6" x 16", 11 ROUS HIGH FROM TOP OF WALL BASE
- PEBBLES BROWN, FP18, 17' x 17", ACCENT FROM TOP OF 8NK BEHIND MIRROR TO FULL HEIGHT

WALL BASE

- 2 ROUS BASE - FOREST PARK, BLACKWOOD, FP93, 9' x 36"

EDGE TRIM

- SCHLUTER ABE100 USED TO FINISH EDGE OF WALL TILE

GROUT

- CUSTOM #60 CHARCOAL

CEILING

- 5/8" GUB EPOXY PAINT COLOR: SHERWIN WILLIAMS SITE WHITE (501010)

DOOR

- STAIN BIRCH CLEAR
- DOOR FRAME PAINT COLOR: BATTLESHIP GRAY

FLOOR TRANSITION STRIP (FTS)

- SCHLUTER RAMP AERP125B90

NEW DESIGN
KITCHEN (1/A11)
FLOOR

- RED QUARRY TILE, 6" x 6" FABRIC ABRASIVE
- RED QUARRY TILE BULLNOSE AROUND DRAINS WHEN NEEDED

WALL

- QUARRY TILE, 6" x 6" AND FRP SEE 2/A11

WALL BASE

- QUARRY TILE, 6" x 6"

GROUT

- EPOXY GROUT, LATOCRETE SPECTRALOCK 1000 MIDNIGHT BLACK

CEILING

- 2' x 4' SMOOTH PRO CEILING TILE
- ACCENT WALLS (3/A11)
- 17'x24' SHOUSSCAPE, CURRENT SH-11

CAN WASH (2/A11)
FLOOR

- RED QUARRY TILE, 6" x 6" FABRIC ABRASIVE
- RED QUARRY TILE BULLNOSE AROUND DRAINS WHEN NEEDED

WALL

- QUARRY TILE, 6" x 6" AND FRP SEE 2/A11

WALL BASE

- QUARRY TILE, 6" x 6"

GROUT

- EPOXY GROUT, LATOCRETE SPECTRALOCK 1000 MIDNIGHT BLACK

CEILING

- 2' x 4' SMOOTH PRO CEILING TILE
- ACCENT WALLS (3/A11)
- 17'x24' SHOUSSCAPE, CURRENT SH-11

DINING AREA (4/A11)
FLOOR

- OPTION 1 - STAINED CONCRETE
- OPTION 2 - 15' x 15' COTTO CONTEMPOR CO3 WALL STREET, INSTALLED DIAGONALLY
- FULL HGT WALL: 6" x 36" SADDLE BROOK, WALNUT CREEK SD15, 5 FT BEAD BOARD
- KNEE WALL
- DRIVE THRU WALL
- TRIM: SCHLUTER ABE100 USED TO FINISH EDGE OF WALL TILE

GROUT

- CUSTOM #60 CHARCOAL

CEILING

- EXPOSED STRUCTURE PAINT COLOR: BLACK
- EXPOSED DUCT: GALVANIZED
- WALL CROWN MOLDING
- PAINT COLOR: SHERWIN WILLIAMS SITE WHITE (501010)

RESTROOMS (5-A11)
FLOOR

- FOREST PARK, BLACKWOOD, FP93, 9' x 36"

GROUT

- CUSTOM #60 CHARCOAL

WALL

- ANNAPOLIS, APO1 SAND, GLOS, 6" x 16", 11 ROUS HIGH FROM TOP OF WALL BASE
- PEBBLES BROWN, FP18, 17' x 17", ACCENT FROM TOP OF 8NK BEHIND MIRROR TO FULL HEIGHT

WALL BASE

- 2 ROUS BASE - FOREST PARK, BLACKWOOD, FP93, 9' x 36"

EDGE TRIM

- SCHLUTER ABE100 USED TO FINISH EDGE OF WALL TILE

GROUT

- CUSTOM #60 CHARCOAL

CEILING

- 5/8" GUB EPOXY PAINT COLOR: SHERWIN WILLIAMS SITE WHITE (501010)

DOOR

- STAIN BIRCH CLEAR
- DOOR FRAME PAINT COLOR: BATTLESHIP GRAY

FLOOR TRANSITION STRIP (FTS)

- SCHLUTER RAMP AERP125B90

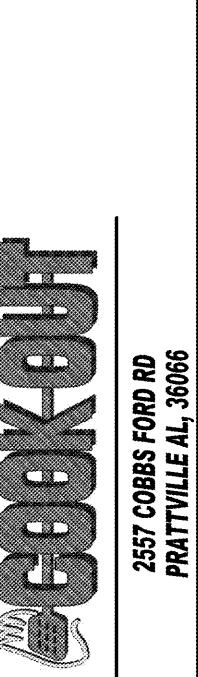
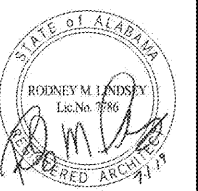

NO.	DATE	DESCRIPTION

FINISH PLAN AND SCHEDULE

DATE: 07/01/2019
 DRAWN BY: ERH
 CHECK BY: RML
 JOB NO.: 19-031
 SHEET: **A7.1**