

Order Plans

1 FLOOR FINISH PLAN
SCALE: 3/16" = 1'-0"

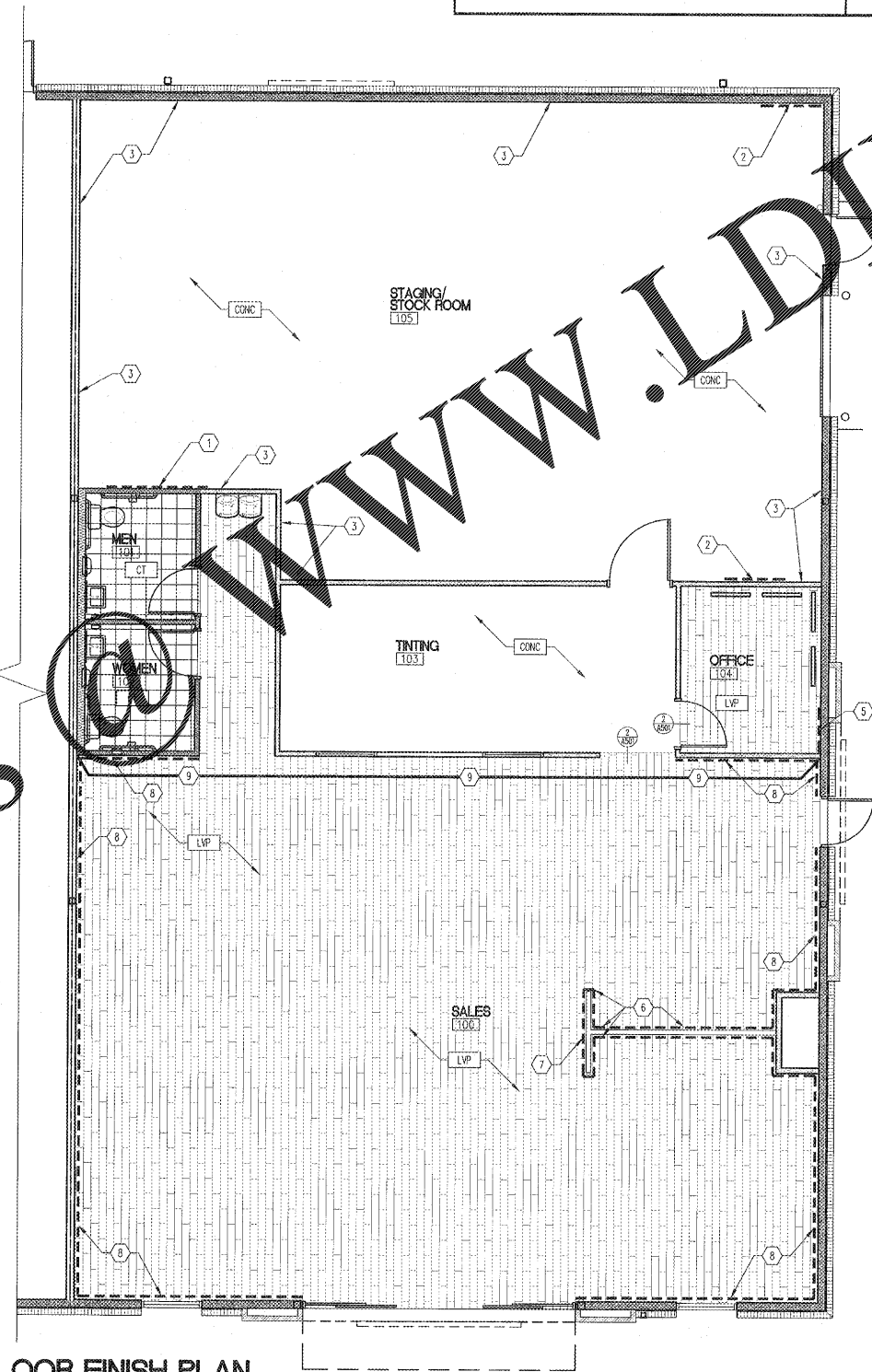

GENERAL NOTES

- GYPSUM WALLS TO RECEIVE PAINT SHALL HAVE GYPSUM WALLBOARD PRIMER APPLIED PRIOR TO PAINTING
- GYPSUM FINISH LEVELS SHALL COMPLY WITH GYPSUM ASSOCIATION GA-214
- GYPSUM WALLBOARD SHALL BE 5/8" THICK, ONLY PRODUCTS FROM A GYPSUM ASSOCIATION MEMBER COMPANY SHALL BE USED.

FLOOR LEGEND

CONC EXPOSED CONCRETE FLOORING

CT CERAMIC TILE

LVP LUXURY VINYL PLANK LAMINATE FLOORING

FLOOR FINISH NOTES

- G.C. TO INSTALL WHITE FRP BOARD MIN. 6"-8" CENTERED BETWEEN FIXTURES. INSURE ALL EDGES ARE SEALED WITH MANUFACTURERS TRIM.
- G.C. TO INSTALL 4"x4"x3/4" PLYWOOD FOR BATTERY CHARGER OR TELEPHONE/DATA. BOTTOM OF BOARD @ 36" AFF.
- G.C. TO INSTALL 2x6 PRESSURE TREATED BASE AT PERIMETER OF ROOM.
- NOT USED
- G.C. TO INSTALL 3"x3"x5/8" PLYWOOD IN CORNER. INSTALL 6" BELOW BELOW CEILING PAINT TO MATCH WALL.
- G.C. TO INSTALL 4" CROWN MOLDING ON ALL SIDES OF T WALL.
- G.C. TO INSTALL 5/8" PLYWOOD BEHIND GYP. BD. FULL EXTENT OF WALL.
- G.C. TO INSTALL 2x4 BLOCKING IN ALL PERIMETER WALLS. BLOCKING TO BE 6"-10" AFF TO CENTER. COORDINATE WITH SHELL PERMIT TO BE INSTALLED PRIOR TO INTERIOR SHEATHING.
- ACCENT WALL WITH SW7036 CITYSCAPE WALL FINISHES - SEE FINISH SCHEDULES BELOW.

WALL TYPE LEGEND

EXISTING 6" METAL STUD EXTERIOR WALL - 1/2" OSB SHEATHING ON EXTERIOR FACE OF STUDS - REFER TO EXTERIOR ELEVATIONS FOR FINISH

EXISTING BRICK VENEER

EXISTING 2 HOUR TENANT SEPARATION WALL PER UL #149

NEW METAL STUD FRAMING - SEE GENERAL FINISH NOTES ON SHEET A141

SOUND ATTENUATION

DIMENSION NOTES:

3'-0" TO FACE OF STUD

MINIMUM DIMENSION ALLOWED (MAY BE MORE)

MAXIMUM DIMENSION ALLOWED (MAY BE LESS)

ACTUAL DISTANCE BETWEEN FINAL FINISHED SURFACES

ALL DIMENSIONS ARE TO FACE OF FRAMING UNLESS OTHERWISE NOTED

TYPICAL DIMENSION WHICH MAY NOT BE ACHIEVED IN FIELD - BE AWARE OF POSSIBLE CHANGE

ALIGN THESE FINISH SURFACES

EXPOSED STRUCTURE PAINT SCHEDULE

ROOM	LOCATION	COLOR	SURFACE	PRIMER	# OF COATS	FINISH	# OF COATS
100 SALES	EXPOSED ROOF STRUCTURE	BA2902 - TINT TO SW 7035 AESTHETIC WHITE	STL	DTM ACRYLIC PRIMER B66W	1	WATERBORNE ACRYLIC DRYFALL ED-SHEL BA2 W 2 TINT	2
100 SALES	EXPOSED HVAC	BA2902 - TINT TO SW 7035 AESTHETIC WHITE	ALUM	DTM ACRYLIC PRIMER B66W	1	WATERBORNE ACRYLIC DRYFALL ED-SHEL BA2 W 2 TINT	2
			GALV MTL	DTM ACRYLIC PRIMER B66W	1	WATERBORNE ACRYLIC DRYFALL ED-SHEL BA2 W 2 TINT	2
			STL	DTM ACRYLIC PRIMER B66W	1	WATERBORNE ACRYLIC DRYFALL ED-SHEL BA2 W 2 TINT	2

PAINT SCHEDULE

ROOMS	LOCATION	COLOR	SURFACE	PRIMER	# OF COATS	FINISH	# OF COATS
100 SALES 103 STAGING	ALL WALLS EXCEPT WINDOW WALL AND T-WALL	SW 7036 ACCESSIBLE BEIGE	GWB	ROLLER OR SPRAY USE DRYWALL PRIMER INTERIOR LATEX E28 W 0800	1	EMERALD INTERIOR LATEX SATIN K37 ** EXTRA WHITE BASE	2
100 SALES	ACCENT WALL AND T-WALL	SW 7067 CITYSCAPE	GWB		1	EMERALD INTERIOR LATEX SATIN K37 ** DEEP BASE	2
104 OFFICE, 101 MEN, 102 WOMEN	ALL WALLS	SW 7036 ACCESSIBLE BEIGE	GWB	SPRAY ONLY HIGH BUILD INT LTX DRYWALL PRIMER 025WFOOD	1	EMERALD INTERIOR LATEX SATIN K37 ** EXTRA WHITE BASE	2
105 STOCKROOM	ALL FINISHED DRYWALL	WHITE	GWB		1	PRONAR 200 INTERIOR LATEX E28WELL B28 W 6000	2
100 SALES	DRYWALL CEILING	SW 7036 ACCESSIBLE BEIGE	GWB		1	EMERALD INTERIOR LATEX SATIN K37 **	2
AS APPLICABLE	DRYWALL CEILING	WHITE	GWB		1	EMERALD INTERIOR FLAT EXTRA WHITE K35 W 00351 **	2
ALL ROOMS EXCEPT WINDOW WALL AND T-WALL	DOORS AND TRIM	SW 7036 ACCESSIBLE BEIGE	MTL	PRERITE WALL AND WOOD INT OIL PRIMER B49W2	1	PROCLASSIC WATERBORNE INTERIOR ACRYLIC SEM-GLOSS ENAMEL B31 W 1150	2
100 SALES	WINDOW WALL WINDOW TRIM AND T-WALL CROWN MOLDING	SW 7035 AESTHETIC WHITE	WD	PRERITE WALL AND WOOD INT OIL PRIMER B49W2	1	PROCLASSIC WATERBORNE INTERIOR ACRYLIC SEM-GLOSS ENAMEL B31 W 1150	2
105 STOCKROOM	EXIT AND RECEIVING DOORS INSIDE AND OUTSIDE	MATCH EXTERIOR BUILDING	MTL	IF NOT FACTORY PRIMED, USE STEEL - ROM KROMK PRIMER ALUM - DTM WASH PRIMER	1	INDUSTRIAL ENAMEL B34 - CUSTOM MATCH TO BUILDING EXTERIOR	2
103 STAGING	CONCRETE FLOOR	HAZE GRAY	CONCRETE		-	B55A60 - ARMORSEAL / REXTHANE URETHANE FLOOR COATING*	2
105 STOCKROOM	CONCRETE FLOOR	HAZE GRAY	CONCRETE		-	B55A60 - ARMORSEAL / REXTHANE URETHANE FLOOR COATING*	2

* MAY APPLY FIRST COAT WITH UP TO 10% REDUCTION USING F/MS; ADD H&C SHARK-GRIP IN SECOND COAT AS ANTI-SLIP ADDITIVE.
** FOR EMERALD PRODUCTS USE ONLY ONE OF THESE ROLLER COVERS: SW 3/8" CONTRACT SERIES 100% POLYESTER OR PURDY 3/8" WHITE DOVE.

FINISH SCHEDULE

MARK	MATERIAL	MANUFACTURE	STYLE/COLOR	REMARKS
ACT	ACOUSTIC CEILING TILE	USG	FEASURED 2x2 TILE WITH SLANT EDGE, #506 WITH DA/DXL GRD	GRD AND TILE TO BE WHITE
CONC	CONCRETE	-	EXPOSED CONCRETE	SEE PAINT SCHEDULE FOR FINISH COLOR
CT	CERAMIC TILE	DAL'ILE	SALERNO ORGO PERLA #5184	12"x12" CERAMIC TILE AND 3"x12" BULLNOSE CAP; GROUT: LATIGRETE #165 DELORIAN GRAY
LVP	LUXURY VINYL PLANK LAMINATE FLOORING	MANNINGTON	NATURES PATH HERITAGE CHERRY 12103	LAY IN RANDOM PATTERN; OWNER SUPPLIED, G.C. INSTALLED
PLAM	PLASTIC LAMINATE	WILSON ART	LIMBER MAPLE 10734-60	PLAM FUR BUILT-IN DESKTOP AND SHELF
VCB	VINYL CORNER BASE	MANNINGTON	607-ACL STONE GRAY	4" HEIGHT; OWNER SUPPLIED, G.C. INSTALLED
VCT	VINYL TILE	MANNINGTON	PROGRESSIONS 55A31 OYSTER WHITE	LAY IN CHECKERBOARD PATTERN; USE MANNINGTON V-11 ADHESIVE

ROOM FINISH SCHEDULE

NOTES: SEE PAINT SCHEDULE FOR PAINT REQUIREMENTS.

ROOM	FLOOR	BASE	CERAMIC	HEIGHT	REMARKS
100 SALES	LVP AND VCT	VCB	-	OPEN TO STRUCT.	SEE FINISH PLAN; USE VINYL TRANSITION STRIPS AT CONCRETE
103 STAGING	PAINTED CONCRETE	VCB	2x2 ACT	10'-0"	INCLUDE BATT INSULATION FOR NOISE CONTROL; USE VINYL TRANSITION STRIPS AT CONCRETE
104 OFFICE	VCT	VCB	2x2 ACT	9'-0"	INCLUDE BATT INSULATION FOR NOISE CONTROL
101 MEN	CT	CT	2x2 ACT	9'-0"	INCLUDE CERAMIC WANGCOOT TO 63" AFF; INCLUDE BATT INSULATION FOR NOISE CONTROL
102 WOMEN	CT	CT	2x2 ACT	9'-0"	INCLUDE CERAMIC WANGCOOT TO 63" AFF; INCLUDE BATT INSULATION FOR NOISE CONTROL
105 STOCKROOM	PAINTED CONCRETE	2x6 PRESSURE TREATED WD	-	OPEN TO STRUCT.	PAINT ALL WALLS AND DOORS; PLYWOOD PROTECTION TO 6'-0" AFF ABOVE BASE ON ALL WALLS.

LHMT Project No. 19120.01

NO DRAWING IS THE PROPERTY OF THE ARCHITECT AND MAY NOT BE REPRODUCED OR COPIED WITHOUT HIS WRITTEN PERMISSION.

ARCHITECT ASSOCIATES

3005 Carrington Mill Blvd
Merrillville, IN 46449-9309
Phone: 813-24-0037

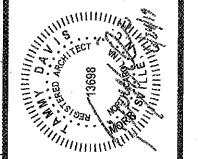

PROJECT: **SHERWIN - WILLIAMS**

4808 COUNTRY CLUB ROAD
SUITE 103
WINSTON-SALEM, NC 27104

FINISH FLOOR PLAN

Revisions

NO.	REVISION DATE

PROJECT DATE: 6/24/2019

Drawn By: MTP

Checked By: TD

Sheet No. **A131**