

VICINITY MAP
NTS

TREE SAVE AREA NOTES:

- TREE PROTECTION DURING CONSTRUCTION: TO RECEIVE CREDIT FOR EXISTING TREES PROPOSED FOR PRESERVATION, THE TSA MUST BE PROTECTED FROM DIRECT AND INDIRECT ROOT DAMAGE, TRUCK AND CROWN DISTURBANCE. THE FOLLOWING STANDARDS SHALL APPLY.
 - THE TREE SAVE AREA (TSA) SHALL INCLUDE ALL AREA LOCATED WITHIN THE CRITICAL ROOT ZONE.
 - CONSTRUCTION SITE ACTIVITIES, SUCH AS PARKING, MATERIAL STORAGE, DIRT STODGILS, CONCRETE WASHOUT, AND OTHER SIMILAR ACTIVITIES, SHALL NOT BE PERMITTED WITHIN A TREE SAVE AREA (TSA).
 - PROTECTIVE BARRIERS SHALL BE INSTALLED AROUND THE TREE SAVE AREA (TSA) AS NECESSARY PRIOR TO THE ISSUANCE OF A GRADING PERMIT.

VEGETATION:

THE FOLLOWING CRITERIA APPLY TO VEGETATION IN AND AROUND THE WET POND:

- THE DAM STRUCTURE, INCLUDING FRONT AND BACK EMBANKMENT SLOPES, OF THE POND SHALL BE VEGETATED WITH NON-CLUMPING TURF GRASS; TREES AND WOODY SHRUBS SHALL NOT BE ALLOWED, AND
- THE VEGETATED SHELF SHALL BE PLANTED WITH A MINIMUM OF THREE DIVERSE SPECIES OF HERBACEOUS, NATIVE VEGETATION AT A MINIMUM DENSITY OF 50 PLANTS PER 200 SQUARE FEET OF SHELF AREA.
- THE WET POND DESIGN INCLUDES A LANDSCAPE PLAN (SEE SHEET C-8) THAT HAS BEEN PREPARED BY A QUALIFIED DESIGN PROFESSIONAL LICENSED IN NORTH CAROLINA. THE LANDSCAPE PLAN PROVIDES SPECIFICATIONS FOR THE VEGETATION SPECIES, INSTALLATION AND THE POST-INSTALLATION CARE. THE LANDSCAPE PLAN SHALL COVER THE DAM, EMBANKMENT SLOPES AND THE VEGETATED SHELF.
- ON THE DAM AND THE DAM AND EMBANKMENT SLOPES, TURF GRASS PROVIDES STABILITY AND ENHANCES ACCESS TO THE FACILITY FOR MAINTENANCE. DEDICATED RECOMMENDED PERENNIAL GRASSES SUCH AS HYPERICUM BERBERIDIS, CENTAUREA IN THE COASTAL PLAIN AND FRIEDMONT, AND COOL SEASON TURF GRASS SUCH AS FESCUE AND BLUEGRASS IN THE MOUNTAINS. WEEPING LOVE GRASS IS NOT ALLOWED BECAUSE IT DOES NOT PROVIDE LONG-TERM SLOPE STABILIZATION.
- TREES AND WOODY SHRUBS SHALL NOT BE PLANTED ON THE DAM OR EMBANKMENT SLOPES AND ANY VOLUNTEERS SHOULD BE REMOVED AS PART OF REGULAR MAINTENANCE ACTIVITIES. HOWEVER, TREES AND SHRUBS MAY BE PLANTED OUTSIDE OF THE EMBANKMENT SLOPES AND CAN SERVE TO SHADE THE WET.
- WETLAND SEED MIXES ARE NOT ALLOWED.
- CONTRACTOR IS RESPONSIBLE TO COORDINATE INSTALLATION OF ALL PLANTING WITH CITY OF WINSTON-SALEM. ALL PLANTING SIZE AND VARIETY SHALL MEET NCDQR AND CITY OF WINSTON-SALEM SIZE AND SPECIFICATIONS. (SEE NCDQR STORMWATER MANUAL SECTION C-3 WETPOND FOR PLANT LIST.

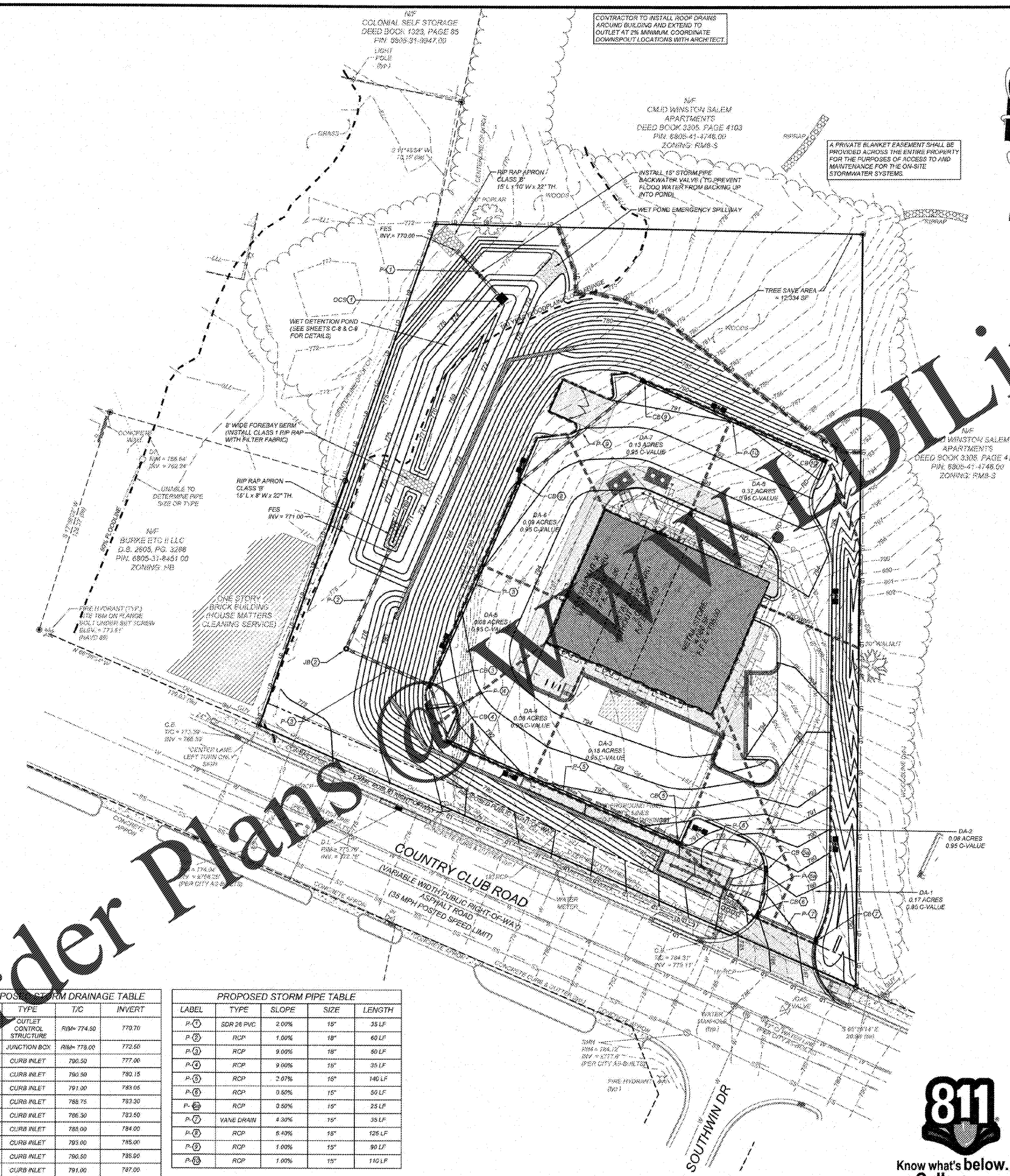

GRADING NOTES

- ALL GRADING, BACKFILLING, EXCAVATION, ETC., SHALL BE IN ACCORDANCE WITH THE RECOMMENDATIONS SET FORTH IN THE GEOTECHNICAL INVESTIGATION REPORTS. REFER TO THESE REPORTS FOR ADDITIONAL INFORMATION NOT TRANSFERRED TO THESE PLANS.
- CONTRACTOR IS TO CONTACT MISS UTILITY OF VIRGINIA AT 1-800-552-7001 FOR UNDERGROUND UTILITY LOCATION 48 HOURS PRIOR TO ANY DIGGING.
- THE EROSION CONTROL MEASURES ARE TO BE IN PLACE PRIOR TO ANY EARTHWORK.
- ALL EROSION CONTROL MEASURES SHALL BE MAINTAINED UNTIL DISTURBED AREAS ARE STABILIZED.
- ALL EROSION CONTROL FACILITIES SHALL BE INSPECTED AND REPAIRED AT A MINIMUM OF WEEKLY BASIS AND AFTER EVERY RAIN EVENT.
- ALL PAVED AREAS SHALL BE KEPT CLEAR OF EARTH MATERIALS AND DEBRIS. THE SITE SHALL BE MAINTAINED SO AS TO MINIMIZE SEDIMENT-LOADED RUNOFF TO ANY STORM DRAINAGE SYSTEM.
- CONTRACTOR SHALL LOCATE AND VERIFY THE LOCATION OF ALL UTILITIES PRIOR TO BEGINNING CONSTRUCTION.
- PURSUANT TO G.S. 113A-57(2) THE ANGLE FOR GRADED SLOPES AND FILL S SHALL BE NO GREATER THAN THE ANGLE THAT CAN BE RETAINED BY VEGETATION OR OTHER ADEQUATE EROSION CONTROL DEVICES OR STRUCTURES. IN ANY EVENT, SLOPES LEFT EXPOSED WILL, WITHIN 14 CALENDAR DAYS OF COMPLETION OF ANY PHASE OF GRADING, BE SEEDED OR OTHERWISE PROVIDED WITH TEMPORARY OR PERMANENT GROUND COVER. DEVICES OR STRUCTURES SUBJECT TO RESTRAIN EROSION. PURSUANT TO G.S. 113A-57(3), PROVISION FOR PERMANENT GROUND COVER SUFFICIENT TO RESTRAIN EROSION MUST BE ACCOMPLISHED FOR ALL DISTURBED AREAS WITHIN 15 WORKING DAYS FOLLOWING COMPLETION OF CONSTRUCTION OF THE DEVELOPMENT.
- ALL CUT AND FILL SLOPES AND CHANNEL SLOPES WHICH ARE NOT TO BE SEED, SHALL BE SEED UNTIL A GOOD STAND OF GRASS IS OBTAINED IN ACCORDANCE WITH:
 - 100 LBS PER 1,000 SQUARE FEET OF GRASS SEED OR EQUIVALENT. NO SOIL TEST REQUIRED FOR INITIAL SEEDING ONLY.
 - 20 LBS OF 10-10-10 FERTILIZER PER 1,000 SQUARE FOOT.
 - VARIETIES TO BE SEED:
 - SPRING SEEDING - APRIL 1 - APRIL 30; SPRING OATS 2.5 LBS PER 1,000 SQUARE FOOT.
 - SUMMER SEEDING - MAY 1 - AUGUST 1; WEEPING LOVE GRASS AT 2 OZ PER SQUARE FOOT MIXED WITH 1 BUSHEL OF MANURE FOR UNIFORM SEEDING.
 - SPRING MULCH & GALLONS PER 1,000 SQUARE FOOT. ALL SEEDING WILL BE MULCHED.
- LANDSCAPE PLAN FOR PERMANENT SEEDING.
- UNLESS OTHERWISE SPECIFIED ON THESE PLANS, ALL STORM DRAINAGE PIPES ARE TO BE RCP CLASS III.

PERMANENT SEEDING SPECIFICATION

As a minimum requirement, all graded areas not under pavement and within the right-of-way and/or easements shall be prepared, fertilized and limed, seeded, and mulched immediately upon completion of construction as follows (Application rate PER 1,000 SQUARE FEET):

Type I Seeding (Lawns or other focal areas)
 100 lbs. of lime
 20 lbs. of 10-20-20 or 20 lbs. of 10-10-10 in combination with 4 lbs of 0-46-0
 5 lbs. of tall fescue, containing a blend of 2 or more tall fescues
 1 lb. of Kenblue or Kentucky Bluegrass
 1 lb. of winter annual rye (November 1 to March 1)

Type II Seeding (General or low maintenance areas)
 100 lbs. of lime
 15 lbs. of 10-20-20 or 15 lbs. of 10-10-10 in combination with 3 lbs. of 0-46-0
 4 lbs. of tall fescue, containing a blend of 2 or more tall fescues
 1 lb. of sericea lespedeza (use unscarified seed August 15 to February 1)
 1/4 lb. of German millet (May 1 to August 15)
 1 lb. of rye grain (prior to May 1 or after August 15)

Seeding mixtures other than those listed above must be approved by the City Inspector prior to seeding.

Order Plans

GRADING LEGEND

- TF TREE PROTECTION FENCE
- LD LIMITS OF DISTURBANCE
- FLARED END SECTION
- DROP INLET
- CURB INLET
- STORM PIPE
- TOP OF CURB
- BOTTOM OF CURB
- HANDICAP AREA (2% MAX. SLOPE)
- SPILL CURB
- GROUND AT TOP OF WALL
- GROUND AT BOTTOM OF WALL
- INLINE DRAIN
- ROOF DRAIN

PROPOSED STORM DRAINAGE TABLE

LABEL	TYPE	T/C	INVERT
CE(1)	OUTLET CONTROL STRUCTURE	RIM= 774.50	770.70
JB(2)	JUNCTION BOX	RIM= 773.00	773.50
CB(3)	CURB INLET	790.50	777.06
CB(4)	CURB INLET	790.50	780.15
CB(5)	CURB INLET	791.00	783.05
CB(6)	CURB INLET	788.75	783.30
CB(7)	CURB INLET	786.50	783.50
CB(8)	CURB INLET	788.00	784.00
CB(9)	CURB INLET	793.00	785.00
CB(10)	CURB INLET	790.50	785.50
CB(11)	CURB INLET	791.00	787.00

PROPOSED STORM PIPE TABLE

LABEL	TYPE	SLOPE	SIZE	LENGTH
P(1)	SDR 26 PVC	2.00%	18"	35 LF
P(2)	RCP	1.00%	18"	60 LF
P(3)	RCP	9.00%	18"	50 LF
P(4)	RCP	9.00%	15"	35 LF
P(5)	RCP	2.07%	15"	140 LF
P(6)	RCP	0.50%	15"	50 LF
P(7)	RCP	0.50%	15"	25 LF
P(8)	VANE DRAIN	4.30%	15"	35 LF
P(9)	RCP	5.40%	18"	125 LF
P(10)	RCP	1.00%	15"	90 LF
P(11)	RCP	1.00%	15"	110 LF



Know what's below.
Call before you dig.
nc811.org or 1-800-632-4949

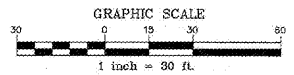
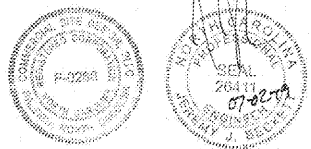

REVISIONS	CITY COMMENTS	UPDATE BUILDING AREAS	CITY COMMENTS #2	NO.	DATE	DESCRIPTION	BY
	1	06-14-19	2	06-20-19	3	06-26-19	

COMMERCIAL
SITE DESIGN

(978) 848-6621 FAX: (978) 848-7941
WWW.CSDDESIGN.COM

CLIENT:	GEMCAP DEVELOPMENT 210 WEST FOURTH STREET SUITE 200 WINSTON-SALEM, NC 27101
PROJECT NO:	GEM-1808
FILENAME:	GEM1808-GP
DRAWN BY:	RCN
SCALE:	1" = 30'
DATE:	01-17-19
SHEET NO:	C-3

RETAIL DEVELOPMENT
4809 COUNTRY CLUB ROAD
WINSTON-SALEM, NORTH CAROLINA

STORM WATER MANAGEMENT PLAN