

ODA
overcash demmitt

2010 south tryon st. suite 1a
charlotte north carolina 28203
office .704.332.1615
web.www.odarch.com

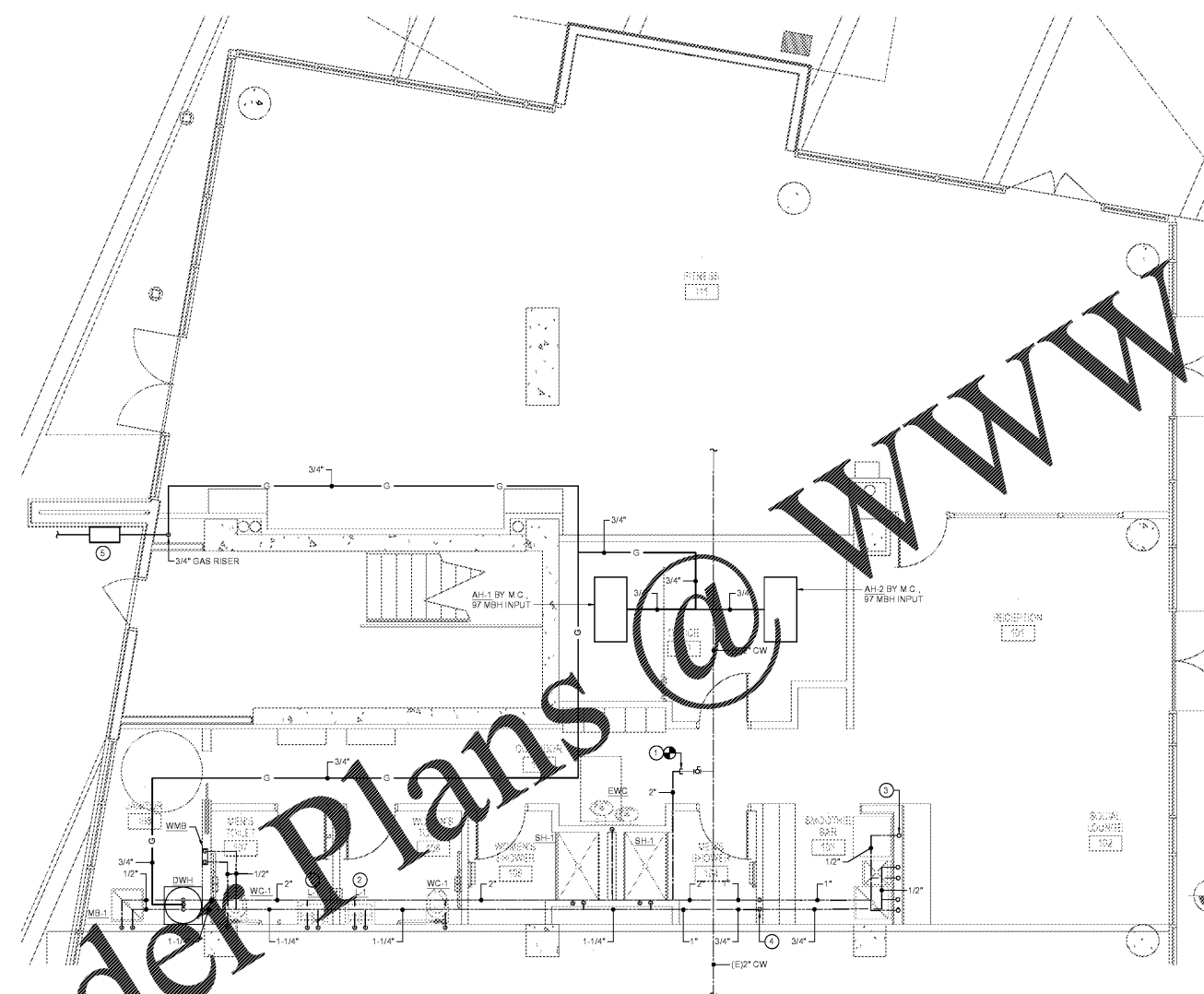

Order Plans @ www.LDILine.com



1 PLUMBING WATER AND GAS PLAN
SCALE 1/4" = 1'-0"

KEYED NOTES THIS SHEET

1. EXTEND NEW CW PIPING AND CONNECT TO EXISTING CW PIPING CAPRED IN THIS AREA. VERIFY EXACT LOCATION AND SIZE OF EXISTING PIPING IN FIELD.
2. IN LIEU OF SPECIFIED P-TRAP, PROVIDE JAY R. SMITH MODEL 2698-1 PRIME-EZE WATER SAVER TRAP PRIMER P-TRAP WITH CLEANOUT PLUG AND PRIMER HOSE. CONNECT 1/2" TRAP PRIMER LINE TO PRIMER HOSE. DROP DOWN IN WALL TO BELOW FLOOR, AND EXTEND BELOW FLOOR TO CONNECTION ON FLOOR DRAIN.
3. CONNECT 1/2" CW TO ICE MACHINE WITH BALL VALVE AND WATTS SERIES LFY DUAL CHECK VALVE. VERIFY EXACT LOCATION AND SIZE OF CONNECTION WITH EQUIPMENT SUPPLIER.
4. DROP 3/4" HW AND 1" CW PIPING DOWN IN WALL TO BELOW FLOOR. ROUTE 3/4" HW AND 1" CW PIPING BELOW FLOOR TO SMOOTH AREA AND CONNECT TO EQUIPMENT. VERIFY EXACT ALL REQUIREMENTS WITH EQUIPMENT SUPPLIER.
5. COORDINATE WITH LOCAL GAS AUTHORITY FOR SERVICE AND METER ASSEMBLY. SEE GAS SECTION IN GENERAL NOTES ON SHEET P-001 FOR SIZING CRITERIA.

GENERAL NOTES THIS SHEET

1. SEE FIXTURE SCHEDULE ON SHEET P-001 FOR SIZES OF DOMESTIC WATER CONNECTIONS TO INDIVIDUAL FIXTURES.
2. ALL DOMESTIC WATER PIPING AND ALL NATURAL GAS PIPING SHOWN ON THIS SHEET SHALL BE RUN ABOVE CEILINGS IN AREAS WITH CEILINGS AND SHALL BE RUN AS HIGH AS POSSIBLE IN AREAS WITHOUT CEILINGS, UNLESS OTHERWISE NOTED.
3. THE PLUMBING CONTRACTOR SHALL FIELD VERIFY EXISTING CONDITIONS INCLUDING DIRECTION OF FLOW, INVERTS, AND TIE-IN LOCATIONS PRIOR TO ROUTING ANY PIPING. SAWCUT EXISTING SLAB, WALL, OR CEILING CONSTRUCTION AS REQUIRED. AREAS TO BE SAWCUT SHALL BE APPROVED BY ARCHITECT PRIOR TO CUTTING. ALL SAWCUT AND ALTERED SURFACES SHALL BE FILLED, PATCHED, PAINTED, AND REPAIRED TO MATCH ADJACENT SURFACES.

Hustle House

ODA Project No. 183324
Charlotte, NC

FOR CONSTRUCTION

06.28.2019

REVISIONS		
No.	Description	Date

PLUMBING WATER AND GAS PLAN

P-102