

Order Plans @ WWW.WLDILING.COM

REFLECTED CEILING PLAN SYMBOL LEGEND

	NEW ACOUSTICAL CEILING GRID; SEE FINISH ROOM SCHEDULE FOR SPECIFICATION. CENTER IN EACH ROOM IN WHICH LOCATED.
	GYPSUM CEILING/ GYPSUM SOFFIT
	ACOUSTICAL CEILING SURFACE MOUNTED WALL WASHER
	LINEAR PENDANT INDIRECT/DIRECT FIXTURES; MOUNT BOTTOM @ 8'-6" AFF
	LINEAR RECESSED FIXTURES IN ACT CLNG
	LINEAR PENDANT FIXTURES; MOUNT @ 8'-6" AFF
	DECORATIVE PENDANT; MOUNT BOTTOM @ 8'-6" AFF
	DECORATIVE PENDANT; MOUNT BOTTOM @ 8'-0" AFF
	DECORATIVE PENDANT; MOUNT BOTTOM @ 7'-0" AFF
	DECORATIVE PENDANT; MOUNT BOTTOM @ 7'-0" AFF
	WALL SCONCE; COORDINATE POWER LOCATION AFF WITH FIXTURE
	FLOOR LAMP
	LED STRIP LIGHT IN COVE AND UNDERCOUNTER LIGHT
	CABLE LIGHTS RUNNING BETWEEN SOFFITS; MOUNT CABLE AT 9'-0" AFF
	FIRE PROTECTION HEADS; REFERENCE FIRE PROTECTION DRAWINGS FOR ADDITIONAL INFORMATION. NOTE: WHITE COVE DETECT HEADS IN GYPSUM BOARD CEILINGS.

REFLECTED CEILING PLAN NOTES

- ALL CEILINGS ARE NEW AND AT NOTED HEIGHTS ON PLAN.
- ALL LIGHTS ARE DIMENSIONED FOR LOCATION ON PLAN UNLESS LOCATED IN ACOUSTICAL CEILING GRID. IF QUESTION, CONSULT DESIGNER.
- ALL PENDANT HUNG FIXTURES, SEE ALSO ELEVATION SHEETS FOR HEIGHT OFF FINISHED FLOOR.
- LIGHT FIXTURES SHALL BE CENTERED IN CEILING TILE UNLESS NOTED OTHERWISE.
- CEILING STRUCTURE, INCLUDING CONDUIT, SPRINKLER PIPE AND HVAC DUCT TO BE PAINTED.
- SEE ELECTRICAL PLAN FOR SWITCHING, EXT SIGNS, AND EMERGENCY LIGHTS.
- ALL DEVICES TO BE WHITE ON PBLT WALLS, WHITE ON LIGHT ACCENT PAINT OR VWC WALLS, BLACK ON ACCENT PAINT OR TILE WALLS.
- SEE MECHANICAL PLAN FOR LOCATION OF THERMOSTATS AND REMOTE SENSORS.
- THERMOSTATS TO BE WHITE IN COLOR.
- SWITCHES SHALL BE MOUNTED 8" TO CENTERLINE OF SWITCH FROM LATCH JAMB OF DOOR, UNO.
- GROUPED SWITCHES SHALL BE MOUNTED WITHIN A SINGLE FACEPLATE, UNO.
- MINIMUM CEILING HEIGHT ALONG ACCESSIBLE ROUTE SHALL BE 9'0" AFF (PER ANSI GUIDELINES).
- PROVIDE REQUIRED ACCESS PANELS IN CEILING FOR MECHANICAL, ELECTRICAL, AND PLUMBING SYSTEMS. LOCATION, COLOR AND TYPE OF ACCESS PANEL SHALL BE VERIFIED WITH DESIGNER PRIOR TO CONSTRUCTION.
- PENETRATIONS AND OPENINGS IN CEILING FOR FIXTURES OR MECHANICAL SYSTEM PATHS AND REGISTERS SHALL BE PRECISELY CUT FOR INSTALLED ITEMS WITH EDGES TO BE CONCEALED BY MOUNTING TRIM OR COVER.
- CONTRACTOR TO REMOVE DEBRIS OR MATERIAL FROM ABOVE CEILING PRIOR TO FINAL CLEANING. GENERAL CONTRACTOR IS RESPONSIBLE FOR DAMAGES CAUSED BY DEBRIS OR UNSECURED MATERIAL ABOVE FINISHED CEILING.
- FIXTURES AND REGISTERS SHALL ALIGN SQUARE AND LEVEL WITH FINISHED CEILING.
- INSPECTION AND APPROVAL OF ABOVE CEILING SYSTEMS BY MUNICIPAL ENGINEER PRIOR TO MANUFACTURE, OR MAINTENANCE REQUIREMENTS SHALL OCCUR PRIOR TO ANY CEILING TO WARRANT PROPER INSTALLATION AND OPERATION.
- PENETRATIONS OF PARTITIONS FOR MECHANICAL SYSTEMS SHALL BE PROTECTED BY SEALERS. PENETRATIONS WITHIN RATED PARTITION ASSEMBLIES SHALL PROTECT OR REINFORCE DIAPHRAGM DEVICES, SLEEVES, SMOKE DETECTORS AND FIREPROOFING TO MAINTAIN APPROVED RATING.
- JUNCTION BOXES, SHUTOFFS OR CLEANOUTS ARE TO BE INSTALLED IN ACCESSIBLE PANELS IN GWB CEILINGS. COORDINATE WITH ARCHITECT IF CONFLICTS.
- WHERE LIGHTS AND DUCTWORK CROSS, PROVIDE UPRIGHT ANCHOR ROD TO SUPPORT LIGHTS AROUND DUCTWORK.
- LIGHT LOCATIONS TAKE PRECEDENCE OVER MECHANICAL LINES AND SECONDARY HVAC DUCT.

REFLECTED CEILING PLAN KEY NOTES

R1	UNDERCOUNTER LIGHT AT UPPER OFFICES
R2	2X8 STAFFED MECH RAFTERS AND STRINGERS; SEE ALSO ELEVATIONS
R3	CENTER LIGHTING IN ROOM AND/OR ON FURNITURE/MILLWORK
R4	CEILING SOFFIT TO BE 1'-0" AFF
R5	GWB SOFFIT TO BE 8'-0" AFF
R6	LIGHT COVE; SEE DETAIL 2/A1.03
R7	SCONCE TO BE CENTERED ON WALL LEFT/RIGHT; COORDINATE POWER LOCATION AFF WITH FIXTURES
R8	4 7/8" SOFFIT TRANSITION AT LIGHT COVE TO ACT

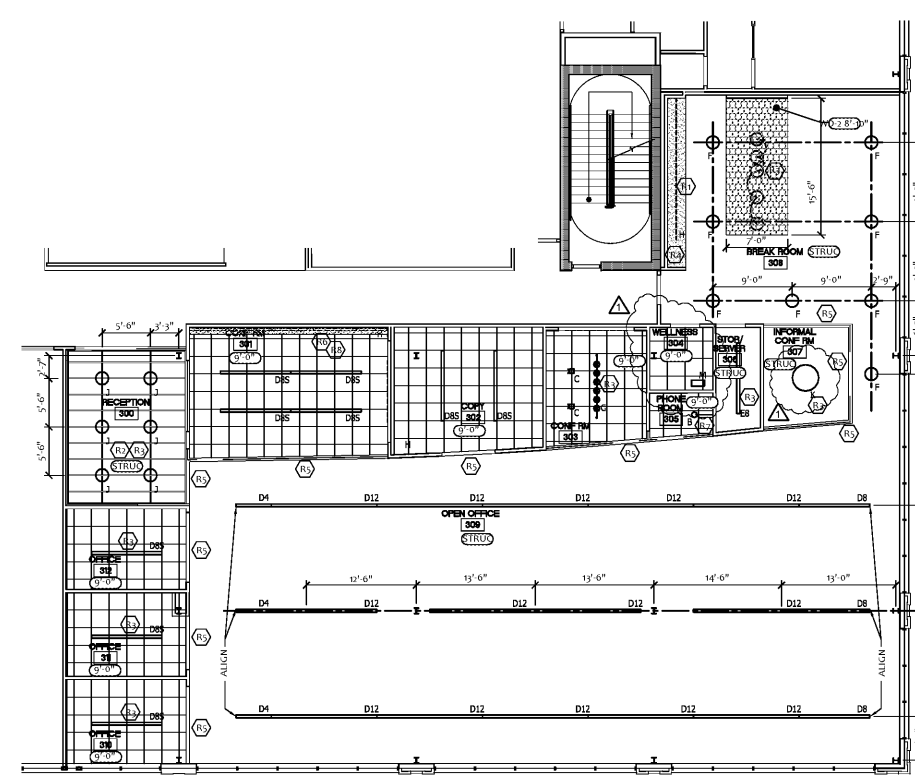
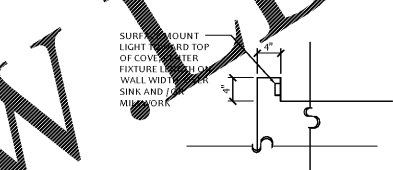

**NOVUS**  
*always new*  
1950 ABBOTT STREET, STE 605  
CHARLOTTE, NC 28203  
704-373-3101  
FAX 704-373-3103  
WWW.NOVUSARCHITECTS.COM

**carrie frye**  
interior design  
2126 CHARLOTTE DR.  
CHARLOTTE, NC 28203  
704-996-7705  
WWW.CFDESIGNSTUDIO.COM

**BR+A**

BR+A  
300 West Summit  
Office Bldg

300 West Summit Ave.  
Suite #310  
Charlotte, NC 28203

PROJECT NUMBER: 19-018  
CONSTRUCTION ISSUE: 6.20.2019  
CLARIFICATIONS 2019.07.03

REFLECTED CEILING  
PLAN & NOTES

**A1.03**