

N:\Active Projects\Hospitality\018 Holiday Inn Express - Wilson, NC\Drawings CAD-Rev\18-176.rvt

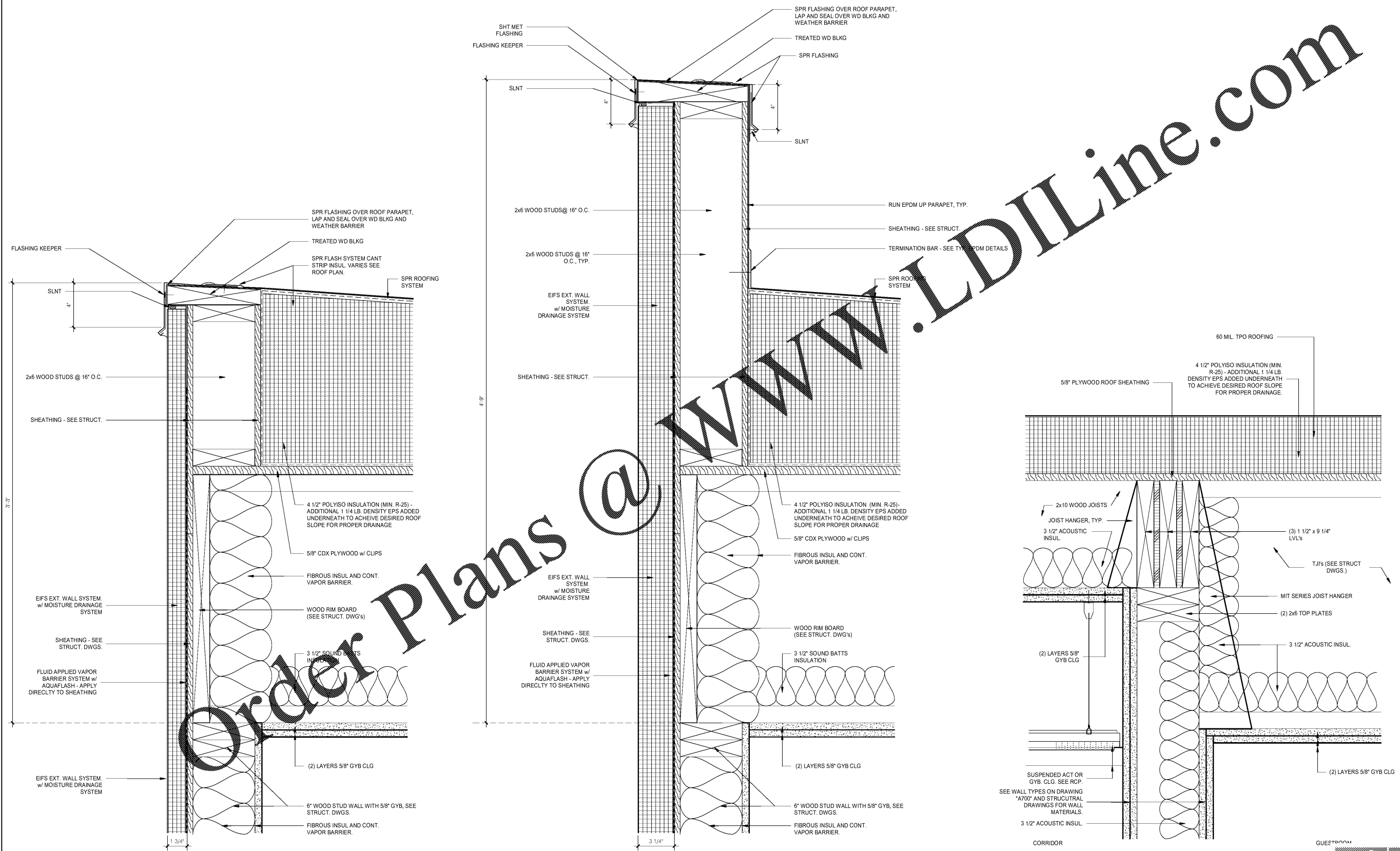

1 EXTERIOR WALL/ROOF TYPICAL LOAD BEARING  
3' = 1'-0'

2 EXTERIOR WALL/ROOF TYPICAL LOAD BEARING @ LOW PARAPET  
3' = 1'-0'

3 INTERIOR WALL/ROOF TYPICAL CORRIDOR  
3' = 1'-0'

MEISTER-COX ARCHITECTS

INFO@MEISTER-COX.COM  
PHONE: 610-375-1331 FAX: 610-375-4655  
1522 PENN AVENUE WYOMISSING, PA 19610  
WWW.MEISTER-COX.COM

TYPICAL ROOF DETAILS

HOLIDAY INN EXPRESS & SUITES  
INTERSECTION OF HAYNES PLACE & LAMM RD.  
WILSON, NC 27893

STATUS: BIDDING  
PROJ. DATE: 06-07-19  
PROJ. NO: 18-176  
PRINTED: 6/7/2019 7:11:59 PM  
DRAWN BY: Author  
CHECKED BY: Checker  
SHEET NO. A542  
SCALE: 3" = 1'-0"



No.	Description	Date

DISCLAIMER: PC is providing, by agreement with certain parties, materials stored electronically. The parties recognize that data, plans, specifications, reports, drawings, and other documents are subject to alteration, deletion, or modification. The parties warrant that the electronic documents are accurate as of the date of creation, transmission, conversion, media degradation, software error or human alteration. Accordingly, all such documents are provided as a service and not as a record. Any reliance herein is deemed to be solely on the original hard copies of the Architect's instruments of service and not on these documents of record.