

1 STAIR 1 PLAN LEVEL 1
1/4" = 1'-0"

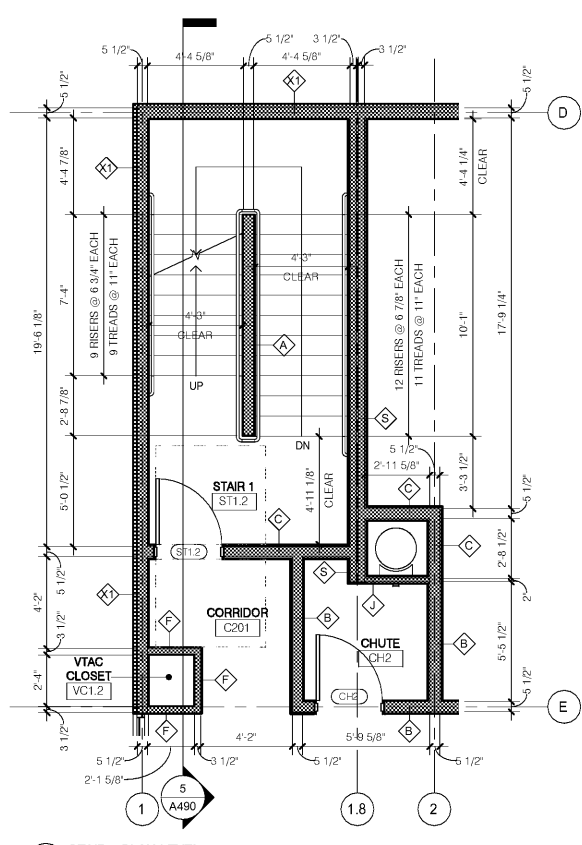

2 STAIR 1 PLAN LEVEL 2
1/4" = 1'-0"

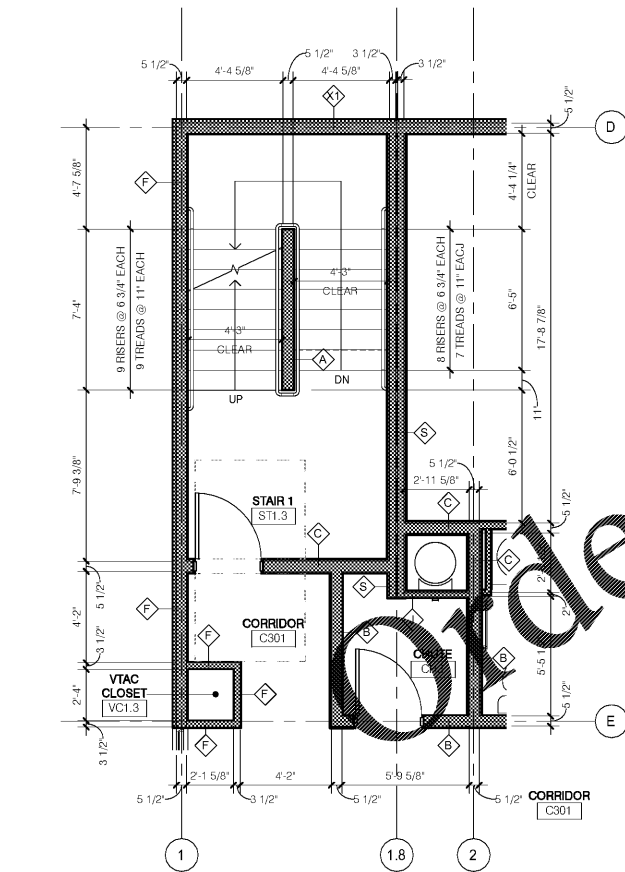

3 STAIR 1 PLAN LEVEL 3
1/4" = 1'-0"

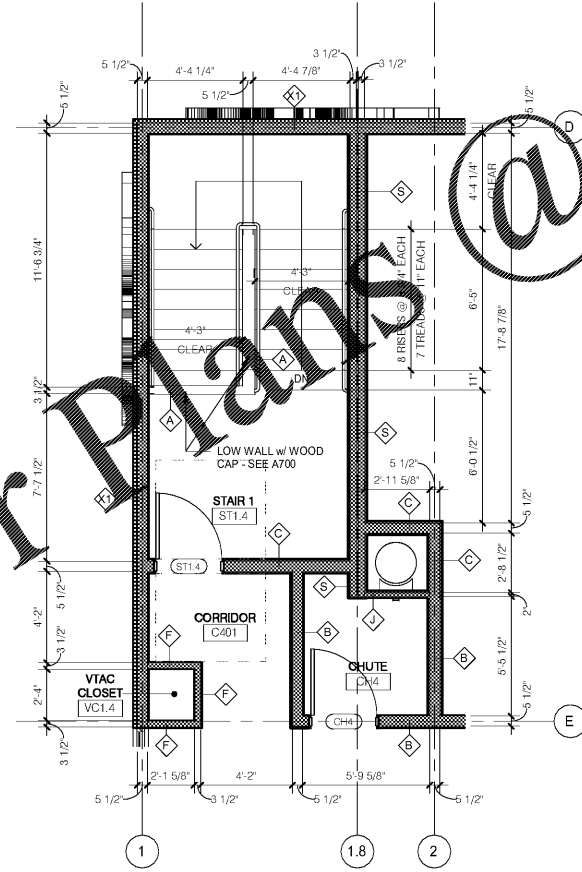

4 STAIR 1 PLAN LEVEL 4
1/4" = 1'-0"

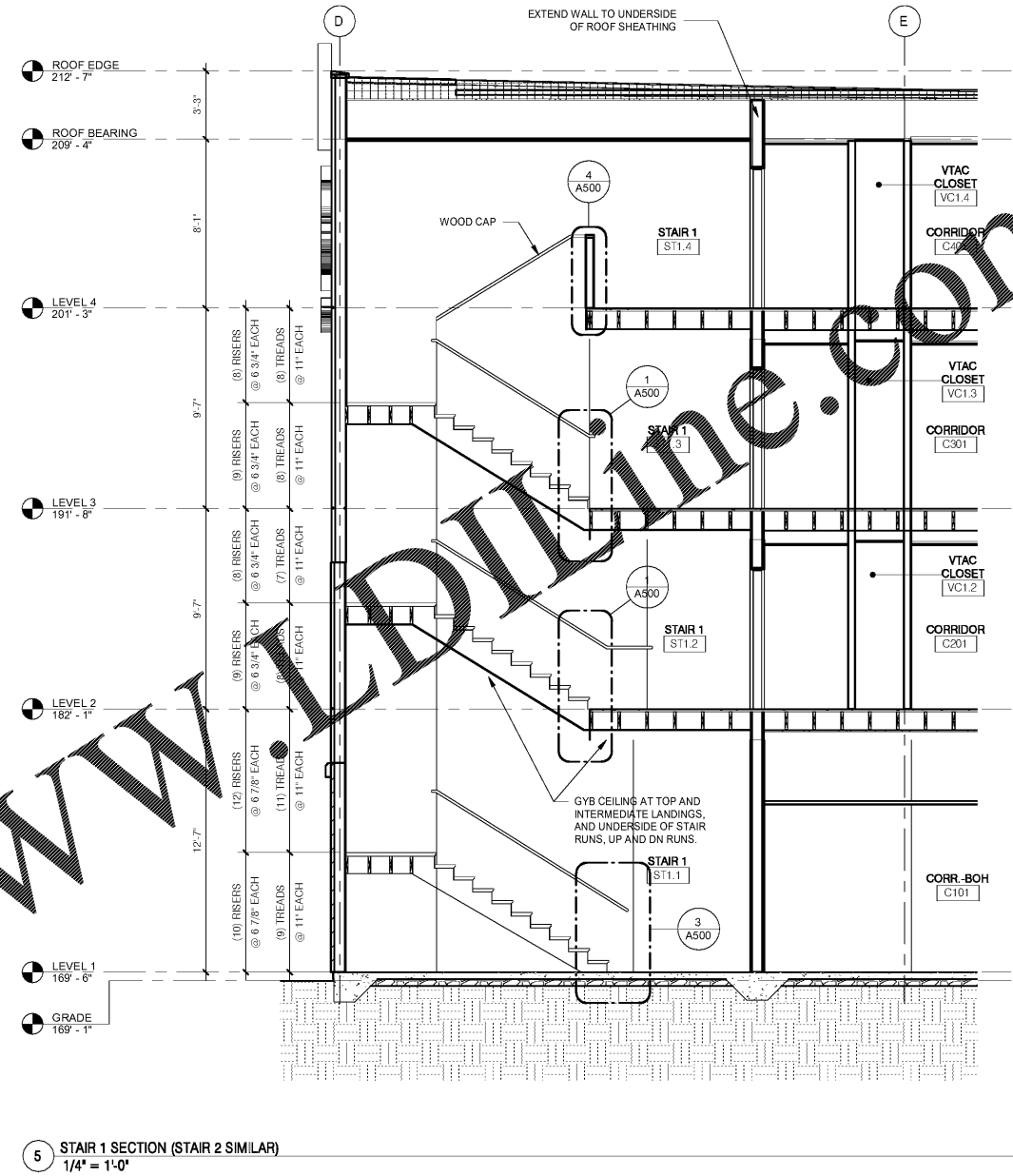

5 STAIR 1 SECTION (STAIR 2 SIMILAR)
1/4" = 1'-0"

Order Plans @

WWW.LDLINE.COM

No.	Description	Date

DISCLAIMER: This drawing is provided by agreement with certain parties. Materials shown electronically. The parties recognize that data, plans, specifications, reports, drawings, and other documents are subject to modification, correction, transmission, conversion, media degradation, software error or human alteration. Accordingly, all such documents are not to be used as a record or as a record document. Any reliance thereon is deemed to be the user's responsibility. Strapped hard copies of the Architect's instruments of service are the only true documents of record.

MEISTER COX ARCHITECTS

INFO@MEISTER-COX.COM
 PHONE: 610-375-1331 FAX: 610-375-4655
 1522 PENN AVENUE WYOMISSING, PA 19310
 WWW.MEISTER-COX.COM

STAIR 1 PLANS AND SECTION

HOLIDAY INN EXPRESS & SUITES
 INTERSECTION OF HAYNES PLACE & LAMM RD.
 WILSON, NC 27893

STATUS: BIDDING
 PROJ. DATE: 06-07-19
 PROJ. NO: 18-176
 PRINTED: 6/7/2019 7:11:36 PM
 DRAWN BY: RFF
 CHECKED BY: TGC

SHEET NO.
A490
 SCALE: 1/4" = 1'-0"

