

N:\Active Projects\hospitality\2018 Holiday Inn Express - Wilson, NC\Drawings CAD-Rev\18-176.rvt

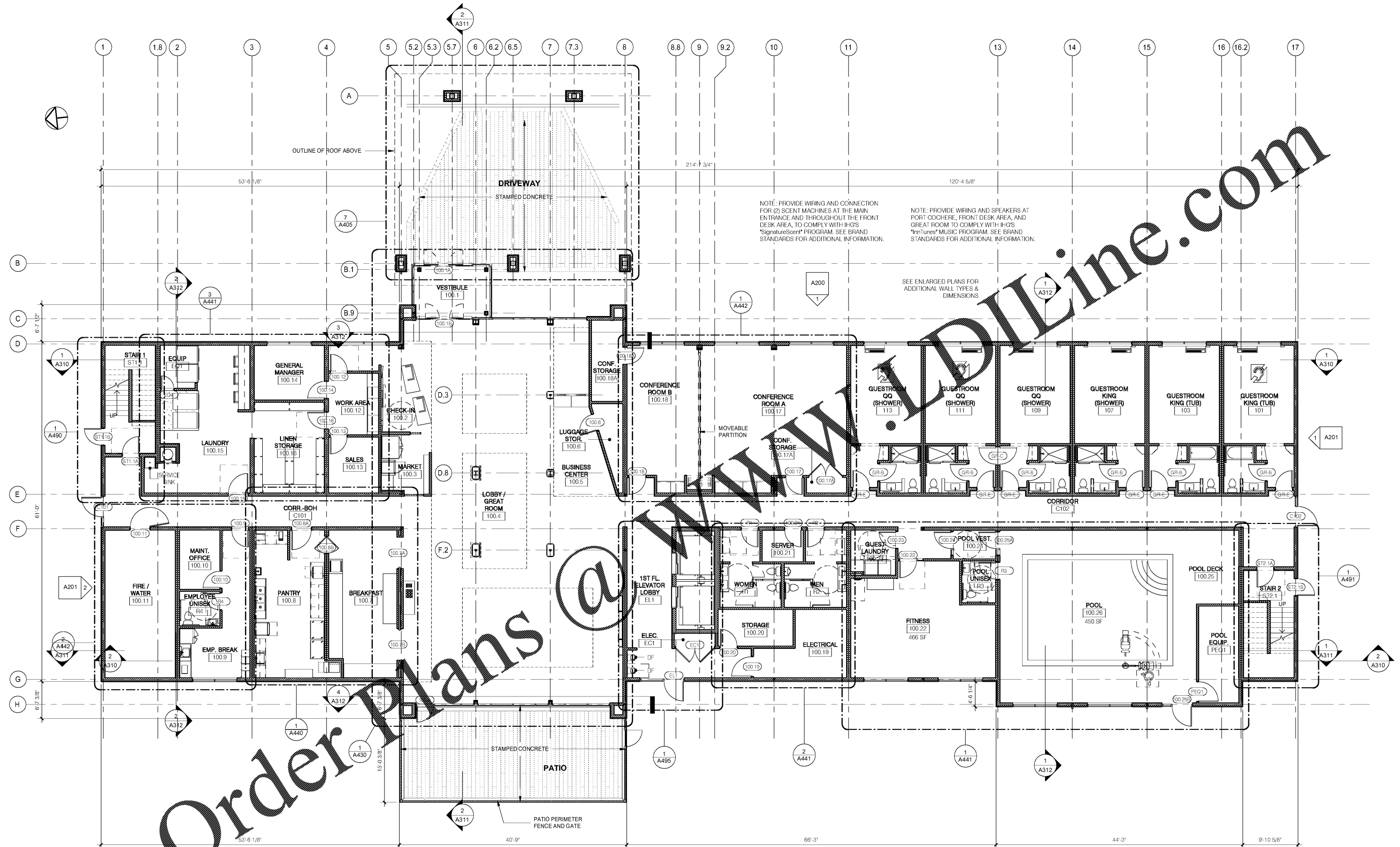

No.	Description	Date

DISCLAIMER: This drawing is provided by agreement with certain parties, materials, methods, etc. The parties recognize that data, plans, specifications, reports, drawings, etc. are subject to modification, alteration, or deletion without notice. The parties agree that the electronic media (including but not limited to CAD documents) are subject to modification, alteration, or deletion without notice. The parties agree that the electronic media (including but not limited to CAD documents) are subject to modification, alteration, or deletion without notice. The parties agree that the electronic media (including but not limited to CAD documents) are subject to modification, alteration, or deletion without notice.

MEISTER COX ARCHITECTS

INFO@MEISTERCOX.COM
 PHONE: 610-375-1331 FAX: 610-375-4655
 1522 PENN AVENUE WYOMISSING, PA 19310
 WWW.MEISTERCOX.COM

FLOOR PLAN - LEVEL 1

HOLIDAY INN EXPRESS & SUITES
 INTERSECTION OF HAYNES PLACE & LAMM RD.
 WILSON, NC 27893

STATUS:	BIDDING
PROJ. DATE:	06-07-19
PROJ. NO.:	18-176
PRINTED:	6/7/2019 7:10:12 PM
DRAWN BY:	RFF
CHECKED BY:	TGC
SHEET NO.:	A111
SCALE:	1/8" = 1'-0"

1 LEVEL 1 FLOOR PLAN
1/8" = 1'-0"

