

EXTERIOR LIGHT FIXTURE SCHEDULE

ALL ITEMS LISTED ON THE "LIGHT FIXTURE SCHEDULE" WILL BE SUPPLIED BY THE OWNER (O'REILLY). ITEMS SHALL BE DIRECT ORDERED AND/OR RELEASED FROM THE LISTED ELECTRICAL EQUIPMENT DISTRIBUTOR.

GRAYBAR ELECTRIC CO. INC.
11885 LACKLAND ROAD
ST. LOUIS, MO 63146

GRAYBAR O'REILLY TEAM
EMAIL: oreilly@graybar.com
TOLL FREE: (314) 573-2080

MARK	MFR.	CATALOG NUMBER	SUPPLY VOLTAGE	FINISH	MOUNTING			LAMPS			WATTAGE	NOTES	FIXTURE QUANTITY
					SURFACE WALL	SURF. CEILING	OTHER	LED	OTHER	QUANTITY			
LED EXTERIOR LIGHTS													
WS1	LSI	XWM-FT-LED-06L-50-UE-BRZ NO SUBSTITUTIONS	120	DARK BRONZE	X			X		1	59	FULL CUT-OFF, BUG RATING B1-U0-G1. ARCHITECTURAL ELEVATIONS SHOW DIMENSIONED LOCATIONS.	5
LED POLE LIGHTS													
P1	LSI	MRM-LED-18L-SIL-FT-UW-DIM-50-80CRI-BRZ-IL	120	DARK BRONZE			X	X	X	1	154	25' POLE LENGTH, ADVANCE BALLASTS, FULL CUT-OFF, NO SUBSTITUTIONS, ANCHOR BOLTS W/HARDWARE & TEMPLATE, WITH INTERNAL LOUVER HOUSE SIDE SHIELD, BUG RATING B2-U0-G3	1
	LSI	5S0B3-S11G-25-S-BRZ-LAB-5BC											
P2	LSI	MRM-LED-18L-SIL-FT-UW-DIM-50-80CRI-BRZ-IL	120	DARK BRONZE			X	X	X	1	154	25' POLE LENGTH, ADVANCE BALLASTS, FULL CUT-OFF, NO SUBSTITUTIONS, ANCHOR BOLTS W/HARDWARE & TEMPLATE, WITH INTERNAL LOUVER HOUSE SIDE SHIELD, BUG RATING B2-U0-G3	2
	LSI	5S0B3-S11G-25-S-BRZ-LAB-5BC											1

FIXTURE QUANTITY TO BE VERIFIED WITH SITE PLAN QUANTITY

BACKLIGHT-UPLIGHT-GLARE (BUG) RATING / FULL CUTOFF

SEE CUT-SHEET ON SP SHEETS AND SCHEDULE BELOW FOR EXTERIOR LIGHT FIXTURES. ALL OF THE LSI MRM & XWM LED FIXTURES HAVE ZERO UPLIGHT AND ARE CONSIDERED "FULL CUT OFF" AND DARKSKY COMPLIANT. SP SHEETS AND BELOW DELIVERED LUMENS SCHEDULE HAS "BUG" RATINGS, AS TESTED TO IDENTIFY HOW MUCH OF THE LIGHT GOES BACKWARDS, UPWARDS AND TO THE GROUND. THE CHART SHOWS THAT THESE FIXTURES HAVE BUG RATINGS WITH (UPLIGHT) U = 0.

Fixture	Fixture Lumens	Fixture Watts	Lumens/Watt	IES Class	Long. Class	BUG Rating
XWM3 LED-06-50	6,571	54	122	Type III	Medium	B1-U0-G2
XWMF1 LED-06-50	6,523	54	121	Type IV	Short	B1-U0-G2



DRAWN BY: JTH

CRAIG A. SCHNEIDER, AIA
ARCHITECT
1736 East Sunshine, Suite 417
Springfield, Missouri 65804
e-mail: architect@stetyschneider.com

PROJECT: NEW O'REILLY AUTO PARTS STORE
US HWY 43
WINFIELD, AL

O'Reilly AUTO PARTS
CORPORATE OFFICES
233 SOUTH PATTERSON
SPRINGFIELD, MISSOURI 65802
(417) 862-2674 TELEPHONE

COMM # 4308
DATE: 05-03-19
REVISION
DATE:

SP1 of 3

AUTOMATIC LIGHTING CONTROL

COMPLIANCE WITH ENERGY CODE IS ACHIEVED BY:
1. ONCE THE EMS HAS BEEN PROGRAMMED, THE INTERIOR AND EXTERIOR LIGHTS WILL TURN ON AND OFF USING THE FOLLOWING LOGIC:
- INTERIOR WORK LIGHTS WILL TURN ON WITH FIRST MOTION IN THE STORE AND WILL TURN OFF 15 MINUTES AFTER LAST MOTION ONCE THE STORE IS CLOSED.
- INTERIOR SALES LIGHTS WILL TURN ON AT STORE OPENING AND TURN OFF 15 MINUTES AFTER STORE CLOSING.
- EXTERIOR SIGN LIGHTS WILL TURN ON WHEN IT IS DARK ENOUGH OUTSIDE ANYTIME DURING STORE HOURS, AND WILL TURN OFF AT STORE CLOSING.
- EXTERIOR SITE LIGHTS WILL TURN ON WHEN IT IS DARK ENOUGH OUTSIDE AND IT IS WITHIN STORE HOURS OR THERE IS MOTION IN THE STORE. THEY WILL TURN OFF 30 MINUTES AFTER LAST MOTION ONCE THE STORE IS CLOSED.
FOR NEW CONSTRUCTION LOCATIONS ONLY, THERE IS A TEMPORARY PROGRAM TO KEEP SIGN AND SITE LIGHTS ON UNTIL MIDNIGHT RATHER THAN THE TIMES INDICATED ABOVE. O'REILLY WILL DISABLE THIS PROGRAM ONE YEAR AFTER STORE OPENING.
2. RESTROOMS AND OFFICES: ALL LIGHTING IN THESE AREAS ARE CONTROLLED BY OCCUPANT-SENSING DEVICES.

Statistics

Description	Symbol	Avg	Max	Min	Max/Min	Avg/Min	Avg/Max
Parking	+	0.00 fc	0.00 fc	0.00 fc	N/A	N/A	N/A

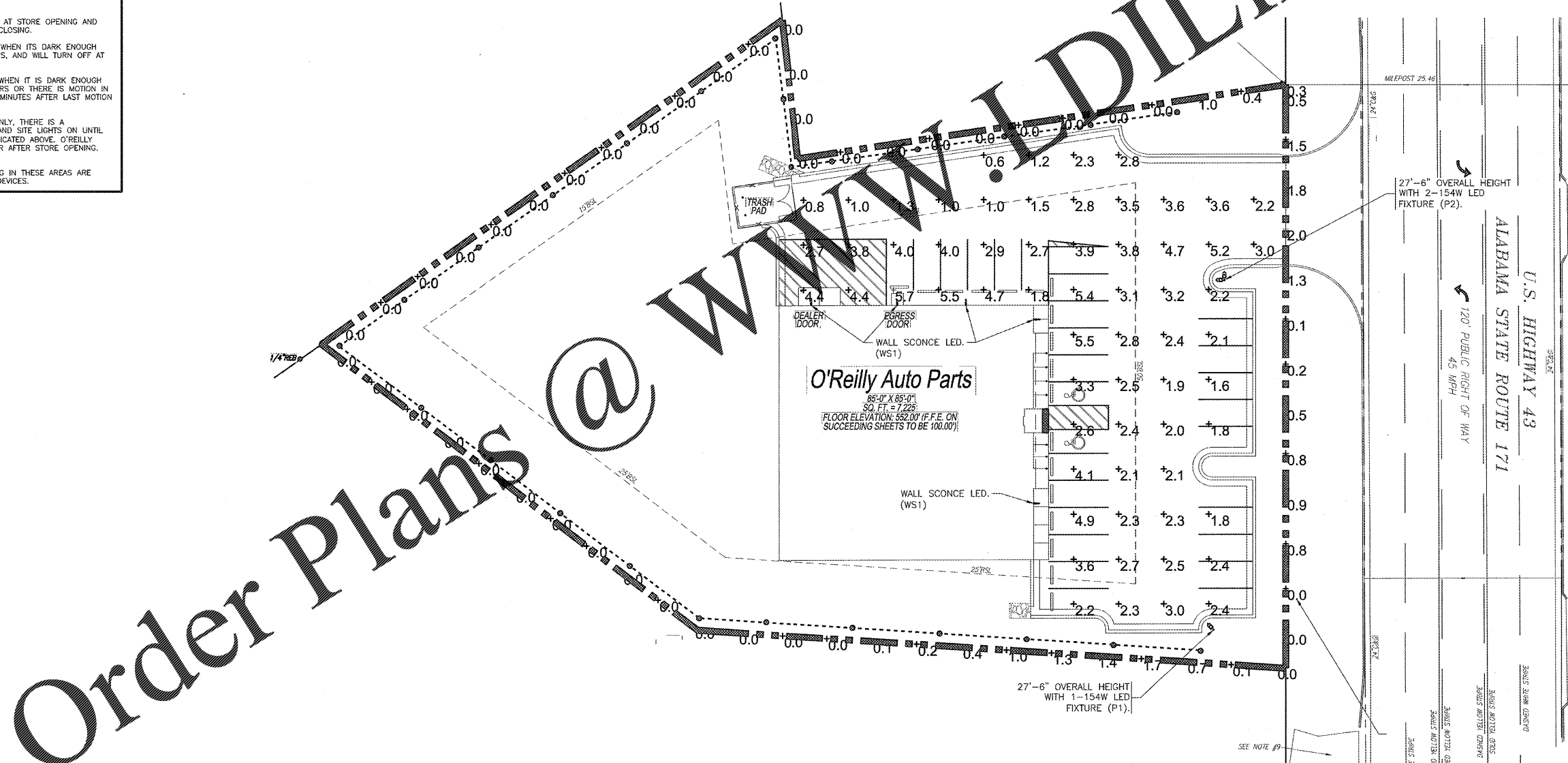

SITE LIGHTING PHOTOMETRICS

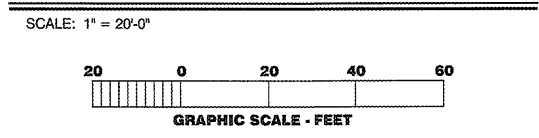

3855 S. JEFFERSON AVE. P: 417-882-2200
SPRINGFIELD, MO 65807 F: 417-882-1188
WWW.SMITH-GOTH.COM

RECEIVED
MAY 02 2019
1736 EAST SUNSHINE, SUITE 417
SPRINGFIELD, MO