

HAMMOND & ASSOCIATES, INC.
 CONSULTING ENGINEERS
 7348 NW 5TH STREET
 PLANTATION, FLORIDA 33317
 TEL: (954) 327-7111 FAX: (954) 327-7154
 ERIC J. HAMMOND P.E.
 MECHANICAL / ELECTRICAL ENGINEER
 F.E. #39048
 EB 5315

CRAIN ATLANTIS
 ENGINEERING, INC.
 CONSULTING ENGINEERS & ARCHITECTS
 210 SW 10TH AVENUE
 MIAMI, FLORIDA 33136
 TEL: (305) 372-5811
 FAX: (305) 372-5811
 A 25001858 EB - 2748

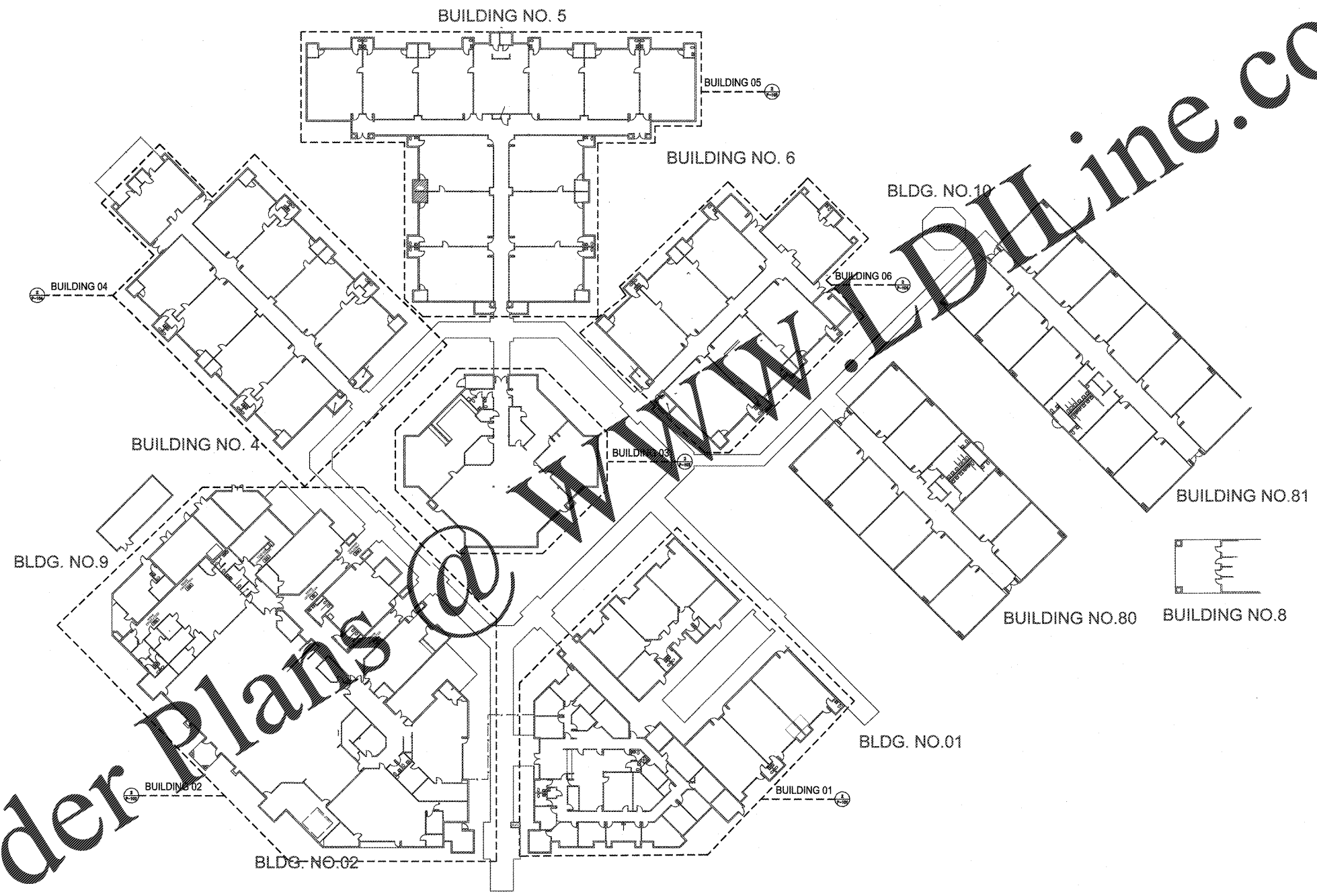

RECEIVED
 DEC 19 2017
 BUILDING DEPARTMENT
 BCPS

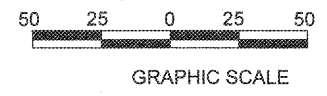

Order Plans @ WWW.DILine.com

1. OVERALL PLUMBING PLAN
 SCALE: 1/32" = 1'-0"

Eric Hammond
 12-15-17



SEA CASTLE
 ELEMENTARY SCHOOL
 9600 MIKAMAR BOULEVARD
 MIKAMAR, FLORIDA 33025



THE SCHOOL BOARD OF BROWARD COUNTY

OVERALL PLUMBING
 FLOOR PLAN

100% SUBMITTAL
 JOB PHASE: P.001632
 SBBC PROJECT: AS SHOW
 DATE: 12.13.16
 SCALE: HA
 DRAWN BY: E.H.
 CHECKED BY: E.H.
 CAE PROJECT NO. 201655

FL. LICENSE PE# 39048

ERIC HAMMOND
 PROFESSIONAL ENGINEER
 SEAL

DRAWING No.

P-100

IT IS A VIOLATION OF THE LAW FOR ANY PERSON, UNLESS ACTING UNDER THE DIRECTION OF A LICENSED ARCHITECT, TO ALTER THESE PLANS AND SPECIFICATIONS. THIS DOCUMENT CONTAINS PROPERTY INFORMATION AND SHALL NOT BE USED OR REPRODUCED, IN WHOLE OR IN PART, WITHOUT THE PRIOR WRITTEN CONSENT OF CRAIN ATLANTIS ENGINEERING, INC. COPYRIGHT 2014 CRAIN ATLANTIS ENGINEERING, INC.