

- FIRE ALARM GENERAL NOTES**
- ALL FIRE ALARM DEVICES ARE NEW UNLESS OTHERWISE NOTED.
 - THE BATTERY BACK UP FOR ALARM AND SUPERVISORY FUNCTIONS SHALL BE ADEQUATE TO PROVIDE POWER AS REQUIRED BY CODE.
 - THE FIRE ALARM CONTRACTOR SHALL SUBMIT TO THE ENGINEER OF RECORD FOR REVIEW AND APPROVAL PRIOR TO SUBMITTAL TO THE BUILDING DEPARTMENT SIGNED AND SEALED SHOP DRAWINGS AND CALCULATIONS BY A LICENSED FLORIDA PROFESSIONAL ENGINEER FOR THE FIRE ALARM SYSTEM.
 - CONTRACTOR SHALL NOTIFY TO THE OWNER OR OWNERS REPRESENTATIVE AND A/E OF ANY EXISTING ALARM, SUPERVISORY OR TROUBLE CONDITION IN THE ALARM PANEL PRIOR TO COMMENCING WORK ON THE FIRE ALARM SYSTEM. ALARM PANEL SHALL BE CLEARED OF ALL TROUBLES BEFORE COMMENCING WORK.
 - REMOTE DUCT DETECTOR INDICATOR/TEST STATIONS IN ACCORDANCE W/ BCPS 13845 3.1 FOR ALL NEW AND REPLACEMENT AIR HANDLERS SHALL BE MOUNTED INSIDE THE MECHANICAL ROOM ADJACENT TO THE DOOR OPENING HARDWARE, UNIFORMLY SURFACE MOUNTED BETWEEN 48" TO 54" ABOVE THE FLOOR.
 - PROVIDE AN EMERGENCY VOICE EVACUATION SYSTEM IN DINING, MULTI-PURPOSE ROOM, OR ANY SPACE WHERE OCCUPANCY EXCEEDS 300 PEOPLE.

FIRE ALARM ABBREVIATIONS

E	EXISTING TO REMAIN
ETR	EXISTING TO BE RELOCATED
ETBR	EXISTING TO BE REMOVED
N	NEW
R	RELOCATED
RC	ELEVATOR RECALL
PIV	POST INDICATOR VALVE
DDCV	DOUBLE DETECTOR CHECK VALVE

FIRE ALARM SYMBOLS

FACP	FIRE ALARM CONTROL PANEL
FAAP	FIRE ALARM ANNUCIATOR PANEL
PS1	FIRE ALARM POWER SUPPLY 1
PS2	FIRE ALARM POWER SUPPLY 2
F	ADDRESSABLE MANUAL PULL STATION
SD	ADDRESSABLE PHOTOELECTRIC SMOKE DETECTOR
D	ADDRESSABLE DUCT DETECTOR
R	REMOTE ALARM/TEST SWITCH
HD	ADDRESSABLE HEAT DETECTOR
TS	TAMPER SWITCH
FS	FLOW SWITCH
L/S	SPEAKER/STROBE DEVICE
L	STROBE LIGHT
R	RELAY
M	MONITOR MODULE

RECEIVED
 OCT 29 2016
 BUILDING DEPARTMENT
 BCPS

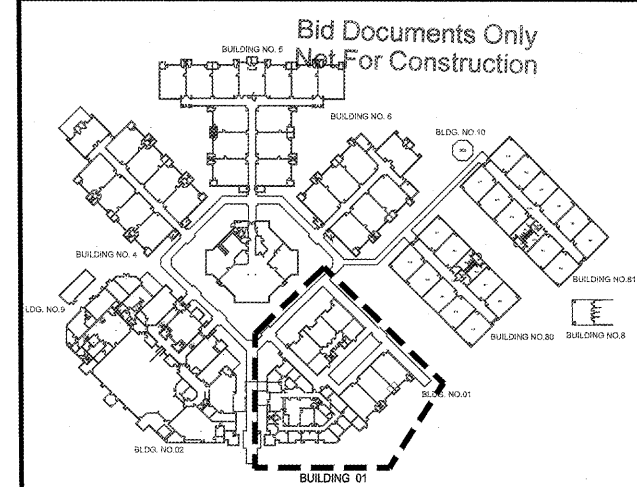

1 KEY PLAN
 SCALE: 1" = 100'-0"

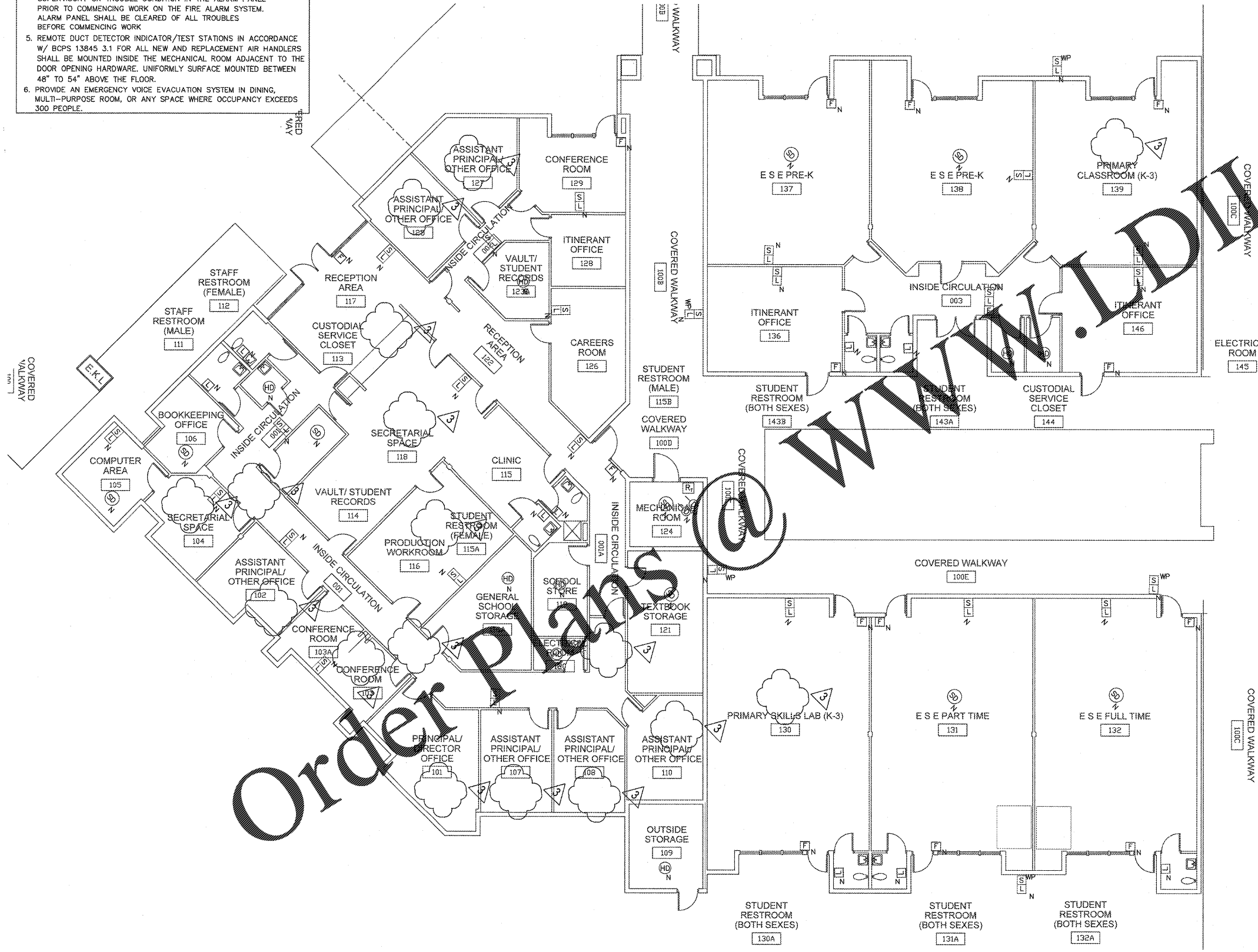

2 PARTIAL FIRE ALARM FLOOR PLAN BUILDING 01
 SCALE: 1/8" = 1'-0"

Order Plans @ www.DLine.com

SEA CASTLE
 ELEMENTARY SCHOOL
 9600 MIRAMAR BOULEVARD
 MIRAMAR, FLORIDA 33025

PARTIAL FIRE ALARM
 FLOOR PLAN BUILDING 01

100% SUBMITTAL
 P.001632
 DATE: 12.13.16
 SCALE: AS SHOWN
 DRAWN BY: HA
 CHECKED BY: EH
 CAE PROJECT NO. 2015.55

FL. LICENSE # 19048
 ERIC J. HAMMOND
 P.E. #39046
 MECHANICAL/ELECTRICAL ENGINEER
 PROFESSIONAL SEAL

DRAWING No.

E-301

THIS IS A VIOLATION OF THE LAW FOR ANY PERSON, UNLESS ACTING UNDER THE DIRECTION OF A LICENSED ARCHITECT, TO ALTER THESE PLANS AND SPECIFICATIONS. THIS DOCUMENT CONTAINS PROPERTY INFORMATION AND SHALL NOT BE USED OR REPRODUCED, IN WHOLE OR IN PART, WITHOUT THE PRIOR WRITTEN CONSENT OF CRAIN ATLANTIS ENGINEERING, INC. COPYRIGHT 2014 CRAIN ATLANTIS ENGINEERING, INC.