

HAMMOND & ASSOCIATES, INC.
 CONSULTING ENGINEERS
 7348 NW 5TH STREET
 PLANTATION, FLORIDA 33317
 TEL: (954) 327-7111 FAX (954) 327-7154
 ERIC J. HAMMOND P.E.
 MECHANICAL / ELECTRICAL ENGINEER
 P.E. #39048
 EB 5315

CRAIN ATLANTIS
 ENGINEERING, INC.
 CONSULTING ENGINEERS & ARCHITECTS
 210 S. WASHINGTON AVE. SUITE 304
 MIAMI, FLORIDA 33130
 TEL: (305) 371-2811
 FAX: (305) 371-2812
 EB - 27498

Order Plans @ WWW.LDILine.com

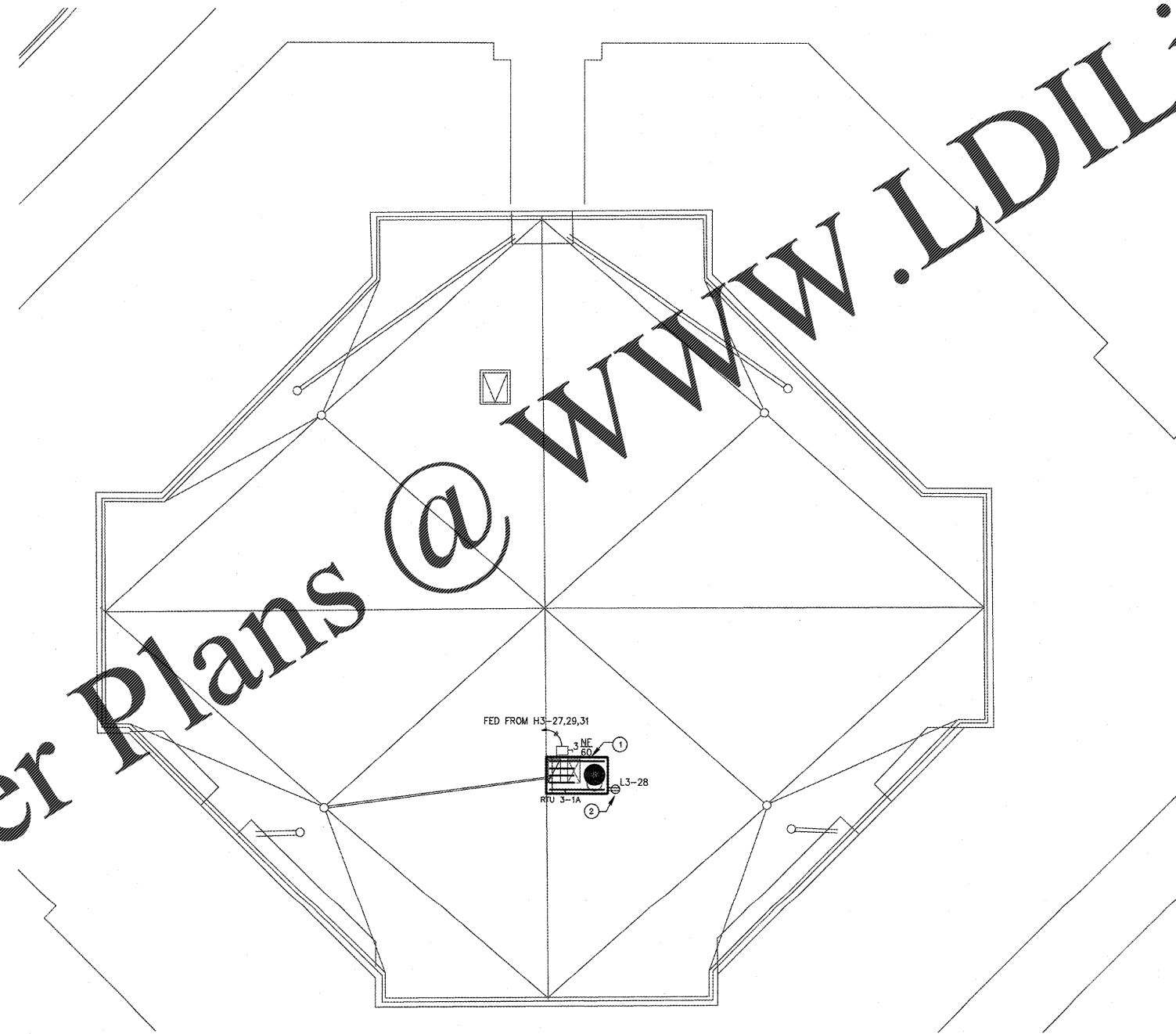

RECEIVED
 MAR 06 2018
 BUILDING DEPARTMENT
 BCPS

DRAWING KEY NOTES:
 ① LOCATION OF NEW RTU LOCATED ON ROOF. PROVIDE NEW DISCONNECT, CONDUIT, AND WIRING AS REQUIRED.
 ② LOCATION OF NEW GFI OUTLET. FED FROM EXISTING CIRCUIT.

Bid Documents Only
 Not For Construction

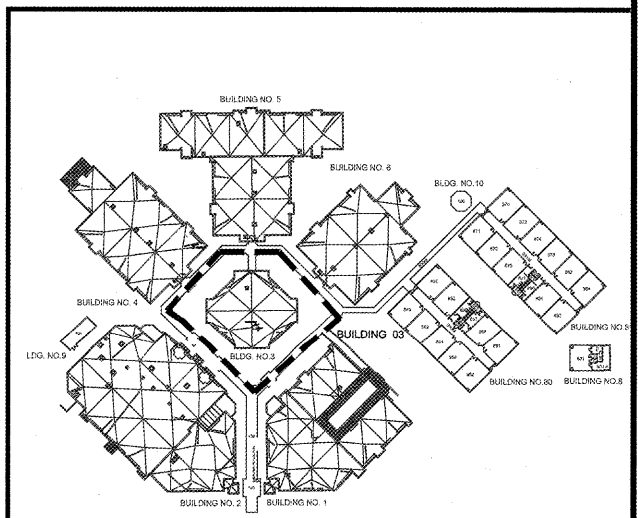

2 MECHANICAL DEMOLITION ROOF PLAN BUILDING 03
 SCALE: 1/8" = 1'-0"

1 KEY PLAN
 SCALE: 1" = 100'-0"

REVISIONS	BUILDING DEPARTMENT COMMENTS
Δ 02/23/18	

SEA CASTLE
 ELEMENTARY SCHOOL
 9600 MIRAMAR BOULEVARD
 MIRAMAR, FLORIDA 33025



THE SCHOOL BOARD OF BROWARD COUNTY

ELECTRICAL ROOF
 PLAN BUILDING 03

JOB PHASE: 100% SUBMITTAL
 SBBC PROJECT: P.001632
 DATE: 12.13.16
 SCALE: AS SHOWN
 DRAWN BY: HA
 CHECKED BY: E.H.
 CAE PROJECT NO. 2016.55

FL. LICENSE PE# 39048



DRAWING No.

E-203

THIS IS A VIOLATION OF THE LAW FOR ANY PERSON, UNLESS ACTING UNDER THE DIRECTION OF A LICENSED ARCHITECT, TO ALTER THESE PLANS AND SPECIFICATIONS. THIS DOCUMENT CONTAINS PROPERTY INFORMATION AND SHALL NOT BE USED OR REPRODUCED, OR ITS CONTENTS DISCLOSED, IN WHOLE OR IN PART, WITHOUT THE PRIOR WRITTEN CONSENT OF CRAIN ATLANTIS ENGINEERING, INC. COPYRIGHT 2014 CRAIN ATLANTIS ENGINEERING, INC.