

HAMMOND & ASSOCIATES, INC.
 CONSULTING ENGINEERS
 7348 NW 5TH STREET
 PLANTATION, FLORIDA 33317
 TEL: (904) 327-7111 FAX (904) 327-7154
 ERIC J. HAMMOND P.E.
 MECHANICAL / ELECTRICAL ENGINEER
 P.E. #39048
 EB - 5515

- DRAWING KEY NOTES:**
- ① LOCATION OF NEW AIR HANDLING UNIT. PROVIDE NEW DISCONNECT, CONDUIT, AND WIRING AS REQUIRED.
 - ② LOCATION OF NEW FAN COIL UNIT AND DUCT HEATER. PROVIDE NEW DISCONNECT, CONDUIT, AND WIRING AS REQUIRED.
 - ③ LOCATION OF NEW HVAC CIRCULATING PUMP. PROVIDE NEW DISCONNECT, CONDUIT, AND WIRING AS REQUIRED.
 - ④ LOCATION OF NEW FAN COIL UNIT. PROVIDE NEW DISCONNECT, CONDUIT, AND WIRING AS REQUIRED.
 - ⑤ LOCATION OF EXISTING CHILLER TO MAIN.
 - ⑥ LOCATION OF NEW RTU LOCATED ON ROOF. PROVIDE NEW DISCONNECT, CONDUIT, AND WIRING AS REQUIRED.
 - ⑦ PROVIDE POWER TO NEW INCLINED CHAIR LIFT. ELECTRICAL SUPPLY TO BE COORDINATED WITH SHOP DRAWING. INCLINED CHAIR LIFT TO BE PROVIDED WITH AUXILIARY BATTERY BACKUP FOR EMERGENCY OPERATION.
 - ⑧ LOCATION OF NEW AIR CONDITIONING CONDENSING UNIT. PROVIDE NEW DISCONNECT, CONDUIT, AND WIRING AS REQUIRED.
 - ⑨ LOCATION OF NEW GFI OUTLET.
 - ⑩ LOCATION OF NEW GFI OUTLET. FED FROM EXISTING CIRCUIT.
 - ⑪ LOCATION OF NEW ROOFTOP EXHAUST FAN. PROVIDE NEW DISCONNECT, CONDUIT, AND WIRING AS REQUIRED.

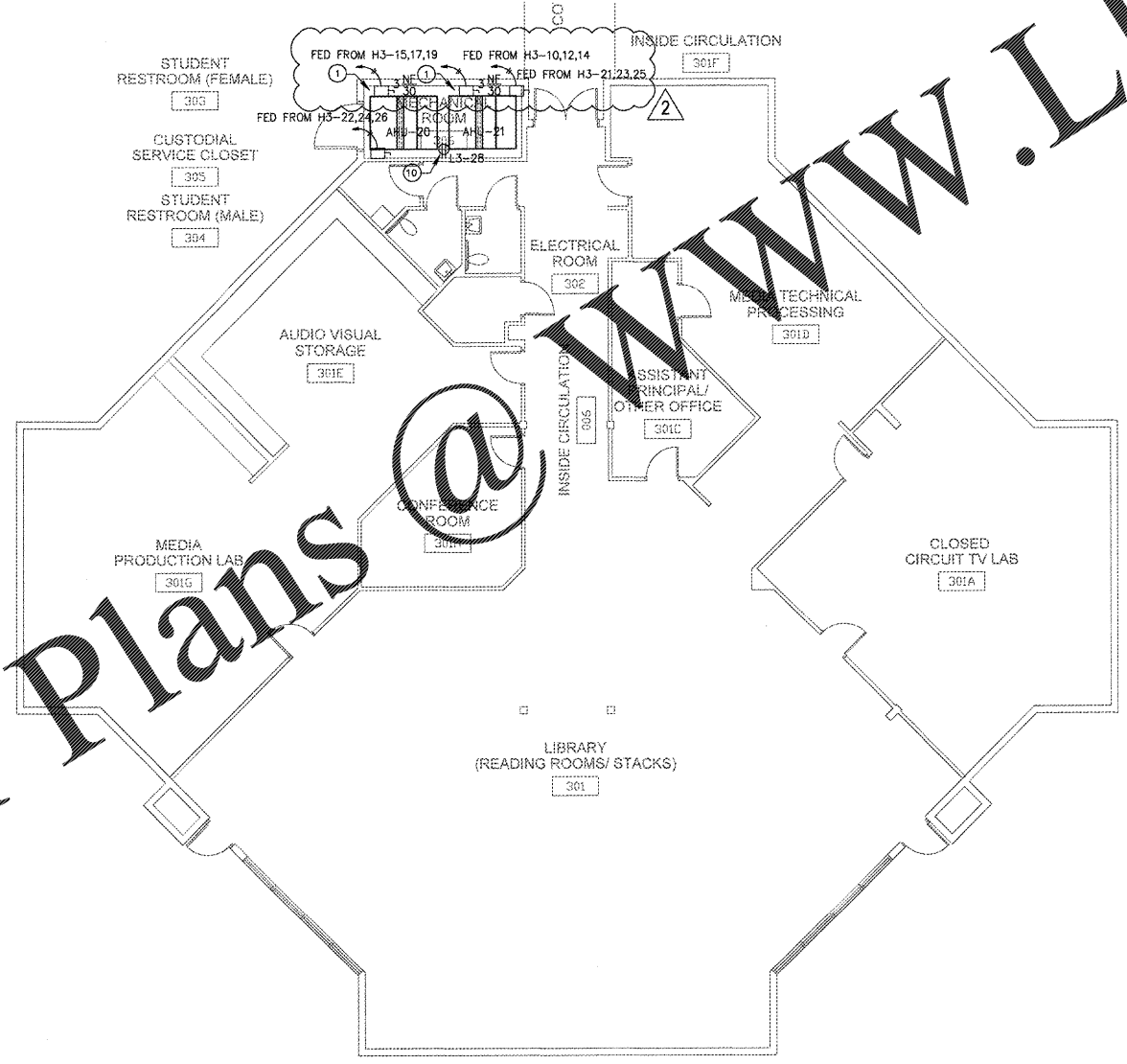

RECEIVED
 JUL 18 2018
 BUILDING DEPARTMENT
 BCPS

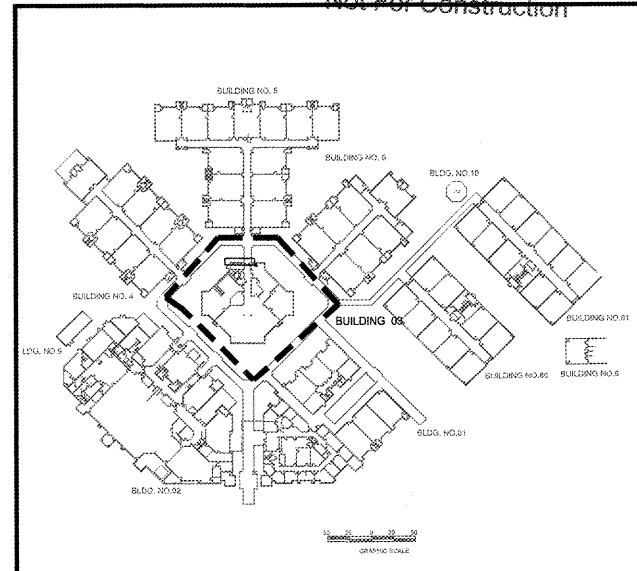

Order Plans @

WWW.LDILine.com

CRAIN ATLANTIS ENGINEERING, INC.
 CONSULTING ENGINEERS & ARCHITECTS
 210 SW 10TH AVENUE
 DEERFIELD BEACH, FL 33441
 AA 26001888 EB - 27488

REVISIONS	BUILDING DEPARTMENT COMMENTS	BUILDING DEPARTMENT COMMENTS
Δ 02/23/18		
Δ 07/10/18		

SEA CASTLE ELEMENTARY SCHOOL
 9600 MIRAMAR BOULEVARD
 MIRAMAR, FLORIDA 33025



THE SCHOOL BOARD OF BROWARD COUNTY

PARTIAL ELECTRICAL FLOOR PLAN BUILDING 03

100% SUBMITTAL
 JOB PHASE: SBBC PROJECT: P-001632
 DATE: 12.13.16
 SCALE: AS SHOWN
 DRAWN BY: HA
 CHECKED BY: E.H.
 CAE PROJECT NO.: 2016.55

ERIC J. HAMMOND
 LICENSED PROFESSIONAL ENGINEER
 STATE OF FLORIDA
 P.E. #39048
 MECHANICAL/ELECTRICAL ENGINEER

DRAWING No.

E-103

THIS IS A VIOLATION OF THE LAW FOR ANY PERSON, BUSINESS OR CORPORATION, UNLESS ACTING UNDER THE DIRECTION OF A LICENSED ARCHITECT, TO ALTER THESE PLANS AND SPECIFICATIONS. THIS DOCUMENT CONTAINS PROPERTY INFORMATION AND SHALL NOT BE USED OR REPRODUCED, IN WHOLE OR IN PART, WITHOUT THE PRIOR WRITTEN CONSENT OF CRAIN ATLANTIS ENGINEERING, INC. COPYRIGHT 2014 CRAIN ATLANTIS ENGINEERING, INC.