

HAMMOND & ASSOCIATES, INC.  
 CONSULTING ENGINEERS  
 7348 NW 5TH STREET  
 PLANTATION, FLORIDA 33317  
 TEL: (954) 327-7111 FAX (954) 327-7154  
 ERIC J. HAMMOND P.E.  
 MECHANICAL / ELECTRICAL ENGINEER  
 P.E. #39048  
 EB 5315

CRAIN ATLANTIS  
 ENGINEERING, INC.  
 CONSULTING ENGINEERS & ARCHITECTS  
 210 SW MADURA AVENUE  
 DEERFIELD BEACH, FLORIDA 33441  
 AA 28601888 EB - 27488

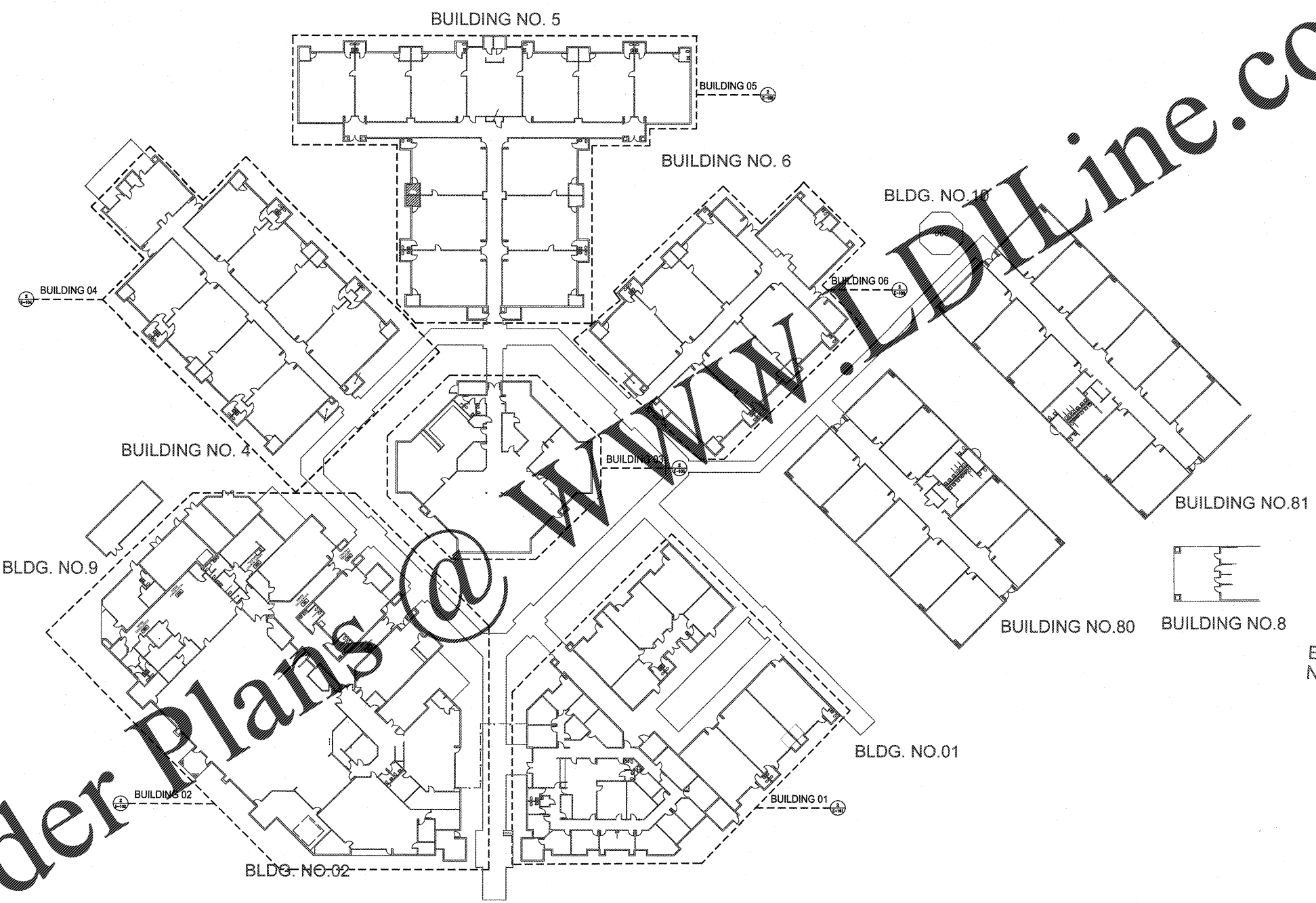

RECEIVED  
 DEC 19 2017  
 BUILDING DEPARTMENT  
 BCPS

SEA CASTLE  
 ELEMENTARY SCHOOL  
 9600 MIRAMAR BOULEVARD  
 MIRAMAR, FLORIDA 33025



THE SCHOOL BOARD OF BROWARD COUNTY

Bid Documents Only  
 Not For Construction

OVERALL ELECTRICAL  
 FLOOR PLAN

JOB PHASE: 100% SUBMITTAL  
 SBBC PROJECT: P-001632  
 DATE: 12.13.16  
 SCALE: AS SHOWN  
 DRAWN BY: HA  
 CHECKED BY: E.H.  
 CAE PROJECT NO. 2015.55  
 FL. LICENSE PE# 39048

ERIC HAMMOND  
 PROFESSIONAL ENGINEER  
 SEAL

DRAWING No.  
**E-100**

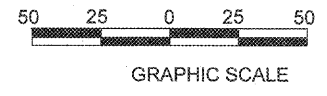

Order Plans @ [www.dline.com](http://www.dline.com)

THIS IS A VIOLATION OF THE LAW FOR ANY PERSON, UNLESS ACTING UNDER THE DIRECTION OF A LICENSED ARCHITECT, TO ALTER THESE PLANS AND SPECIFICATIONS. THIS DOCUMENT CONTAINS PROPRIETARY INFORMATION AND SHALL NOT BE USED OR REPRODUCED, OR ITS CONTENTS DISCLOSED, IN WHOLE OR IN PART, WITHOUT THE PRIOR WRITTEN CONSENT OF CRAIN ATLANTIS ENGINEERING, INC. COPYRIGHT 2014 CRAIN ATLANTIS ENGINEERING, INC.