

**FIRE ALARM ABBREVIATIONS**

E	EXISTING TO REMAIN
ETR	EXISTING TO BE RELOCATED
ETBR	EXISTING TO BE REMOVED
N	NEW
R	RELOCATED
RC	ELEVATOR RECALL
PIV	POST INDICATOR VALVE
DDCV	DOUBLE DETECTOR CHECK VALVE

**FIRE ALARM SYMBOLS**

FACP	FIRE ALARM CONTROL PANEL
FAAP	FIRE ALARM ANNUNCIATOR PANEL
PS1	FIRE ALARM POWER SUPPLY 1
PS2	FIRE ALARM POWER SUPPLY 2
F	ADDRESSABLE MANUAL PULL STATION
SD	ADDRESSABLE PHOTOELECTRIC SMOKE DETECTOR
D	ADDRESSABLE DUCT DETECTOR
R	REMOTE ALARM/TEST SWITCH
HD	ADDRESSABLE HEAT DETECTOR
TS	TAMPER SWITCH
FS	FLOW SWITCH
LH	HORN/STROBE DEVICE
L	STROBE LIGHT
R	RELAY
M	MONITOR MODULE

RECEIVED  
 DEC 19 2017  
 BUILDING DEPARTMENT  
 BCPS

Bid Documents Only  
 Not For Construction

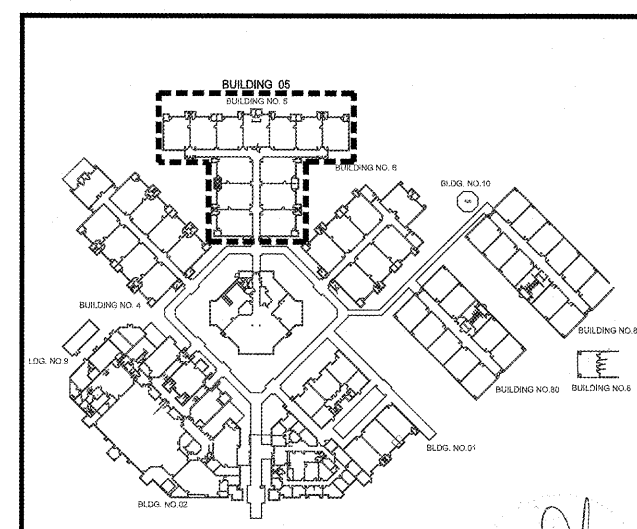

SEA CASTLE  
 ELEMENTARY SCHOOL  
 9600 MIRAMAR BOULEVARD  
 MIRAMAR, FLORIDA 33025



THE SCHOOL BOARD OF BROWARD COUNTY

PARTIAL DEMOLITION  
 FIRE ALARM FLOOR PLAN  
 BUILDING 05

100% SUBMITTAL  
 JOB PHASE: P 001632  
 SBBP PROJECT: P 001632  
 DATE: 12.13.16  
 SCALE: AS SHOWN  
 DRAWN BY: HA  
 CHECKED BY: E.H.  
 CAE PROJECT NO. 2015.35  
 FL LICENSE PE# 39048

ERIC HAMMOND  
 PROFESSIONAL ENGINEER  
 SEAL  
 DRAWING No.

DE-305

THIS IS A VOLUNTARY OF THE LAW FOR ANY PERSON, UNLESS ACTING UNDER THE DIRECTION OF A LICENSED ARCHITECT, TO ALTER THESE PLANS AND SPECIFICATIONS. THIS DOCUMENT CONTAINS PROPERTY INFORMATION AND SHALL NOT BE USED OR REPRODUCED, IN WHOLE OR IN PART, WITHOUT THE PRIOR WRITTEN CONSENT OF CRAIN ATLANTIS ENGINEERING, INC. COPYRIGHT 2014 CRAIN ATLANTIS ENGINEERING, INC.