

FIRE ALARM ABBREVIATIONS	
E	EXISTING TO REMAIN
ETR	EXISTING TO BE RELOCATED
ETBR	EXISTING TO BE REMOVED
N	NEW
R	RELOCATED
RC	ELEVATOR RECALL
PIV	POST INDICATOR VALVE
DDCV	DOUBLE DETECTOR CHECK VALVE

FIRE ALARM SYMBOLS	
[FACP]	FIRE ALARM CONTROL PANEL
[FAAP]	FIRE ALARM ANNUCIATOR PANEL
[PS1]	FIRE ALARM POWER SUPPLY 1
[PS2]	FIRE ALARM POWER SUPPLY 2
[F]	ADDRESSABLE MANUAL PULL STATION
[SD]	ADDRESSABLE PHOTOELECTRIC SMOKE DETECTOR
[D]	ADDRESSABLE DUCT DETECTOR
[R]	REMOTE ALARM/TEST SWITCH
[HD]	ADDRESSABLE HEAT DETECTOR
[TS]	TAMPER SWITCH
[FS]	FLOW SWITCH
[LH]	HORN/STROBE DEVICE
[L]	STROBE LIGHT
[R]	RELAY
[M]	MONITOR MODULE

**RECEIVED**  
 DEC 19 2017  
 BUILDING DEPARTMENT  
 BCPS

Bid Documents Only  
 Not For Construction

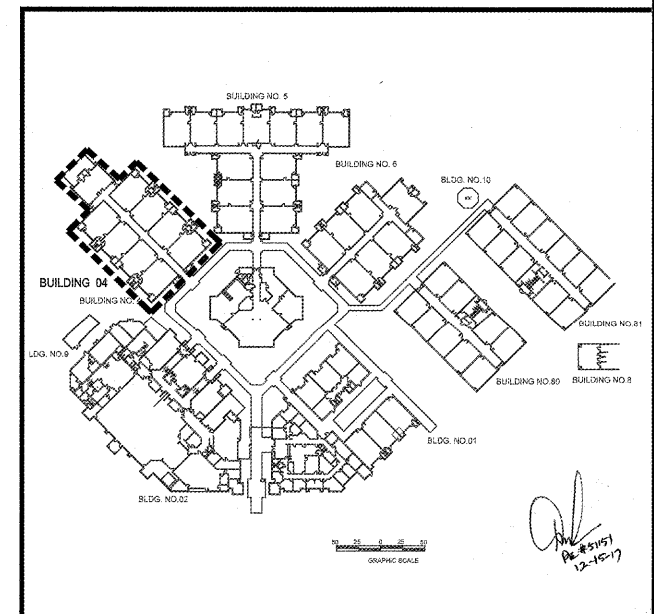

Order Plans @ [www.VDILine.com](http://www.VDILine.com)

2 PARTIAL DEMOLITION FIRE ALARM FLOOR PLAN BUILDING 04  
 SCALE: 1/8" = 1'-0"

1 KEY PLAN  
 SCALE: 1" = 100'-0"

SEA CASTLE  
 ELEMENTARY SCHOOL  
 9600 MIRAMAR BOULEVARD  
 MIRAMAR, FLORIDA 33025  
 THE SCHOOL BOARD OF BROWARD COUNTY

PARTIAL DEMOLITION  
 FIRE ALARM FLOOR PLAN  
 BUILDING 04  
 JOB PHASE: 100% SUBMITTAL  
 SBPC PROJECT: P-001632  
 DATE: 12.13.16  
 SCALE: AS SHOWN  
 DRAWN BY: HA  
 CHECKED BY: E.H.  
 CAE PROJECT No. 201555  
 FL LICENSE PE# 39048  
 ERIC HAMMOND  
 PROFESSIONAL ENGINEER  
 SEAL  
 DRAWING No.

DE-304

THIS IS A VIOLATION OF THE LAW FOR ANY PERSON, UNLESS ACTING UNDER THE DIRECTION OF A LICENSED ARCHITECT, TO ALTER THESE PLANS AND SPECIFICATIONS. THIS DOCUMENT CONTAINS PROPERTY INFORMATION AND SHALL NOT BE USED OR REPRODUCED, IN WHOLE OR IN PART, WITHOUT THE PRIOR WRITTEN CONSENT OF CRAIN ATLANTIS ENGINEERING, INC. COPYRIGHT 2014 CRAIN ATLANTIS ENGINEERING, INC.