

HAMMOND & ASSOCIATES, INC.
 CONSULTING ENGINEERS
 7348 NW 5TH STREET
 PLANTATION, FLORIDA 33317
 TEL: (954) 327-7111 FAX (954) 327-7154
 ERIC J. HAMMOND P.E.
 MECHANICAL / ELECTRICAL ENGINEER
 P.E. #39048
 EB 5516

CRAIN ATLANTIS
 ENGINEERING, INC.
 CONSULTING ENGINEERS & ARCHITECTS
 10 DE SOTO AVENUE
 DEERFIELD BEACH, FLORIDA 33441
 AA 28001858 EB - 2748

Order Plans @ WWW.LDILine.com

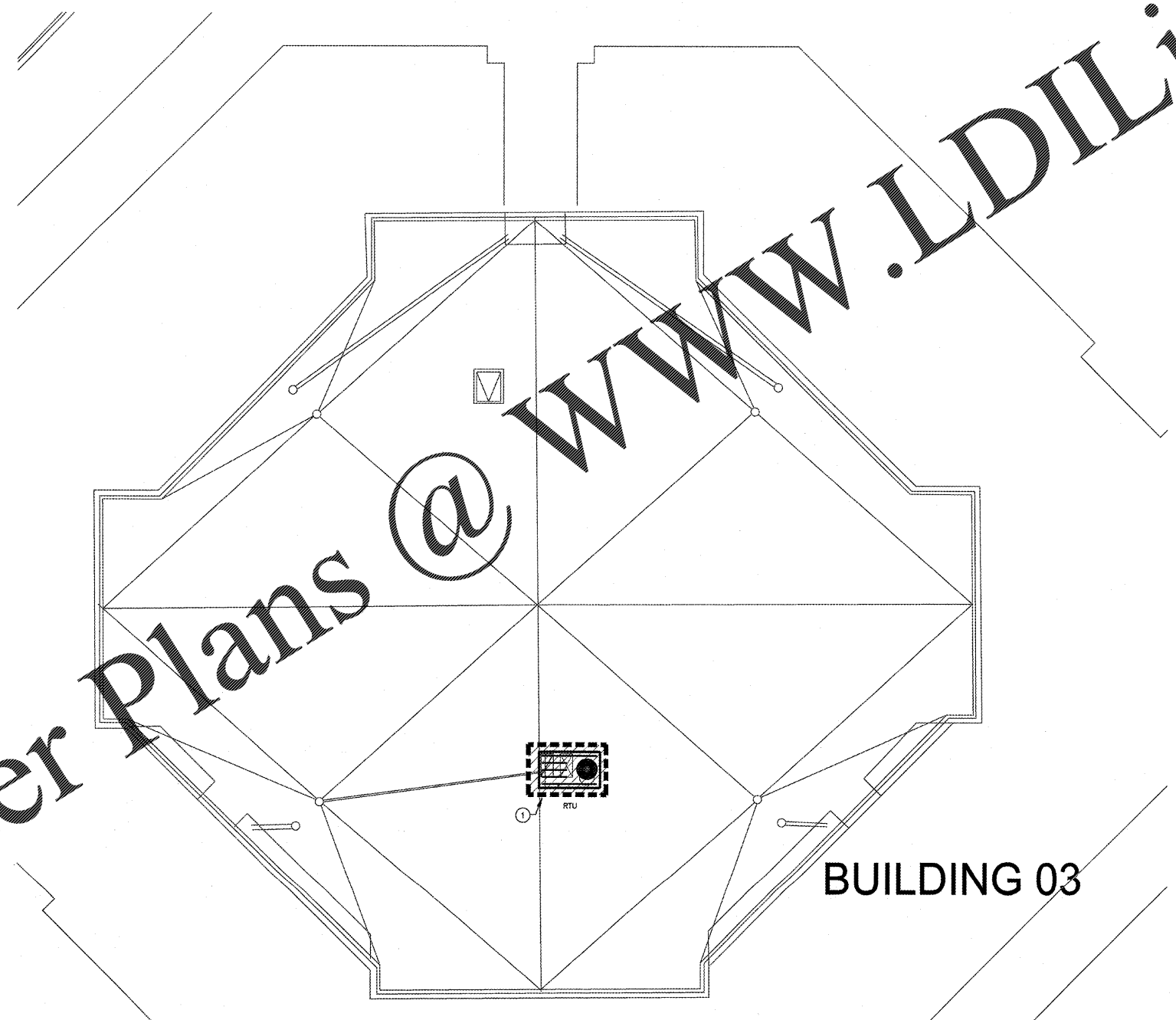

DEMOLITION KEY NOTES:
 ① LOCATION OF EXISTING ROOF TOP UNIT TO BE REPLACED WITH NEW. REMOVE EXISTING ROOF TOP UNIT AND DUCTWORK AS REQUIRED. PROVIDE NEW ROOF TOP UNIT AND CONNECT TO EXISTING DUCTWORK.

DEMOLITION NOTES:
 A. EXISTING CONTROLS ARE BEING REPLACED WITH NEW DDC CONTROLS. ALL EXISTING CONTROLS ARE TO BE REMOVED. REFER TO CONTROL SCHEMATIC SHEET M-302 FOR NEW CONTROLS REQUIREMENTS.

RECEIVED
 DEC 19 2017
 BUILDING DEPARTMENT
 BCPS

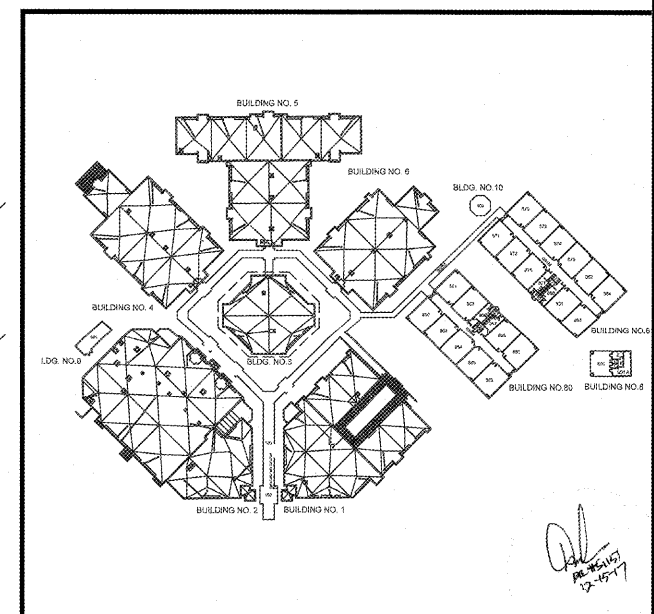

SEA CASTLE
 ELEMENTARY SCHOOL
 9600 MIRAMAR BOULEVARD
 MIRAMAR, FLORIDA 33025



THE SCHOOL BOARD OF BROWARD COUNTY

MECHANICAL DEMOLITION
 ROOF PLAN BUILDING 03

JOB PHASE: 100% SUBMITTAL
 SBC PROJECT: P 001652
 DATE: 12.13.16
 SCALE: AS SHOWN
 DRAWN BY: HA
 CHECKED BY: E.H.
 CAE PROJECT NO. 2015.55

FL LICENSE PE# 39048

ERIC HAMMOND
 PROFESSIONAL ENGINEER
 SEAL

DRAWING No.

DM-203

THIS IS A VIOLATION OF THE LAW FOR ANY PERSON, UNLESS ACTING UNDER THE DIRECTION OF A LICENSED ARCHITECT, TO ALTER THESE PLANS AND SPECIFICATIONS. THIS DOCUMENT CONTAINS PROPERTY INFORMATION AND SHALL NOT BE USED OR REPRODUCED, IN WHOLE OR IN PART, WITHOUT THE PRIOR WRITTEN CONSENT OF CRAIN ATLANTIS ENGINEERING, INC. COPYRIGHT 2014 CRAIN ATLANTIS ENGINEERING, INC.