

GENERAL DEMOLITION NOTES	
1. COMPLETELY TEAR OFF ALL ROOFING SYSTEM, CANTS, ROOF VENTS, NAILERS, FLASHING, DRIP EDGES, PITCH PANS AND MISCELLANEOUS ACCESSORIES DOWN TO THE EXISTING STEEL DECK. CLEAN AND REPAIR ANY DEFECTS IN THE DECK AFFECTING THE INSTALLATION OF THE NEW ROOF SYSTEM AS PER SECTION 07551. INSTALL NEW ROOF SYSTEM AS PER NEW CONSTRUCTION NOTES.	
2. REMOVE ALL EXISTING DESIGNATED ASBESTOS CONTAINING MATERIAL (SEE ASBESTOS REPORT). COORDINATE ABATEMENT WITH ABCB DEPARTMENT OF ASBESTOS MANAGEMENT. INSTALL NEW ROOF (AS PER SECTION 07511) MBR-TORCH APPLICATION.	
3. REMOVE ALL EXISTING FLASHING AND CURBS AT ROOF FANS AND DUCTS PENETRATING ROOF. CLEAN, SEAL AND PREPARE FOR NEW WORK. REMOVE ALL SUPPORT AND PITCH PANS AT ASSOCIATED ELECTRICAL CONDUIT. RAISE ALL SUPPORTS TO COMPLY WITH DETAILS.	
4. REMOVE ALL EXISTING FLASHING AND CURBS AT EXISTING MECHANICAL EQUIPMENT. CLEAN SEAL AND PREPARE FOR NEW WORK.	
5. REMOVE ABANDONED SUPPORTS AND PITCH PANS, CAP PIPES BELOW ROOF. CLEAN AND PREPARE FOR NEW WORK.	
6. REMOVE EXISTING EXPANSION JOINT COVER AND CURB. CLEAN SEAL AND PREPARE FOR NEW WORK (N/A).	
7. REMOVE EXISTING FLASHING, NAILERS, AND CANTS AT WALLS, AND PARAPETS. CLEAN SEAL AND PREPARE FOR NEW WORK.	
8. REMOVE EXISTING SLEEVE AND/OR PITCH PANS AT VTR'S.	
9. REMOVE EXISTING ELECTRICAL CONDUIT, SUPPORTS, JUNCTION BOXES LIGHT AND ASSOCIATED ACCESSORIES AND PREPARE TO RELOCATE AS PER NEW ELECTRICAL DRAWING.	
10. ANY EQUIPMENT, VENTS, ETC. FOUND UNDER EXISTING ROOF ARE TO BE BROUGHT TO THE ATTENTION OF THE ARCHITECT IN WRITING FOR PROPER DOCUMENTATION.	
11. RELOCATE ALL VTR AND PENETRATIONS AT PERIMETER EDGE MINIMUM 2'-0" FROM PERIMETER/EDGE, CURBS AND EXPANSION JOINTS.	
12. REMOVE ALL ABANDONED EXISTING ELECTRICAL, PIPES, ETC. AND PATCH AS REQUIRED.	
13. EXISTING ELECTRICAL CONDUITS ARE SHOWN FOR ILLUSTRATION ONLY. IT IS THE RESPONSIBILITY OF CONTRACTOR TO FIELD VERIFY EXACT QUANTITY AND LOCATION AND RAISE ANY/ALL CONDUITS IN COMPLIANCE WITH NEW ELECTRICAL.	
14. REMOVE EXISTING FLASHING OVER SCUPPER IN EXISTING LOCATION AND PREPARE FOR NEW WORK (N/A).	
15. EXISTING ALL SUPPORT STRUCTURE TO REMAIN, UNLESS OTHERS WISE SHOWN ON PLANS TO BE REMOVED (N/A).	
16. EXISTING DOWNSCOPES TO BE REMOVED AND REPLACED (N/A).	
17. PREPARE RAPEL TO RECEIVE NEW COPPING SYSTEM.	
18. REMOVE ABANDONED GUTTER AND PREPARE FOR NEW WORK (N/A).	
19. REMOVE EXISTING ROOF HATCH TO BE REMOVED AND REPLACED (N/A).	
20. REMOVE EXISTING ROOF DRAINS AND CAP OFF UNDERneath ROOF STRUCTURE (N/A).	
21. RAISE EXISTING AC UNIT (N/A).	
22. REMOVE EXISTING ABANDONED EXHAUST FAN CURBS AND PREPARE FOR NEW WORK (N/A).	
23. REMOVE EXISTING SKYLIGHT CURBS AND PREPARE FOR NEW WORK (N/A).	
24. REMOVE EXISTING ABANDONED COMPRESSOR UNIT, SUPPORT, PITCH PANS AND PREPARE FOR NEW WORK (N/A).	
25. REMOVE AND RE-INSTALL EXISTING ELECTRICAL CONDUIT AND OUTLET AT WALL (N/A).	
26. REMOVE ALL EXISTING ROOF VENTS.	
27. REMOVE AND REPLACE EXISTING ROOF WITH ASPHALT SHINGLES TO MATCH EXISTING.	
28. REMOVE AND REPLACE ANY EXISTING DAMAGED ROOF DECKING AS REQUIRED.	

SCOPE OF WORK - DEMOLITION NOTES	
DECK A	1 2 3 4 5 7 8 9 10 11 12 13 14 17 26
BUILDING	10
GAZEBO	27 28

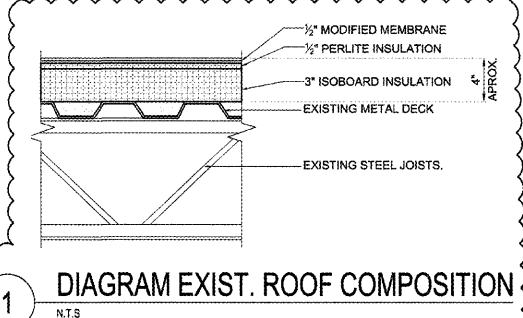

ABBREVIATIONS	
AAR	ABANDONED AIR PRESSURE RELIEF VALVE
ARV	ABANDONED ROOF VENT
AHU	AIR HANDLER UNIT
ANT	ANTENNAE
ANS	ANTENNAE SUPPORT
AS	ABANDON SUPPORT
CH	CHIMNEY
DFR	DEFLECTOR
DP	DOWNSPOUT
EC	ELECTRICAL CONDUIT
EF	EXHAUST FAN
EJ	EXPANSION JOINT
EL	ELECTRIC LIGHT
ESS	EQUIPMENT STANDPIPE
GNK	GOOSENECK
GTR	GUTTER
HP	HIGHT POINT
HS	HEAT STACK
LP	LOW POINT
NOS	NEW OVERFLOW SCUPPER
NORD	NEW OVERFLOW ROOF DRAIN
OS	OVERFLOW SCUPPER
P	PARAPET
PP	PIPE PENETRATION
PPN	PITCH PAN
RWL	RAIN WATER LEADER
RC	PHOTO CELL
RD	ROOF DRAIN
RF	ROOF FAN
RH	ROOF HATCH
RL	ROOF LADDER
RV	ROOF VENT
CSKY	CLOSED SKYLIGHT
S	SCUPPER
SB	SPLASHBLOCK
SL	SLOPE
SP	SPOTLIGHT
SUP.	SUPPORT
TP	NEW 3' TRAFFIC PAD
RRV	ROOF RELIEF VENT
VTR	VENT THROUGH ROOF
WH	WEATHERHEAD
WF	WALL FAN
WS	WORKING SCUPPER
NOD	NEW OVERFLOW DRAIN

LEGENDS	
	ROOFING AREA TO BE REPLACED.
	EXISTING ROOF SLOPE.
	PHOTOGRAPHS LOCATION.
	EXISTING VIDEO CAMERA TO REMAIN.

100% CONSTRUCTION DOCUMENTS
12-13-2017

NOTE: ALL DIMENSIONS AND EXACT LOCATION OF ALL EXISTING EQUIPMENT AND ASSOCIATED PARTS AND ACCESSORIES ARE TO BE FIELD VERIFIED BY THE CONTRACTOR.

KEYPLAN
SCALE: N.T.S.

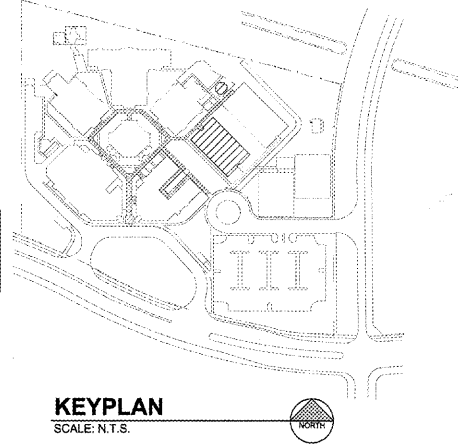

BUILDING 80- DEMOLITION ROOF PLAN
SCALE: 1/8" = 1'-0"

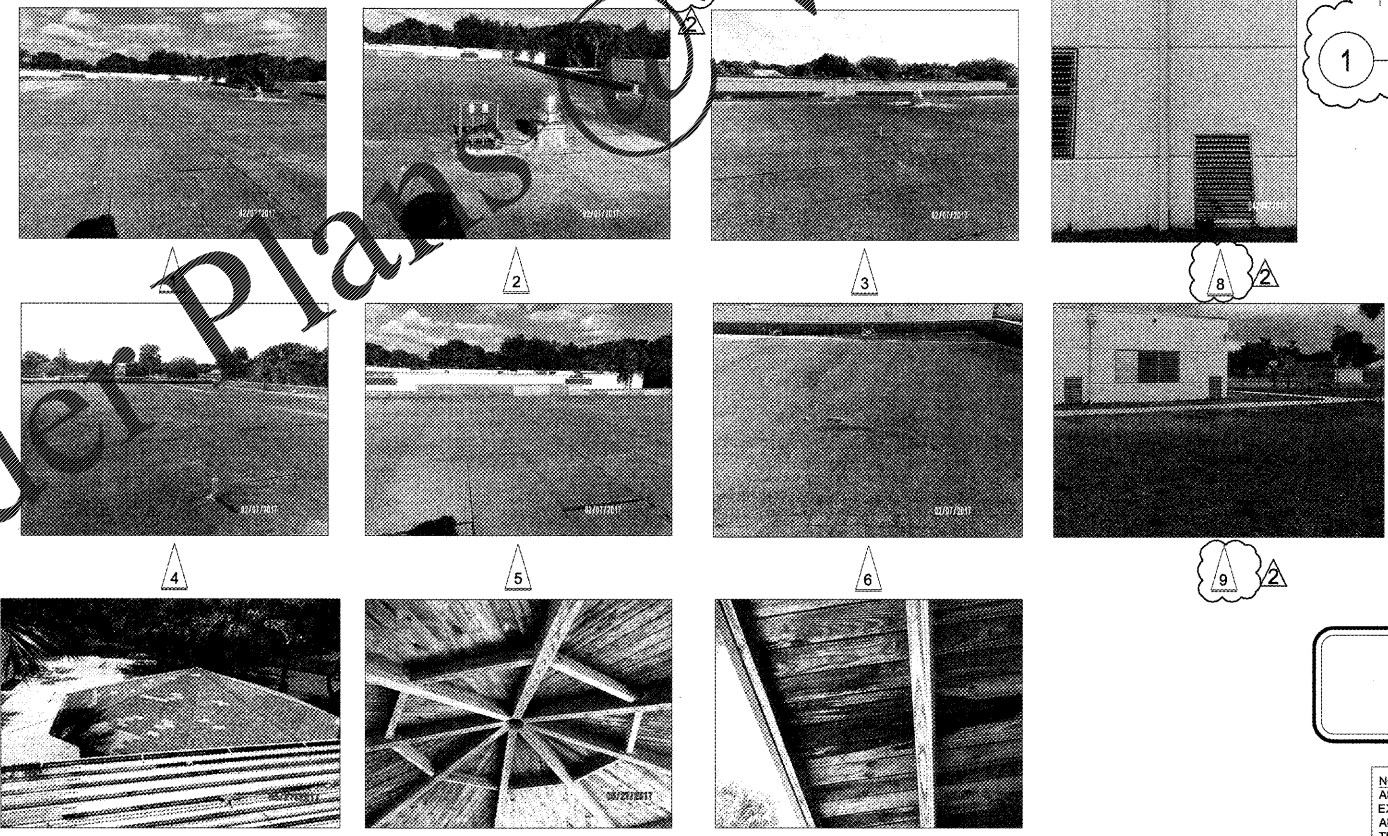
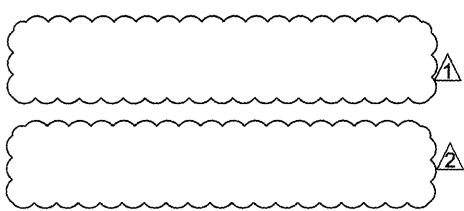

UNDERSIDE VIEW OF ROOF DECK

EXISTING DAMAGE ROOF DECKING

BUILDING 10- DEMOLITION ROOF PLAN
SCALE: 1/8" = 1'-0"

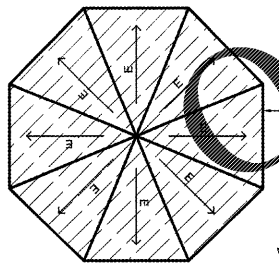

CRAIN ATLANTIS
ENGINEERING, INC.
CONSULTING ENGINEERS & ARCHITECTS
210 SW WATER AVENUE
SUITE 101
MIAMI, FL 33134
A/E: 20001859 EB: 27458

REVISIONS	BUILDING DEPARTMENT COMMENTS	BUILDING DEPARTMENT COMMENTS
02/23/2018		
06/05/2018		

SEA CASTLE
ELEMENTARY SCHOOL
9600 MIRAMAR BOULEVARD
MIRAMAR, FLORIDA 33025



BUILDING 10 & 80
DEMOLITION ROOF
PLAN

JOB PHASE: 100% CONSTRUCTION
SBBP PROJECT: P-001632
DATE: 12-13-2017
SCALE: AS SHOWN
DRAWN BY: C.A.E.
CHECKED BY: A.O./R.P.
ICAE PROJECT No. 2016.55

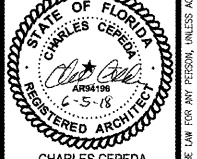

CHARLES CEPEDA
AR # 94196

DRAWING No.
A-6.0

THIS IS A WARNING OF THE LAW FOR ANY PERSON, UNLESS ACTING UNDER THE DIRECTION OF A LICENSED ARCHITECT, TO ALTER THESE PLANS AND SPECIFICATIONS. THIS DOCUMENT CONTAINS PROPERTY INFORMATION AND SHALL NOT BE USED OR REPRODUCED, OR ITS CONTENTS DISCLOSED, IN WHOLE OR IN PART, WITHOUT THE PRIOR WRITTEN CONSENT OF CRAIN ATLANTIS ENGINEERING, INC. COPYRIGHT 2014 CRAIN ATLANTIS ENGINEERING, INC.