

THIS DOCUMENT IS NOT
FOR REGULATORY
APPROVAL, PERMITTING,
OR CONSTRUCTION.

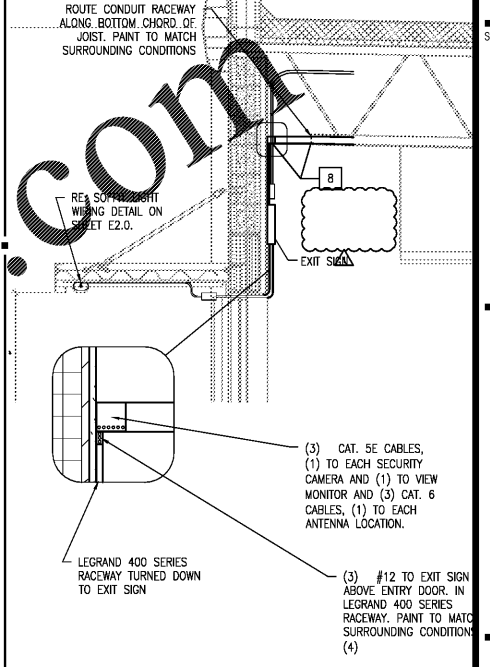
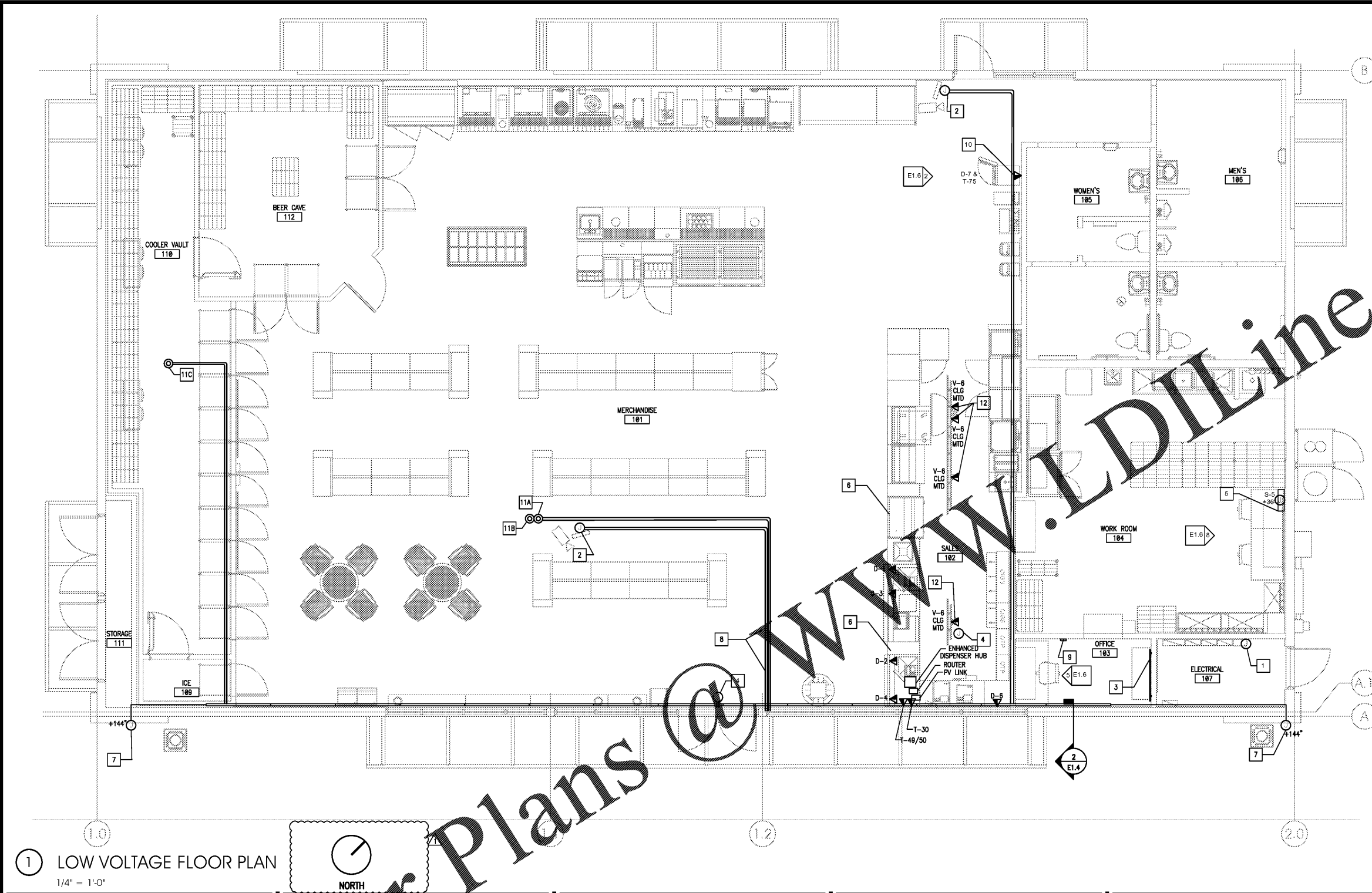

2 WALL SECTION AT STOREFRONT NTS

KEYED NOTES

- ENERGY MANAGEMENT ENCLOSURE PROVIDED BY OTHERS.
- VIEW MONITOR: ROUTE CONDUIT BACK TO VIDEO RECORDING EQUIPMENT LOCATED IN MANAGER'S OFFICE. COORDINATE LOCATION WITH SECURITY SYSTEM INSTALLER. REFER TO LOW VOLTAGE RISER DIAGRAM FOR WIRING REQUIREMENTS.
- TELEPHONE BOARD: 4'x4'x3/4" PLYWOOD WITH (1) #6 CU. GROUND FOR FUTURE USE MOUNTED ABOVE 4'x4'x3/4" PLYWOOD WITH (1) #6 CU. GROUND PER TELE. CO. REQUIREMENTS. MOUNT RECEPTACLE ADJACENT TO OR ABOVE TELEPHONE BOARD. DO NOT MOUNT BELOW.
- SECURITY CAMERA-ROUTE CONDUIT BACK TO VIDEO RECORDING EQUIPMENT LOCATED IN MANAGER'S OFFICE. COORDINATE LOCATION WITH SECURITY SYSTEM INSTALLER.
- VEEDER ROOT: COORDINATE INSTALLATION WITH FUELING PLANS. INSTALL IN ACCESSIBLE LOCATION. MOUNT AT 36" A.F.F. TO BOTTOM.
- ROUTE WIRING FOR DATA DEVICES UNDER SLAB, RE: 1/E1.2
- MOUNT +12" AFF, ROUTE CONDUIT BACK TO VIDEO RECORDING EQUIPMENT LOCATED IN MANAGER'S OFFICE. COORDINATE LOCATION WITH CONSTRUCTION MANAGER AND SECURITY SYSTEM INSTALLER.
- LOW VOLTAGE AND LINE VOLTAGE WIRING IN OPEN CEILING AREAS SHALL BE ROUNDED THROUGH A NONMETALLIC RACEWAY SYSTEM AT THE STOREFRONT AND DOWN TRUSSES AS NEEDED. THERE SHALL BE NO EXPOSED WIRING IN THE SALES AREA. OWNER TO PROVIDE LEGRAND 400 SERIES SYSTEM WITH ALL FITTINGS AND DEVICE BOXES REQUIRED FOR CONNECTION TO EXIT SIGN. OWNER TO ALSO PROVIDE PANDUIT 2X2 FIBERRUNNER ROUTING SYSTEM FOR ALL LOW VOLTAGE CABLING. RE:1/E1.4 FOR LOW VOLTAGE ROUTING.
- CRADLEPOINT WIRELESS INTERNET CONNECTION. THIS WILL BE THE LAST ISP RELATED DEVICE TO BE INSTALLED. THE LOCATION IN THE STORE WILL BE BASED ON THE STRONGEST SIGNAL WITHIN THE STORE. GUIDELINES FOR THE LOCATION OF THE CP ARE AS FOLLOWS:
 - AS FAR AWAY AS POSSIBLE FROM THE ELECTROMAGNETIC INTERFERENCE (MOTORS)
 - AS CLOSE TO THE CEILING AS POSSIBLE
 - POSITIONED SO THE LED LIGHTING SIGNALS ARE VISIBLE FOR TROUBLE SHOOTING / MAINTENANCE PURPOSES
 - MAXIMUM OF 4'-6" OF PATCH CABLE VISIBLE ON THE WALL (COLOR: WHITE)
- RJ11 FLUSH MOUNT FACE PLATE FOR ATM DATA LINE TO RIS COMPUTER WITH JACK TO BE LABELED 'ATM'. DATA LINE IDENTIFIER, D-7
- ACCESS POINT EXTENDED ANTENNA CABLES, FOUR CAT 5 CABLES, RJ45 FEMALE IN A 4-FLEX, COVER PLATE LABELED TO 3 LOCATIONS BELOW:
 - A. CAT6 RJ45 FEMALE JACK CENTER OF SALES FLOOR SUSPENDED ABOVE CEILING TILE (MAY NEED TO MOVE LATER). 100' IN TOTAL LENGTH WITH EXTRA COILED AT FEMALE JACK
 - B. CAT6 RJ45 FEMALE JACK CENTER OF SALES FLOOR SUSPENDED ABOVE CEILING TILE (MAY NEED TO MOVE LATER). 100' IN TOTAL LENGTH WITH EXTRA COILED AT FEMALE JACK.
 - C. CAT6 RJ45 FEMALE JACK IN RECEPTACLE 84" ABOVE FLOOR - CENTER OF WALK-IN COOLER.
- FOUR DIGITAL MENU BOARDS (DMB) WITH MEDIA PLAYERS. INCLUDED IN ALL U.S. NEW STORE PROJECTS AND ALL U.S. REVITALIZATION PROJECTS (REBUILD, RELOCATION, MAJOR REMODEL) EFFECTIVE 1/01/2018. HARDWARE SEI SUPPLIED THROUGH CONTACT WITH AT&T (CONSOLIDATED PO TO AT&T THROUGH TURNKEY RESOURCES). ELECTRICAL POWER AND LOW VOLTAGE POWER BY G.C. COMMISSIONING IS SEI SUPPLIED THROUGH CONTRACT AT&T (DIRECT PO TO AT&T). SUBSCRIPTION AND SERVICE AGREEMENT(S) BILLED DIRECT TO SEI IT DEPARTMENT SEPARATE FROM CONSTRUCTION PROJECTS.

1 LOW VOLTAGE FLOOR PLAN
1/4" = 1'-0"

DATA				
DESIGNATION	LINE	CONDUIT	SIZE	FROM
D-1	COMPUTER AT REGISTER #1	IN SLAB	1"	10" X 10" J-BOX @ WORKSTATION AREA - SALES AREA
D-2	COMPUTER AT REGISTER #2	IN SLAB	1"	10" X 10" J-BOX @ WORKSTATION AREA - SALES AREA
D-3	HOLD-UP BUTTON	IN SLAB	1"	10" X 10" J-BOX @ WORKSTATION AREA - SALES AREA - REGISTER #1
D-4	CAMERA SIGNAL	THROUGH CEILING	1"	10" X 10" J-BOX @ WORKSTATION AREA - REGISTER #1
D-5	MONEY ORDER	IN SLAB	1"	10" X 10" J-BOX @ WORKSTATION AREA - (ELECTRIC ROOM) FUEL TANKS REFER TO E1.6
D-6	ATG	THROUGH CONDUIT TO ELECTRIC ROOM	1"	ISP DESK - ATG MONITOR
D-7	LOTTO	THROUGH CONDUIT IN SLAB	1"	10" X 10" J-BOX @ WORKSTATION AREA - SALES AREA
D-8	ATM	THROUGH OVERHEAD CONDUIT	1"	10" X 10" J-BOX @ WORKSTATION AREA - VCOM WALL

NOTE: ALL DATA LINES TRAVEL FROM DEMARC THROUGH 3" CONDUIT TO 10" X 10" J-BOX IN CEILING, DOWN THROUGH WALL INTO 10" X 10" J-BOX BEHIND RIS DESK.

PHONES				
DESIGNATION	LINE	CONDUIT	SIZE	FROM
T-49/50	STORE VOICE LINE, LOCATED AT SALES AREA, MGR'S OFFICE & RIS WORK STATION.	THROUGH CONDUIT	1"	TELEPHONE BOARD - BACK ROOM 10" X 10" J-BOX & THEN TO FRONT SALES COUNTER
T-30	MONEY ORDER, LONG DISTANCE CARDS (LDC) AND EBT (FOOD STAMP PROGRAM)	THROUGH CONDUIT	1"	TELEPHONE BOARD TO RIS, FROM RIS 10" X 10" TO SALES - FRONT SALES COUNTER
T-39	FAX LINE AT RIS WORKSTATION	THROUGH CONDUIT	1"	TELEPHONE BOARD ABOVE CLG TO RIS 10" X 10" - WORKSTATION(REFER TO E1.6)
T-75	V-COM LINE	THROUGH CONDUIT	1"	TELEPHONE BOARD - ATM LOCATION
T-68/72	SECURITY LINE/ POLICE/ FIRE LOCATED AT TELEPHONE BOARD	THROUGH CONDUIT	1"	TELEPHONE BOARD TO RIS 10" X 10", TO MGR'S OFFICE & REG #1 - TELEPHONE BOARD OUTLET(REFER TO E1.6)
T-63/64	PAY TELEPHONE'S SHARED REVENUE TELEPHONES	SEE SITE PLAN	1"	TELEPHONE BOARD - SEE SITE PLAN

NOTE: ALL PHONE LINES TRAVEL FROM DEMARC THROUGH 3" CONDUIT TO 10" X 10" J-BOX MOUNTED ABOVE ISP.

GENERAL NOTES

- ALL WIRING IS COPPER. REFER TO ELECTRICAL SPECIFICATIONS FOR FURTHER INFORMATION.
- E.C. TO INSTALL DATA LINES IN CONDUIT TO BOXES INSTALLED BY LOW VOLTAGE CONTRACTOR LTCC PRIOR TO TYCO CAMERA INSTALLATION.
- CONDUITS THAT ARE EXPOSED TO WIDELY DIFFERENT TEMPERATURES, SUCH AS COOLERS, FREEZERS OR SERVICE ENTRANCE CONDUCTORS, SHALL BE SEALED TO PREVENT CIRCULATION OF AIR AND/OR MOISTURE. REF 2017 NEC (300.7 (A))
- CONDUIT AND WIRING IN AREAS WHERE EXPOSED SHALL BE ROUTED AT 90 DEGREE ANGLES PERPENDICULAR OR PARALLEL TO JOISTS. COORDINATE PAINTING OF CONDUIT WITH ARCHITECTURAL FINISHES.
- UNLESS OTHERWISE DICTATED BY APPLICABLE CODES OR AHJ, ALL MATERIALS WITHIN RETURN AIR PLENUM MUST BE NON COMBUSTIBLE AND/OR HAVE A FLAME SPREAD INDEX OF NOT MORE THAN 25 AND A SMOKE-DEVELOPED INDEX NOT MORE THAN 50 IN ACCORDANCE WITH ASTM E 84 TESTING.
- DATA TELEPHONE CABLING PROVIDED BY LTCC. CONTACT GREGORY LEVALDS (972) 801-9950. CONDUIT AND BOXES TO BE FURNISHED BY OWNER AND INSTALLED BY G.C.
- ALL LOW VOLTAGE CABLING SHALL BE RAN IN RACEWAY, AND INSTALLED IN A CLEAN WORKMAN LIKE MANNER. THERE SHALL BE NO EXPOSED CABLING IN THE SALES AREA.

NO.	DATE	REVISIONS
1	03.18.19	PEER COMMENTS



BID SET
JUNE 27, 2019

**7-ELEVEN
STORE #38777**

12060 US 301 N
PARRISH, FL
34219

PROJECT NO: 2018.0891
DATE: FEBRUARY 26, 2019

E1.4
LOW VOLTAGE FLOOR PLAN

CHECKED: BKJ DRAWN: MM