

ITEM	DESCRIPTION	QTY	EA	LOC	UNIT	UTIL	CON	ELEC. CONN.	COMMENTS
1	HOB MANAGEMENT SYSTEM	1	EA	A					STUB UP ELECTRICAL CONNECTION. PROVIDE OUTLET AND DATA.
2	WATER PROOF GULLY UNIT	1	EA	A					BY OWNER.
3	WATER PROOF GULLY UNIT	1	EA	A					ELECTRICAL CONNECTION FROM ABOVE. BY OWNER. VERIFY REQUIREMENTS. PROVIDE DATA.
4	WATER PROOF GULLY UNIT	1	EA	A					10-20 AMP CONVENIENCE OUTLET.
5	WATER PROOF GULLY UNIT	1	EA	A					UTILITY OUTLET. MOUNT HORIZONTALLY.
6	WATER PROOF GULLY UNIT	1	EA	A					E.C. TO PROVIDE AND MOUNT DUPLEX OUTLET TO UNDERSIDE OF BLENDER STATION AND TO INTERCONNECT FROM 1 BOX TO OUTLET.
7	WATER PROOF GULLY UNIT	1	EA	A					ROUTE TRIM GROMMET HOLE TO OUTLET MOUNTED TO BLENDER STATION.
8	WATER PROOF GULLY UNIT	1	EA	A					ROUTE TRIM GROMMET HOLE TO OUTLET MOUNTED TO BLENDER STATION.
9	WATER PROOF GULLY UNIT	1	EA	A					UTILITY OUTLET. MOUNT HORIZONTALLY.
10	WATER PROOF GULLY UNIT	1	EA	A					UTILITY OUTLET. MOUNT HORIZONTALLY.
11	WATER PROOF GULLY UNIT	1	EA	A					UTILITY OUTLET. MOUNT HORIZONTALLY.
12	WATER PROOF GULLY UNIT	1	EA	A					UTILITY OUTLET. MOUNT HORIZONTALLY.
13	WATER PROOF GULLY UNIT	1	EA	A					UTILITY OUTLET. MOUNT HORIZONTALLY.
14	WATER PROOF GULLY UNIT	1	EA	A					UTILITY OUTLET. MOUNT HORIZONTALLY.
15	WATER PROOF GULLY UNIT	1	EA	A					UTILITY OUTLET. MOUNT HORIZONTALLY.
16	WATER PROOF GULLY UNIT	1	EA	A					UTILITY OUTLET. MOUNT HORIZONTALLY.
17	WATER PROOF GULLY UNIT	1	EA	A					UTILITY OUTLET. MOUNT HORIZONTALLY.
18	WATER PROOF GULLY UNIT	1	EA	A					UTILITY OUTLET. MOUNT HORIZONTALLY.
19	WATER PROOF GULLY UNIT	1	EA	A					UTILITY OUTLET. MOUNT HORIZONTALLY.
20	WATER PROOF GULLY UNIT	1	EA	A					UTILITY OUTLET. MOUNT HORIZONTALLY.
21	WATER PROOF GULLY UNIT	1	EA	A					UTILITY OUTLET. MOUNT HORIZONTALLY.
22	WATER PROOF GULLY UNIT	1	EA	A					UTILITY OUTLET. MOUNT HORIZONTALLY.
23	WATER PROOF GULLY UNIT	1	EA	A					UTILITY OUTLET. MOUNT HORIZONTALLY.
24	WATER PROOF GULLY UNIT	1	EA	A					UTILITY OUTLET. MOUNT HORIZONTALLY.
25	WATER PROOF GULLY UNIT	1	EA	A					UTILITY OUTLET. MOUNT HORIZONTALLY.
26	WATER PROOF GULLY UNIT	1	EA	A					UTILITY OUTLET. MOUNT HORIZONTALLY.
27	WATER PROOF GULLY UNIT	1	EA	A					UTILITY OUTLET. MOUNT HORIZONTALLY.
28	WATER PROOF GULLY UNIT	1	EA	A					UTILITY OUTLET. MOUNT HORIZONTALLY.
29	WATER PROOF GULLY UNIT	1	EA	A					UTILITY OUTLET. MOUNT HORIZONTALLY.
30	WATER PROOF GULLY UNIT	1	EA	A					UTILITY OUTLET. MOUNT HORIZONTALLY.
31	WATER PROOF GULLY UNIT	1	EA	A					UTILITY OUTLET. MOUNT HORIZONTALLY.
32	WATER PROOF GULLY UNIT	1	EA	A					UTILITY OUTLET. MOUNT HORIZONTALLY.
33	WATER PROOF GULLY UNIT	1	EA	A					UTILITY OUTLET. MOUNT HORIZONTALLY.
34	WATER PROOF GULLY UNIT	1	EA	A					UTILITY OUTLET. MOUNT HORIZONTALLY.
35	WATER PROOF GULLY UNIT	1	EA	A					UTILITY OUTLET. MOUNT HORIZONTALLY.
36	WATER PROOF GULLY UNIT	1	EA	A					UTILITY OUTLET. MOUNT HORIZONTALLY.
37	WATER PROOF GULLY UNIT	1	EA	A					UTILITY OUTLET. MOUNT HORIZONTALLY.
38	WATER PROOF GULLY UNIT	1	EA	A					UTILITY OUTLET. MOUNT HORIZONTALLY.
39	WATER PROOF GULLY UNIT	1	EA	A					UTILITY OUTLET. MOUNT HORIZONTALLY.
40	WATER PROOF GULLY UNIT	1	EA	A					UTILITY OUTLET. MOUNT HORIZONTALLY.

ITEM	DESCRIPTION	QTY	EA	LOC	UNIT	UTIL	CON	ELEC. CONN.	COMMENTS
1	CONNECTION OVER BAR	1	EA	A					
2	CONNECTION OVER BAR	1	EA	A					
3	CONNECTION OVER BAR	1	EA	A					
4	CONNECTION OVER BAR	1	EA	A					
5	CONNECTION OVER BAR	1	EA	A					
6	CONNECTION OVER BAR	1	EA	A					
7	CONNECTION OVER BAR	1	EA	A					
8	CONNECTION OVER BAR	1	EA	A					
9	CONNECTION OVER BAR	1	EA	A					
10	CONNECTION OVER BAR	1	EA	A					
11	CONNECTION OVER BAR	1	EA	A					
12	CONNECTION OVER BAR	1	EA	A					
13	CONNECTION OVER BAR	1	EA	A					
14	CONNECTION OVER BAR	1	EA	A					
15	CONNECTION OVER BAR	1	EA	A					
16	CONNECTION OVER BAR	1	EA	A					
17	CONNECTION OVER BAR	1	EA	A					
18	CONNECTION OVER BAR	1	EA	A					
19	CONNECTION OVER BAR	1	EA	A					
20	CONNECTION OVER BAR	1	EA	A					
21	CONNECTION OVER BAR	1	EA	A					
22	CONNECTION OVER BAR	1	EA	A					
23	CONNECTION OVER BAR	1	EA	A					
24	CONNECTION OVER BAR	1	EA	A					
25	CONNECTION OVER BAR	1	EA	A					
26	CONNECTION OVER BAR	1	EA	A					
27	CONNECTION OVER BAR	1	EA	A					
28	CONNECTION OVER BAR	1	EA	A					
29	CONNECTION OVER BAR	1	EA	A					
30	CONNECTION OVER BAR	1	EA	A					
31	CONNECTION OVER BAR	1	EA	A					
32	CONNECTION OVER BAR	1	EA	A					
33	CONNECTION OVER BAR	1	EA	A					
34	CONNECTION OVER BAR	1	EA	A					
35	CONNECTION OVER BAR	1	EA	A					
36	CONNECTION OVER BAR	1	EA	A					
37	CONNECTION OVER BAR	1	EA	A					
38	CONNECTION OVER BAR	1	EA	A					
39	CONNECTION OVER BAR	1	EA	A					
40	CONNECTION OVER BAR	1	EA	A					

**GENERAL NOTES TO ELECTRICIAN:**

- ELECTRICAL CONTRACTORS TO OBTAIN ALL NECESSARY PERMITS AND INSTALLATION IS TO BE COMPLETE ACCORDANCE WITH ALL NATIONAL, STATE, AND LOCAL CODES.
- ELECTRICAL CONTRACTORS SHALL FURNISH ALL LABOR AND MATERIALS TO MAKE ALL FINAL CONNECTIONS AND SHALL INCLUDE ALL ITEMS REQUIRED BY APPLICABLE CODES.
- A CATALOG OF MANUFACTURERS EQUIPMENT SPECIFICATION SHEETS IS INCLUDED AS AN INTEGRAL PORTION OF THIS SUBMITTAL. WE SUGGEST THAT ALL TRADES REVIEW THE REQUIREMENTS AS INDICATED REGARDING EACH MANUFACTURER'S EXHAUST HOOD 192.
- CROSS REFERENCE ALL INFORMATION PER ROUGH-IN DRAWINGS WITH EQUIPMENT SCHEDULE.
- ELECTRICAL CONTRACTORS TO CROSS REFERENCE ROUGH-IN DRAWINGS, STAINLESS STEEL, FABRICATION, WALK-IN DRAWINGS, EXHAUST HOOD DRAWINGS, AND MILLWORK DETAIL DRAWINGS.
- ELECTRICAL CONTRACTORS TO PROVIDE CONTROL WIRING BETWEEN WALK-IN FREEZER COIL AND REMOTE CONDENSER TO ACCOMMODATE DEFROST CYCLE TIMER.
- ELECTRICAL CONTRACTORS TO SIZE AND SUPPLY STARTER MOTORS FOR EXHAUST HOOD FANS.
- LOCATION OF CONNECTIONS FOR ALL EXHAUST HOODS TO BE DETERMINED FROM FINISHED WALLS, FLOOR, OR CEILING.
- ELECTRICAL POWER TO COOLING EQUIPMENT REQUIRES SHALL BE PROVIDED THROUGH A MAIN TRIP CIRCUIT WITH FULL SHUT OFF. ELECTRICAL CONTRACTOR SHALL PROVIDE CIRCUIT TO MATCH THE COOLING SYSTEM CONTRACTOR'S HOOD TYPING SYSTEM.
- ELECTRICAL CONTRACTOR TO SUPPLY AND INSTALL CONTROL CIRCUITS FOR WALK-IN FREEZERS AND ALL WIRING BETWEEN COMPRESSORS AND COILS.
- ELECTRICAL CONTRACTOR TO RUN ALL ELECTRICAL CONDUCITS OUTSIDE THE 4-8 IN COILS. ALL RATED TRACES TO REFER TO DRAWING FS102.
- ALL ELECTRICAL EQUIPMENT SCHEDULES:

- GO TO PROVIDE ROOF PENETRATIONS, PITCH POCKETS, PRESSURE TREATED LUMBER, AND RESEALING OF ROOF FOR REMOTE REFRIGERATION, ELECTRICAL LINES, AND PATE CURBS.
- ELECTRICAL CONTRACTOR TO PROVIDE 3/4" EMT BETWEEN POS SYSTEMS AND OFFICE FOR CASH REGISTER DATA CABLE. BELDEN FIBERGLASS CABLE IS TO BE FURNISHED AND INSTALLED BY ELECTRICIAN WITH FINAL CONNECTIONS BY REGISTER VENDOR.
- PROVIDE QUAD RECEPTACLE AT MASTER REGISTER. ADD QUAD RECEPTACLE AT OFFICE LOCATION. ALL RECEPTACLES FOR REGISTER AND RECEPTACLE IN OFFICE TO BE ON SAME DEDICATED CIRCUIT WITH ISOLATED GROUND.
- BELDEN CABLE #48348 IS TO RUN FROM LOCATION "S" TO LOCATION "A" AND FROM LOCATION "C" TO LOCATION "A". CONDUIT FROM LOCATION A TO OFFICE IS TO HAVE FULL STRING ONLY - NO CABLE.



Mark S. Salopek, LLC  
 3638 West Galloway Drive  
 Richmond, OH 44286  
 330.572.2112 / 330.572.2102

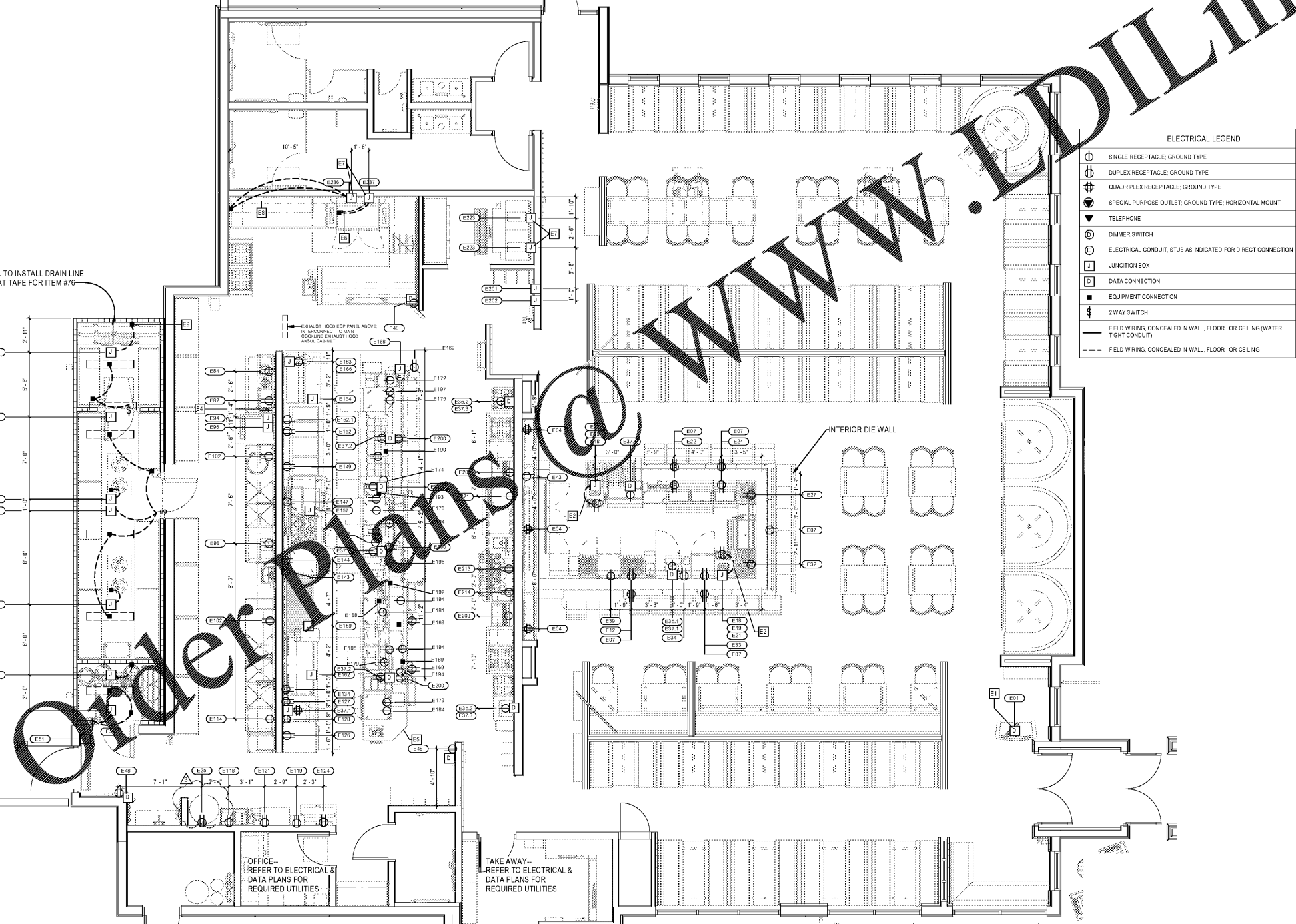

**FOODSERVICE EQUIPMENT ELECTRICAL REQUIREMENTS PLAN**  
 14" x 11"  
 FS301

BLOOMING BRANDS  
**HIALEAH, FL - OUTBACK STEAKHOUSE**  
 1751 W 40TH STREET  
 HIALEAH, FLORIDA 33012

SHEET ISSUE  
 OUT TO PERMIT  
 3 6/17/19 Revision 3 3/21/19

PRINCIPAL CHARGE MS  
 PROJECT ARCHITECT TDO  
 DRAWN BY TDO

SHEET TITLE  
**FOODSERVICE EQUIPMENT ELECTRICAL REQUIREMENTS**

PROJ. NO.  
**FS301**  
 201823120