

**SHEET KEYNOTES**

1. WEATHERPROOF GFCI RECEPTACLE PROVIDED WITH RTU AND WIRED BY ELECTRICAL CONTRACTOR.
2. DISCONNECT SWITCH IS FACTORY INSTALLED ON UNIT. ELECTRICAL CONTRACTOR SHALL WIRE TO UNIT. IF MANUFACTURER REQUIRES FUSES, CONTRACTOR SHALL SUPPLY FUSIBLE DISCONNECT SWITCH (W.P.) SIZED AND FUSED AS PER MANUFACTURER'S RECOMMENDATIONS.
3. 200V, 1PH, NEMA 3R WATERPROOF DISCONNECT SWITCH ON ROOF FOR ICE CUBE & KEG COOLER CONDENSER. INTERCONNECT W/ ICE MACHINE PER MANUFACTURER'S REQUIREMENTS.
4. ELECTRICAL CONTRACTOR TO SUPPLY AND INSTALL CONTROLS WIRING BETWEEN CONDENSER HOOD FAN AND DISHWASHER CONTROL PANEL. TO TURN FAN ON WHEN DISHWASHER IS ON AND TURN FAN OFF 5 MINUTES AFTER DISHWASHER TURNS OFF. FAN SHALL ALSO RUN WHENEVER BOOSTER HEATER IS OPERATING. VERIFY ELECTRICAL REQUIREMENTS WITH MFG.
5. LED DRIVER MOUNTED INSIDE IN ACCESSIBLE LOCATION WITH CONNECTION TO LIGHTING SYSTEM AT TOP AND BOTTOM OF TOWER PER MANUFACTURER'S REQUIREMENTS.
6. PROVIDE POWER AND CONTROL WIRING IN EMT FROM WALK-IN COOLER, KEG COOLER & WALK-IN FREEZER CONDENSERS TO RESPECTIVE EVAPORATORS BELOW.
7. FUSED SAFETY SWITCH, NEMA 3R, W/ GROUNDING KIT, FUSED PER MFG. REQUIREMENTS.
8. ICE MACHINE REMOTE CONDENSER.
9. WALK-IN COOLER CONDENSER.
10. WALK-IN FREEZER CONDENSER.
11. KEG COOLER CONDENSER.
12. TO BE SWITCHED W/ RESTROOM LIGHTS. REFER TO DETAIL ON SHEET E101.
13. ELECTRICAL FEED TO BE ON HINGED SIDE OF FAN TO PERMIT ACCESS TO CLEAN FIELD COORDINATE.
14. ROUTE CONDUIT & WIRING BELOW ROOF & THRU EQUIPMENT CABINETS.
15. DISCONNECT IS FURNISHED WITH FAN. INSTALLED BY ELECTRICAL CONTRACTOR. REFER TO SCHEDULE ON SHEET M301.
16. WIRED THRU HOOD WIRING CABINET.
17. PROVIDE WIRE PER MANUFACTURER'S RECOMMENDATIONS IN HOOD. ICE MACHINE BELOW REFER TO KEG COOLER FOR ADDITIONAL INFORMATION. LIGHTING CONTROL DIAGRAMS, SHEET E301.
18. WEATHER PROOF J-BOX AND DISCONNECT TO BUILD OUT RANGE. VERIFY LOCATION WITH SIGN SUPPLIER BEFORE INSTALLING.
19. TO BUILDING ELECTRICAL REFER TO SHEET E201 AND A 202 FOR LOCATIONS.
20. TO TAKE ELECTRICAL FROM WALK-IN COOLER TO SUPERIOR ELEVATORS. FOR LOCATIONS.
21. EXTEND CONDUIT AND WIRING TO SUPERIOR ELEVATORS.
22. LOCATION TO DIRECT TV ON ROOF.
23. WEATHERPROOF GFCI RECEPTACLE MOUNTED ON HINGED SIDE OF EXHAUST FAN.

**PRIORITY OF CONSTRUCTION**

- A. FIRST DUCTWORK
- B. SECOND: FIRE PROTECTION PIPING
- C. THIRD: ANY PIPING WITH SLOPE REQUIREMENTS
- D. FOURTH: OTHER PIPING
- E. FIFTH: CONDUIT

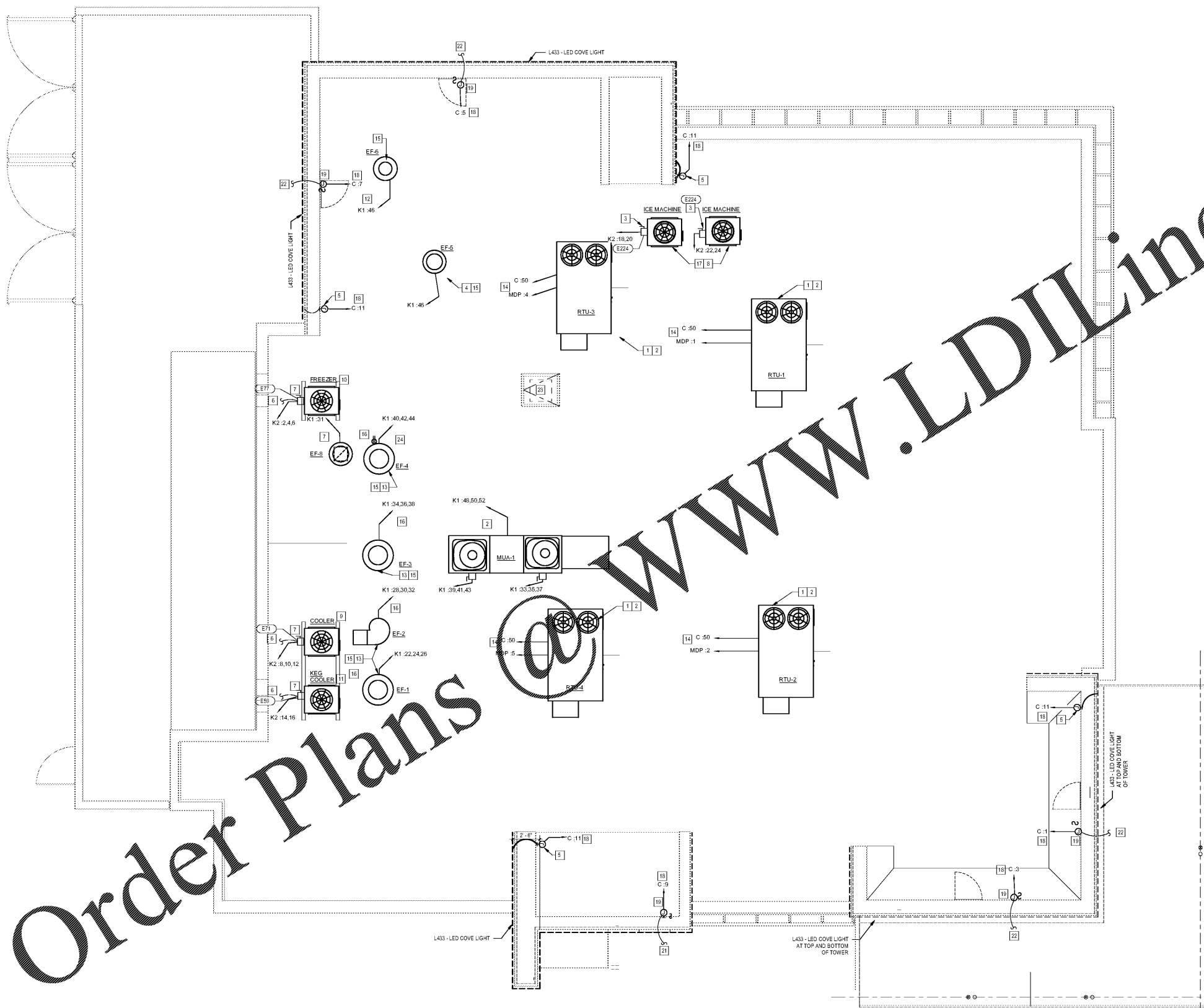

**ELECTRICAL ROOF PLAN**  
E200 1/4" = 1'-0"



BLOOMING BRANDS  
**OUTBACK STEAKHOUSE**  
1751 W 49TH STREET  
HALEAH, FLORIDA 33012

SHEET ISSUE  
OUT TO PERMIT:

PRINCIPAL IN CHARGE: JC  
PROJECT ARCHITECT: MS  
DRAWN BY: BM

SHEET TITLE  
**ELECTRICAL ROOF PLAN**

SHEET NO. PROJ. NO.  
E200 2018231 50

**E200**