

OWNERS POS CORPORATE REPRESENTATIVE
 OUTBACK STEAKHOUSE INC.
 LIZ ZAMBLER
 2202 NORTH WEST SHORE BLVD.
 TAMPA, FL 33607
 PH: (813) 282-4225 FAX: (813) 289-2584
 E-MAIL: LZAMBLER@OUTBACK.COM

GENERAL NOTES

- A. REFER TO SHEET E201 FOR PANEL SCHEDULES.
- B. REFER TO SHEET F5-301 FOR DIMENSIONED ROUGH-IN & CONNECTOR REQUIREMENTS.
- C. REFER TO E401 FOR GENERAL NOTES.
- D. REFER TO E401 FOR LEGEND.
- E. LOCAL STATE CODES REQUIRE FIRE CABLING TO BE IN CONDUIT, THE EC SHALL BE RESPONSIBLE TO FURNISH 3/4" C UNDER BASE BID.
- F. REFER TO F401 FOR FIRE ALARM DEVICES.

PRIORITY OF CONSTRUCTION

- A. FIRST: DUCTWORK
- B. SECOND: FIRE PROTECTION PIPING
- C. THIRD: ANY PIPING WITH SLOPE REQUIREMENTS
- D. FOURTH: OTHER PIPING
- E. FIFTH: CONDUIT

SHEET KEYNOTES

1. PROVIDE TELEPHONE TERMINAL BOARD 2'x4'x3/4" PLYWOOD BOARD PAINTED WITH FIRE RETARDANT GRAY PAINT. MOUNT OUTLET ABOVE SERVICE EQUIPMENT. WIRING FROM BUS TERMINAL & AN CU BONDING JUNCTION TO SERVICE EQUIPMENT. INSTALL PER UTILITY CO REQUIREMENTS. NEW CONDUIT REQUIRED TO UTILITY CO TO SERVICE CONNECTION POINT. SERVICE POINT ATT 25' MIN. OVER W/ILANDLORD. MOUNT AS HIGH AS POSSIBLE TO WATER SOURCE.
2. PROVIDE A 4'x4" J-BOX WITH A 2" DIA. HOLE THROUGH DOOR FOR CONDUIT BOX AT 40" A.F.F. NEED 3/4" TO BE PROVIDED THROUGH DOOR FOR CONDUIT BOX AT 40" A.F.F.
3. CONTAINS (2) DATA J-BOX @ HEIGHT INDICATED WITH 3/4" CONDUIT AND PULL WIRE TO 12" ABOVE CEILING FURNISHED AND INSTALLED BY ELECTRICAL CONTRACTOR. IF HEIGHT IS NOT SHOWN, MOUNT AT SAME HEIGHT AS OUTLET. OWNER'S VENDOR TO INSTALL FACE PLATE AND WIRING FROM J-BOX TO APPLICABLE TERMINATION LOCATION. TERMINATIONS AT ALL REGISTERS AND PATCH PANEL BY OUTBACK STEAKHOUSE.
4. SOUND SYSTEM J-BOX. VERIFY QUANTITY & MOUNTING HEIGHT. OWNER'S REP & SOUND SYSTEM INSTALLER PROVIDE 3/4" WITH PULL STRING.
5. SOUND SYSTEM J-BOX @ 7' F.F. W/2" WITH PULL WIRE TO ELL 6" ABOVE CEILING. REFER TO OTHER SHEETS FOR EXACT MOUNTING HEIGHTS AND LOCATIONS OF SOUND SYSTEM DEVICES PRIOR TO ROUGH IN.
6. SINGLE GANG J-BOX MOUNTED 24" BELOW CEILING WITH 3/4" CONDUIT.
7. SINGLE GANG J-BOX MOUNTED 24" BELOW CEILING WITH 3/4" CONDUIT.
8. SINGLE GANG J-BOX WITH PULL WIRE THRU SLAB ABOVE CEILING FOR TELEVISION CONNECTION TO SURVEILLANCE CAMERA. VERIFY LOCATION WITH OWNER.
9. ALL EQUIPMENT POWER AND DATA SHALL BE RUN IN BAR DIE WALL. SIMILAR TO NOTE 1 ABOVE EXCEPT MOUNTED ABOVE DOOR OF OFFICE FOR OWNER TELEPHONE EQUIPMENT.
10. CONTAINS (3) VOICE AND (1) DATA. USE ONE FLOOR BOX FOR DATA AND POWER. SEE NOTE 21 SHEET E102 W/1" CONDUIT UNDER SLAB TO WALL AND EXTEND CONDUIT 12" ABOVE CEILING. OWNER'S VENDOR TO INSTALL FACE PLATE AND WIRING FROM J-BOX TO APPLICABLE TERMINATION LOCATION.
11. CONTAINS (1) DATA FOR WIRELESS ACCESS POINT. OCTAGON J-BOX 10" A.F.F. FURNISHED AND INSTALLED BY ELECTRICAL CONTRACTOR. OWNER'S VENDOR TO INSTALL FACE PLATE AND WIRING FROM J-BOX TO APPLICABLE TERMINATION LOCATION. TERMINATIONS AT ALL REGISTERS AND PATCH PANEL BY OUTBACK STEAKHOUSE.
12. J-BOXES (1) @ 5'4" A.F.F. FOR T-STAT W/1" TO REMOTE SENSOR LOCATION AS INDICATED. COORDINATE W/ MECHANICAL CONTRACTOR. (STAGGER OR MOUNT IN (2) ROWS IF NEEDED).
13. CONTAINS (1) DATA. SINGLE GANG J-BOX CEILING MOUNTED WITH 3/4" CONDUIT AND PULL WIRE TO 12" ABOVE CEILING. FURNISHED AND INSTALLED BY ELECTRICAL CONTRACTOR. IF HEIGHT IS NOT SHOWN, MOUNT AT SAME HEIGHT AS OUTLET. OWNER'S VENDOR TO INSTALL FACE PLATE AND WIRING FROM J-BOX TO APPLICABLE TERMINATION LOCATION. TERMINATIONS AT ALL REGISTERS AND PATCH PANEL BY OUTBACK STEAKHOUSE.
14. TRIPLE PHONE JACK @ 5'5" A.F.F. J-BOX AT HEIGHT INDICATED WITH 3/4" CONDUIT TO 12" ABOVE CEILING. FURNISHED AND INSTALLED BY ELECTRICAL CONTRACTOR. IF HEIGHT IS NOT SHOWN, MOUNT AT SAME HEIGHT AS OUTLET. OWNER'S VENDOR TO INSTALL FACE PLATE AND WIRING FROM J-BOX TO APPLICABLE TERMINATION LOCATION.
15. CONTAINS (1) DATA. J-BOX @ CEILING. FIELD COORDINATE EXACT LOCATIONS & REQUIREMENTS W/ OUTBACK'S P.O.S. SUPPLIER PRIOR TO ROUGH-IN. OWNER'S VENDOR TO INSTALL FACE PLATE AND WIRING FROM J-BOX TO APPLICABLE TERMINATION LOCATION.
16. P.O.S. CONDUITS TO STUB-OUT ABOVE COUNTER. P.O.S. 12 PORT PATCH PANEL HUB FOR COMM WIRING. LOCATED ABOVE COUNTER AT OFFICE P.C. CONTAINS 12 PORT CATEGORY 5 MINI PATCH. HINGED 5888 (88V OR 851046510). TERMINATIONS AT ALL REGISTERS AND PATCH PANEL BY OUTBACK STEAKHOUSE.
17. CONTAINS (1) VOICE AND (2) DATA. J-BOX AT HEIGHT INDICATED WITH 3/4" CONDUIT TO ELL 12" ABOVE CEILING. FURNISHED AND INSTALLED BY ELECTRICAL CONTRACTOR. MOUNT AT 43" AFF. OWNER'S VENDOR TO INSTALL FACE PLATE AND WIRING FROM J-BOX TO APPLICABLE TERMINATION LOCATION. TERMINATIONS AT ALL REGISTERS AND PATCH PANEL BY OUTBACK STEAKHOUSE.
18. OUTLET AND J-BOX W/3/4" C. TO 12" ABOVE ACCESSIBLE CEILING. MOUNT @ 7'0" A.F.F. FOR SECURITY MONITOR.
19. CONDUIT TO BE RUN FROM NEAREST FULL HEIGHT WALL THEN UNDER SLAB AND CONCEALED IN BAR DIE WALL (AS REQUIRED).
20. PROVIDE SINGLE GANG BOX WITH 2 TELEPHONE OUTLETS. PROVIDE 3/4" C TO FULL HEIGHT WALL FOR ROUTING OF TELEPHONE CABLES.

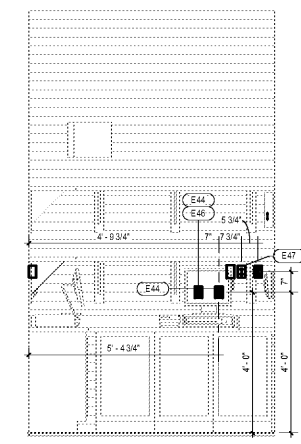
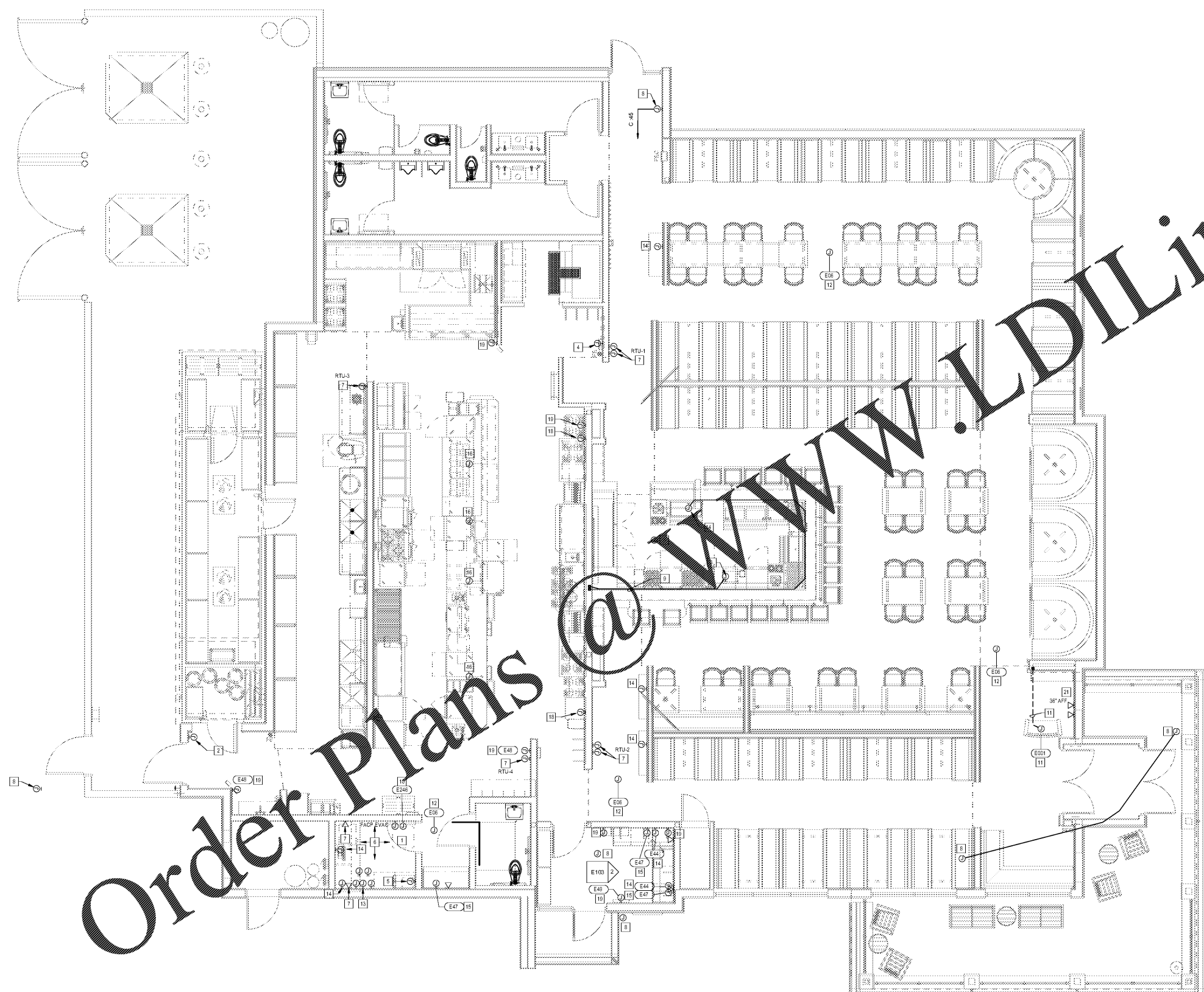

2 TAKE AWAY POS
 1/2" = 1'-0"

1 ELECTRICAL COMMUNICATIONS & DATA PLAN
 1/4" = 1'-0"



BLOOMIN BRANDS
 OUTBACK STEAKHOUSE
 1751 W 49TH STREET
 HALEAH, FLORIDA 33012

SHEET ISSUE
 OUT TO PERMIT:

PRINCIPAL IN CHARGE: JC
 PROJECT ARCHITECT: MS
 DRAWN BY: BM

SHEET TITLE
ELECTRICAL COMMUNICATIONS & DATA PLAN

SHEET NO. PROJ. NO.
 2018231 50

E103