

DECOR SCHEDULE

TYPE	DESCRIPTION
D192	ULURU GRAPHIC
D211C	SYDNEY MAP GRAPHIC
D273	BOXING KANGAROO GRAPHIC
D275	MAP OUTLINE GRAPHIC METAL PANEL
D276	GRAFFITI MURAL ART
D277	VERTICAL WOOD SLAT WALL, BY MILLWORK VENDOR

INTERIOR ELEVATION GENERAL NOTES

- REF A104 FOR ALL WALL FINISHES
- REF A201 FOR ALL CEILING HEIGHTS
- 0.5" WALL PAINT ALL INTERIOR HOLLOW METAL DOOR FRAMES IRON ORE, SEMI-GLOSS
- REF FOOD SERVICE FOR KITCHEN ELEVATIONS W/ EQUIPMENT
- ALL ITEMS PROVIDED BY MILLWORK CONTRACTOR SHALL BE INSTALLED BY G.C.
- FULL WALL HOLES IN WOOD WANSKOT, TRIM, CASINGS, ETC. TO MATCH FINISH OF WOOD
- REFERENCE ID100 FOR CASEWORK VENDOR ITEM SCHEDULE

SHEET KEYNOTES

- EXTERIOR WALL ALUMINUM STOREFRONT SYSTEM, DARK BRONZE FINISH, REF EXTERIOR ELEVATION 9 AND WALL SECTION 8
- INTERIOR ALUMINUM STOREFRONT, DARK BRONZE FINISH, REF SHEETS A102 AND A801
- 1X6 WOOD BASE WITH 3/4" QUARTER ROUND SHOE, STAIN S-02
- WOOD FRAME TRELLIS, REF SHEET A412
- BOOTHEATING
- LOW WALL, REFER TO WALL TYPES ON SHEET A102
- VINYL WALL BASE TO BE PLACED ON TOP OF CONCRETE CURB
- CONCRETE CURB, REF STRUCTURAL
- TELEPHONE TERMINAL BOARD, REF ELECTRICAL DRAWINGS
- MAIN SHUTOFF VALVE AND BACK FLOW PREVENTER, REF PLUMBING DRAWING
- WALL MOUNTED TANKLESS WATER HEATERS, REF ELECTRICAL DRAWING
- CASH DRAWER / POS TO BE BOLTED AND SECURED TO COUNTER
- 1/4" WINDOW DOOR TRIM, TOP SUPPLIED BY MC, INSTALLED BY G.C. S-18-06
- WATER FILTERS, REF SHEET FS11
- TRAY JACKS, NIC, 88 TO PROVIDE MOUNTING HEIGHT
- ELECTRICAL PANEL, REF ELECTRICAL DRAWING
- TIRE AND BED SPRING BOARD, NO PAINT
- FORESEEN BY FIRE PROTECTION CONTRACTOR, REF LET F-1
- EXTENT OF FRP WALL FINISH
- WATER SOFTENERS, REF ELECTRICAL DRAWING
- 4 1/2" RAISED SCOUR PLATFORM, REFER TO DETAILS A103 FOR ADDITIONAL INFORMATION
- DELIVERY MONITOR
- SURVEILLANCE MON
- PAIN WALLS ABOVE 6' IN O.P. DUCTS, HVAC GRILLS, ALL EXPOSED PIPING/CONDUIT, AND STRUCTURE
- UNDER LIGHTING UNDER COUNTER, REF ELECTRICAL
- FIRE EXTINGUISHER CASE COLOR TO MATCH BR-06

INTERIOR FINISH SCHEDULE

TYPE	COLOR NAME	COLOR #	PRODUCT NAME	FINISH
PT-05	NOMADIC DESERT	SW6107	SHERWIN WILLIAMS	EGGSHELL/BEIGE/GLOSS (REST ROOM ONLY)
PT-11	TURKISH COFFEE	SW6076	SHERWIN WILLIAMS	FLAT
PT-03	HIGH REFLECTIVE WHITE	SW7577	SHERWIN WILLIAMS	FLAT
PT-09	BOLERO	SW 7600	SHERWIN WILLIAMS	FLAT
PT-08	DOUBLE LATTÉ	SW 9138	SHERWIN WILLIAMS	FLAT

TYPE	COLOR NAME	COLOR #	PRODUCT NAME
S-02	PECAN	(SEE FORMULA BELOW)	-
S-06	KONA	(SEE FORMULA BELOW)	-
S-14	PLANKED WOOD FINISH	(SEE FORMULA BELOW)	-

NOTES:
S-05 & S-02 & S-14: PROVIDE SAMPLE TO BBI DESIGN & CONSTRUCTION FOR APPROVAL PRIOR TO APPLICATION; APPL. 2 COATS STAIN & 2 COATS SATIN POLYURETHANE (W.N.); SAND BETWEEN EACH APPLICATION.

OUTBACK STAIN FORMULAS PER GALLON

OUTBACK: KONA (S-06)	SHERWOOD W/SPRAY AND WIPE BASE - S54770057	3190 GRAMS
	SHERWOOD ALKYD STAIN (BLK) - D64XB4009	32 GRAMS
	SHERWOOD ALKYD STAIN (BROWN) - D64XXN500	35 GRAMS
OUTBACK: PECAN (S-02)	SHERWOOD W/SPRAY AND WIPE BASE - S54770057	2246 GRAMS
	SHERWOOD ALKYD STAIN (Y) - D64XY40021	50 GRAMS
	SHERWOOD ALKYD STAIN (RED) - D64XXR2641	23 GRAMS
	SHERWOOD ALKYD STAIN (BROWN) - D64XB4009	19.2 GRAMS
	SHERWOOD ALKYD STAIN (BROWN) - D64XXN500	15.7 GRAMS

MSC MATERIALS

TYPE	REMARKS
FRP-1	FIBER REINFORCED PANEL, WHITE
FRP-2	FIBER REINFORCED PANEL, BLACK
FRP-3	FIBER REINFORCED PANEL, BEIGE/ALMOND
DS-01	HORIZONTAL 1X6 RECLAIMED OAK PLANKS, 60% LIGHT, 20% MEDIUM, 20% DARK STAIN, "RANDOM" STAGGER JOINTS. ALL IS PROVIDED PREFINISHED BY MILLWORK CONTRACTOR AND INSTALLED BY GC.
DS-02	SILVER CROCODILE PANELS, ORNAMENTAL SURFACE BY ASI DECORATIVE SURFACES. SIZE: 102 4" x 39.37" NOMINAL. THICKNESS: .04" - .15" DEPENDING ON PATTERN.
AL-1	ALUMINUM DIAMOND TREAD FROM F.F. TO 48" A.F.F.
ST STL	STAINLESS STEEL WALL PANELS AND CORNER TRIMS BY KITCHEN EQUIPMENT CONTRACTOR.
QF-3	SILKAL 61 CG DECORATIVE QUARTZ FLOORING - TROWEL FNISH, QUARTZ BLEND #9, FLOOR AND BASE BY SILKAL AMERICA. BILL ROSEMEYER EMAIL: WROSEMEYER@SILKALAMERICA.COM PHONE: 772-708-0355

FLOOR TILE

TYPE	COLOR NAME	REMARKS
TL-16	BROWN	TRINITY TILE "DISTRICT", 12"x12" BROWN FLOOR TILE, RUNNING BOND PATTERN, GROUT: MAPEI COLOR OF CHOCOLATE.
TL-17	CHERT	TRINITY TILE "ENERGY", 12"x24" WALL TILE, RUNNING BOND WITH 24" SIDE RUNNING HORIZONTAL GROUT, MAPEI COLOR 96 HARVEST.

WALL BASE

TYPE	COLOR	REMARKS
WB-01	BLACK	JOHNSONITE TRADITIONAL VINYL WALL BASE CS-49A, COLOR BLACK, 0.800" THICKNESS, APPLY JOHNSONITE 890 WALL BASE ADHESIVE TO BACK OF WALL BASE WITH 1/16" SQUARE NOTCHED TROWEL, APPLY CLEAR SILICONE CAULKING TO TOP & BOTTOM OF BASE. CONTACT: ERIN GUY @ EQU@BPTTEAM.COM WEBSITE: WWW.JOHNSONITE.COM

WANSKOT

TYPE	REMARKS
M203	HORIZONTAL 1X6 PINE SQUARE PROFILE TAG WANSKOT PANELING, "RANDOM" STAGGER JOINTS. TERMINATE PANELING W/ 1X6 OAK BASE & 2X OAK WALL CAP W/ 1X4 OAK APRON TRIM. ALL IS PROVIDED PREFINISHED BY MILLWORK CONTRACTOR AND INSTALLED BY GC. STAIN S-09.

SCHLUTER SYSTEMS

TYPE	REMARKS
MT-01	SCHLUTER COVE TRIM: DILEX-HK 15 1/2" BRUSHED NICKEL
MT-02	SCHLUTER TOP CAP TRIM: ATGO-SCHIELE A125 ATGO-BRUSHED NICKEL
MT-03	SCHLUTER OUTSIDE CORNER TRIM: RONDREC RD 125 ATGO-BRUSHED NICKEL

ALUMINUM BREAK METAL

TYPE	REMARKS
MT-04	METAL COPING COLOR: MATCH STOREFRONT COLOR - DARK BRONZE MANUFACTURER: BERTRIDGE

SOLID SURFACE

TYPE	COLOR NAME
SS-11	CAMBRIA HALSTEAD, RESTROOM VANITIES
SS-13	CAMBRIA OAKHAMPTON, MILLWORK TOPS
SS-15	CAMBRIA ARMITAGE, BARTOP

CEILING

TYPE	REMARKS
CG-04	ACOUSTICAL DECK INSULATION: KNAUF BLACK ACOUSTICAL BOARD W/ ECOSE TECHNOLOGY. PAINT: PT-11, MINERAL FIBER BOARD INSULATION.
CG-09	SHEETROCK LAY IN CEILING PANEL, USG CLIMAPLUS, 34X48X1/2" SQUARE CUT, COLOR: WHITE, FACTORY PAINTED. ACOUSTICAL TILE TYPE 2, REF SPECIFICATIONS.

VINYL FLOORING

TYPE	MANUFACTURER/PRODUCT
VF-15	MANNINGTON-SPACA WOOD "RUSTIC BARN WOOD"

STONE

TYPE	REMARKS
BR-06	THIN BRICK 3-58"x1.58" AND 3-58"x1.15" MANGANESE IRONSPOT SMOOTH NO SUBSTITUTIONS MANUFACTURER: ENDICOTT THIN BRICK & TILE LLC

WEBSITE: WWW.ENDICOTT.COM

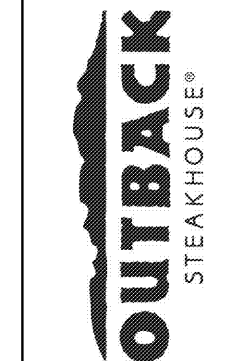

Mark S. Salopek, LLC
3638 West Gateway Drive
Richfield, OH 44286
330.572.2112 330.572.2102

BLOOMING BRANDS
HIALEAH, FL - OUTBACK STEAKHOUSE
1751 W 48TH STREET
HIALEAH, FLORIDA 33012

SHEET ISSUE:
OUT TO PERMIT: 3/21/19

PRINCIPAL IN CHARGE: JC
PROJECT ARCHITECT: MS
DRAWN BY: CC
SHEET TITLE: INTERIOR ELEVATIONS

SHEET NO: A421
PROJ. NO: 2018231.29

A421

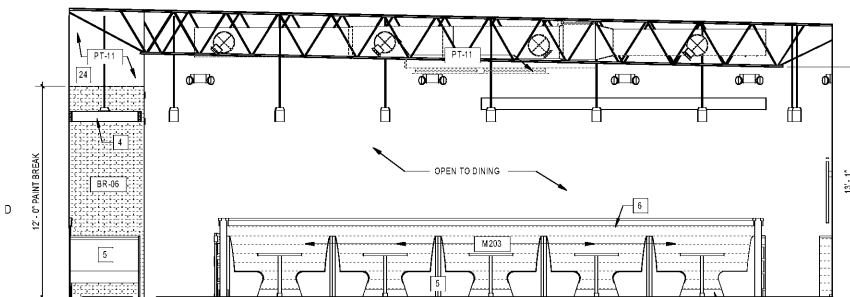

D1 DINING - WEST
A421 114' x 110'

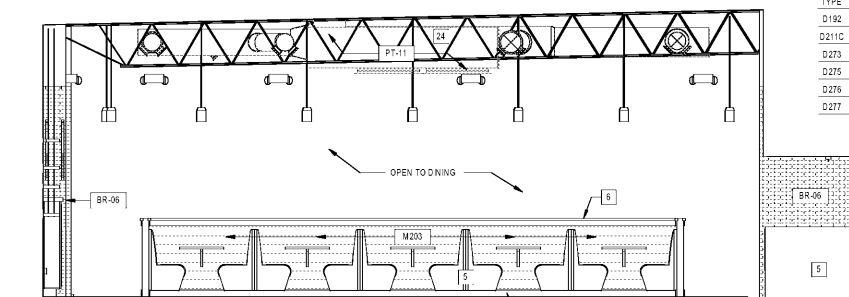

D2 BAR/DINING - EAST
A421 114' x 110'

D4 RR VEST. - NORTH
A421 114' x 110'

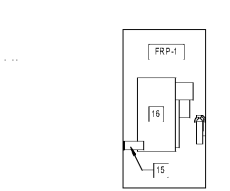

S1 SERVICE VEST. - SOUTH
A421 114' x 110'

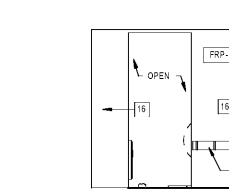

S2 SERVICE VEST. - EAST
A421 114' x 110'

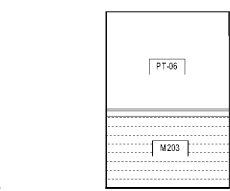

V3 VESTIBULE - EAST
A421 114' x 110'

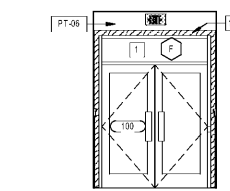

V4 VESTIBULE - SOUTH
A421 114' x 110'

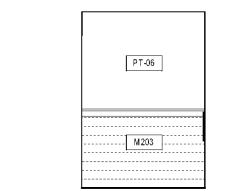

V5 VESTIBULE - WEST
A421 114' x 110'

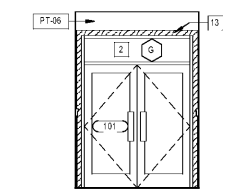

V6 VESTIBULE - NORTH
A421 114' x 110'

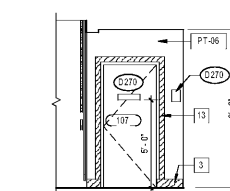

M7 MENS RR VEST. - WEST
A421 114' x 110'

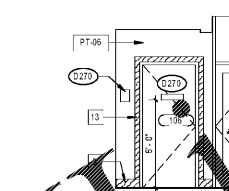

W8 WOMENS RR VEST. - EAST
A421 114' x 110'

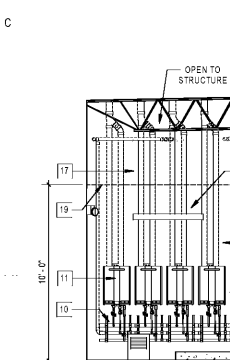

B1 MECH. ROOM - EAST
A421 114' x 110'

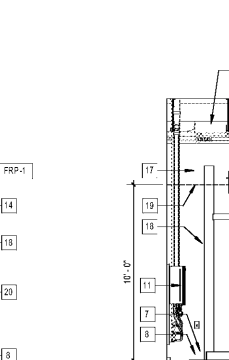

B2 MECH. ROOM - SOUTH
A421 114' x 110'

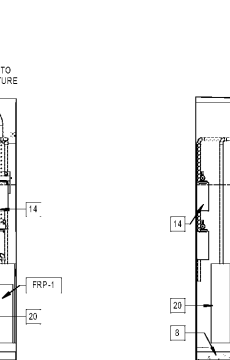

B3 MECH. ROOM - WEST
A421 114' x 110'

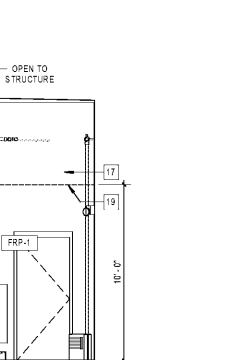

B4 MECH. ROOM - NORTH
A421 114' x 110'

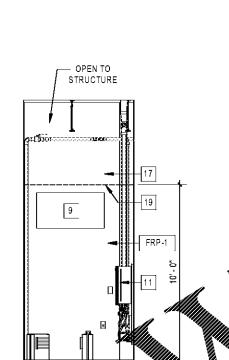

S5 SIDE ENTRY - EAST
A421 114' x 110'

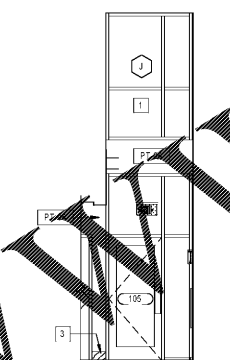

S6 SIDE ENTRY - SOUTH
A421 114' x 110'

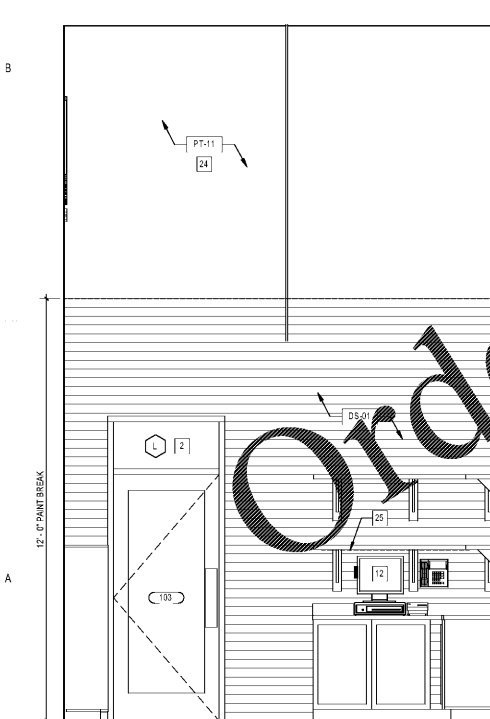

A1 TAKE-AWAY - EAST
A421 112' x 110'

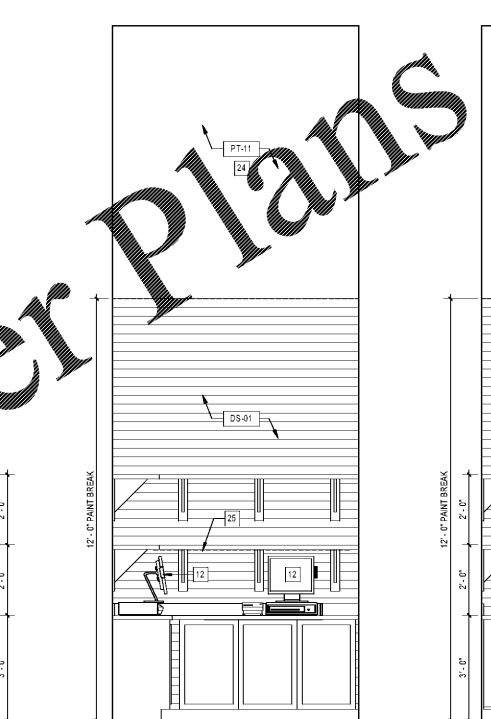

A2 TAKE-AWAY - SOUTH
A421 112' x 110'

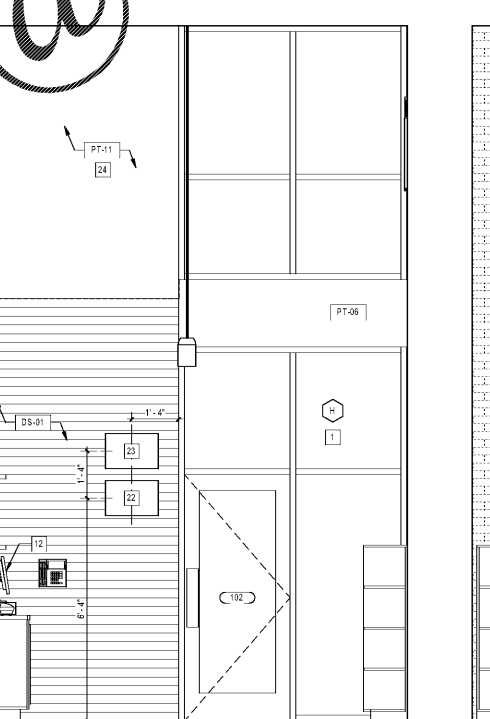

A3 TAKE-AWAY - WEST
A421 112' x 110'

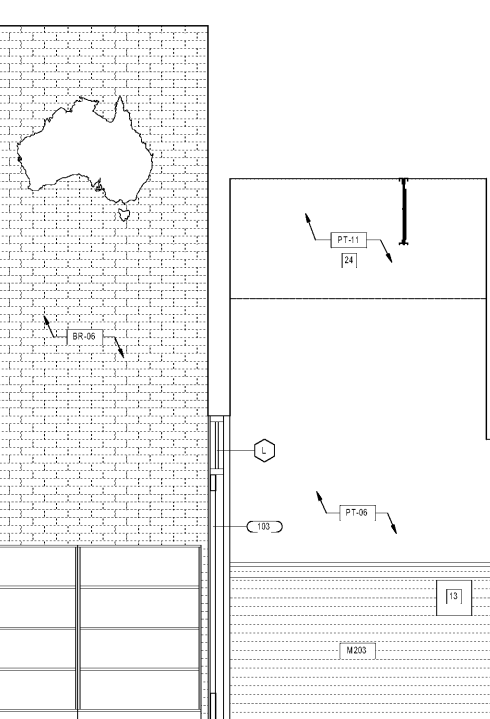

A4 TAKE-AWAY - NORTH
A421 112' x 110'