

INTERIOR ELEVATION GENERAL NOTES

- A. REF. A104 FOR ALL WALL FINISHES
- B. REF. A201 FOR ALL CEILING HEIGHTS
- C. G.C. SHALL PAINT ALL INTERIOR HOLLOW METAL DOOR FRAMES IRON ORE SEMI-GLOSS
- D. REF. FOOD SERVICE FOR KITCHEN ELEVATIONS W/ EQUIPMENT
- E. ALL ITEMS PROVIDED BY MILLWORK CONTRACTOR SHALL BE INSTALLED BY G.C.
- F. FILL ALL WALL HOLES IN WOOD WAINSCOT, TRIM, CASINGS, ETC. TO MATCH FINISH OF WOOD.
- G. REFERENCE D100 FOR CASEWORK VENDOR ITEM SCHEDULE

SHEET KEYNOTES

- 1. EXTERIOR WALL ALUMINUM STOREFRONT SYSTEM DARK BRONZE FINISH. REF. EXTERIOR ELEVATION 5 AND WALL SECTIONS.
- 2. INTERIOR ALUMINUM STOREFRONT. DARK BRONZE FINISH. REF. SHEETS A102 AND A801.
- 3. 1X8 WOOD BASE WITH 3/4" QUARTER ROUND SHOE STAIN S-02.
- 4. WOOD FRAME TRELLIS. REF. SHEET A412.
- 5. CABINETRY AND SHELVING PROVIDE BY MILLWORK CONTRACTOR. INSTALLED BY G.C. TO BE STAINED S-08.
- 6. BOOTH SEATING.
- 7. LOW WALL. REF. WALL TYPES ON SHEET A102.
- 8. BUILT-UP WOOD BEAMS. REF. SHEET A412.
- 9. VINYL GRAPHIC.
- 10. DECORATIVE ELEMENT PROVIDED BY SIGNAGE MANUFACTURER. REF. SHEET G.C. REFERENCE DIMENSIONS ON REFERENCE ELEVATIONS FOR FINISH. PT-11.
- 11. WOOD SLATS TO BE PROVIDED BY MILLWORK CONTRACTOR. LED BY G.C. TO BE STAINED DS-01.
- 12. 85" TV ON FIXED BRACKET.
- 13. 1x4 WINDOW & DOOR TRIM. TYP. SUPPLIED BY MILLWORK CONTRACTOR. LED BY G.C. TO BE STAINED DS-01.
- 14. 1X2 CORNER. INSTALL FLUSH WITH WALL. STAIN S-08.
- 15. 55" TV ON FIXED BRACKET.
- 16. PAINT WALLS ABOVE 12'-0" IN. PAINT DUCTS TO BE GROUTED TO EXPOSED PIPING/CONDUIT AND FINISH TO MATCH WALL FINISH.

INTERIOR FINISH SCHEDULE

FOR PAINT	COLOR NAME	COLOR #	PRODUCT NAME	FINISH
PT-06	MADEIRA	SW9197	SHERWIN WILLIAMS	EGGSHELL/SEMI-GLOSS (RESTROOM ONLY)
PT-07	IRISHISH COFFEE	SW9076	SHERWIN WILLIAMS	FLAT
PT-68	HIGH REFLECTIVE WHITE	SW7757	SHERWIN WILLIAMS	FLAT
PT-69	BOLERO	SW 7600	SHERWIN WILLIAMS	FLAT
PT-69	TOSSIE LATTIE	SW 9108	SHERWIN WILLIAMS	FLAT

WOOD STAIN	COLOR NAME	COLOR #	PRODUCT NAME
S-02	PECAN	(SEE FORMULA BELOW)	
S-06	KONA	(SEE FORMULA BELOW)	
S-14	PLANKED WOOD FINISH BEAM STAIN TO MATCH LIGHTST	(SEE FORMULA BELOW)	

NOTES:
 S-06 & S-02 & S-14 PROVIDE SAMPLE TO BID DESIGN & CONSTRUCTION FOR APPROVAL. PRIOR TO APPLICATION, APPLY 2 COATS STAIN & 2 COATS SATIN POLYURETHANE (M/V), SAND BETWEEN EACH APPLICATION.

OUTBACK STAIN FORMULAS PER GALLON

OUTBACK - KONA (S-06)	SHERWOOD WB SPRAY AND WIPE BASE - 564770057	3190 GRAMS
	SHERWOOD ALKYD STAN (BLK) - D64X84009	32 GRAMS
	SHERWOOD ALKYD STAN (BROWN) - D64XK500	35 GRAMS
OUTBACK - PECAN (S-02)	SHERWOOD WB SPRAY AND WIPE BASE - 564770057	2240 GRAMS
	SHERWOOD ALKYD STAN (W) - D64XY40021	50 GRAMS
	SHERWOOD ALKYD STAN (RED) - D64XR24411	23 GRAMS
	SHERWOOD ALKYD STAN (BROWN) - D64XK48009	13 GRAMS
	SHERWOOD ALKYD STAN (BROWN) - D64XK29185	57 GRAMS

MISC MATERIALS

TYPE	REMARKS
RRP-1	FIBER REINFORCED PANEL - WHITE
RRP-2	FIBER REINFORCED PANEL - BLACK
RRP-3	FIBER REINFORCED PANEL - BEIGE / ALMOND
DS-01	HORIZONTAL 1X8 RECLAIMED OAK PLANKS, 60% LIGHT, 20% MEDIUM, 20% DARK STAIN. "RANDOM" STAGGER JOINTS. ALL IS PROVIDED PREFINISHED BY MILLWORK CONTRACTOR AND INSTALLED BY GC.
DS-02	SILVER CROCODILE PANELS-ORNAMENTAL SURFACE BY ASI/ DECORATIVE SURFACES. SIZE: 102.4" x 39.37" NOMINAL. THICKNESS: .84" - .15" DEPENDING ON PATTERN.
AL-1	ALUMINUM DIAMOND TREAD PROF. F. 7 TO 40" x 8" F.
ST STL	STAINLESS STEEL WALL PANELS AND CORNER TRIMS BY KITCHEN EQUIPMENT CONTRACTOR.
QF-3	SILKAL 61 CG DECORATIVE QUARTZ FLOORING. TROWEL FINISH. QUARTZ BLEND #9. FLOOR AND BASE BY SILKAL AMERICA. BILL ROSEMEYER. EMAIL: WROSEMEYER@SILKALAMERICA.COM PHONE: 772-739-0285

FLOOR TILE

TYPE	COLOR NAME	REMARKS
TL-16	BROWN	TRINITY TILE "DISTRICT" 12"x12" BROWN FLOOR TILE. RUNNING BOND PATTERN. GROUT: MAPEI COLOR OF CHOCOLATE.
TL-17	CHERT	TRINITY TILE "ENERGY" 12"x24" WALL TILE. RUNNING BOND WITH 24" S/E RUNNING HORIZONTAL. GROUT: MAPEI COLOR 96 HARVEST.

WALL BASE

TYPE	COLOR NAME	REMARKS
VB-01	BLACK	JOHNSONITE TRADITIONAL VINYL WALL BASE CB-404. COLOR BLACK, 0.880" THICKNESS. APPLY JOHNSONITE #60 WALL BASE ADHESIVE TO BACK OF WALL BASE WITH 4" SQUARE NOTCHED TROWEL. APPLY CLEAR SILICONE CAULKING TO TOP & BOTTOM OF BASE CONTACT. ENR G-118. EQS/18P/TEAM.COM WEBSITE: WWW.JOHNSONITE.COM

WAINSCOT

M200	HORIZONTAL 1X8 PINE. SQUARE PROFILE TAG WAINSCOT PANELING. "RANDOM" STAGGER JOINTS. TERMINATE PANELING W/ 1X8 OAK BASE & 2X OAK WALL CAP W/ 1X4 OAK TRIM. ALL IS PROVIDED PREFINISHED BY MILLWORK CONTRACTOR AND INSTALLED BY G.C. STAIN S-06.
------	--

SCHLUTER SYSTEMS

MT-01	SCHLUTER COVE TRIM. DLEX-AHK 18 125-BRUSHED NICKEL.
MT-02	SCHLUTER TOP CAP TRIM. ATQD-SCHENE A125 ATGB-BRUSHED NICKEL.
MT-03	SCHLUTER OUTS DE CORNER TRIM. RONDEC RO 125 ATGB-BRUSHED NICKEL.

ALUMINUM BREAK METAL

MT-04	METAL CORNER COLOR: MATCH STOREFRONT COLOR - DARK BRONZE. MANUFACTURER: BERRIDGE.
-------	---

SOLID SURFACE

TYPE	COLOR NAME
SS-11	CAMBRIA HALSTEAD. RESTROOM VANITIES
SS-13	CAMBRIA OAKHAMPTON. MILLWORK TOPS
SS-15	CAMBRIA ARMITAGE. BARTOP

CEILING

CG-04	ACOUSTICAL DECK INSULATION: KNAUF BLACK ACOUSTICAL BOARD W/ ECOSE TECHNOLOGY. PAINT: PT-11. MINERAL FIBER BOARD INSULATION.
CG-08	SHEETROCK LAY IN CEILING PANEL. USG CL-MPLUS. 24X48X1/2" SQUARE CUT. COLOR: WHITE. FACTORY PAINTED. ACOUSTICAL TILE TYPE 2. REF. SPECIFICATIONS.

VINYL FLOORING

VF-15	MANUFACTURER/PRODUCT: MANNINGTON-SPACIA WOOD "RUSTIC BARN WOOD"
-------	---

STONE

TYPE	REMARKS
BR-06	THIN BRICK 3-59"X7-9" AND 3-59"X15". MANGANESE IRONSPOT SMOOTH. MANUFACTURER: ENDICOTT. NO SUBSTITUTIONS. THIN BRICK & TILE LLC. WEBSITE: WWW.ENDICOTT.COM

DECOR SCHEDULE

TYPE	DESCRIPTION
D192	ULLURU GRAPHIC
D211C	SYDNEY MAP GRAPHIC
D273	BOXING KANGAROO GRAPHIC
D275	MAP OUTLINE GRAPHIC METAL PANEL
D276	GRAFFITI MURAL ART
D277	VERTICAL WOOD SLAT WALL. BY MILLWORK VENDOR



Mark S. Salopek, LLC
 3638 West Gateway Drive
 Richfield, OH 44286
 330.572.2112 330.572.2102

BLOOMING BRANDS
 HIALEAH, FL - OUTBACK STEAKHOUSE
 1751 W 48TH STREET
 HIALEAH, FLORIDA 33012

SHEET ISSUE:
 OUT TO PERMIT: 3/21/19

PRINCIPAL IN CHARGE: JC
 PROJECT ARCHITECT: MS
 DRAWN BY: CC

SHEET TITLE:
INTERIOR ELEVATIONS

SHEET NO. PROJ. NO.
 A420 2018201.29

A420

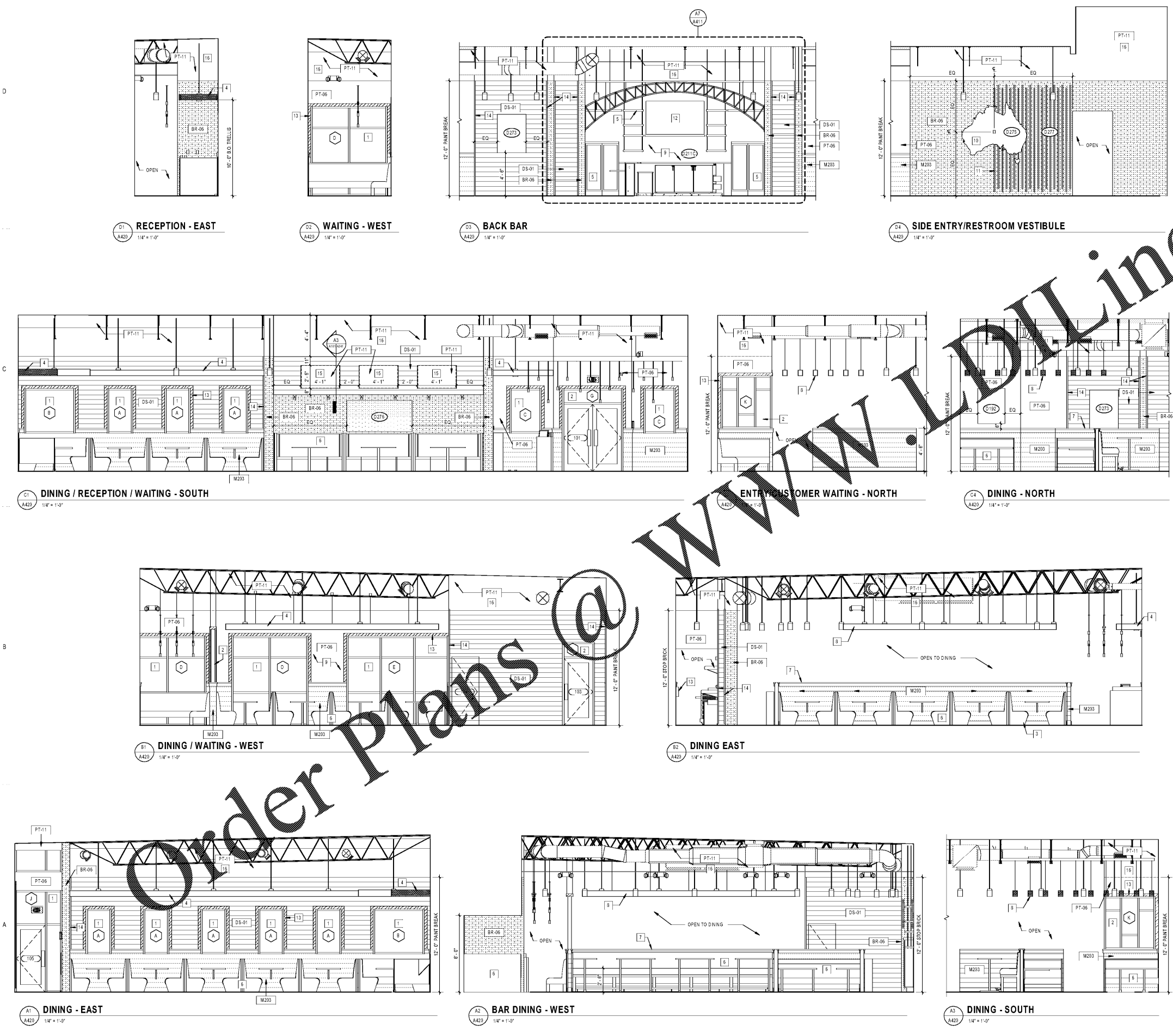

D1 RECEPTION - EAST
 A420 1/4" = 1'-0"

D2 WAITING - WEST
 A420 1/4" = 1'-0"

D3 BACK BAR
 A420 1/4" = 1'-0"

D4 SIDE ENTRY/RESTROOM VESTIBULE
 A420 1/4" = 1'-0"

C1 DINING / RECEPTION / WAITING - SOUTH
 A420 1/4" = 1'-0"

C2 ENTRY/RESTROOM WAITING - NORTH
 A420 1/4" = 1'-0"

C4 DINING - NORTH
 A420 1/4" = 1'-0"

B1 DINING / WAITING - WEST
 A420 1/4" = 1'-0"

B2 DINING EAST
 A420 1/4" = 1'-0"

A1 DINING - EAST
 A420 1/4" = 1'-0"

A2 BAR DINING - WEST
 A420 1/4" = 1'-0"

A3 DINING - SOUTH
 A420 1/4" = 1'-0"