

INTERIOR WALL FINISH PLAN GENERAL NOTES

- A. 1/2" PLYWOOD SUBSTRATE USED THROUGHOUT BACK-OF-HOUSE WALLS, EXCEPT AT HOOD WALLS, WHERE OCCURS REF. SHEET A101
- B. 1/2" GYPSUM BOARD SUBSTRATE TYPICAL IN FRONT-OF-HOUSE, EXCEPT AT APPLIED WOOD FINISHES.
- C. 1/2" CEMENTITIOUS BOARD TYPICAL AT BASE OF ALL WET WALLS, PER DETAILS AND AT CERAMIC WALL TILE APPLICATIONS.
- D. 'BY OWNER' SHALL MEAN ITEM FURNISHED BY OWNER, ASSEMBLED AND INSTALLED BY GC AS PART OF THE WORK OF THIS CONTRACT.
- E. 'NOT IN CONTRACT' SHALL MEAN ITEM PROVIDED AND INSTALLED BY OWNER UNDER SEPARATE CONTRACT.
- F. ALL ITEMS NOT DESIGNATED BY OWNER OR NOT IN CONTRACT TO BE FURNISHED BY GC.
- G. EASE ALL WETTED CORNERS AT CHAR RAILS, TOP CAPS, ETC.
- H. ALL WALLS W/ PAINT FINISH SHALL TRANSITION TO PT-11 AT 12" O' AFF.
- I. REFERENCE EXTERIOR FINISH SCHEDULE, SHEET A300 FOR MT-04 FINISH.
- J. NO TILE BEHIND WINDERS IN MEN'S AND WOMEN'S RESTROOM.
- K. 1X6 WOOD BASE WITH 3/4" QUARTER ROUND SHOE, STAIN S-02, AT BR-06 AND DS-01 WALLS.

INTERIOR FINISH SCHEDULE

INTERIOR PAINT			
TYPE	COLOR NAME	COLOR #	PRODUCT NAME
PT-06	NOMADIC DESERT	SW1907	SHERWIN WILLIAMS
PT-11	TURKISH COFFEE	SW6076	SHERWIN WILLIAMS
PT-03	HIGH REFLECTIVE WHITE	SW7077	SHERWIN WILLIAMS
PT-48	BOLEDO	SW 7600	SHERWIN WILLIAMS
PT-89	DOUBLE LATTE	SW 9108	SHERWIN WILLIAMS

WOOD STAIN			
TYPE	COLOR NAME	COLOR #	PRODUCT NAME
S-02	PECAN	(SEE FORMULA BELOW)	
S-05	KONA	(SEE FORMULA BELOW)	
S-14	PLANKED WOOD 7' FINISH	(SEE FORMULA BELOW)	

NOTES:
 S-06, S-02 & S-14 WOOD SAMPLES TO BE DESIGNED & CONSTRUCTION FOR APPROVAL PRIOR TO APPLICATION. WOOD STAIN & 2 COATS SATIN POLYURETHANE (M.N.I.) BETWEEN EACH COAT.

W/BACK STAIN FORMULAS PER GALLON			
OUTBACK K	S-06	SHERWOOD W/8 SPRAY AND W/PE BASE - S44770657	3190 GRAMS
SHERWOOD ALKYD STAIN (BLK) - D64XK80009			32 GRAMS
SHERWOOD ALKYD STAIN (BROWN) - D64XK5500			35 GRAMS
OUTBACK PECAN (S-02)		SHERWOOD W/8 SPRAY AND W/PE BASE - S44770657	2246 GRAMS
SHERWOOD ALKYD STAIN (W/1) - D64XK0001			50 GRAMS
SHERWOOD ALKYD STAIN (RED) - D64XK26411			23 GRAMS
SHERWOOD ALKYD STAIN (BROWN) - D64XK80009			10.2 GRAMS
SHERWOOD ALKYD STAIN (BROWN) - D64XK29185			57 GRAMS

MISC. MATERIALS

TYPE	REMARKS
FRP-1	FIBER REINFORCED PANEL - WHITE
FRP-2	FIBER REINFORCED PANEL - BLACK
FRP-3	FIBER REINFORCED PANEL - BEIGE / ALMOND
DS-02	HORIZONTAL 1X6 RECLAIMED OAK PLANKS, 8/8" LIGHT 20% MEDIUM 20% DARK STAIN, RANDOM STAGGER JOINTS, ALL S PROVIDED PREFINISHED BY MILLWORK CONTRACTOR AND INSTALLED BY GC.
AL-1	SILVER CROCODILE PANELS-ORNAMENTAL SURFACE BY AS/DECORATIVE SURFACES SIZE 102 1/4" X 39 3/4" NOMINAL THICKNESS .84" - .87" DEPENDING ON PATTERN
AL-1	ALUMINUM DIAMOND TREAD FROM F.F. TO 48" A.F.F.
ST STL	STAINLESS STEEL WALL PANELS AND CORNER TRIMS BY KITCHEN EQUIPMENT CONTRACTOR.
QF-3	SILKALCO DECORATIVE QUARTZ FLOORING, TROWEL FINISH, QUARTZ BLEND #9, FLOOR AND BASE BY SILKAL AMERICA. BILL ROSEMEYER, EMAIL: WROSEMEYER@SILKALAMERICA.COM PHONE: 772-709-0265

FLOOR TILE

TYPE	COLOR NAME	REMARKS
TL-16	BROWN	TRINITY TILE 'DISTRICT', 12X12" BROWN FLOOR TILE, RUNNING BOND PATTERN, GROUT: MAPEI COLOR 07-CHOCOLATE
TL-17	CHERT	TRINITY TILE 'ENERGY', 12X24" WALL TILE, RUNNING BOND WITH 24" SIDE RUNNING HORIZONTAL, GROUT: MAPEI, COLOR 06-HARVEST

WALL BASE

TYPE	COLOR NAME	REMARKS
WB-01	BLACK	40 JOHNSONITE TRADITIONAL VINYL WALL BASE CS-40-6, COLOR BLACK, 0.800" THICKNESS, APPLY JOHNSONITE 960 WALL BASE ADHESIVE TO BACK OF WALL BASE WITH A 1/8" SQUARE NOTCHED TROWEL, APPLY CLEAR SILICONE CALKING TO TOP & BOTTOM OF BASE CONTACT: ERIN GUY @ EGY@PTTEAM.COM WEBSITE: WWW.JOHNSONITE.COM

WAINSCOT

TYPE	REMARKS
M203	HORIZONTAL 1X6 PINE, SQUARE PROFILE T&G WAINSCOT PANELING, "RANDOM" STAGGER JOINTS, TERNMATE PANELING W/ 1/8" OAK BASE & 2 1/4" OAK WALL CAP W/ 1/4" OAK APRON TRIM, ALL S PROVIDED PREFINISHED BY MILLWORK CONTRACTOR AND INSTALLED BY GC. STAIN S-06

SCHLUTER SYSTEMS

TYPE	REMARKS
MT-01	SCHLUTER COVE TRIM, DILEXARK 15 1/2"-BRUSHED NICKEL
MT-02	SCHLUTER TOP CAP TRIM, ATOSCHENE A125 ATOS-BRUSHED NICKEL
MT-03	SCHLUTER OUTSIDE CORNER TRIM, RONDECRO 125 ATOS-BRUSHED NICKEL

ALUMINUM BREAK METAL

TYPE	REMARKS
MT-04	METAL COPING, COLOR: MATCH STOREFRONT COLOR - DARK BRONZE, MANUFACTURER: BENRIDGE

SOLD SURFACE

TYPE	COLOR NAME	REMARKS
SS-11	CAMBRIA HALLSTEAD	RESTROOM VANITIES
SS-13	CAMBRIA OAK-HAMPTON	MILLWORK TOPS
SS-15	CAMBRIA ARMITAGE	BARTOP

CEILING

TYPE	REMARKS
CG-04	ACOUSTICAL DECK INSULATION: KNAUF, BLACK ACOUSTICAL BOARD W/ ECOSE TECHNOLOGY; PAINT, PT-11, MINERAL FIBER BOARD INSULATION
CG-08	SHEETROCK LAY IN CEILING PANEL, USG CLMAPLUS, 24X48X1/2" SQUARE CUT, COLOR: WHITE, FACTORY PAINTED, ACOUSTICAL TILE TYPE & REF SPECIFICATIONS

VINYL FLOORING

TYPE	MANUFACTURER/PRODUCT
VF-15	MANINGTON-SPACIA WOOD "RUSTIC BARN WOOD"

STONE

TYPE	REMARKS
BR-06	THIN BRICK 3-5/8"X7-5/8" AND 3-5/8"X15", MANGAVESE IRONSPOT SMOOTH, MANUFACTURER: ENDCOTT THIN BRICK & TILE LLC

WEBSITE: WWW.ENDCOTT.COM

DECOR SCHEDULE

TYPE	DESCRIPTION
D192	ULURU GRAPHIC
D210	BYDNEY MAP GRAPHIC
D273	BOXING KANGAROO GRAPHIC
D275	MAP OUTLINE GRAPHIC METAL PANEL
D276	GRAFFITI MURAL ART
D277	VERTICAL WOOD SLAT WALL, BY MILLWORK VENDOR

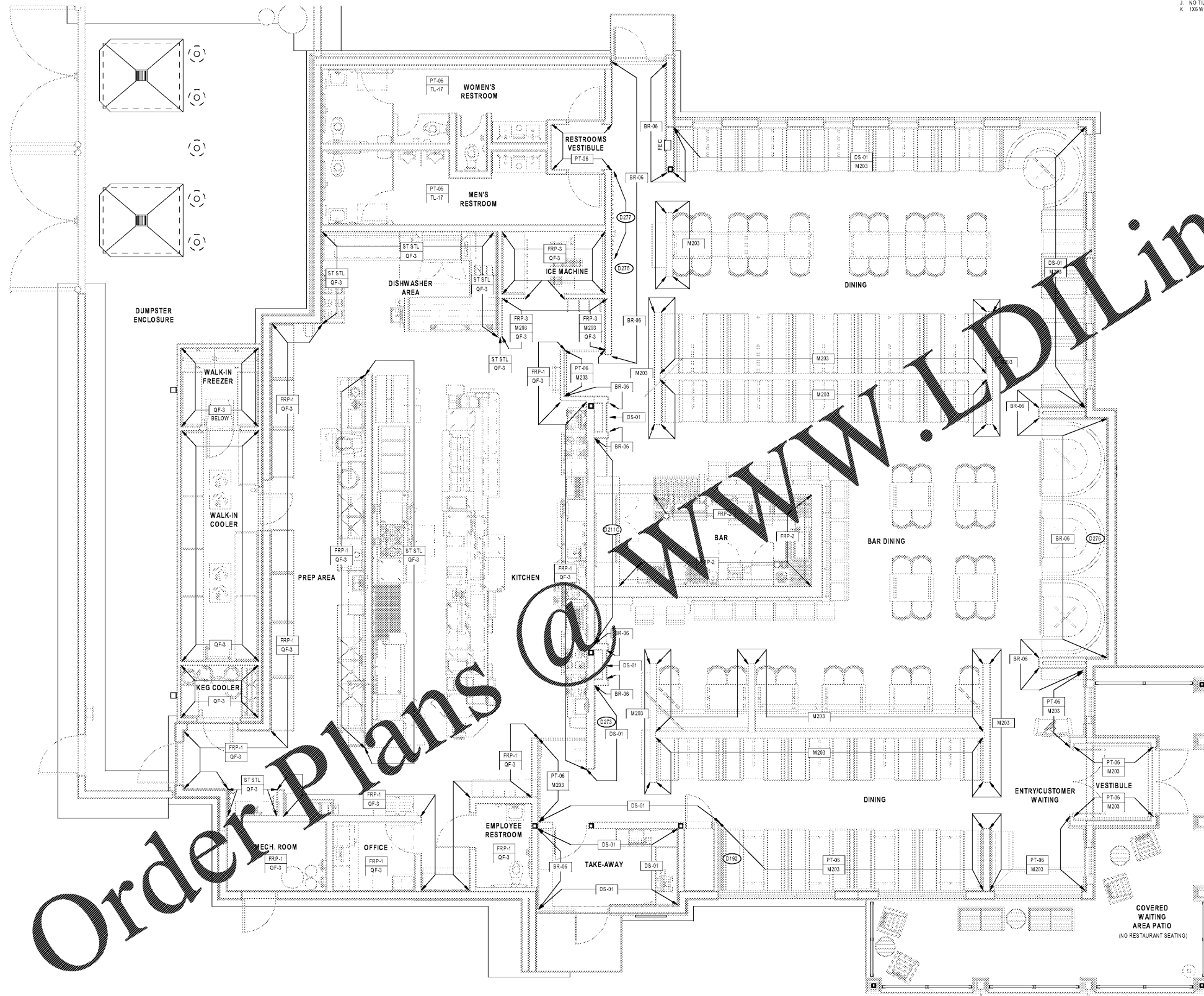

31 INTERIOR WALL FINISH PLAN
 1/8" = 1'-0"



Mark S. Salopek, LLC
 3638 West Galloway Drive
 Richmond, OH 44286
 330.572.2112 330.572.2102

BLOOMING BRANDS
 HIALEAH, FL - OUTBACK STEAKHOUSE
 1751 W 48TH STREET
 HIALEAH, FLORIDA 33012

SHEET ISSUE:
 OUT TO PERMIT: 3/21/19

PRINCIPAL IN CHARGE: JC
 PROJECT ARCHITECT: MS
 DRAWN BY: TB
 SHEET TITLE:
 INTERIOR WALL FINISH PLAN

SHEET NO. PROJ. NO.
 2018201 29

A104