

DIMENSION PLAN GENERAL NOTES

- A. ALL DIMENSIONS ARE FROM FACE OF STUD, FACE OF CMU, OR CENTER OF COLUMN UNO
- B. ALL WOOD FRAMING IN CONTACT WITH CONCRETE SLAB SHALL BE PRESURE TREATED
- C. WALLS AT ALL WET AREAS SHALL HAVE THE BOTTOM TRACK/PLATE SET IN A FULL BED OF ELASTOMERIC SEALANT, REF DETAIL CS/AG20
- D. PROVIDE WATERPROOF MEMBRANE EQUIVALENT TO LATICRETE 8205 UNDER FLOOR FINISH IN KITCHEN, BAR EMPLOYEE AND PUBLIC RESTROOMS. APPLY TO WALLS AT COOLER AND FREEZER PRIOR TO INSTALLATION OF COOLER BOX. EXTEND MEMBRANE UP WALL 1'-0" AND ON FLOOR 2'-0" REF DETAIL CS/AG20
- E. ALL FRONT OF HOUSE INTERIOR WALL SHEATHING SHALL BE 1/2" GYPSUM BOARD UNLESS OTHERWISE SPECIFIED
- F. ALL STUDS IN INTERIOR WALLS SHALL BE 16" OC UNO REF STRUCTURAL FOR STUD SPACING ON EXTERIOR WALLS
- G. LOCATIONS OF SOUND BATT INSULATION, REF SHEET A101
- H. PROVIDE 1/2" CEMENTITIOUS BOARD TO 12" AFF ON ALL WALLS IN WET AREAS
- I. ALL KITCHEN / BOH TAKE-AWAY WALLS SHALL HAVE CONTINUOUS 1/2" PLYWOOD SHEATHING TO 6" ABOVE CEILING. COVER PLYWOOD IN TAKE-AWAY ROOM WITH 1/4" GYP BOARD UNO
- J. ENLARGED RESTROOM PLAN, REF SHEET A100
- K. WALL TYPES, REF SHEET A100
- L. CRITICAL FOOD SERVICE DIMENSIONS AND WALL BACKING LOCATIONS/CONDITIONS, REF FOOD SERVICE PLANS.

SHEET KEYNOTES

- 1. FACES OF FRAMING SHALL ALIGN
- 2. WALL BACKING FROM 100" AFF DOWN TO 10" AFF FOR 10" MINOZ DISPLAY CABINET AND RECLAIMED WOOD



Mark S. Salopek, LLC
 3638 West Galloway Drive
 Richmond, OH 44286
 330.572.2112 330.572.2102

BLOOMING BRANDS
HIALEAH, FL - OUTBACK STEAKHOUSE
 1751 W 48TH STREET
 HIALEAH, FLORIDA 33012

SHEET ISSUE:
 OUT TO PERMIT: 3/21/19

PRINCIPAL IN CHARGE: JC
 PROJECT ARCHITECT: MS
 DRAWN BY: CC

SHEET TITLE:
DIMENSION PLAN

SHEET NO. PROJ. NO.
 A102 2018231.29

A102

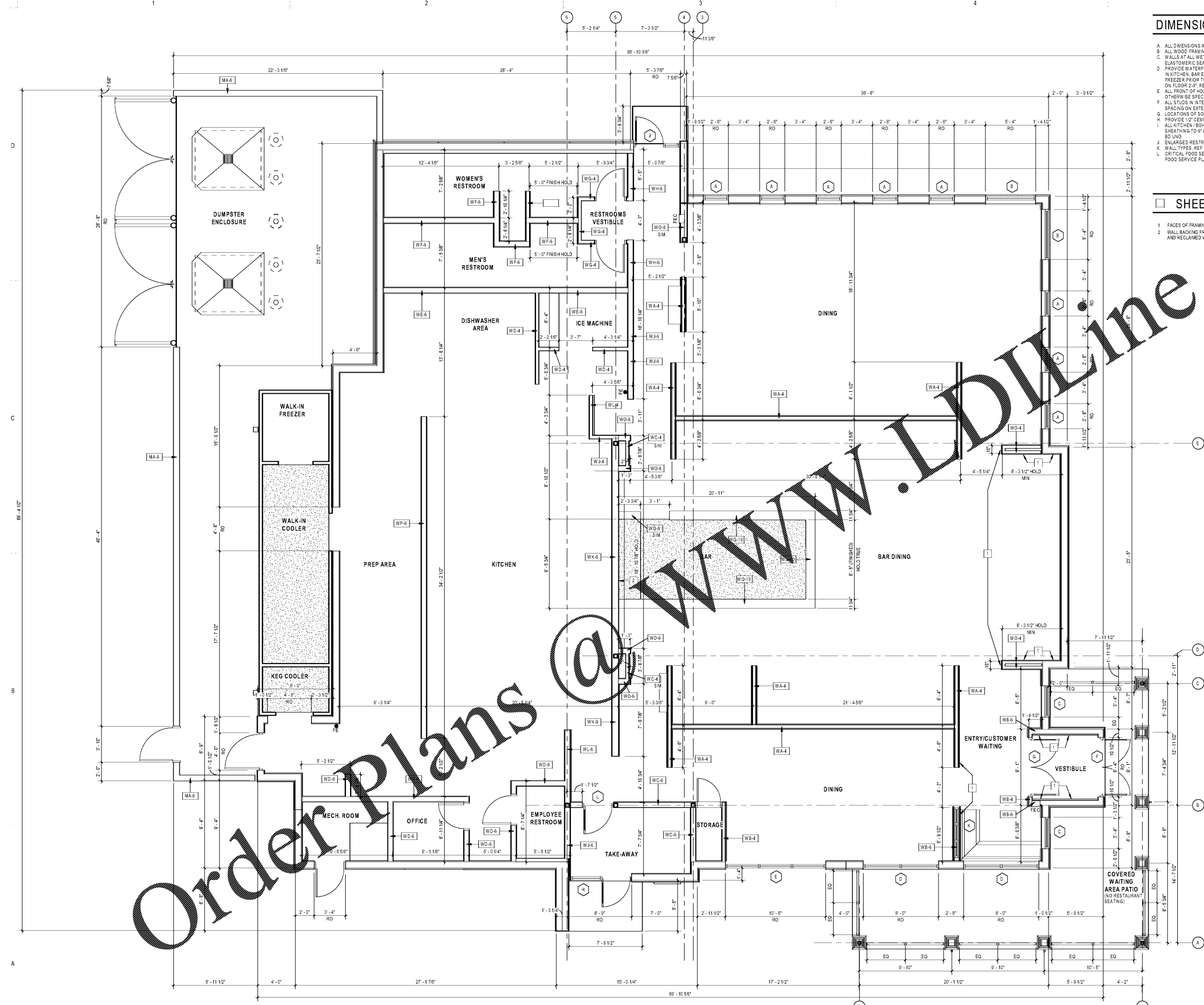

A102 DIMENSION PLAN
 1/4" = 1'-0"

Order Plans @ www.LDOnline.com