



Project
**THE CENTER FOR
 ADVANCED SURGICAL
 SERVICES (CASS)**
 88 JESSE HILL DRIVE
 ATLANTA, GA 30303

Prepared For
GRADY HEALTH SYSTEM
 80 JESSE HILL DR. SE
 ATLANTA, GA 30303



Hellmuth, Obata & Kassabaum, Inc.
 191 Peachtree Street, NE, Suite 2250
 Atlanta, GA 30303 USA
 T+1 404 439 9000 F+1 404 439 9001

All reproduction & intellectual property rights reserved © 2019.

In Association with



TLC ENGINEERING
 255 S. Orange Avenue
 Suite 1600
 Orlando, FL 32801
 P 407 841 9950
 COA PE12029802
 www.tlcengineering.com
 TLC No. 118548
 FPK/MSK, L167220K, C026447K

Key Plan

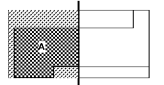

Professional Seal
 Emory Neal Boothe, P.E.
 Georgia License #PE039005

**NOT FOR
 CONSTRUCTION**

No.	Description	Date
3	BD - GMP	2019-07-03

Project No. 18.16013.00
 Sheet Title
**GROUND FLOOR PLAN
 - WEST - VOICE/DATA**

Original is 30 x 42. Do not scale contents of this drawing.
 Sheet Number

T200A

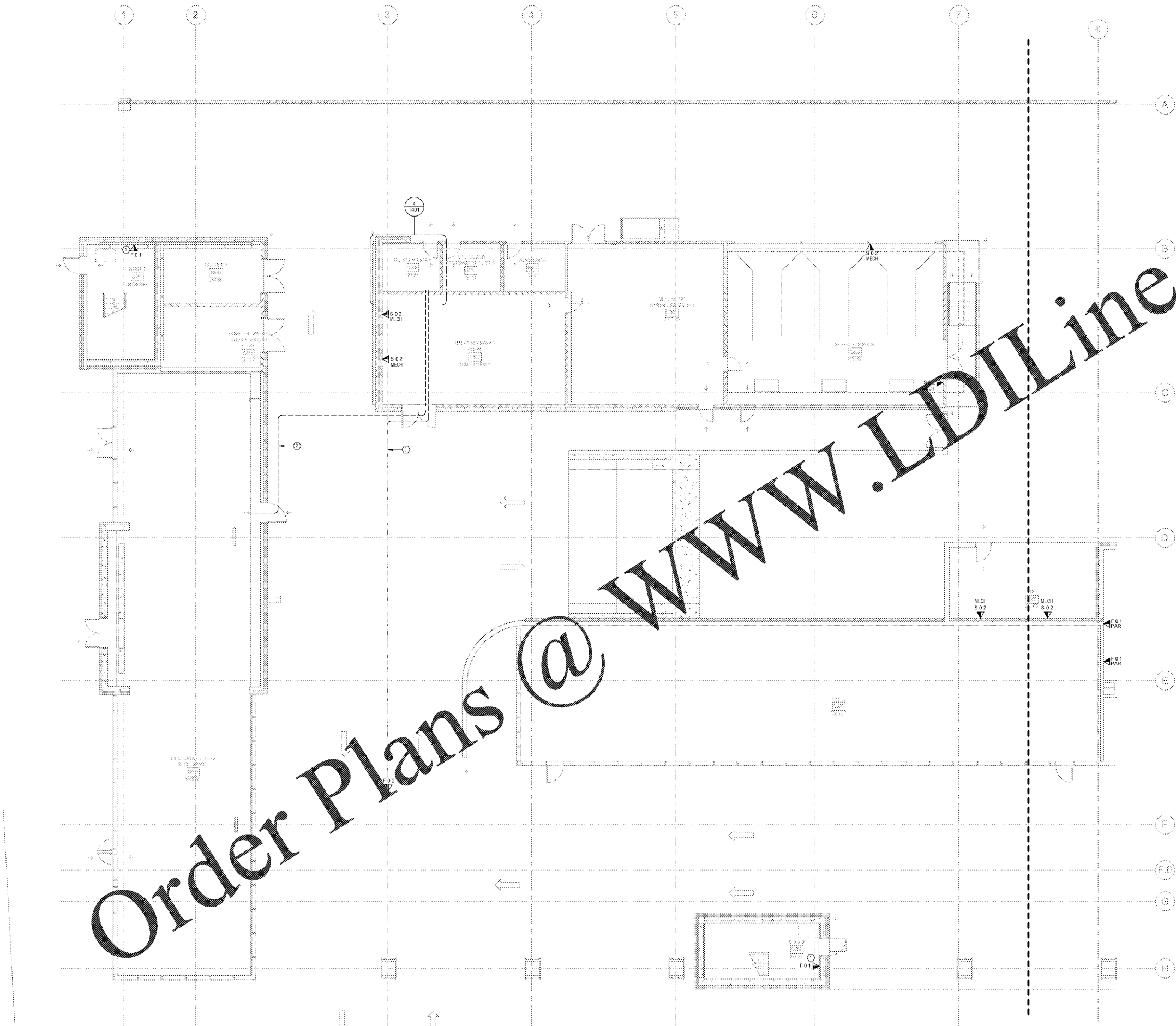

TECHNOLOGY SITE PLAN KEYED NOTES

- PROVIDE A WALL MOUNTED DATA LOCATION AT 8' AFF FOR FUTURE SECURITY MONITOR LOCATION.
- PROVIDE (1) 2" CONDUIT WITH PULL STRING STUBBED UP AT THE FUTURE CARE FOR FUTURE SERVICE PROVIDER AND DATA CABLEING.
- PROVIDE (1) 1" CONDUIT WITH PULL AND STUB UP AT BLAND FOR PARKING ATTENDANT LOCATION.

1 FLOOR PLAN - GROUND LEVEL - WEST - VOICE/DATA
 1/8" = 1'-0"