



- GENERAL FIRE ALARM PLAN NOTES:
1. REFER TO ARCHITECTURAL ELEVATIONS FOR FINAL MOUNTING HEIGHTS OF ALL DEVICES. UNLESS NOTED OTHERWISE, ARCHITECTURAL ELEVATIONS SHALL Dictate.
 2. VERIFY AND COORDINATE EXACT ELECTRICAL REQUIREMENTS OF ALL EQUIPMENT WITH MANUFACTURER'S RECOMMENDATIONS PRIOR TO INSTALLATION.
 3. COORDINATE INSTALLATION OF ALL LOW VOLTAGE SYSTEMS WITH O.F.C.I. PATIENT MEDICAL SYSTEMS PRIOR TO ROUGH-IN OF AREA.

Project
**THE CENTER FOR
ADVANCED SURGICAL
SERVICES (CASS)**
88 JESSE HILL DRIVE
ATLANTA, GA 30303

Prepared For
GRADY HEALTH SYSTEM
80 JESSE HILL DR. SE
ATLANTA, GA 30303



Hellmuth, Obata & Kassabaum, Inc.
191 Peachtree Street, NE, Suite 2250
Atlanta, GA 30303 USA
T+1 404 439 9000 F+1 404 439 9001

All reproduction & intellectual property rights reserved © 2019.

In Association with



Key Plan

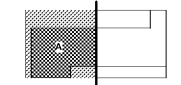

Professional Seal
Emory Neal Boothe, P.E.
Georgia License #PE039005

**NOT FOR
CONSTRUCTION**

No.	Description	Date
1	ED - GMP	2019-07-03

Project No: 18.16013.00
Sheet Title

**LEVEL 6 FLOOR PLAN -
WEST NURSE CALL**

Original is 30 x 42. Do not scale contents of this drawing.
Sheet Number

E506A

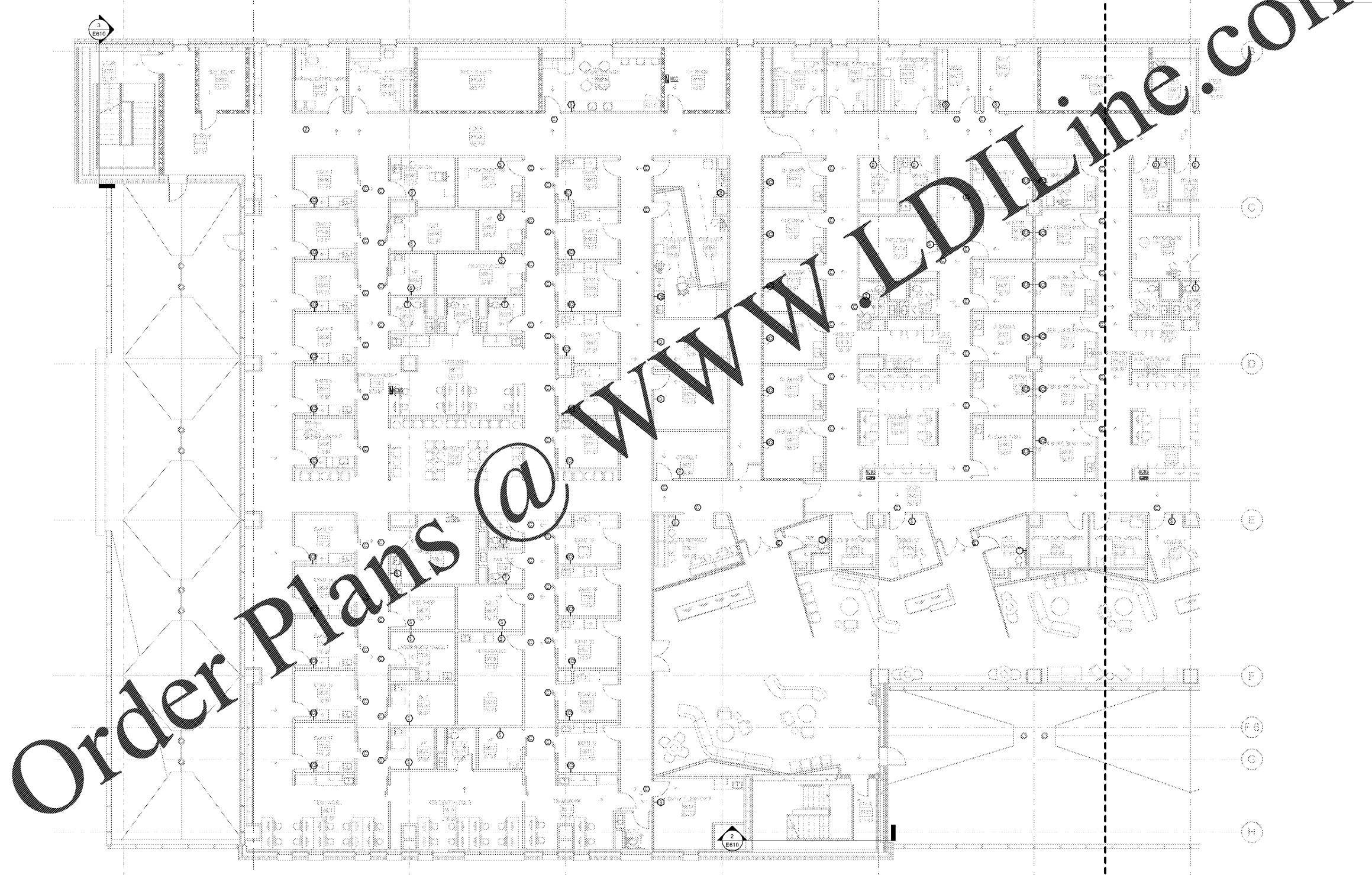

1 FLOOR PLAN - LEVEL 6 - WEST - NURSE CALL
1/8" = 1'-0"