

REFER TO R. POWELL & ASSOCIATES DRAWINGS FOR WORK IN THIS AREA.

- GENERAL LIGHTING PLAN NOTES**
- REFER TO ARCHITECTURAL CEILING PLANS FOR FINAL PLACEMENT AND LOCATION OF ALL CEILING MOUNTED LIGHT FIXTURES.
 - REFER TO ARCHITECTURAL ELEVATIONS FOR FINAL MOUNTING HEIGHTS OF ALL WALL MOUNTED FIXTURES.
 - SURFACE MOUNTED RACKWAY IS NOT PERMITTED FOR INTERCONNECTIONS BETWEEN MULTIPLE UNDERCABINET LIGHT FIXTURES. BACKFEED ALL FIXTURES.

- KEY PLAN**
- REFER TO SHEET 18.16013.00 FOR WALL MOUNTED LIGHT FIXTURES.
 - REFER TO SHEET 18.16013.00 FOR ELEVATOR SHAFT LIGHT FIXTURES.



Project
**THE CENTER FOR
 ADVANCED SURGICAL
 SERVICES (CASS)**
 88 JESSE HILL DRIVE
 ATLANTA, GA 30303

Prepared For
GRADY HEALTH SYSTEM
 80 JESSE HILL DR. SE
 ATLANTA, GA 30303



Helmuth, Obata & Kassabaum, Inc.
 191 Peachtree Street, NE, Suite 2250
 Atlanta, GA 30303 USA
 T+1 404 439 9000 F+1 404 439 9001

All reproduction & intellectual property rights reserved © 2019
 In Association with

TLC ENGINEERING
 256 S. Orange Avenue
 Suite 1400
 Orlando, FL 32801
 P 407.841.0262
 CDA PEF 002960
 www.tlc-engineering.com
 TLC No. 118548
 TPOWS, L16729K, C265A19

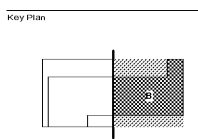

Professional Seal
 Emory Neal Boothe, P.E.
 Georgia License #PE039005

**NOT FOR
 CONSTRUCTION**

No.	Description	Date
1	DD - GMP	2019-07-03

Project No: 18.16013.00
 Sheet Title
**LEVEL 3 FLOOR PLAN -
 EAST - LIGHTING**

Original is 30 x 42. Do not scale contents of this drawing.
 Sheet Number

E303B

1 FLOOR PLAN - LEVEL 3 - EAST - LIGHTING
 1/8" = 1'-0"