

- GENERAL POWER PLAN NOTES:**
- VERIFY AND COORDINATE EXACT ELECTRICAL REQUIREMENTS OF ALL EQUIPMENT WITH MANUFACTURER'S RECOMMENDATIONS PRIOR TO INSTALLATION OF EQUIPMENT. MODIFY LAYOUT AS REQUIRED PER MANUFACTURER'S SPACE REQUIREMENTS.
  - REFER TO ARCHITECTURAL ELEVATIONS AND CASEWORK DRAWINGS FOR FINAL MOUNTING HEIGHTS AND INSTALLATION REQUIREMENTS OF ALL DEVICES. UNLESS NOTED OTHERWISE, ARCHITECTURAL ELEVATIONS SHALL DICTATE MOUNTING HEIGHTS OF ALL FIXTURES AND DEVICES.
  - COORDINATE FINAL LOCATIONS OF ALL DIVISION 23 EQUIPMENT IN FIELD WITH DIVISION 23 EQUIPMENT. FIELD LOCATIONS SHALL DICTATE.
  - COORDINATE MOUNTING HEIGHTS AND LOCATIONS OF ALL DEVICES WITH ARCHITECTURAL ELEVATIONS AND CASEWORK.
  - CRITICAL BRANCH WIRING FROM ANY PANEL DOWNSTREAM OF AUTOMATIC TRANSFER SWITCHES 475-57 AND 475-52 SHALL MAINTAIN SEPARATION FROM THESE TRANSFER SWITCHES AND THEIR DISTRIBUTION ALLWAYS TO THE LOADS.

**KEY:**

ALL NEW DEVICES WITH MANUFACTURER'S ELECTRICAL ROOM SHALL BE INSTALLED IN THIS ROOM. THESE SHALL BE RATED BY THE MANUFACTURER. THESE SHALL BE RATED BY THE MANUFACTURER.

1 PROVIDE SINGLE CHANNEL ALUMINUM RACEWAY EQUAL TO LEGRAND WHEN OLD SERIES AL 330 WITH HOSPITAL GRADE DUPLEX RECEPTACLES LOCATED 48" ON CENTER. PROVIDE LENGTH AS INDICATED. CIRCUIT TO THE PANEL, INDICATED WITH ADJACENT RECEPTACLES ON A TERMINAL CIRCUIT. PROVIDE ALL PARTS NECESSARY FOR A COMPLETE AND WORKING SYSTEM. MOUNT AT 48" HFT. EACH RECEPTACLE SHALL HAVE AN ENGRAVED PHONO LABEL INDICATING THE PANEL AND CIRCUIT SERVING THE DEVICE. REFER TO SPECIFICATIONS FOR FUTURE LABELING REQUIREMENTS.

2 THIS ROOM IS A PATIENT CARE AREA. ALL RECEPTACLES IN THIS ROOM SHALL BE HOSPITAL GRADE TYPE AND SHALL HAVE REDUNDANT GROUNDING (I.E. EQUIPMENT GROUNDING CONDUCTOR AND LISTED RACEWAY). ALL BRANCH CIRCUITS SHALL HAVE DEDICATED NEUTRAL CONDUCTORS. REFER TO RADIOLOGY DEPARTMENT DRAWINGS FOR ADDITIONAL WORK IN THIS AREA. ALL RECEPTACLES TO DIVISION 23 CONTRACTOR SHALL PROVIDE SEPARATE RACEWAYS OR CONTINUOUS BARRIERS FOR THE SEPARATION OF INTERCONNECTING CABLES PER VOLTAGE RATING AND CLASS. POWER AND CLASS 1 CIRCUIT WIRING SHALL BE SEPARATED TOTALLY SEPARATE FROM CLASS 2 AND 3 CIRCUIT WIRING. PROVIDE A CHART AND/OR WIRING DIAGRAM WITH MARKED CABLES TO FACILITATE VERIFICATION OF THIS REQUIREMENT. THIS CHART MUST BE PROVIDED BY THE RADIOLOGY EQUIPMENT MANUFACTURER'S ENGINEERING DEPARTMENT.



Project  
**THE CENTER FOR  
 ADVANCED SURGICAL  
 SERVICES (CASS)**  
 88 JESSE HILL DRIVE  
 ATLANTA, GA 30303

Prepared For  
**GRADY HEALTH SYSTEM**  
 80 JESSE HILL DR. SE  
 ATLANTA, GA 30303



Heilmuth, Obata & Kassabaum, Inc.  
 191 Peachtree Street, NE, Suite 2250  
 Atlanta, GA 30303 USA  
 T+1 404 439 9000 F+1 404 439 9001

All reproduction & intellectual property rights reserved © 2019  
 An Association with

**TLC ENGINEERING**  
 255 S. Orange Avenue  
 Suite 1100  
 Orlando, FL 32801  
 P: 407.841.0900

CDM: PE0322860  
 www.tlc-engineering.com  
 TLC No. 1118548  
 TPN005, L052206, C285A10

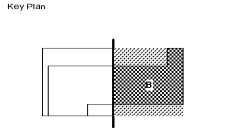

Professional Seal  
 Emory Neal Boothe, P.E.  
 Georgia License #PE039005

**NOT FOR  
 CONSTRUCTION**

No.	Description	Date
1	ED - GMP	2019-07-03

Project No: 18.16013.00  
 Sheet Title  
**LEVEL 6 FLOOR PLAN -  
 EAST - POWER**

Original is 20 x 42. Do not scale contents of this drawing.  
 Sheet Number

**E206B**

Order Plans @

1 FLOOR PLAN - LEVEL 6 - EAST - POWER  
 1/8" = 1'-0"