



Project  
**THE CENTER FOR  
 ADVANCED SURGICAL  
 SERVICES (CASS)**  
 88 JESSE HILL DRIVE  
 ATLANTA, GA 30303

Prepared For  
**GRADY HEALTH SYSTEM**  
 80 JESSE HILL DR. SE  
 ATLANTA, GA 30303



Hellmuth, Obata & Kassabaum, Inc.  
 191 Peachtree Street, NE, Suite 2250  
 Atlanta, GA 30303 USA  
 T+1 404 439 9000 F+1 404 439 9001

All reproduction & intellectual property rights reserved © 2019



Key Plan

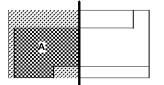

Professional Seal  
 Emory Neal Boothe, P.E.  
 Georgia License #PE039005

**NOT FOR  
 CONSTRUCTION**

No.	Description	Date
1	ED - GMP	2019-07-03

Project No: 18.16013.00  
 Sheet Title  
**LEVEL 5 FLOOR PLAN -  
 WEST - POWER**

Original is 30 x 42. Do not scale contents of this drawing  
 Sheet Number

**E205A**

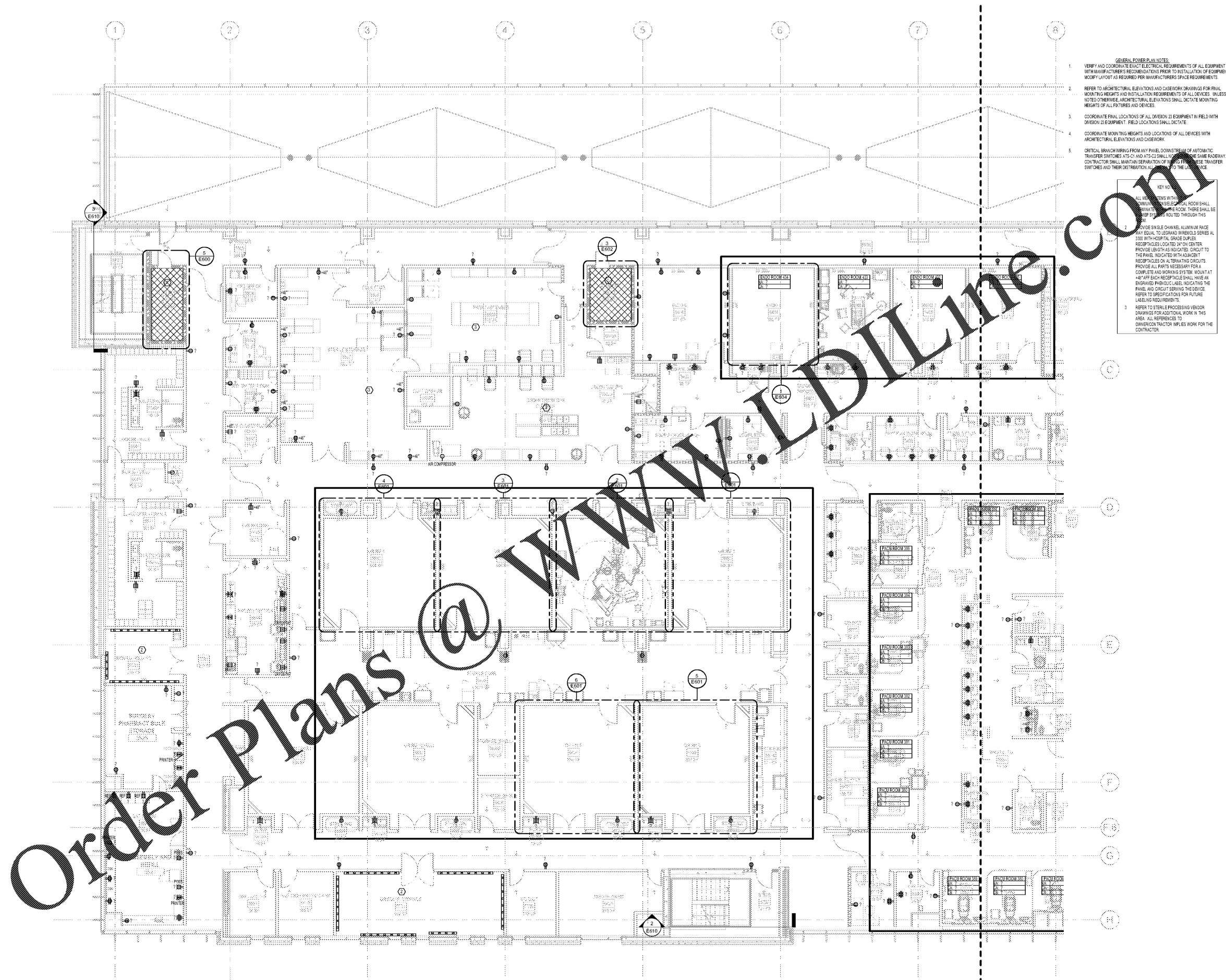

- GENERAL POWER PLAN NOTES**
- VERIFY AND COORDINATE EXACT ELECTRICAL REQUIREMENTS OF ALL EQUIPMENT WITH MANUFACTURER'S RECOMMENDATIONS PRIOR TO INSTALLATION OF EQUIPMENT. MODIFY LAYOUT AS REQUIRED PER MANUFACTURER'S SPACE REQUIREMENTS.
  - REFER TO ARCHITECTURAL ELEVATIONS AND CASEWORK DRAWINGS FOR FINAL MOUNTING HEIGHTS AND INSTALLATION REQUIREMENTS OF ALL DEVICES. UNLESS NOTED OTHERWISE, ARCHITECTURAL ELEVATIONS SHALL DICTATE MOUNTING HEIGHTS OF ALL FIXTURES AND DEVICES.
  - COORDINATE FINAL LOCATIONS OF ALL DIVISION 23 EQUIPMENT IN FIELD WITH DIVISION 23 EQUIPMENT. FIELD LOCATIONS SHALL DICTATE.
  - COORDINATE MOUNTING HEIGHTS AND LOCATIONS OF ALL DEVICES WITH ARCHITECTURAL ELEVATIONS AND CASEWORK.
  - CRITICAL BRANCH WIRING FROM ANY PANEL DOWNSTREAM OF AUTOMATIC TRANSFER SWITCHES AT 47 AND AT 52 SHALL NOT BE ON THE SAME RACEWAY. CONTRACTOR SHALL MAINTAIN SEPARATION OF THESE RACEWAYS. THESE TRANSFER SWITCHES AND THEIR DISTRIBUTION ALL REFER TO THE LAYOUT.
- KEY PLAN**
- ALL NEW SYSTEMS WITHIN THE ELECTRICAL ROOM SHALL BE INSTALLED IN THE ELECTRICAL ROOM. THESE SHALL BE RACEWAYS ROUTED THROUGH THIS ROOM.
  - PROVIDE SINGLE CHANNEL ALUMINUM RACEWAY EQUAL TO LEGRAND WIREMOLD SERIES AL 330 WITH HOSPITAL GRADE DUPLEX RECEPTACLES LOCATED 24" ON CENTER. PROVIDE LENGTH AS INDICATED. CIRCUIT TO THE PANEL, INDICATED WITH ADJACENT RECEPTACLES ON ALL TERMINAL CIRCUITS. PROVIDE ALL PARTS NECESSARY FOR A COMPLETE AND WORKING SYSTEM. MOUNT AT 48" HFT. EACH RECEPTACLE SHALL HAVE AN ENGRAVED PHONO LABEL INDICATING THE PANEL AND CIRCUIT SERVING THE DEVICE. REFER TO SPECIFICATIONS FOR FUTURE LABELING REQUIREMENTS.
  - REFER TO STERILE PROCESSING VENDOR DRAWINGS FOR ADDITIONAL WORK IN THIS AREA. ALL REFERENCES TO OWNER CONTRACTOR IMPLIES WORK FOR THE CONTRACTOR.

**1 FLOOR PLAN - LEVEL 5 - WEST - POWER**  
 1/8" = 1'-0"

C:\Revit\Local\GRADY\CASS-TLC-ELEC\_JOE\_HLDRBRAND\K01.dwg

7/1/2019 5:03:18 PM