

- GENERAL POWER PLAN NOTES:**
1. VERIFY AND COORDINATE EXACT ELECTRICAL REQUIREMENTS OF ALL EQUIPMENT WITH MANUFACTURER'S RECOMMENDATIONS PRIOR TO INSTALLATION OF EQUIPMENT. MODIFY LAYOUT AS REQUIRED PER MANUFACTURER'S SPACE REQUIREMENTS.
  2. REFER TO ARCHITECTURAL ELEVATIONS AND CASEWORK DRAWINGS FOR FINAL MOUNTING HEIGHTS AND INSTALLATION REQUIREMENTS OF ALL DEVICES. UNLESS NOTED OTHERWISE, ARCHITECTURAL ELEVATIONS SHALL DICTATE MOUNTING HEIGHTS OF ALL FIXTURES AND DEVICES.
  3. COORDINATE FINAL LOCATIONS OF ALL DIVISION 23 EQUIPMENT IN FIELD WITH DIVISION 23 EQUIPMENT. FIELD LOCATIONS SHALL DICTATE.
  4. COORDINATE MOUNTING HEIGHTS AND LOCATIONS OF ALL DEVICES WITH ARCHITECTURAL ELEVATIONS AND CASEWORK.
  5. CRITICAL BRANCH WIRING FROM ANY PANEL DOWNSTREAM OF AUTOMATIC TRANSFER SWITCHES AT 40' AND AT 50' SHALL NOT BE ON THE SAME RACEWAY. CONTRACTOR SHALL MAINTAIN SEPARATION OF THESE TRANSFER SWITCHES AND THEIR DISTRIBUTION ALL THE WAY TO THE LOADS.



Project  
**THE CENTER FOR  
 ADVANCED SURGICAL  
 SERVICES (CASS)**  
 88 JESSE HILL DRIVE  
 ATLANTA, GA 30303

Prepared For  
**GRADY HEALTH SYSTEM**  
 80 JESSE HILL DR. SE  
 ATLANTA, GA 30303



Hellmuth, Obata & Kassabaum, Inc.  
 191 Peachtree Street, NE, Suite 2250  
 Atlanta, GA 30303 USA  
 T+1 404 439 9000 F+1 404 439 9001

All reproduction & intellectual property rights reserved © 2019  
 in Association with

**TLC ENGINEERING**  
 CONSULTING ENGINEERS  
 258 S. Orange Avenue  
 Suite 1400  
 Orlando, FL 32801  
 P 407.841.0262  
 F 407.841.0262  
 CDA PEF 002980  
 www.tlc-engineering.com  
 TLC No. 118548  
 TPOWS, L16723N, C265A19

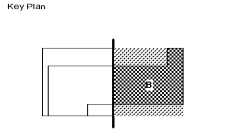

Professional Seal  
 Emory Neal Boothe, P.E.  
 Georgia License #PE039005

**NOT FOR  
 CONSTRUCTION**

No.	Description	Date
1	DD - GMP	2019-07-03

Project No: 18.16013.00  
 Sheet Title  
**LEVEL 3 FLOOR PLAN -  
 EAST - POWER**

Original is 30 x 42. Do not scale contents of this drawing.  
 Sheet Number

**E203B**

Order Plans @ [www.LDILLINE.com](http://www.LDILLINE.com)

**1 FLOOR PLAN - LEVEL 3 - EAST - POWER**  
 1/8" = 1'-0"