



Project
**THE CENTER FOR
 ADVANCED SURGICAL
 SERVICES (CASS)**
 88 JESSE HILL DRIVE
 ATLANTA, GA 30303

Prepared For
GRADY HEALTH SYSTEM
 80 JESSE HILL DR. SE
 ATLANTA, GA 30303



Hellmuth, Obata & Kassabaum, Inc.
 191 Peachtree Street, NE, Suite 2250
 Atlanta, GA 30303 USA
 T+1 404 439 9000 F+1 404 439 9001

All reproduction & intellectual property rights reserved © 2019

In Association with

TLC ENGINEERING
 255 S. Orange Avenue
 Suite 1500
 Orlando, FL 32801
 P: 407.841.0200
 F: 407.841.0202
 CDA PEF 022860
 www.tlcengineering.com
 TLC No. 118548
 TPNWES, L16720K, C282A10P

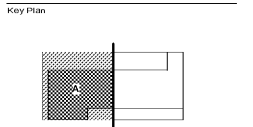

Professional Seal
 Emory Neal Boothe, P.E.
 Georgia License #PE039005

**NOT FOR
 CONSTRUCTION**

No.	Description	Date
1	ED - GMP	2019-07-03

Project No: 18.16013.00
 Sheet Title
**GROUND FLOOR PLAN
 - WEST - POWER**

Original is 20 x 42. Do not scale contents of this drawing.
 Sheet Number

E200A

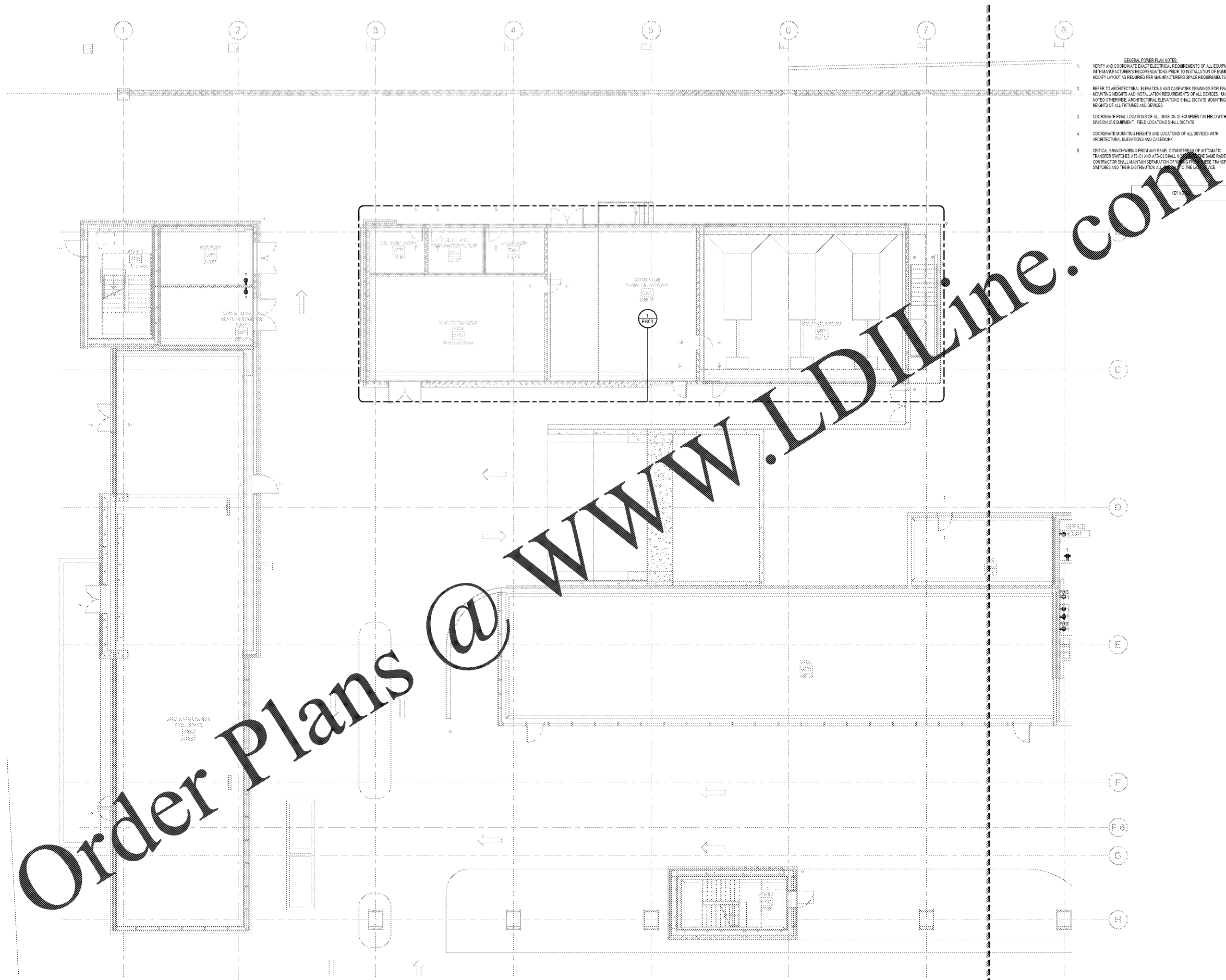

Order Plans @ www.LDILine.com

1 FLOOR PLAN - GROUND LEVEL - WEST - POWER
 1/8" = 1'-0"