

2 RCP
 1/4" = 1'-0"
 INFUSION PHARMACY - 8TH FLOOR RCP

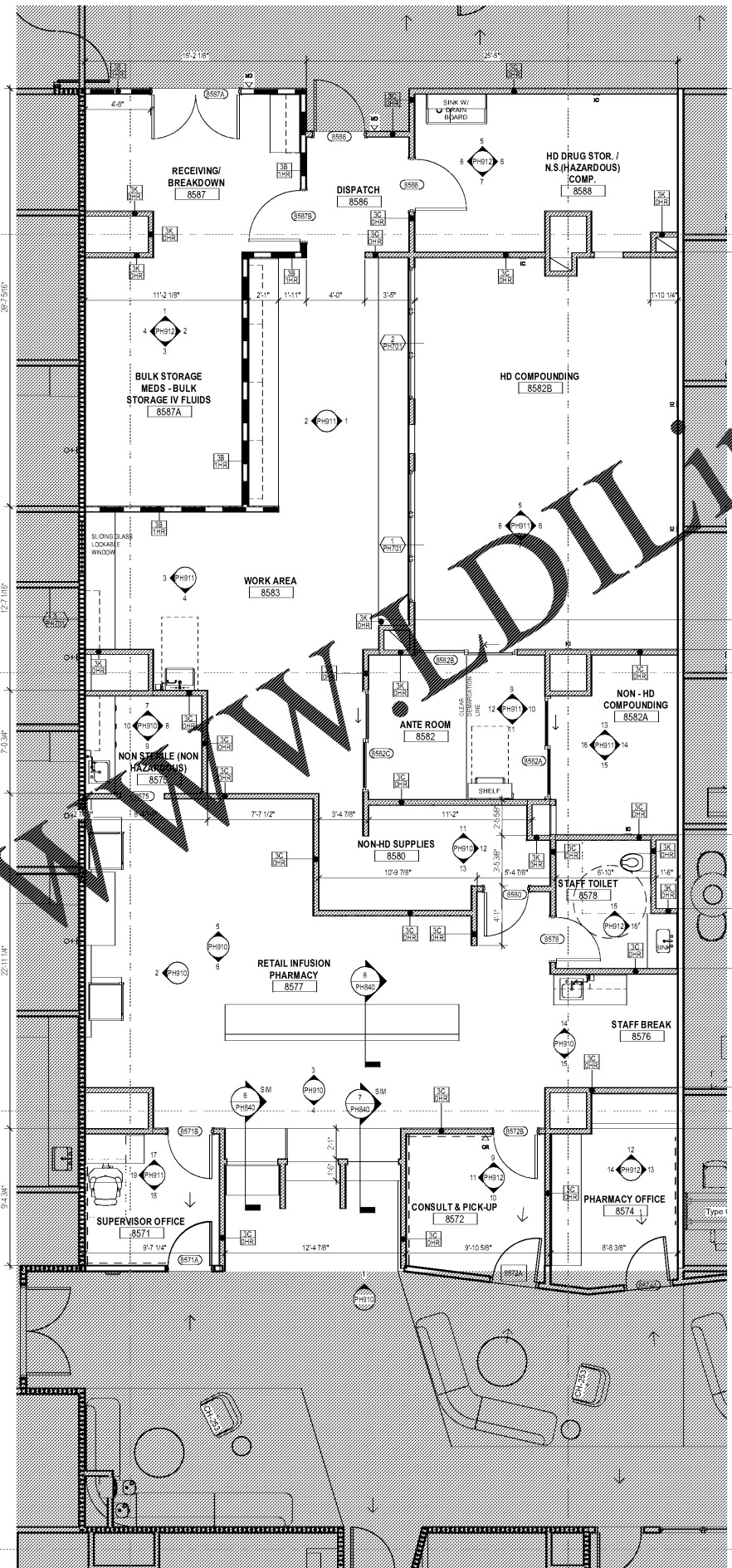

1 PLAN
 1/4" = 1'-0"
 INFUSION PHARMACY - 8TH FLOOR - NEW WORK

FLOOR PLAN GENERAL NOTES

- A. ALL DIMENSIONS ARE TO FACE OF WALL (UNLESS NOTED OTHERWISE).
- B. SEE FINISH SCHEDULE FOR ADDITIONAL INFORMATION OF LOCATIONS AND TYPES OF FINISH MATERIALS.
- C. SEE EQUIPMENT PLAN FOR ALL NEW EQUIPMENT AND FINISHINGS.
- D. SEE WALL TYPE NOTE #2 FOR ALL NEW WINDOWS.
- E. ALL WALLS ARE TYPE "C" WALLS UNLESS NOTED OTHERWISE - SEE ENLARGED PLANS AND WALL TYPES FOR MORE INFORMATION.
- F. ALL WALLS TO BE PAINTED PT-1 U.N.O.
- G. PROVIDE WOOD BLOCKING, NOT EXPOSED, AS REQUIRED FOR ALL MILLWORK, CASEWORK, P.M.E. DEVICES AND FIXTURES.
- H. COORDINATE ALL WORK WITH ENGINEERS DRAWINGS.
- I. SEE ELEVATIONS AND STRUCTURAL DRAWINGS FOR ALL CONTROL JOINT LOCATIONS.
- J. COORDINATE WITH ENGINEERS DRAWINGS ALL ACCESS PANEL LOCATIONS REQUIRED.
- K. REFER TO LIFE SAFETY PLANS FOR FIRE/SMOKE PARTITION TYPES AND LOCATIONS AND FIRE EXTINGUISHER INFORMATION.
- L. INSTALL HOSPITAL PROVIDED SOAP, SANITIZERS AND PAPER TOWEL DISPENSERS AT ALL WALL AND COUNTER MOUNTED SINK LOCATIONS - SEE MOUNTING HEIGHTS SHEET.
- M. MECHANICAL & ELECTRICAL EQUIPMENT SHALL BE ON HOUSEKEEPING PADS. PADS ARE TO BE PROVIDED BY THE TRADE SUPPLYING THE EQUIPMENT. SEE MECHANICAL AND ELECTRICAL DRAWINGS FOR ADDITIONAL INFORMATION. WORK TO BE COORDINATED THROUGH THE GENERAL TRADES CONTRACTOR PADS 4" MIN. 4" THICK WITH W.W.F. UNLESS NOTED OTHERWISE. SEE NEATLY FORMED AROUND BEAMS WITH ALL CAVITIES FILLED WITH INSULATION.
- N. SEE ENLARGED PLANS WHERE INDICATED FOR DETAILS WITH OTHER TRADES CONTRACTOR AREA.
- O. FRAMING CONTRACTOR SHALL COORDINATE WITH OTHER TRADES TO NOT THICKEN WALLS AS REQUIRED FOR SPECIAL PANEL EQUIPMENT PANELS, ETC. REVIEW ALL HORIZONTAL WALL DEVICES WITH ARCHITECT.
- P. CONTRACTOR IS RESPONSIBLE FOR VERIFYING EXISTING WALL COMPLIANCE WITH CODES. VERIFY EXISTING WALL IS NOT IN COMPLIANCE WITH CONTRACT DOCUMENTS FOR CLARIFICATION.
- Q. REPAIR AND MAINTAIN 2-HOUR RATED FLOOR SLAB SEE STRUCTURAL DRAWINGS FOR SIZE AND LOCATIONS.
- R. SEE STRUCTURAL DRAWINGS FOR STEEL REINFORCING IN WALLS AND FLOOR STRUCTURE.

CODED NOTE LEGEND

1. EXISTING AREA OF NO WORK.
2. EXISTING EQUIPMENT TO REMAIN - SEE PLUMBING DRAWINGS.
3. COMPLETE WALL CONSTRUCTION AS NECESSARY TO ACQUIRE NEW G.W.B. FINISHES TO BE CONSISTENT WITH NEW CONSTRUCTION AT SPECIFIED LOCATION.
4. WALL MOUNTED SINK (STERILE AREA) - SEE PLUMBING DRAWINGS & MOUNTING HEIGHTS SHEET.
5. WALL MOUNTED SINK (WITH ACCESSORIES) - SEE PLUMBING DRAWINGS & MOUNTING HEIGHTS SHEET.
6. COUNTER MOUNTED SINK - SEE PLUMBING DRAWINGS & MOUNTING HEIGHTS SHEET.
7. NEW CASWORK - SEE DETAILS.
8. INFILL EXISTING WINDOW WITH NEW WALL TO MATCH EXISTING WALL TYPE.
9. INFILL NEW WALL OPENING WITH NEW WALL TO MATCH EXISTING WALL TYPE.
10. ELECTRIC DOOR HARDWARE CONTROL DEVICE (HAND REOPER. REFER TO DOOR HARDWARE AND ELECTRICAL DRAWINGS FOR ADDITIONAL INFORMATION).
11. NEW FIRE EXTINGUISHER CABINET, COORDINATE WITH LIFE SAFETY SHEETS.
12. EXISTING DRYWALL - HEADER TO REMAIN ABOVE WINDOW/DOOR OPENING - SEE RELEVANT CEILING PLANS.
13. NEW EQUIPMENT - SEE EQ120 SERIES SHEETS FOR EQUIPMENT DESIGNATION.
14. RELOCATED EQUIPMENT - SEE EQ120 SERIES SHEETS FOR EQUIPMENT DESIGNATION.
15. PARTIAL HEIGHT WALL - SEE DETAIL.
16. FIRE EXTINGUISHER CABINET - SEE MOUNTING HEIGHTS SHEET.
17. NEW PARTIAL WINDOW LOCATION - SEE DETAIL.
18. DASHED LINE OF CLEAR DEMARCATION AREA.
19. 24" WIDE X 12" DEEP STAINLESS STEEL SHELF MOUNTED AT 48" A.F.F. FOR SOAP AND PAPER TOWELS.

RCP GENERAL NOTES

- A. PAINT DESIGNATED FOR EXPOSED OVERHEAD STRUCTURES IS TO INCLUDE ALL COMPONENTS INCLUDING (BUT NOT EXCLUSIVE TO) DECKING, STRUCTURAL MEMBERS, MECHANICAL AND ELECTRICAL DELIVERY SYSTEMS, FIRE PROTECTION SYSTEMS (INCLUDING SPRINKLER HEADS) AND ALL OTHER MISCELLANEOUS BUILDING SYSTEMS LOCATED OVERHEAD. EACH OF THE FOREMENTIONED CATEGORIES IS TO INCLUDE ANY AND ALL ASSOCIATED SUPPORTS, HANGERS, STRUTS, BRACES, BRACKETS, ETC.
- B. LIGHT FIXTURES SHOWN TO INDICATE PROPOSED FIXTURES & GENERAL DESIGN INTENT - SEE P.M.E. DRAWINGS.
- C. COORDINATE LOCATION OF FIXTURES WITH MECHANICAL, ELECTRICAL, PLUMBING, FIRE SUPPRESSION AND TECHNOLOGY DRAWINGS. ANY CONFLICT BETWEEN TRADES, NOTIFY ARCHITECT PRIOR TO INSTALLATION.
- D. FINISHED CEILING HEIGHTS ARE MARKED FROM TOP OF FINISH FLOOR U.N.O.
- E. FACE OF BULKHEADS ARE TO ALIGN WITH FACE OF ADJACENT WALLS TO WHICH BULKHEADS ARE PARALLEL U.N.O. OR DIMENSIONED.
- F. ALL GYPSUM BOARD SOFFITS & CEILING ARE TO BE PAINTED FLAT CEILING WHITE U.N.O.
- G. PAINT DUCTWORK INSIDE AIR GRILLES FLAT BLACK.
- H. CEILING GRIDS ARE CENTERED ON ROOM, U.N.O. OR DIMENSIONED.
- I. ALL CEILING DEVICES TO BE CENTERED IN PILE, U.N.O.
- J. WHERE EXISTING DEVICES OCCUR OVER A DOOR OR PAIR OF DOORS, CENTER SIGN IN DOOR OPENING.
- K. COORDINATE LOCATIONS OF ALL G.W.B. MOUNTED CEILING ACCESS PANELS BEFORE INSTALLATION.

CODED NOTE LEGEND

1. ALL CEILING MOUNTED EQUIPMENT SHALL BE INSTALLED PER P.M.E. DRAWINGS - SEE P.M.E. DRAWINGS FOR ADDITIONAL DETAIL.
2. NEW MECHANICAL DUCTWORK IN THIS AREA. REPAIR CEILING AS NECESSARY TO CONNECT TO EXISTING.
3. EXISTING DRYWALL - HEADER TO REMAIN.
4. ALIGN NEW SOFFIT WITH EXISTING SOFFIT HEIGHT AND FINISHES.
5. ALIGN FIXTURES.
6. REPAIR EXISTING CEILING WHERE WALLS HAVE BEEN MODIFIED.
7. EXISTING SOFFIT TO REMAIN.
8. WALL MOUNTED LIGHT FIXTURE REFER TO ELECTRICAL DRAWINGS.
9. NEW G.W.B. SOFFIT - SEE DETAIL.
10. ALIGN EDGE OF SOFFIT WITH WALL.
11. SUSPENDED LIGHT FIXTURE.

RCP LEGEND

- A1 ACOUSTIC CEILING TYPE 1: 2x2' LAY-IN CEILING
- A2 ACOUSTIC CEILING TYPE 2: 2x4' LAY-IN CEILING
- E1 EXPOSED STRUCTURE ABOVE
- G1 GYPSUM BOARD CEILING OR SOFFIT
- 2x2 FLUORESCENT LIGHT FIXTURE (SHADING DENOTES EMERGENCY FIXTURE)
- 2x4 FLUORESCENT LIGHT FIXTURE (SHADING DENOTES EMERGENCY FIXTURE)
- 1x4 FLUORESCENT LIGHT FIXTURE (SHADING DENOTES EMERGENCY FIXTURE)
- 1/8 FLUORESCENT LIGHT FIXTURE (SHADING DENOTES EMERGENCY FIXTURE)
- RECESSED CAN LIGHT
- SURFACE MOUNTED LIGHT
- EXIT LIGHT WITH DIRECTIONAL ARROW
- EXIT LIGHT
- SUPPLY DIFFUSER
- LINEAR DIFFUSER
- EXHAUST RETURN GRILLE
- SPEAKER
- CEILING TAG WITH HEIGHT



Project
 CASS Pharmacies

88 Jesse Hill Drive
 Atlanta, GA 30303

Prepared For
 GRADY HEALTH SYSTEM



Hickmont, O'Leary & Kastbaum, Inc.
 133 Peachtree Street, NE, Suite 4800
 Atlanta, GA 30303 USA
 +1 404 439 9300 +1 404 439 9001

All reproduction & intellectual property rights reserved ©
 in Association with

Key Plan

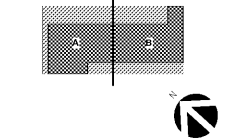

Professional Seal

NOT FOR CONSTRUCTION

No.	Description	Date
1	ED - GMP	2019-07-03

Project No: 18534.01
 Sheet Title

ENLARGED PLANS - INFUSION PHARMACY

Original is 30" x 42". Do not scale contents of this drawing.
 Sheet Number

PH408

Order Plans @

AWW@Dilme