

14 INFUSION NOURISHMENT ROOM - W  
3/8" = 1'-0"

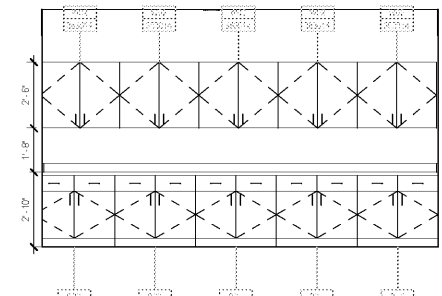

10 BREAST IMAGING TECH WORK - S  
3/8" = 1'-0"

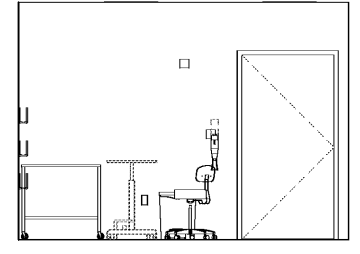

8 MAMMO DIAGNOSTIC - W  
3/8" = 1'-0"

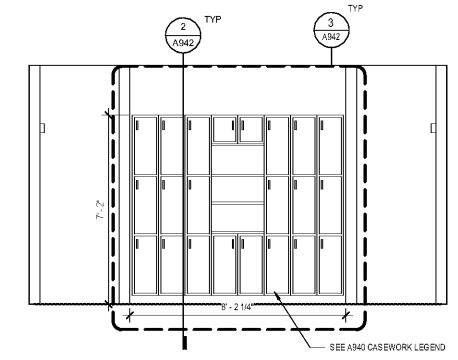

4 BREAST IMAGING CHANGING ROOM - N  
3/8" = 1'-0"

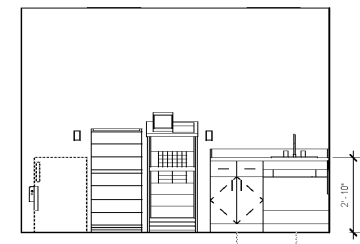

13 TYP INFUSION MEDS ROOM - E  
3/8" = 1'-0"

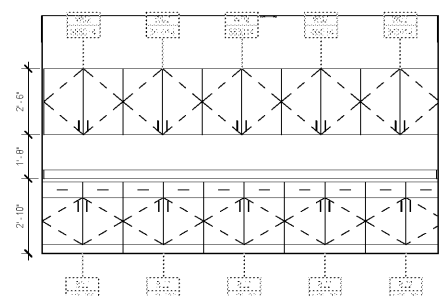

9 BREAST IMAGING TECH WORK - N  
3/8" = 1'-0"

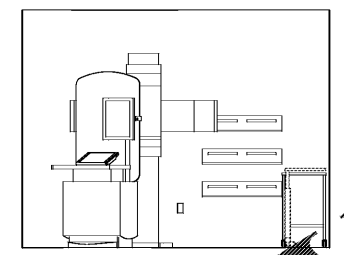

7 MAMMO DIAGNOSTIC - S  
3/8" = 1'-0"

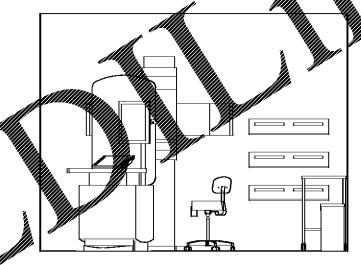

3 MAMMO - S  
3/8" = 1'-0"

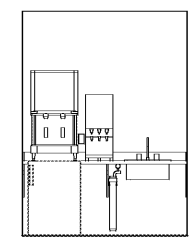

12 INFUSION NOURISHMENT ALCOVE - E  
3/8" = 1'-0"

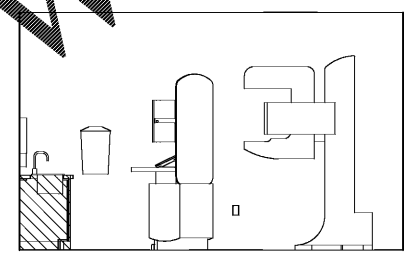

6 MAMMO DIAGNOSTIC - E  
3/8" = 1'-0"

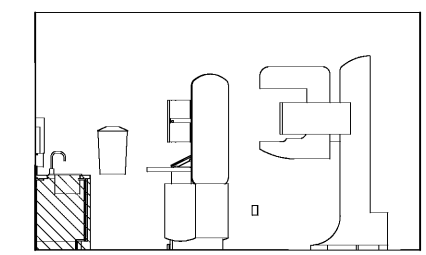

2 MAMMO - E  
3/8" = 1'-0"

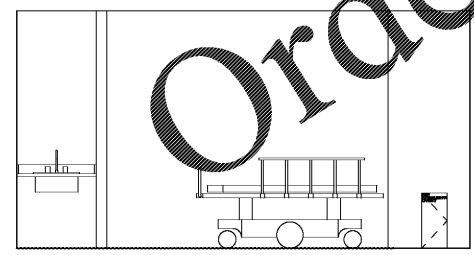

11 TYP INFUSION ALCOVE - S  
3/8" = 1'-0"

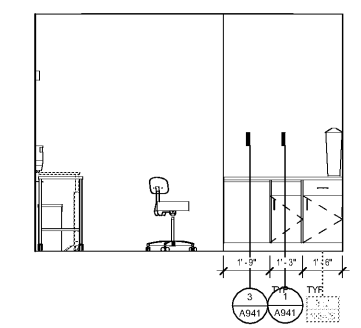

5 MAMMO DIAGNOSTIC - N  
3/8" = 1'-0"

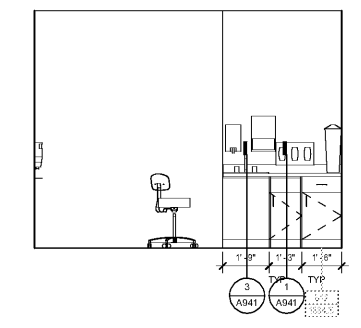

1 MAMMO - N  
3/8" = 1'-0"

SHEET SPECIFIC NOTES

- A. GENERAL NOTES:**
- TRUE NORTH USED FOR NORTH, EAST, SOUTH, AND WEST DESIGNATION. REFER TO NORTH ARROW ON FLOOR PLANS.
  - EQUIPMENT IS SHOWN FOR SPACE PLANNING AND MOUNTING-HEIGHT PURPOSES ONLY. REFER TO MEDICAL EQUIPMENT DRAWINGS FOR QUANTITIES, DIMENSIONS, POWER REQUIREMENTS AND ADDITIONAL INFORMATION.
  - ALL CASEWORK TO BE LOOKABE, U.N.O.
  - REFER TO ENLARGED PLANS, ELEVATIONS AND DETAILS FOR CLARIFICATION OF EXTENT OF FINISH MATERIALS AND ADDITIONAL INFORMATION.
  - REFER TO A940 SERIES SHEETS FOR TYPICAL CASEWORK SECTIONS AND GENERAL NOTES.
  - REFER TO A220 SERIES FINISH PLANS FOR FINISH & WALL PROTECTION SYSTEM EXTENTS AND INFORMATION.
  - REFER TO A220.1, A220.2 FOR WALL PROTECTION SYSTEM LEGEND AND FINISH SCHEDULE.
  - WHERE TRANSITIONS OF WALL PROTECTION OCCUR USE THE REGLET TRANSITIONS PIECES AS FOLLOWS:
    - AT CORNER TRANSITION USE REGLET #125-211 ANODIZED
    - AT TRANSITION FROM WALL PROTECTION TO CASE USE FRY REGLET W/CTB ANODIZED
    - AT TRANSITION FROM TRANSITION TO WALL PROTECTION USE W/CTB #217 CLEAR ANODIZED
- B. DEFINITIONS:**
- GWB - GYPSUM WALL BOARD
  - W - WALL PROTECTION SYSTEM



Project  
**THE CENTER FOR  
ADVANCED SURGICAL  
SERVICES (CASS)**  
80 GILMER STREET SE  
ATLANTA, GA 30303

Prepared For  
**GRADY HEALTH SYSTEM**  
80 JESSE HILL DR. SE  
ATLANTA, GA 30303



Hok, Inc. (Hok & Kistebaum, Inc.)  
133 Peachtree Street, NE, Suite 4800  
Atlanta, GA 30303 USA  
+1 404 439 9000 +1 404 439 9001

All reproduction & intellectual property rights reserved © 2019  
in Association with

Key Plan

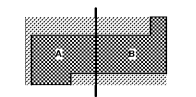

Professional Seal

**NOT FOR  
CONSTRUCTION**

No.	Description	Date
1	ED - GMP	2019-07-03

Project No: 18.16013.00  
Sheet Title  
**CLINICAL ELEVATIONS  
- LEVEL 08**

Original is 20 x 42. Do not scale contents of this drawing  
Sheet Number

**A648.3**

Order Plans @ [WWW.LDILine.com](http://WWW.LDILine.com)