



Project  
**THE CENTER FOR  
 ADVANCED SURGICAL  
 SERVICES (CASS)**  
 80 GILMER STREET SE  
 ATLANTA, GA 30303

Prepared For  
**GRADY HEALTH SYSTEM**  
 80 JESSE HILL DR. SE  
 ATLANTA, GA 30303



Hok, Inc. / Jacobs & Kasstbaum, Inc.  
 133 Peachtree Street, NE, Suite 4800  
 Atlanta, GA 30303 USA  
 T+1 404 439 9000 F+1 404 439 9001

All reproduction & intellectual property rights reserved ©  
 2019. In Association with

Key Plan

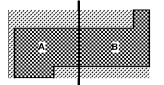

Professional Seal

**NOT FOR  
 CONSTRUCTION**

No.	Description	Date
1	ED - GMP	2019.07.03

Project No: 18.16013.00  
 Sheet Title

**LEVEL 7 REFLECTED  
 CEILING PLAN - EAST**

Original is 30 x 42. Do not scale contents of this drawing.  
 Sheet Number

**A307B**

**RCP LEGEND**

**MATERIALS**

- 2' x 2' GRID AND TILE SYSTEM - SEE SPECIFICATIONS
- 2' x 4' GRID AND ACoustical TILE SYSTEM - SEE SPECIFICATIONS
- GYPSUM BOARD CEILING AS INDICATED ON PLAN. SEE FINISH PLAN FOR PAINT SPECIFICATIONS
- WOOD SLAT SUSPENDED CEILING SYSTEM
- UNDERSIDE OF WOOD VENEER PORTAL
- GSI: INSULATED GYPSUM BOARD SYSTEM
- EXTERIOR BRICK

**ANNOTATIONS**

- DIMENSIONING HEIGHT AS INDICATED ON PLAN UNL.

**LIGHT FIXTURES**

- 2' x 2' RECESSED SEMI-INDIRECT LUMINAIRE
- 2' x 4' RECESSED SEMI-INDIRECT LUMINAIRE
- RECESSED LINEAR LUMINAIRE - REFER TO ELEC DRAWINGS FOR LENGTH AND MOUNTING HEIGHT
- LINEAR LED STRIP LIGHT
- RECESSED DOWNLIGHT - ROUND
- RECESSED DOWNLIGHT - SQUARE
- COVE LIGHT
- CEILING SURFACE MOUNTED STRIP LIGHT
- PENDANT
- PENDANT MTD DIRECT / INDIRECT LED
- UNDER CABINET
- UPLIGHT STRIP

**SHADES**

- WINDOW SHADES - MOTORIZED
- WINDOW SHADES - MANUAL

**POWER & TELEDATA**

- FF FURNITURE FEED, POWER POLE AS INDICATED
- OCCUPANCY SENSOR
- AUDIO SPEAKER
- PROJECTOR
- PROJECTION SCREEN - ELECTRONIC
- PROJECTION SCREEN - MANUAL

**LIFE SAFETY**

- EXIT SIGN, ARROW INDICATES PATH OF TRAVEL
- SMOKE DETECTOR
- LIFE SAFETY SPEAKER STROBE
- LIFE SAFETY SPEAKER
- LIFE SAFETY STROBE
- SPRINKLER

**KEY NOTES**

- THESE NOTES ARE FOR THE PURPOSE OF 3D COORDINATION ONLY
- KEY ROOMS TO HAVE 2' X 2' ACoustical CEILING TILE, TWO 2' X 4' RECESSED LUMINAIRE UNL.
  - COORDINATE LIGHTING FOR ALL SPECIALTY KEY ROOMS
    - \* LIGHT FIXTURES IN IMAGING AND EYE CLINICS TO HAVE DIMMABLE CAPABILITIES
  - COORDINATE ANY SPECIFIC EQUIPMENT WITH LIGHTING IMPLICATIONS (I.E. MEDICAL INTENSIVE ROOMS) WITH APPROPRIATE CONSULTANTS
  - PERIMETER LIGHTING AT CORRIDORS TO ILLUMINATE THE PATIENT SIDE AS A WAY FINDING METHOD
  - COORDINATE SPOT LED FIXTURES AT NURSE STATIONS AND IMPORTANT LANDMARKS
  - PARKING LEVEL FIXTURES ARE SHOWN FOR LOCATION ONLY. REFER TO ELECTRICAL LIGHTING PLANS FOR QUANTITIES AND SPECIFICATIONS.

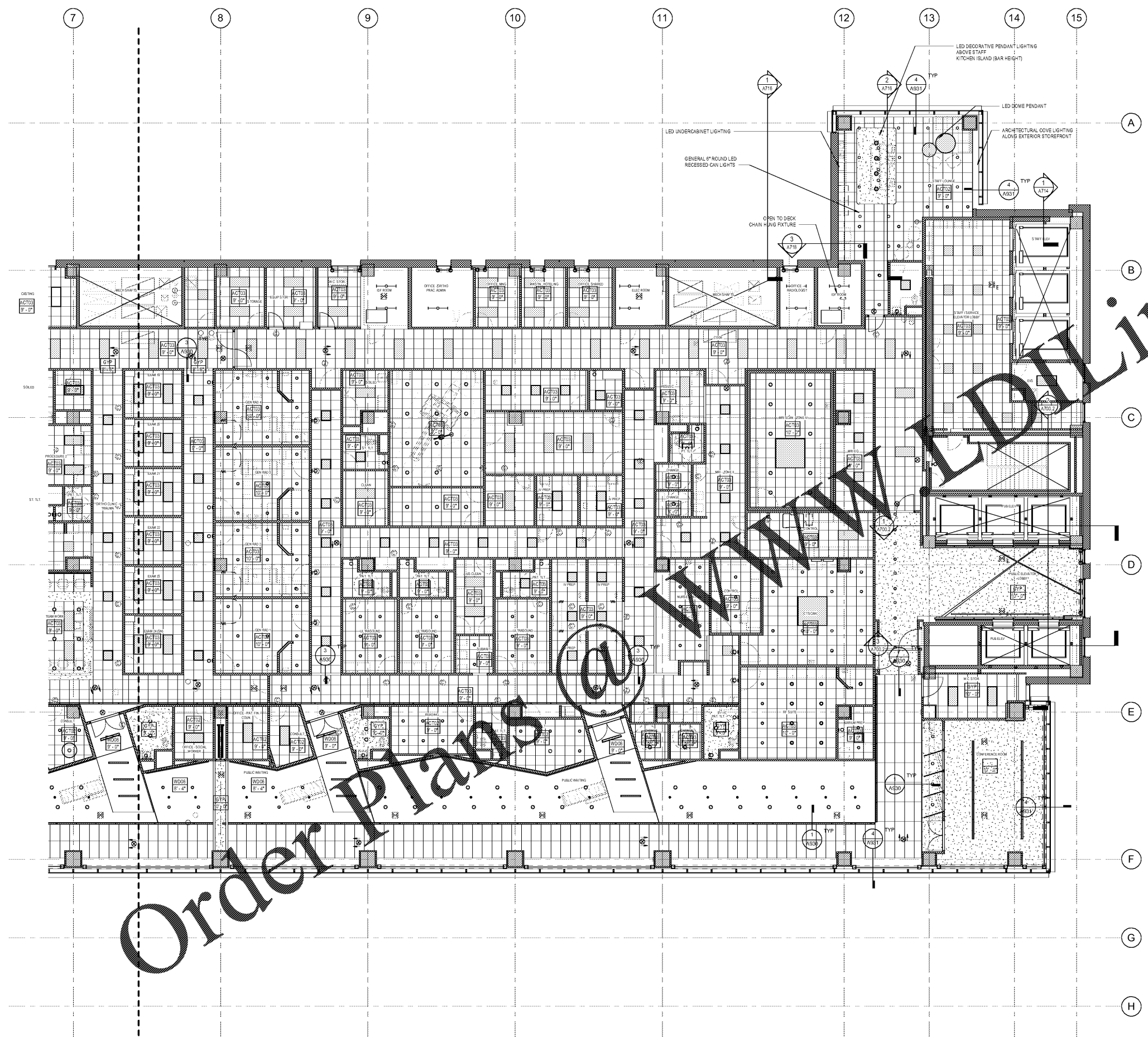

1 REFLECTED CEILING PLAN - LEVEL 7 - EAST  
 1/8" = 1'-0"

Order Plans @ [www.orderplans.com](http://www.orderplans.com)