



Project
**THE CENTER FOR
 ADVANCED SURGICAL
 SERVICES (CASS)**
 80 GILMER STREET SE
 ATLANTA, GA 30303

Prepared For
GRADY HEALTH SYSTEM
 80 JESSE HILL DR. SE
 ATLANTA, GA 30303



Helmuth, Obata & Kassabaum, Inc.
 133 Peachtree Street, NE, Suite 4800
 Atlanta, GA 30303 USA
 T+1 404 439 9000 F+1 404 439 9001

All reproduction & intellectual property rights reserved ©
 2019
 An Association with

Key Plan

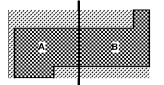

Professional Seal



**NOT FOR
 CONSTRUCTION**

No.	Description	Date
1	ED - GMP	2019.07.03

Project No: 18.16013.00
 Sheet Title

**LEVEL 6 REFLECTED
 CEILING PLAN - WEST**

Original is 30 x 42. Do not scale contents of this drawing.
 Sheet Number

A306A

RCP LEGEND

MATERIALS

- 2' x 2' GRID AND TILE SYSTEM - SEE SPECIFICATIONS
- 2' x 4' GRID AND ACOUSTICAL TILE SYSTEM - SEE SPECIFICATIONS
- GYPSUM BOARD CEILING AS INDICATED ON PLAN. SEE FINISH PLAN FOR PAINT SPECIFICATIONS
- WOOD SLAT SUSPENDED CEILING SYSTEM
- UNDERSIDE OF WOOD VENEER PORTAL
- GSI: INSULATED GYPSUM BOARD (GSPF)
- EXTERIOR STUCCO

ANNOTATIONS

- FINISHED CEILING HEIGHT AS INDICATED ON PLAN UON.

LIGHT FIXTURES

- 2' x 2' RECESSED SEMI-DIRECT LUMINAIRE
- 2' x 4' RECESSED SEMI-DIRECT LUMINAIRE
- RECESSED LINEAR LUMINAIRE - REFER TO ELEC DRAWINGS FOR LENGTH AND MOUNTING HEIGHT
- LINEAR LED STRIP LIGHT
- RECESSED DOWNLIGHT - ROUND
- RECESSED DOWNLIGHT - SQUARE
- COVE LIGHT
- CEILING SURFACE MOUNTED STRIP LIGHT
- PENDANT
- PENDANT MTD DIRECT/INDIRECT LED
- UNDER CABINET
- UPLIGHT STRIP

SHADES

- WINDOW SHADES - MOTORIZED
- WINDOW SHADES - MANUAL

POWER & TELEDATA

- FF: FURNITURE FEED, POWER POLE AS INDICATED
- OS: OCCUPANCY SENSOR
- AS: AUDIO SPEAKER
- P: PROJECTOR
- EPS: PROJECTION SCREEN - ELECTRONIC
- MPS: PROJECTION SCREEN - MANUAL

LIFE SAFETY

- EXT SIGN, ARROW INDICATES PATH OF TRAVEL
- SD: SMOKE DETECTOR
- LSS: LIFE SAFETY SPEAKER
- LST: LIFE SAFETY STROBE
- LSS: LIFE SAFETY SPEAKER
- LST: LIFE SAFETY STROBE
- S: SPRINKLER

KEY NOTES

- THESE NOTES ARE FOR THE PURPOSE OF DD COORDINATION ONLY
- KEY ROOMS TO HAVE 2' X 2' ACOUSTICAL CEILING TILE, TWO 2' X 4' RECESSED LUMINAIRE, UON.
 - COORDINATE LIGHTING FOR ALL SPECIALTY KEY ROOMS
 - LIGHT FIXTURES IN IMAGING AND EYE CLINICS TO HAVE DIMMABLE CAPABILITIES
 - COORDINATE ANY SPECIFIC EQUIPMENT WITH LIGHTING IMPLICATIONS (I.E. MEDICAL INTENSIVE ROOMS) WITH APPROPRIATE CONSULTANTS
 - PERMETER LIGHTING AT CORRIDORS TO ILLUMINATE THE PATIENT SIDE AS A WAY FINDING METHOD
 - COORDINATE SPOT LED FIXTURES AT NURSE STATIONS AND IMPORTANT LANDMARKS
 - PARKING LEVEL FIXTURES ARE SHOWN FOR LOCATION ONLY. REFER TO ELECTRICAL LIGHTING PLANS FOR QUANTITIES AND SPECIFICATIONS.

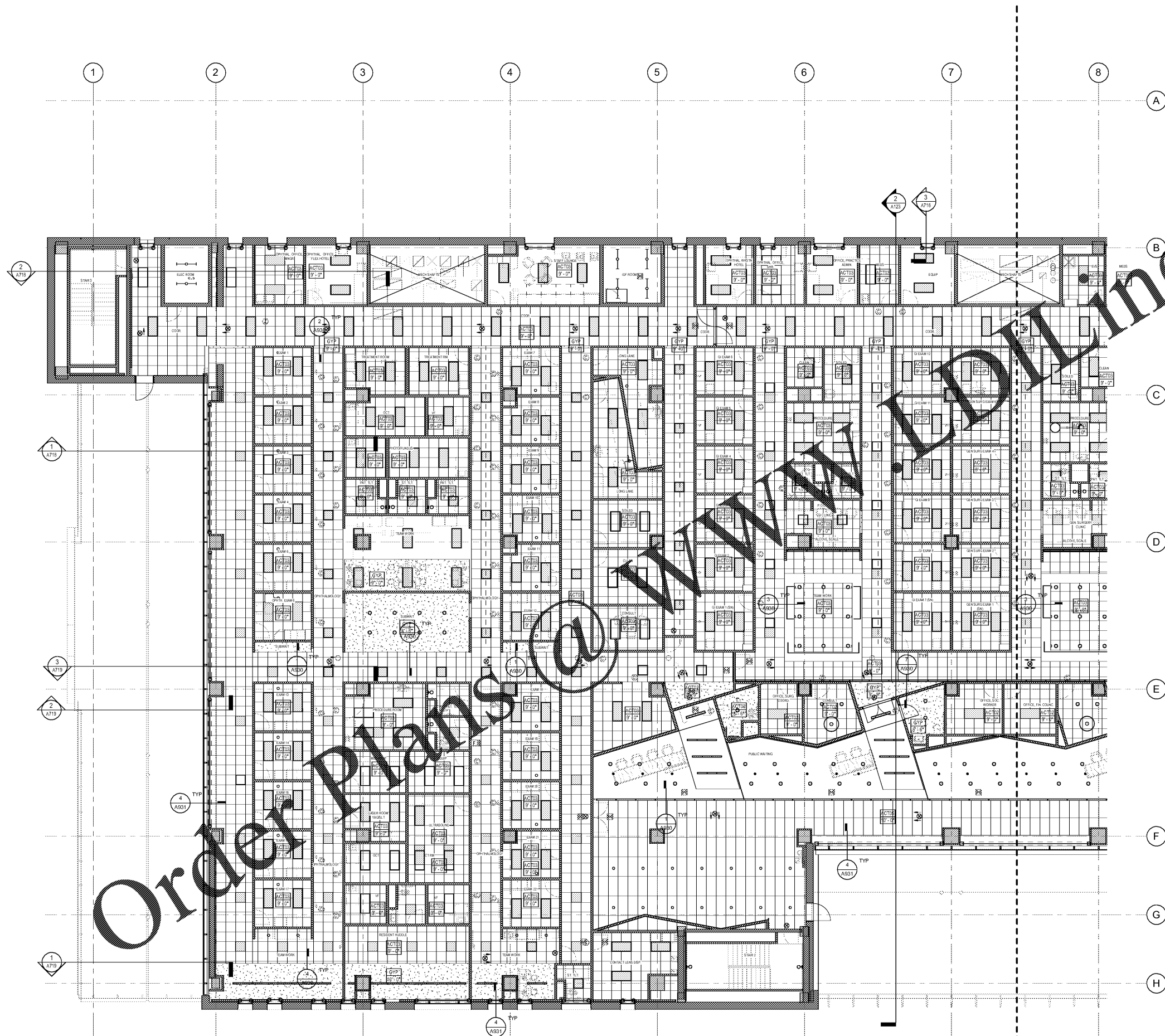

1 REFLECTED CEILING PLAN - LEVEL 6 - WEST
 1/8" = 1'-0"