

GENERAL PLAN NOTES

- ████████████████████ SMOKE BARRIER
  - ██████████████████ 1 HOUR FIRE BARRIER / 1 HR FIRE + SMOKE
  - ██████████████████ 2 HOUR FIRE BARRIER / 2 HR FIRE + SMOKE
1. REVIEW LIFE SAFETY SHEETS FOR FIRE AND SMOKE BARRIER WALL DESIGNATIONS.
  2. SMOKE COMPARTMENT WALLS TO BE MAINTAINED. PHASE ADJACENT PURRING WALLS TO MAINTAIN ADEQUATE SEPARATION REQUIREMENTS. SEE LIFE SAFETY.
  3. WALLS AT LEVELS 6, 4, 5, & 9 TO BE TYPE A0, UNLESS NOTED OTHERWISE. PURRING WALLS AT LEVELS 4, 5, & 9 TO BE TYPE PE UNLESS NOTED OTHERWISE.
  4. WALLS AT LEVELS 1, 2, 3, 6, 7, 8 TO BE TYPE A3, UNLESS NOTED OTHERWISE.
  5. WALL PRIORITY DIAGRAM LOCATED ON INTERIOR PARTITIONS SHEETS. FIRE, SMOKE, AND ACOUSTICAL RATED WALLS TAKE PRECEDENT OVER NON-RATED WALLS. MAINTAIN INTEGRITY OF RATINGS.
  6. WALLS CARRYING STC RATINGS TO BE MAINTAINED ENTIRE LENGTH. WALL SEE PARTITION SCHEDULE FOR MINIMUM STC RATINGS. ASSIGNED VALUES INDICATED ON A100 SERIES DIAGRAMS.
  7. FACETED WALLS AT PUBLIC WAITING AREAS RECEIVE 5 WALL.
  8. MAINTAIN LEAD LINING PARTITION AROUND THE PERIMETER OF ROOM, DOORS, & WINDOWS.
  9. PTS - PNEUMATIC TUBE SYSTEM NOTES. PLAN 1  
PTS - PNEUMATIC TUBE STATION - CALLED OUT  
PTSF - PNEUMATIC TUBE STATION WITH OVERHEAD CONNECTIONS ESTABLISHED



Project  
**THE CENTER FOR  
 ADVANCED SURGICAL  
 SERVICES (CASS)**  
 80 GILMER STREET SE  
 ATLANTA, GA 30303

Prepared For  
**GRADY HEALTH SYSTEM**  
 80 JESSE HILL DR. SE  
 ATLANTA, GA 30303



Helmuth, Obata & Kassabaum, Inc.  
 133 Peachtree Street, NE, Suite 4800  
 Atlanta, GA 30303 USA  
 +1 404 439 9000 F +1 404 439 9001

All reproduction & intellectual property rights reserved ©  
 2019  
 In Association with

Key Plan

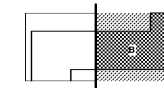

Professional Seal

**NOT FOR  
 CONSTRUCTION**

No.	Description	Date
1	DC - GMP	2019.07.03

Project No: 18.16013.00  
 Sheet Title

**LEVEL 9 PENTHOUSE -  
 EAST**

Original is 20 x 43. Do not scale contents of this drawing  
 Sheet Number

**A209B**

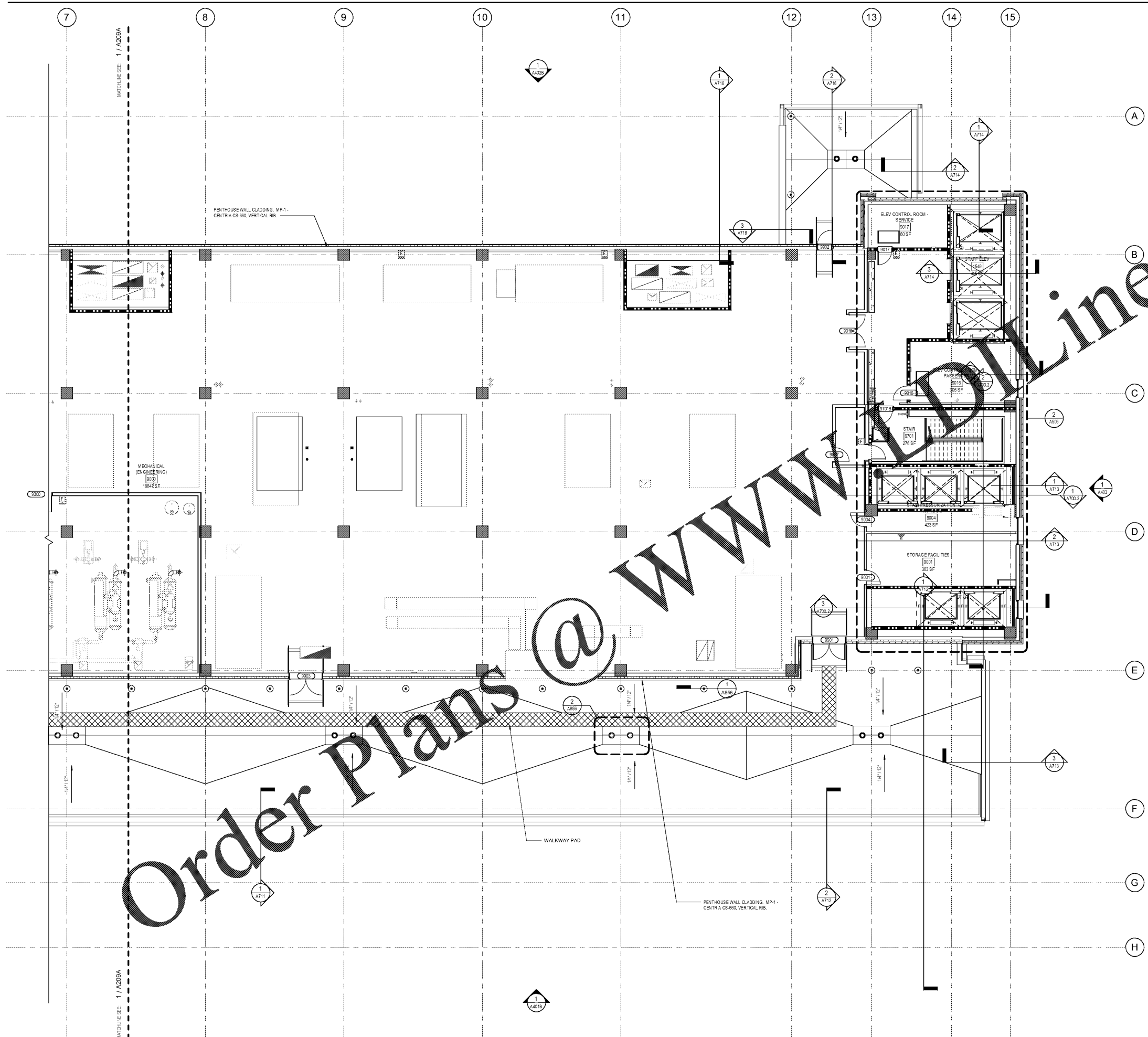

Order Plans @ WWW.OrderPlans.com

**1 FLOOR PLAN - PENTHOUSE - EAST**  
 1/8" = 1'-0"

2019-07-05 4:37:23 PM