

GENERAL PLAN NOTES

- 1. REVIEW LIFE SAFETY SHEETS FOR FIRE AND SMOKE BARRIER WALL DESIGNATIONS.
- 2. SMOKE COMPARTMENT WALLS TO BE MAINTAINED. PHASE ADJACENT FURRING WALLS TO MAINTAIN ADEQUATE SEPARATION REQUIREMENTS. SEE LIFE SAFETY.
- 3. WALLS AT LEVELS 6, 4, 5, & 9 TO BE TYPE A6, UNLESS NOTED OTHERWISE. FURRING WALLS AT LEVELS 6, 4, 5, & 9 TO BE TYPE F6, UNLESS NOTED OTHERWISE.
- 4. WALLS AT LEVELS 1, 2, 3, 6, 7, 8 TO BE TYPE A3, UNLESS NOTED OTHERWISE.
- 5. WALL PRIORITY DIAGRAM LOCATED ON INTERIOR PARTITIONS SHEETS. FIRE, SMOKE, AND ACoustICAL RATED WALLS TAKE PRECEDENCE OVER NON-RATED WALLS. MAINTAIN INTEGRITY OF RATINGS.
- 6. WALLS CARRYING STC RATINGS TO BE MAINTAINED ENTIRE LENGTH. WALL SEE PARTITION SCHEDULE FOR MINIMUM STC RATINGS. ASSIGNED VALUES INDICATED ON A100 SERIES DIAGRAMS.
- 7. FACETED WALLS AT PUBLIC WAITING AREAS RECEIVE 5 WALL.
- 8. MAINTAIN LEAD LINING PARTITION AROUND THE PERIMETER OF ROOM, DOORS, & WINDOWS.
- 9. PTS - PNEUMATIC TUBE SYSTEM NOTES. PLAN 1  
PTS - PNEUMATIC TUBE STATION - CALLED OUT  
PTS - PNEUMATIC TUBE STATION WITH OVERHEAD CONNECTIONS ESTABLISHED



Project  
THE CENTER FOR  
ADVANCED SURGICAL  
SERVICES (CASS)

80 GILMER STREET SE  
ATLANTA, GA 30303

Prepared For  
GRADY HEALTH SYSTEM  
80 JESSE HILL DR. SE  
ATLANTA, GA 30303



Hok, Inc. • Obata & Kassabaum, Inc.  
133 Peachtree Street, NE, Suite 4800  
Atlanta, GA 30303 USA  
+1 404 439 9000 +1 404 439 9001

All reproduction & intellectual property rights reserved ©  
2019  
An Association with

Key Plan

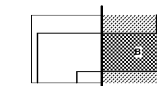

Professional Seal

**NOT FOR  
CONSTRUCTION**

No.	Description	Date
1	DC - GMP	2019.07.03

Project No: 18.16013.00  
Sheet Title

LEVEL 8 FLOOR PLAN -  
EAST

Original is 20 x 42. Do not scale contents of this drawing.  
Sheet Number

**A208B**

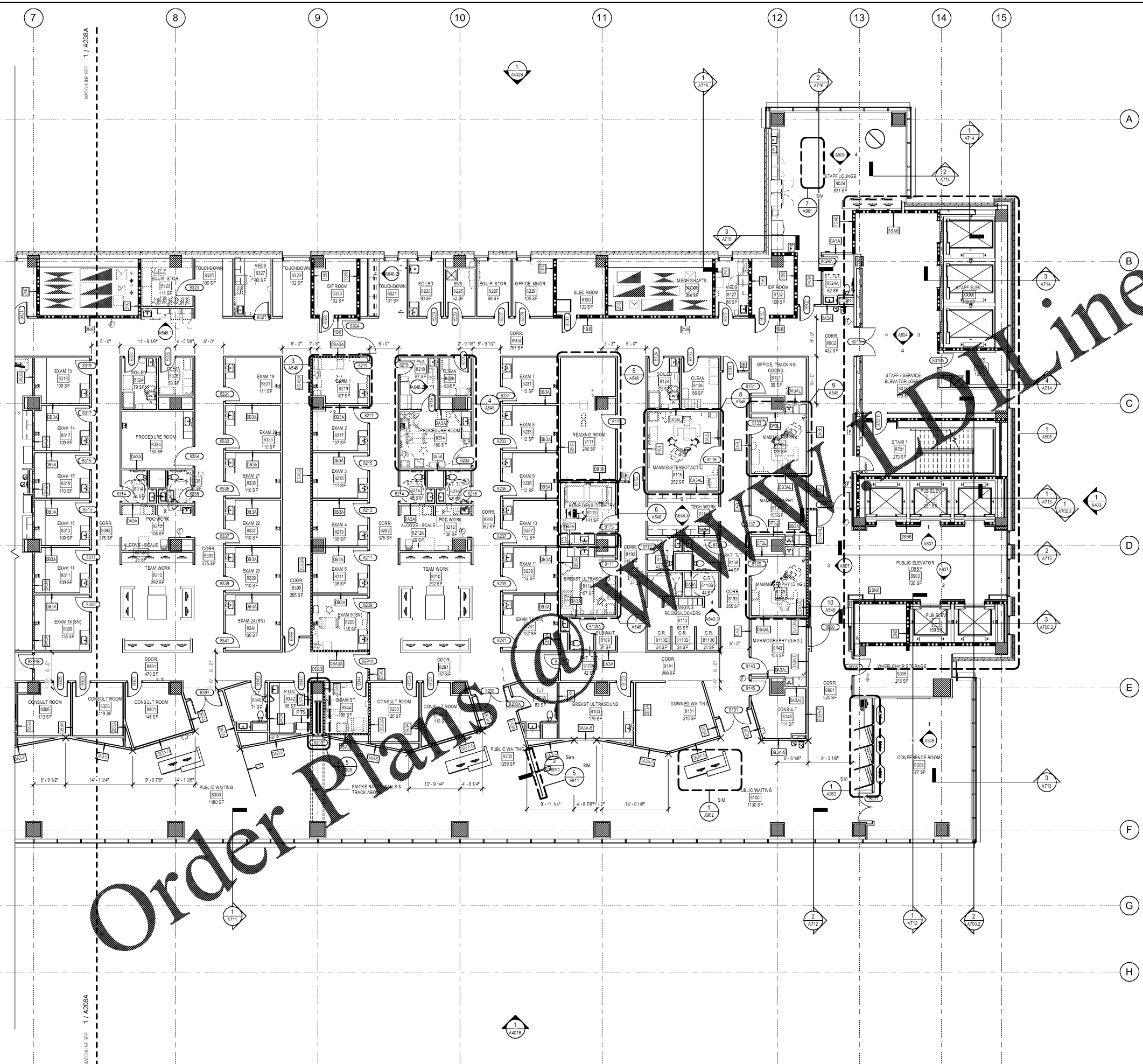

**1** FLOOR PLAN - LEVEL 8 - EAST  
1/8" = 1'-0"

2019-07-04 4:37:16 PM