

GENERAL PLAN NOTES

- 1. REVIEW LIFE SAFETY SHEETS FOR FIRE AND SMOKE BARRIER WALL DESIGNATIONS.
- 2. SMOKE COMPARTMENT WALLS TO BE MAINTAINED. PHASE ADJACENT PURRING WALLS TO MAINTAIN ADEQUATE SEPARATION REQUIREMENTS. SEE LIFE SAFETY.
- 3. WALLS AT LEVELS G, 4, 5, & 9 TO BE TYPE A0, UNLESS NOTED OTHERWISE. PURRING WALLS AT LEVELS 4, 5, & 9 TO BE TYPE PL UNLESS NOTED OTHERWISE.
- 4. WALLS AT LEVELS 1, 2, 3, 6, 7, & 8 TO BE TYPE A3, UNLESS NOTED OTHERWISE.
- 5. WALL PRIORITY DIAGRAM LOCATED ON INTERIOR PARTITIONS SHEETS. FIRE, SMOKE, AND ACoustICAL RATED WALLS TAKE PRECEDENCE OVER NON-RATED WALLS. MAINTAIN INTEGRITY OF RATINGS.
- 6. WALLS CARRYING STC RATINGS TO BE MAINTAINED ENTIRE LENGTH. WALL. SEE PARTITION SCHEDULE FOR MINIMUM STC RATINGS. ASSIGNED VALUES INDICATED ON A100 SERIES DIAGRAMS.
- 7. FACETED WALLS AT PUBLIC WAITING AREAS TO RECEIVE 5 WALL.
- 8. MAINTAIN LEAD LINING PARTITION AROUND THE PERIMETER OF ROOM, DOORS, & WINDOWS.
- 9. P.T.S. - PNEUMATIC TUBE SYSTEM NOTES. P.T.S. - PNEUMATIC TUBE STATION - CALLED OUT. P.T.S.F. - PNEUMATIC TUBE STATION WITH OVERHEAD CONNECTIONS ESTABLISHED.



Project
**THE CENTER FOR
 ADVANCED SURGICAL
 SERVICES (CASS)**

80 GILMER STREET SE
 ATLANTA, GA 30303

Prepared For
GRADY HEALTH SYSTEM
 80 JESSE HILL DR. SE
 ATLANTA, GA 30303



Hok, Inc. • O'Neil & Kestabum, Inc.
 133 Peachtree Street, NE, Suite 4800
 Atlanta, GA 30303 USA
 +1 404 439 9000 +1 404 439 9001

All reproduction & intellectual property rights reserved © 2019
 An Association with

Key Plan

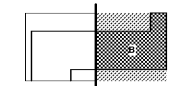

Professional Seal

**NOT FOR
 CONSTRUCTION**

No.	Description	Date
1	DC - GMP	2019.07.03

Project No: 18.16013.00
 Sheet Title

**LEVEL 7 FLOOR PLAN -
 EAST**

Original is 20" x 30". Do not scale contents of this drawing.
 Sheet Number

A207B

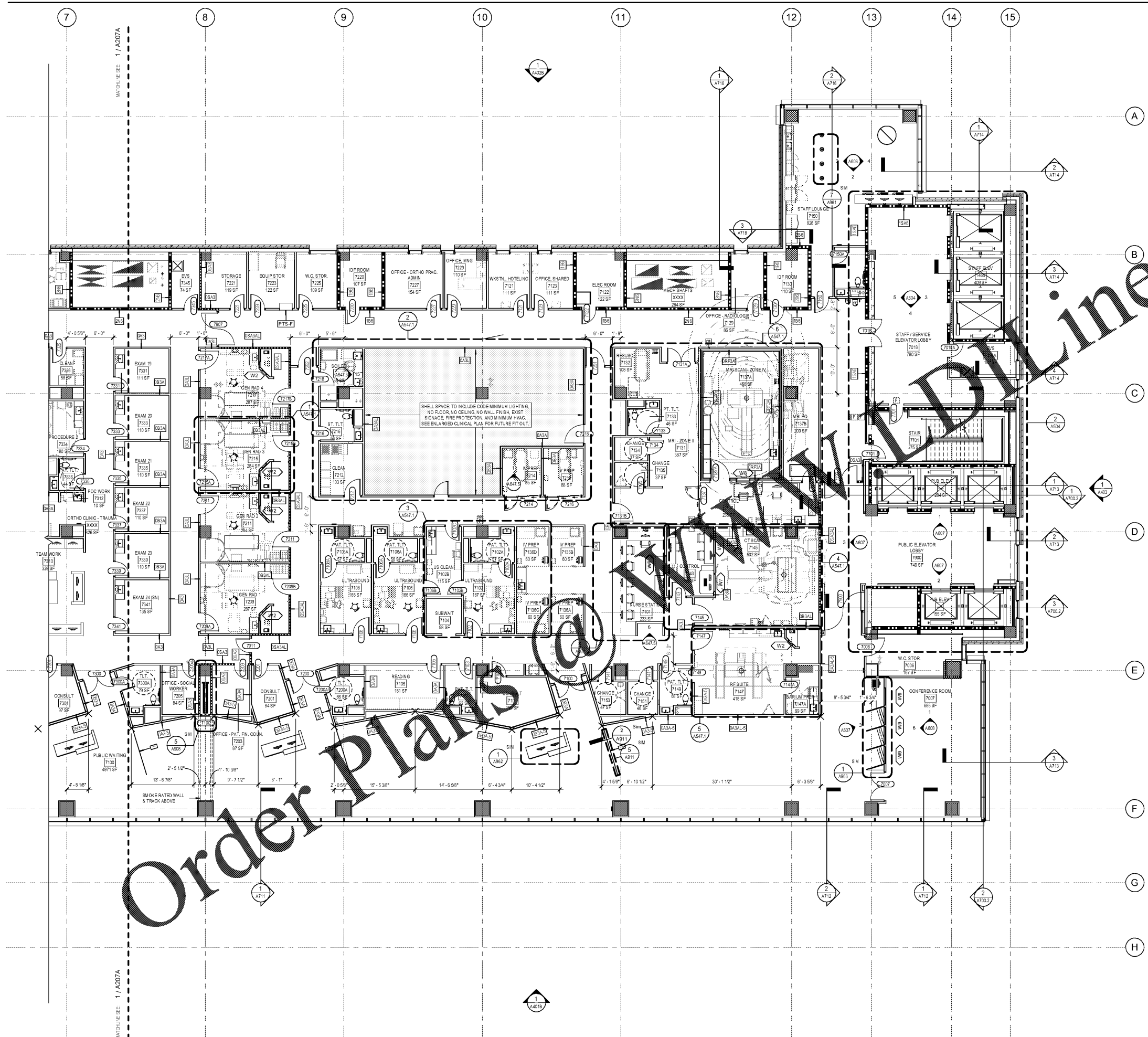

1 FLOOR PLAN - LEVEL 7 - EAST
 1/8" = 1'-0"

2019-07-03 4:38:50 PM