

GENERAL PLAN NOTES

- 1. REVIEW LIFE SAFETY SHEETS FOR FIRE AND SMOKE BARRIER WALL DESIGNATIONS.
- 2. SMOKE COMPARTMENT WALLS TO BE MAINTAINED. PHASE ADJACENT FURRING WALLS TO MAINTAIN ADEQUATE SEPARATION REQUIREMENTS. SEE LIFE SAFETY.
- 3. WALLS AT LEVELS G, A, S, & 9 TO BE TYPE A6, UNLESS NOTED OTHERWISE. FURRING WALLS AT LEVELS G, A, S, & 9 TO BE TYPE PE, UNLESS NOTED OTHERWISE.
- 4. WALLS AT LEVELS 1, 2, 3, 6, 7, 8 TO BE TYPE A3, UNLESS NOTED OTHERWISE.
- 5. WALL PRIORITY DIAGRAM LOCATED ON INTERIOR PARTITIONS SHEETS. FIRE, SMOKE, AND ADJUSTABLE RATED WALLS TAKE PRECEDENCE OVER NON-RATED WALLS. MAINTAIN INTEGRITY OF RATINGS.
- 6. WALLS CARRYING STC RATINGS TO BE MAINTAINED. ENTIRE WALL SHALL SEE PARTITION SCHEDULE FOR MINIMUM STC RATINGS. ASSIGNED VALUES INDICATED ON A100 SERIES DIAGRAMS.
- 7. FACETED WALLS AT PUBLIC WAITING AREAS TO RECEIVE 5 WALL.
- 8. MAINTAIN LEAD LINING PARTITION AROUND THE PERIMETER OF ROOM, DOORS, & WINDOWS.
- 9. P.T.S. - PNEUMATIC TUBE SYSTEM NOTES. PLANS SHALL SHOW P.T.S. PNEUMATIC TUBE STATION - CALLED OUT TO BE INSTALLED IN ACCORDANCE WITH CONNECTIONS ESTABLISHED.



Project  
**THE CENTER FOR  
 ADVANCED SURGICAL  
 SERVICES (CASS)**

80 GILMER STREET SE  
 ATLANTA, GA 30303

Prepared For  
**GRADY HEALTH SYSTEM**  
 80 JESSE HILL DR. SE  
 ATLANTA, GA 30303



Hok, Inc. • O'Connell & Kastbaum, Inc.  
 133 Peachtree Street, NE, Suite 4800  
 Atlanta, GA 30303 USA  
 T+1 404 439 9000 F+1 404 439 9001

All reproduction & intellectual property rights reserved © 2019  
 An Association with

Key Plan

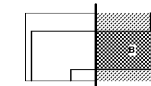

Professional Seal

**NOT FOR  
 CONSTRUCTION**

| No. | Description | Date       |
|-----|-------------|------------|
| 1   | DC - GMP    | 2019.07.03 |

Project No: 18.16013.00  
 Sheet Title

**LEVEL 6 FLOOR PLAN -  
 EAST**

Original is 20 x 42. Do not scale contents of this drawing  
 Sheet Number

**A206B**

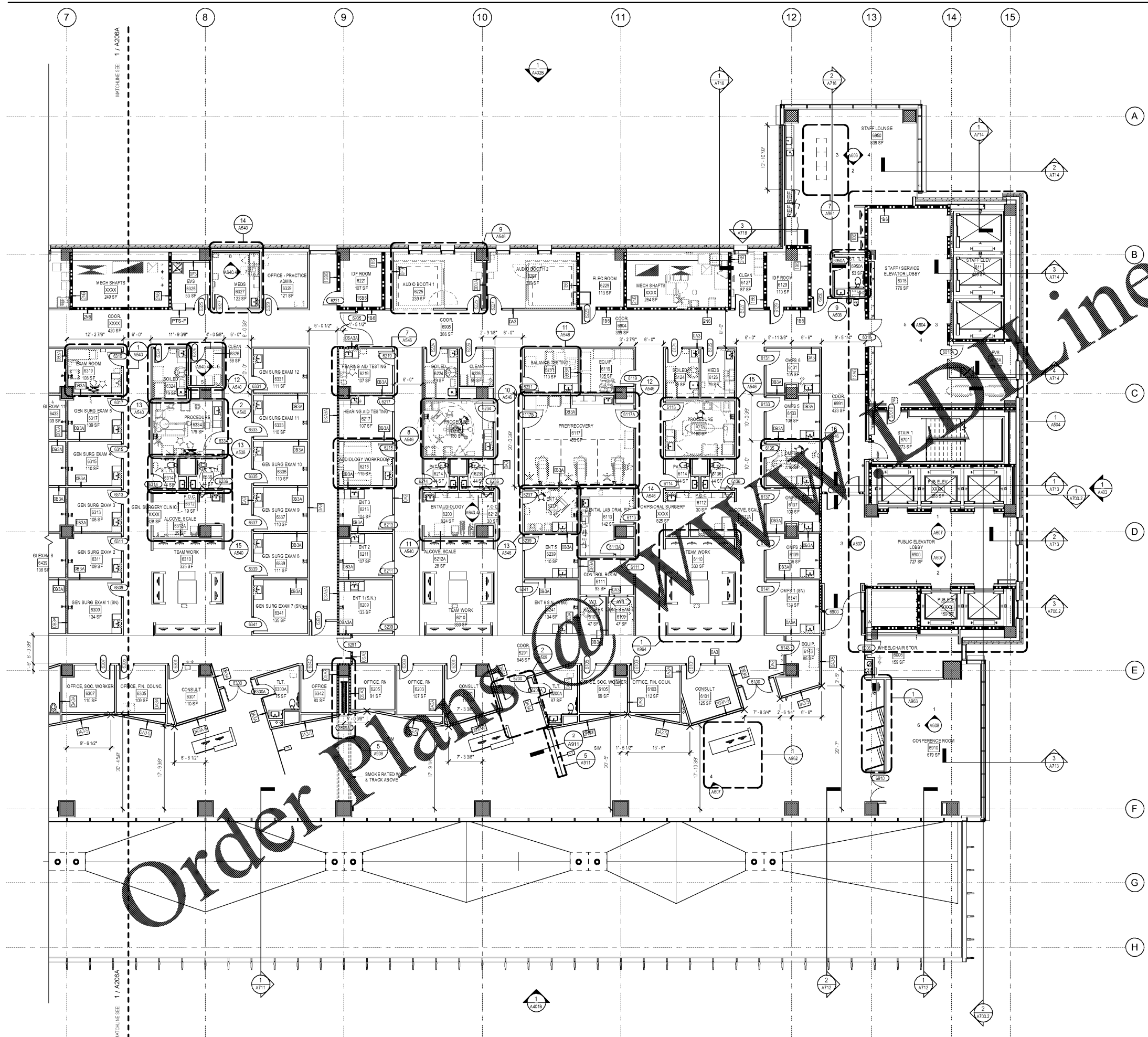

**1 FLOOR PLAN - LEVEL 6 - EAST**  
 1/8" = 1'-0"

2019-07-03 4:38:31 PM