



Key Plan



Professional Seals

**NOT FOR
 CONSTRUCTION**

No.	Description	Date
1	DD - GMP	2019-07-03

Project No: 18-16013-00
 Sheet Title

OVERALL SITE PLAN

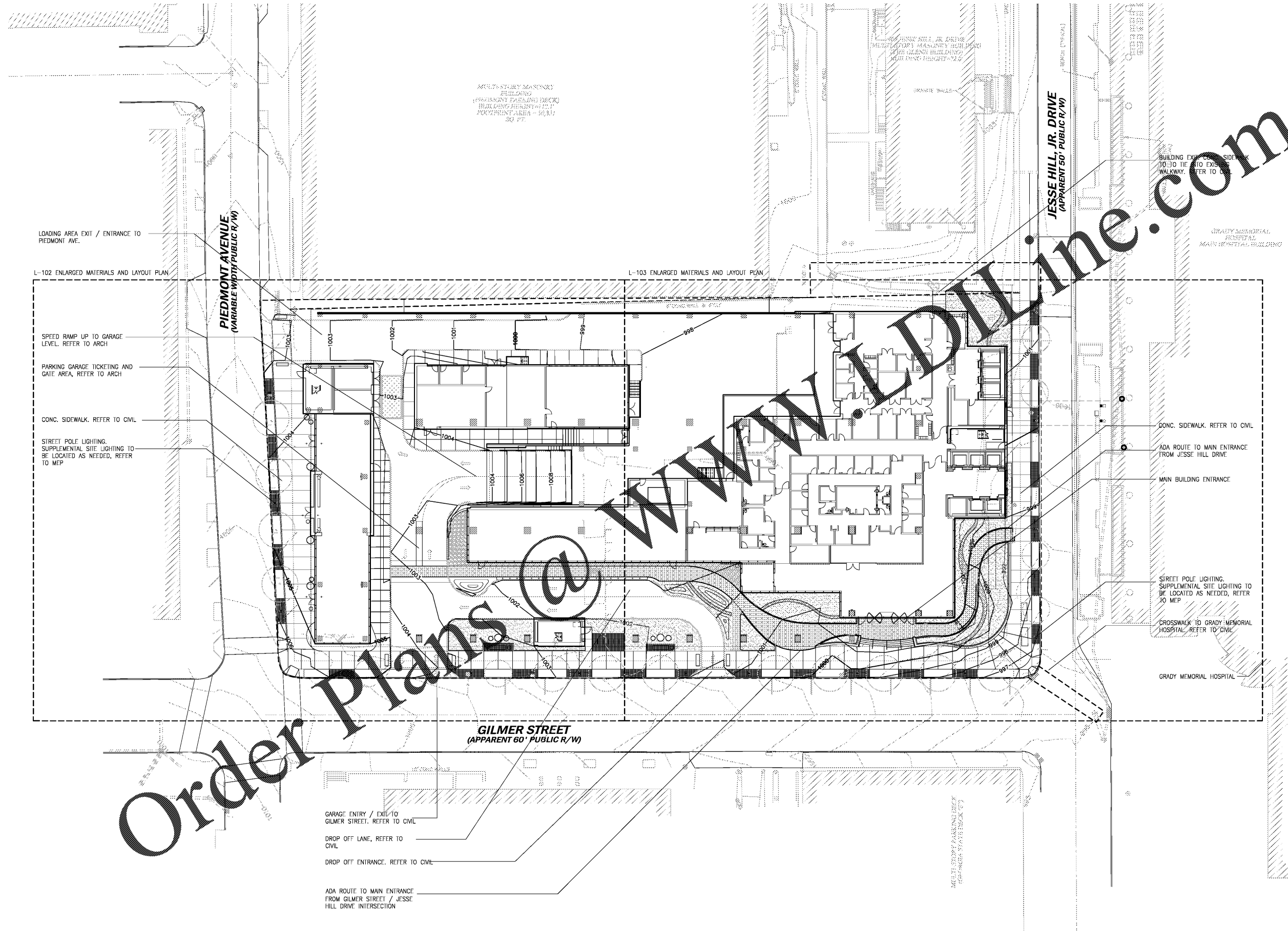

LOADING AREA EXIT / ENTRANCE TO
 PIEDMONT AVE.

L-102 ENLARGED MATERIALS AND LAYOUT PLAN

SPEED RAMP UP TO GARAGE
 LEVEL. REFER TO ARCH

PARKING GARAGE TICKETING AND
 GATE AREA. REFER TO ARCH

CONC. SIDEWALK. REFER TO CIVIL

STREET POLE LIGHTING.
 SUPPLEMENTAL SITE LIGHTING TO
 BE LOCATED AS NEEDED, REFER
 TO MEP

L-103 ENLARGED MATERIALS AND LAYOUT PLAN

BUILDING EXITS. REFER TO ARCH
 30-30 TIE INTO EXISTING
 WALKWAY. REFER TO CIVIL

GRADY MEMORIAL
 HOSPITAL
 MAIN ENTRANCE BUILDING

CONC. SIDEWALK. REFER TO CIVIL

ADA ROUTE TO MAIN ENTRANCE
 FROM JESSE HILL DRIVE

MAIN BUILDING ENTRANCE

STREET POLE LIGHTING.
 SUPPLEMENTAL SITE LIGHTING TO
 BE LOCATED AS NEEDED, REFER
 TO MEP

CROSSWALK TO GRADY MEMORIAL
 HOSPITAL. REFER TO CIVIL

GRADY MEMORIAL HOSPITAL

GILMER STREET
 (APPARENT 60' PUBLIC R/W)

GARAGE ENTRY / EXIT TO
 GILMER STREET. REFER TO CIVIL

DROP OFF LANE. REFER TO
 CIVIL

DROP OFF ENTRANCE. REFER TO CIVIL

ADA ROUTE TO MAIN ENTRANCE
 FROM GILMER STREET / JESSE
 HILL DRIVE INTERSECTION