

LOCATION MAP

N.T.S.

NOTES

1. USE ARCHITECTURAL PLANS FOR BUILDING STAKE OUT.
2. ALL DIMENSIONS SHOWN ARE FROM FACE OF BUILDING, CURB, OR WALL UNLESS OTHERWISE NOTED.

ANTICIPATED TRAFFIC COUNTS

6,534 TRIPS PER DAY
50% ENTERING, 50% EXISTING

PAVING LEGEND

	CONCRETE PAVING
	CONCRETE S/W

COA STANDARD CONCRETE DRIVEWAY APRON

MULTI-STORY MASONRY PARKING DECK

10' CONCRETE SIDEWALK

TRANSFORMER VAULT (BELOW GRADE) BUILDING ABOVE

5' LANDSCAPE STRIP

PROPOSED 3" PRINCETON ELM 30' O.C. (TYP.)

OWNER
GRADY HEALTH SYSTEM
80 JESSE HILL JR. DR. SE
ATLANTA, GA 30303
(404) 616-3872

ENGINEER
WESLEY REED, P.E.
EBERLY & ASSOCIATES, INC.
2951 FLOWERS ROAD SOUTH,
SUITE 119
ATLANTA, GEORGIA 30341
(770) 452-7849
E. WREED@EBERLY.NET

24 HOUR CONTACT
CONTACT: GEORGE SMITH
NUMBER: (404) 616-3228
EMAIL: GCSMITH@GMH.EDU

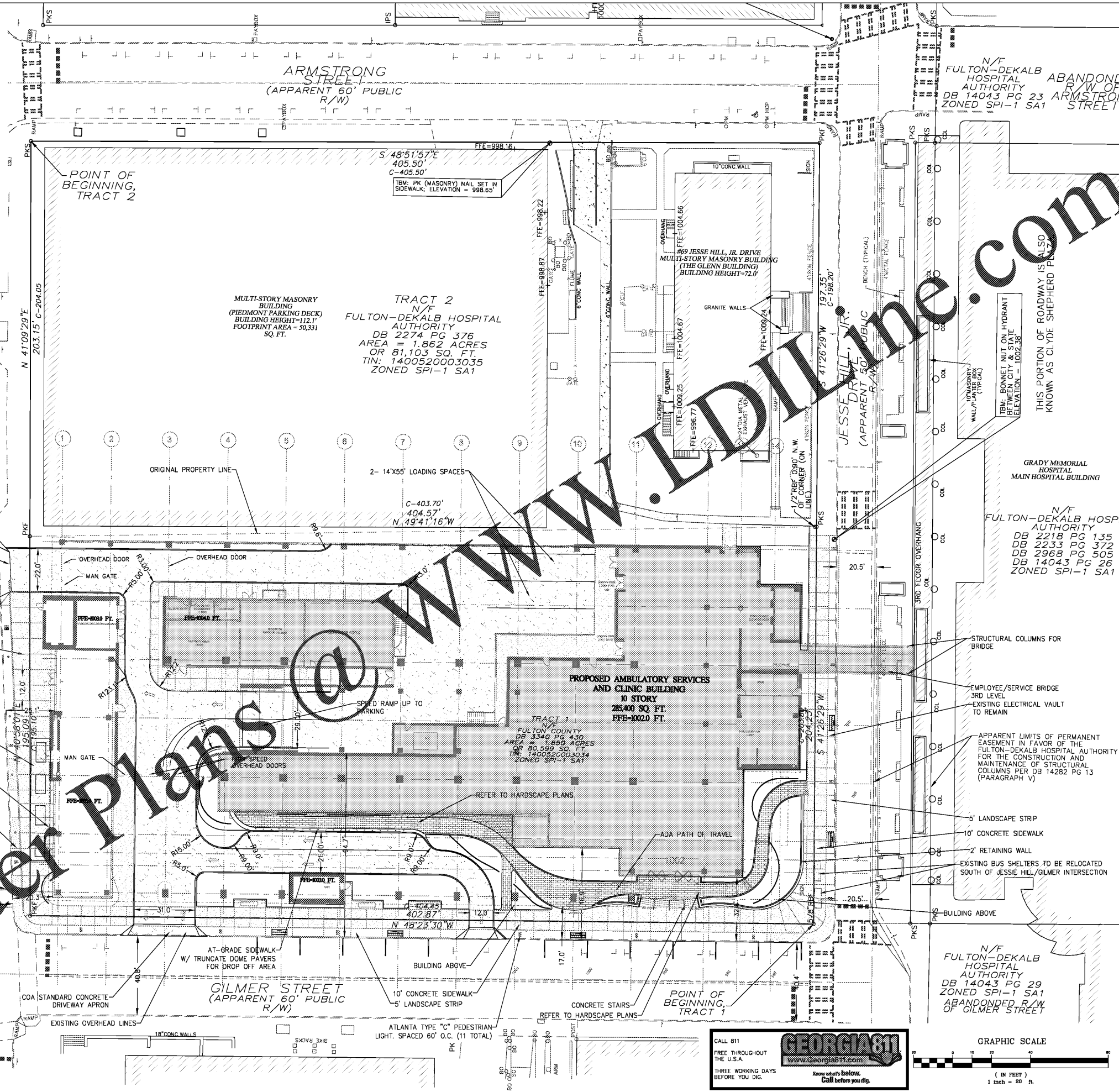

Order Plans @ www.edline.com



Project
THE CENTER FOR
ADVANCED SURGICAL
SERVICES (CASS)
80 GILMER STREET SE
ATLANTA, GA 30303

Prepared For
GRADY HEALTH SYSTEM
80 JESSE HILL DR. SE
ATLANTA, GA 30303



Hellmuth, Obata & Kassabaum, Inc.
133 Peachtree Street, NE, Suite 4800
Atlanta, GA 30303 USA
T+1 404 439 9000 F+1 404 439 9001

All reproduction & intellectual property rights reserved ©
2019
In Association with

Eberly & Associates, Inc.
CIVIL ENGINEERING
2951 Flowers Road South, Suite 119
Atlanta, GA 30341

Key Plan

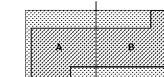

Professional Seals

NOT FOR CONSTRUCTION

No.	Description	Date
1	001 GMP	2019 07 03

